

PROJECT REFERENCE NO. <b>U-3334B</b>	SHEET NO. <b>10</b>
ROADWAY DESIGN ENGINEER <i>(Signature)</i> SEAL 022037 12/5/2017	HYDRAULICS ENGINEER <i>(Signature)</i> SEAL 032581 12/5/2017
<b>DOCUMENT NOT CONSIDERED FINAL UNLESS ALL SIGNATURES COMPLETED</b>	

NAD 83/NSRS 2011

95

24  
 NELL M. HOWELL  
 REVOCABLE TRUST  
 DB 3334 PG 883

100 BM#5

REVISIONS

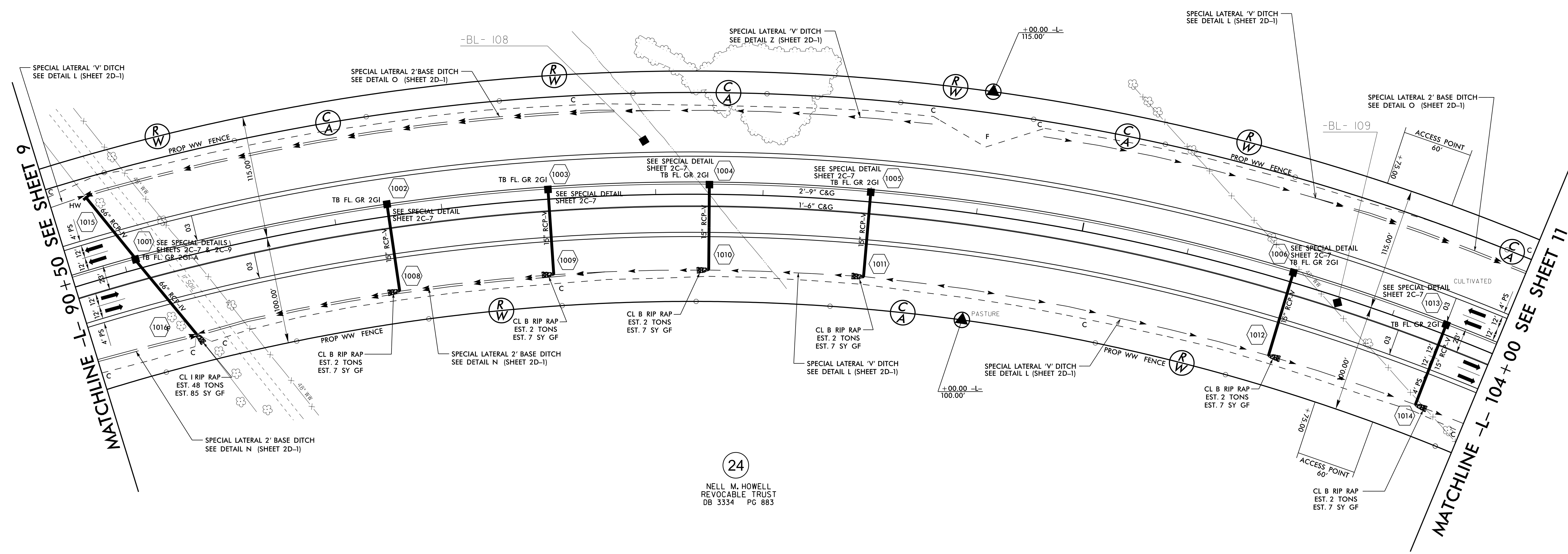

MATCHLINE -L- 90+50 SEE SHEET 9

MATCHLINE -L- 104+00 SEE SHEET 11

24  
 NELL M. HOWELL  
 REVOCABLE TRUST  
 DB 3334 PG 883

-L-  
 PI Sta 102+71.66  
 $\Delta = 90^\circ 31' 41.4''$  (RT)  
 $D = 2' 56' 17.7''$   
 $L = 3,081.03'$   
 $T = 1,968.06'$   
 $R = 1,950.00'$   
 $Se = .03$   
 RUNOFF = 108'

**NOTES:**  
 SEE SHEET 18 FOR -L- PROFILE.