

**This electronic collection of documents is provided
for the convenience of the user
and is Not a Certified Document –**

**The documents contained herein were originally issued
and sealed by the individuals whose names and license
numbers appear on each page, on the dates appearing
with their signature on that page.**

**This file or an individual page
shall not be considered a certified document.**

STATE	STATE PROJECT REFERENCE NO.	SHEET NO.	TOTAL SHEETS
N.C.	I-5793	1	
STATE PROJ. NO.	F.A. PROJ. NO.	DESCRIPTION	

STATE OF NORTH CAROLINA
DIVISION OF HIGHWAYS

DAVIDSON COUNTY

LOCATION: I-85 FROM EAST OF US 64 TO
NC 109 IN THOMASVILLE

TYPE OF WORK: REHABILITATION OF PAVEMENT
AND STRUCTURES.

TIP PROJECT: I-5793

CONTRACT: C204053

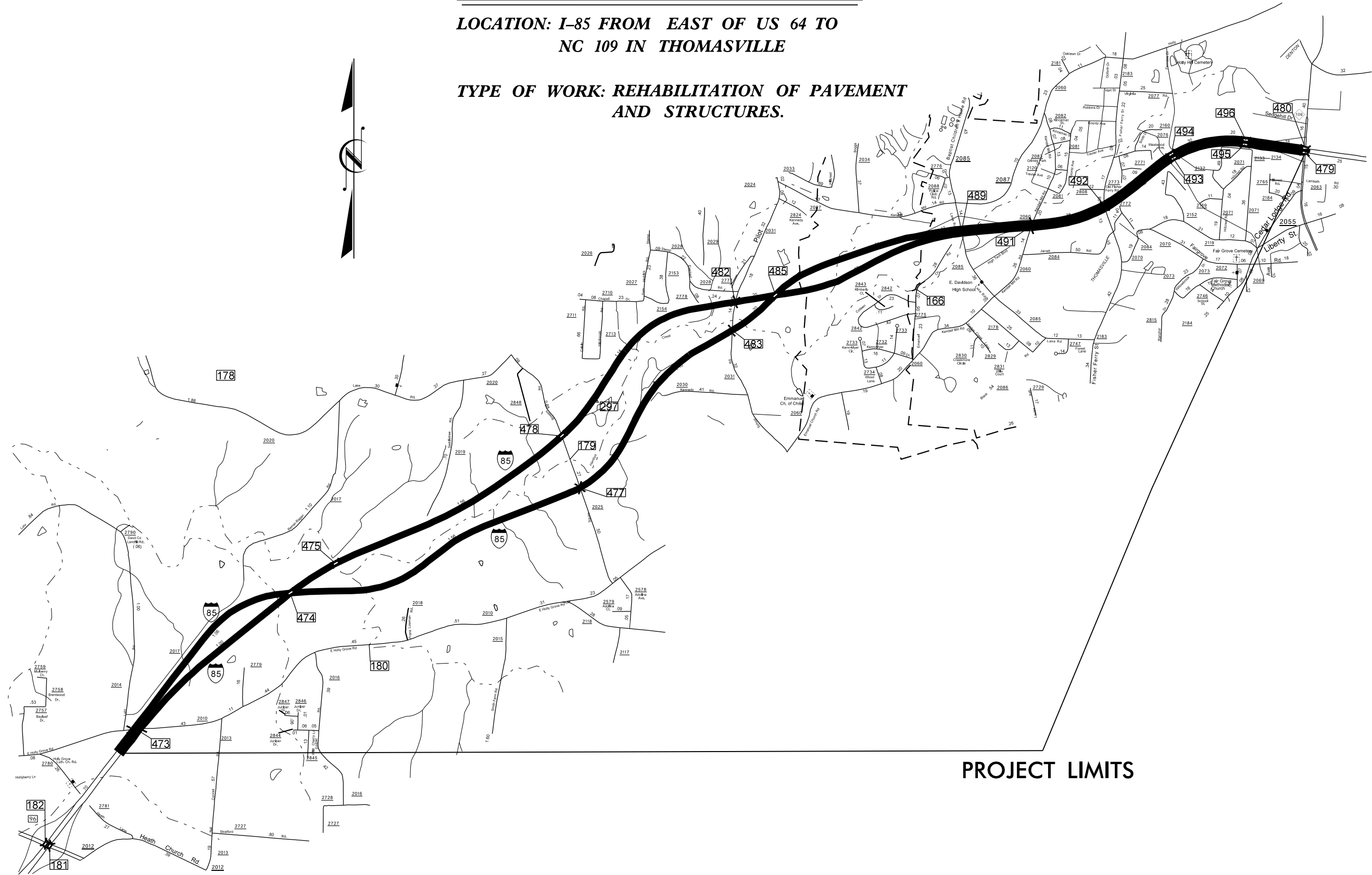

26-OCT-2017 10:35 S:\Contracts\Projects\Resurfacing Projects\Division 9\I-5793 January 2018\I-5793-ddc-tsh.dgn inowerton AT CSD-292595

09/08/99

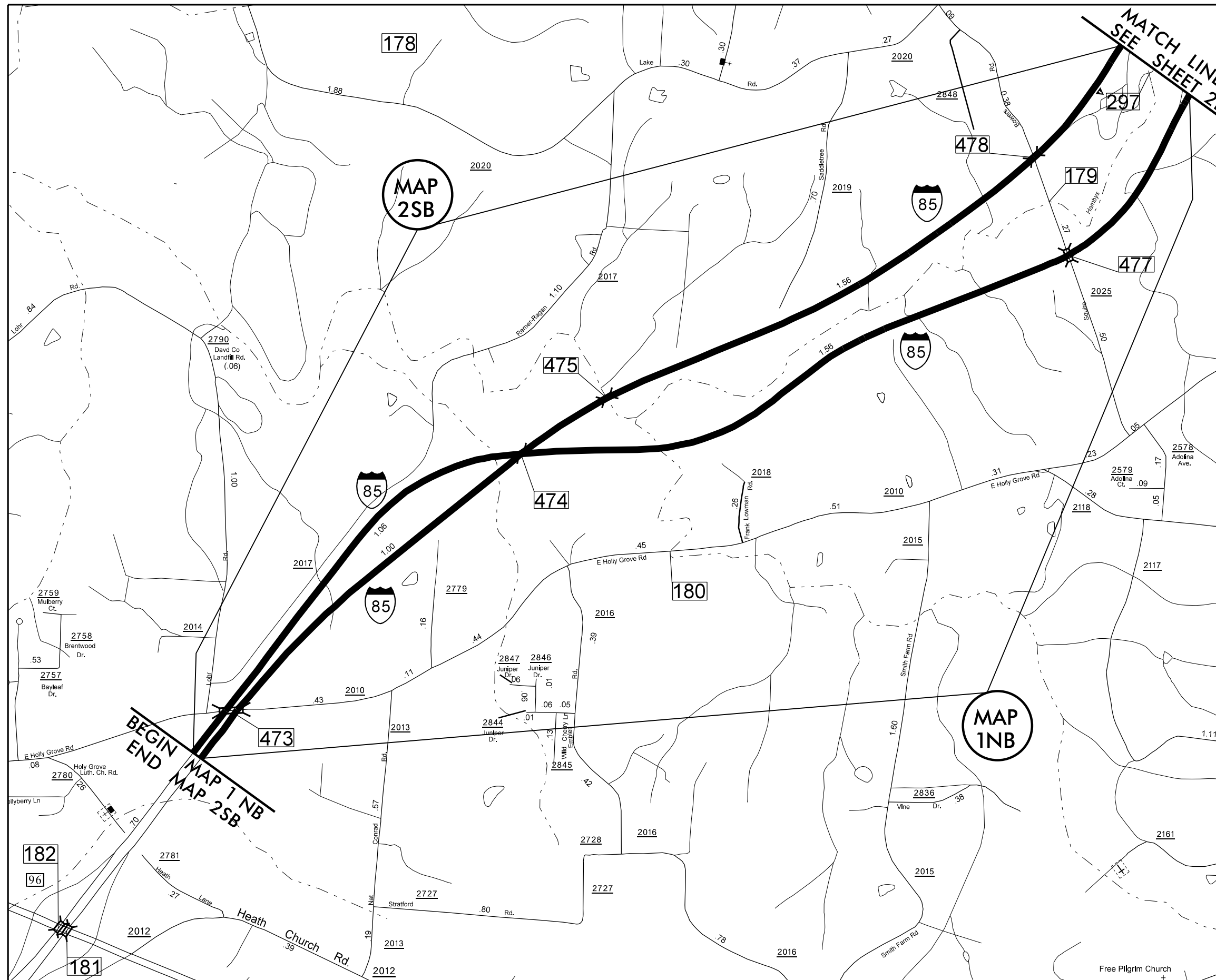

MAP 1NB
 I-85 North Bound
 MAP 2SB
 I-85 South Bound
 ALL WORK ON THESE MAPS TO BE
 NIGHT TIME ONLY 8 P.M. TO 6 A.M.,
 Monday-Sunday.

DAVIDSON COUNTY
 NORTH CAROLINA

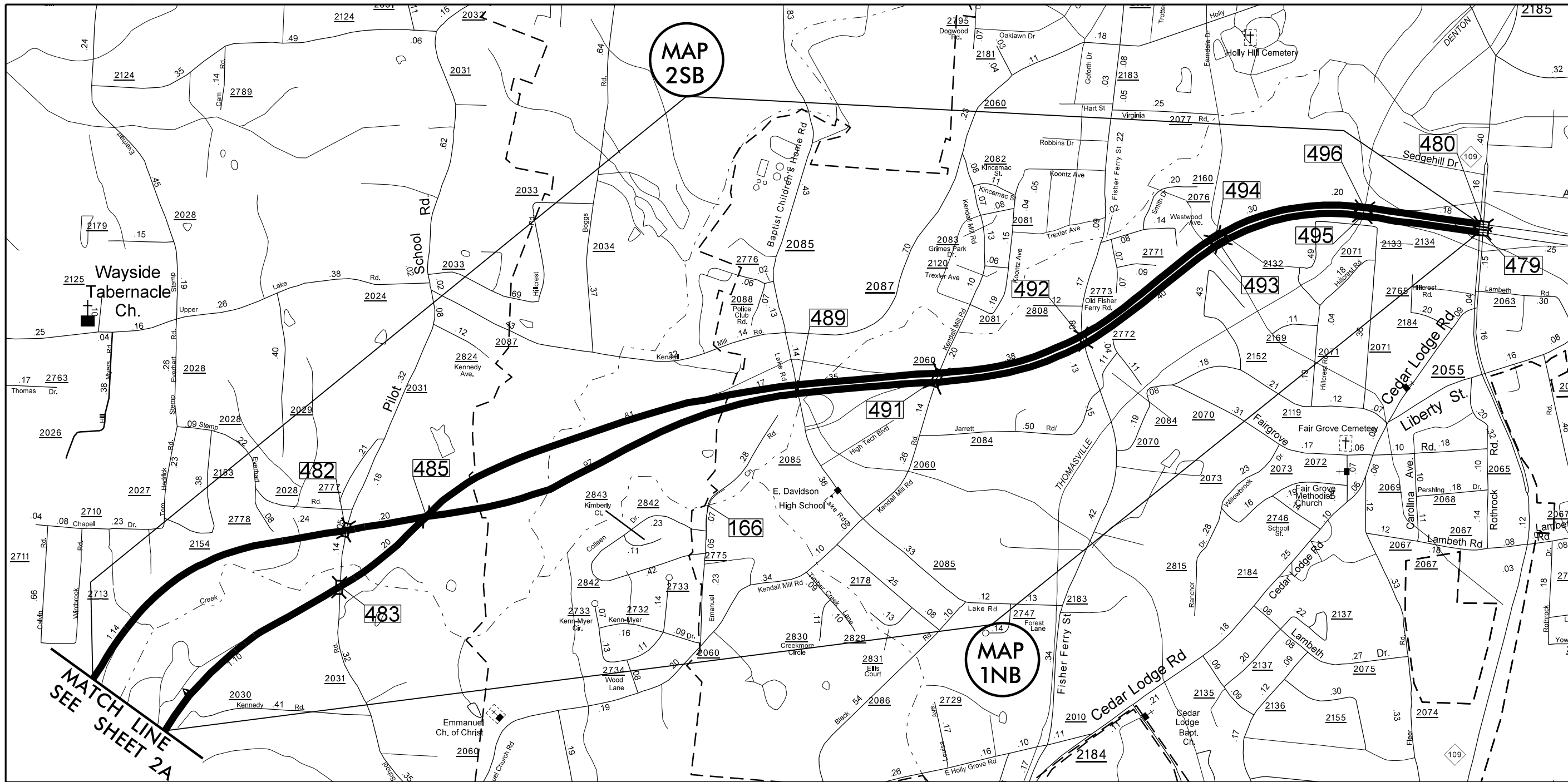

MAP 1NB
 I-85 North Bound
 MAP 2SB
 I-85 South Bound
 ALL WORK ON THESE MAPS TO BE
 NIGHT TIME ONLY 8 P.M. TO 6 A.M.,
 Monday-Sunday.

DAVIDSON COUNTY
 NORTH CAROLINA

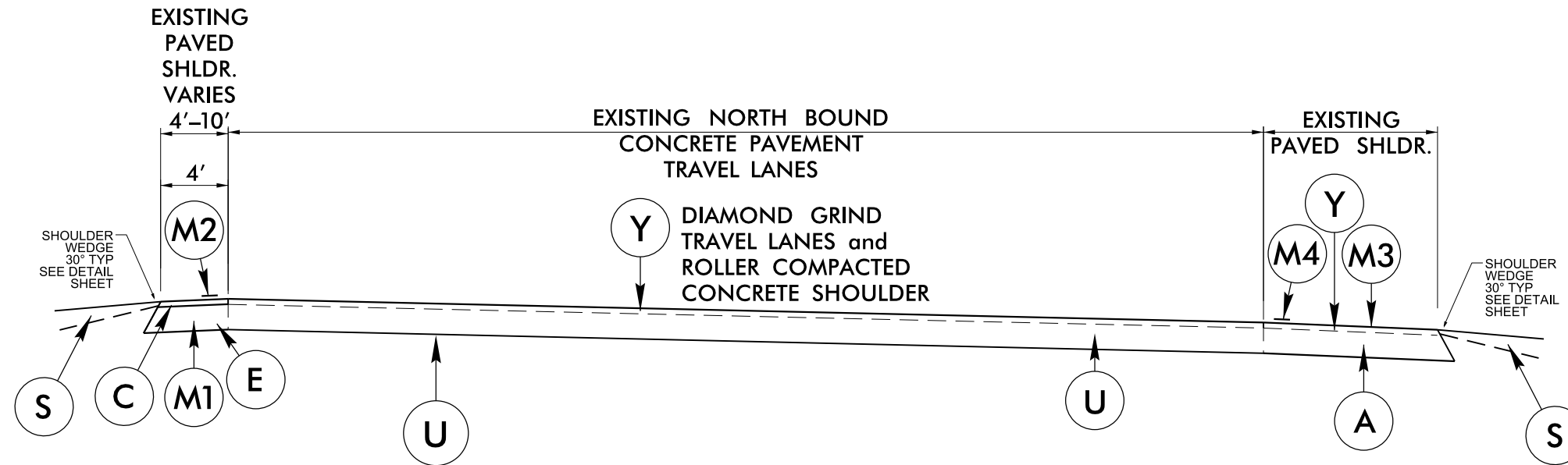

TYPICAL SECTION NO. 1
MAP 1NB
I-85 – NORTH BOUND
MAP 2SB
I-85 – SOUTH BOUND

NOTE:
 PRIOR TO PLACING PAVEMENT MARKING MATERIAL ON CONCRETE SURFACES THAT ARE DIAMOND GROUND; USE AN ACCEPTABLE METHOD TO GRIND RIDGES SMOOTH ONLY WHERE PAVEMENT MARKING WILL BE INSTALLED.

PAVEMENT SCHEDULE	
A	8" ROLLED COMPACTED CONCRETE (RCC)
C	PROP. APPROX. 1½" ASPHALT CONCRETE SURFACE COURSE, TYPE S9.5C, TO BE APPLIED AT AN AVERAGE RATE OF 168 LBS PER SQ. YD.
E	PROP. APPROX. 5½" ASPHALT CONCRETE BASE COURSE, TYPE B25.0C, TO BE APPLIED AT AN AVERAGE RATE OF 627 LBS PER SQ. YD.
M1	7" TRENCHING
M2	MILLED RUMBLE STRIP (ASPHALT CONCRETE)
M3	8" TRENCHING
M4	MILLED RUMBLE STRIPS (CONCRETE SHOULDER)
S	SHOULDER RECONSTRUCTION (SEE DETAIL)
U	EXISTING PAVEMENT
Y	PROPOSED DIAMOND GRINDING

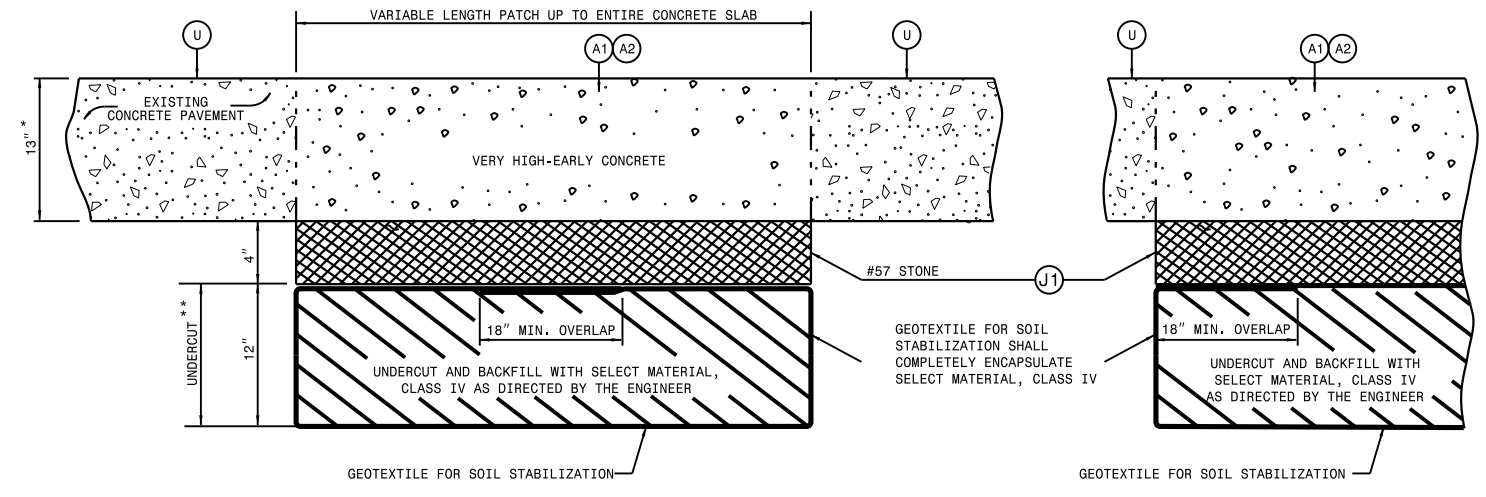
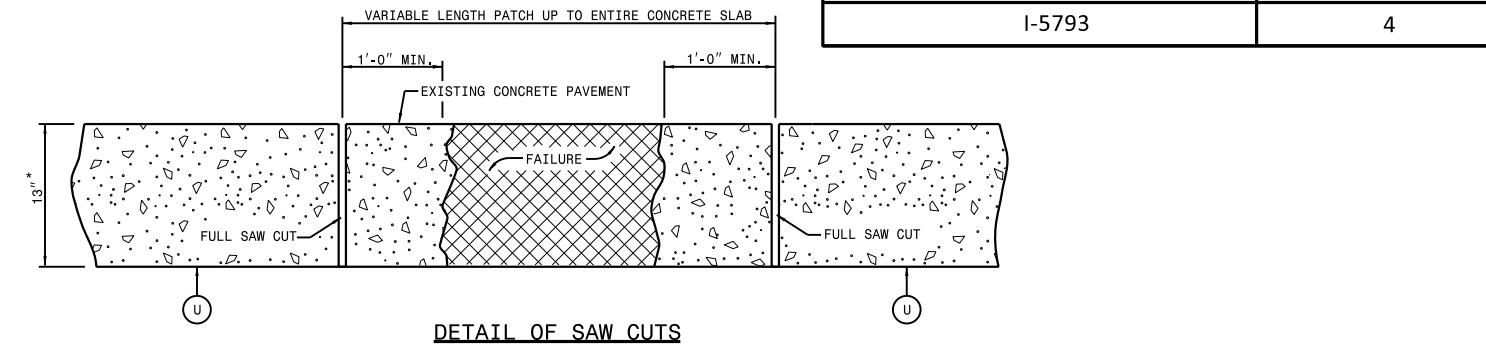

* DIMENSIONS ARE APPROXIMATE AND SHOULD BE FIELD VERIFIED
 ** UNDERCUT REQUIRED IN AREAS AS DIRECTED BY THE ENGINEER

PAVEMENT SCHEDULE	
A1	13" VERY HIGH-EARLY CONCRETE
A2	10" VERY HIGH-EARLY CONCRETE
J1	#57 STONE
U	EXISTING PAVEMENT

Refer to the North Carolina Department of Transportation
 "Partial and Full Depth Repair Manual" when Replacing Slabs
 and when Repairing Concrete Pavement.

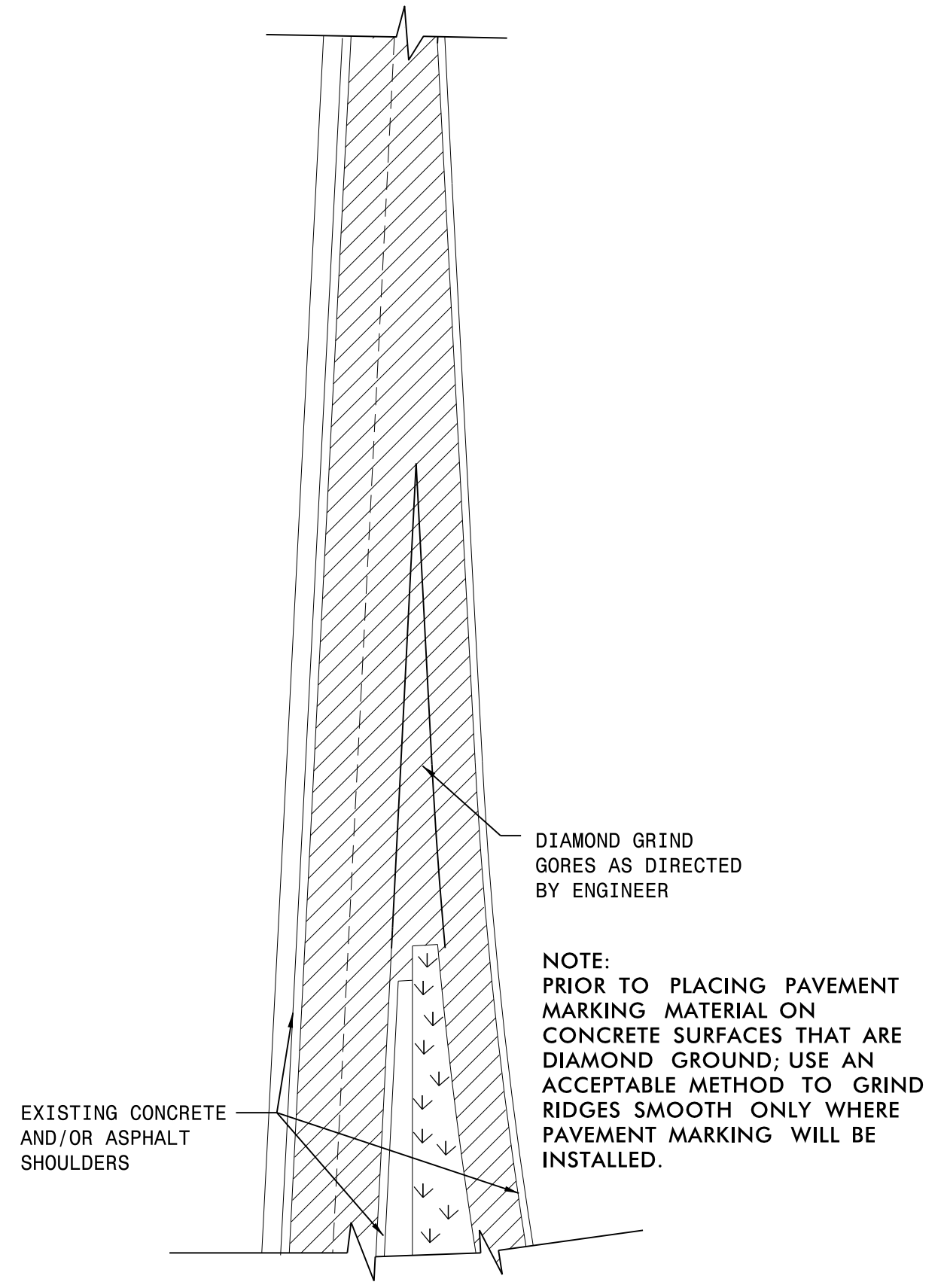

**DETAIL FOR LIMITS OF MILLING
 AND DIAMOND GRINDING AT
 GORE AREAS**

**DETAIL FOR REPAIR OF
 CONCRETE PAVEMENT**

NOTES: Less than 5' - 10' undisturbed buffer from ROW, ditchline, water feature, or drainage inlet, add BMP.

BMP Options: Wattle or Silt Fence

EROSION CONTROL DETAIL

PROJECT REFERENCE NO.	SHEET NO.
I-5793 53032.3.1	5

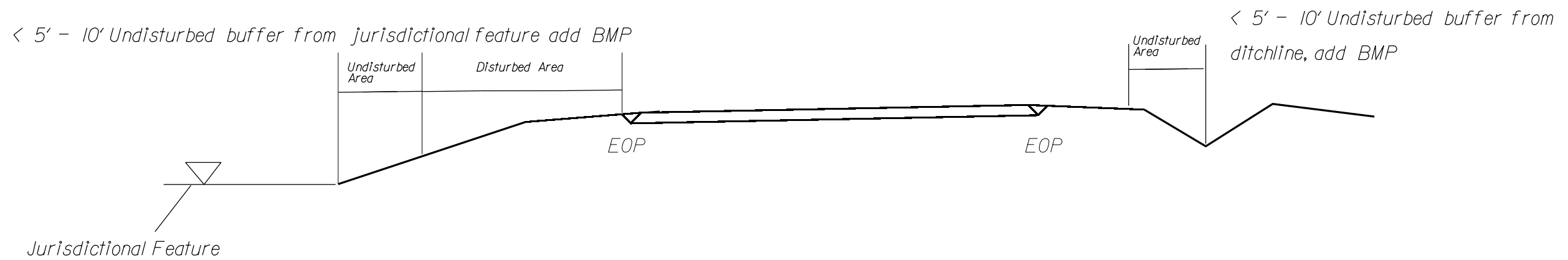
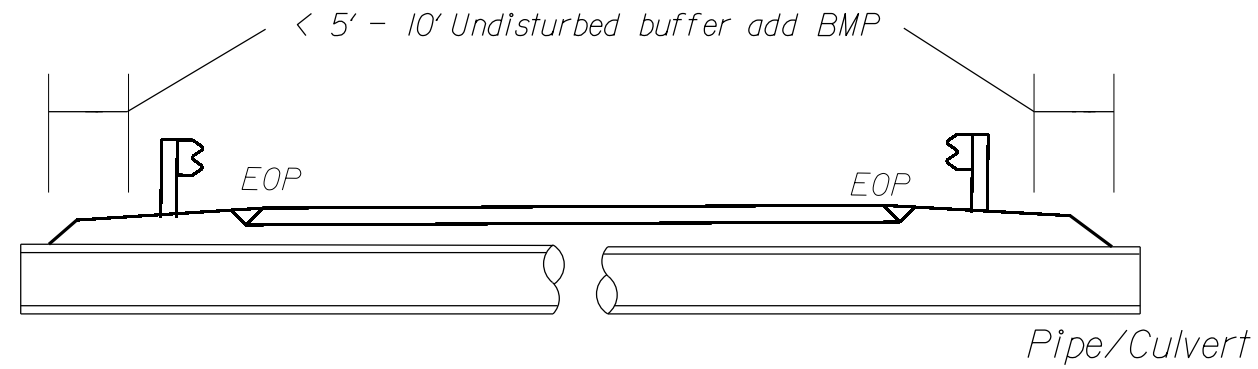

Use BMP's if shoulders and/or frontslopes and/or ditchline and/or backslopes are disturbed



< 5' - 10' Undisturbed buffer from inlet, add wattle

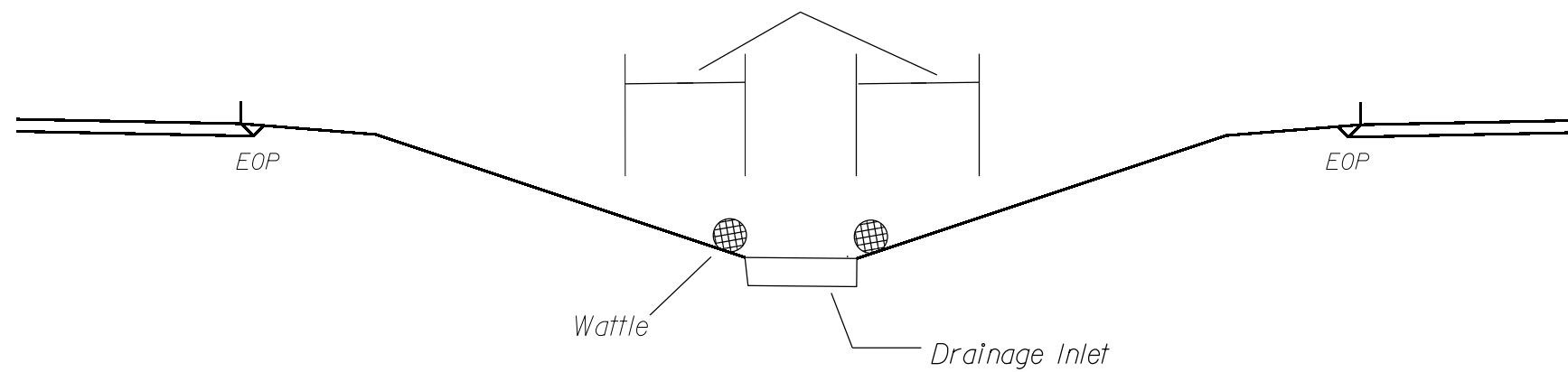

NOT TO SCALE

PROJECT REFERENCE NO.	SHEET NO.
I-5793 53032.3.1	6

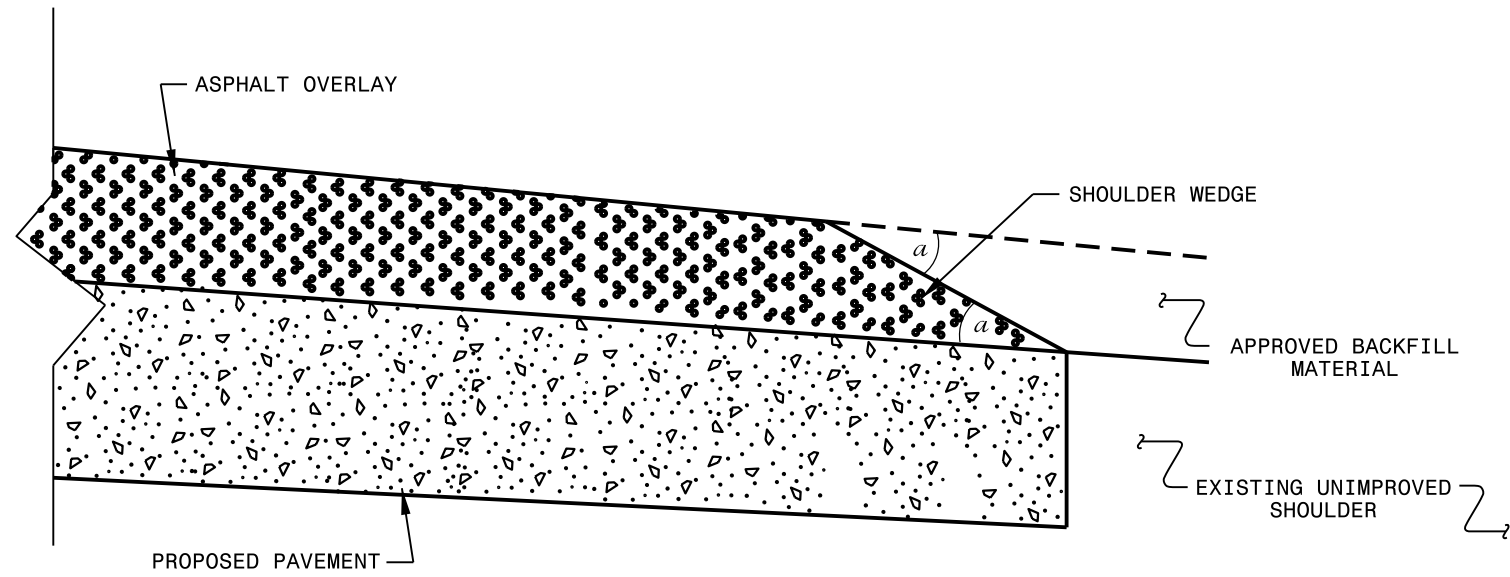

SHOULDER WEDGE DETAIL

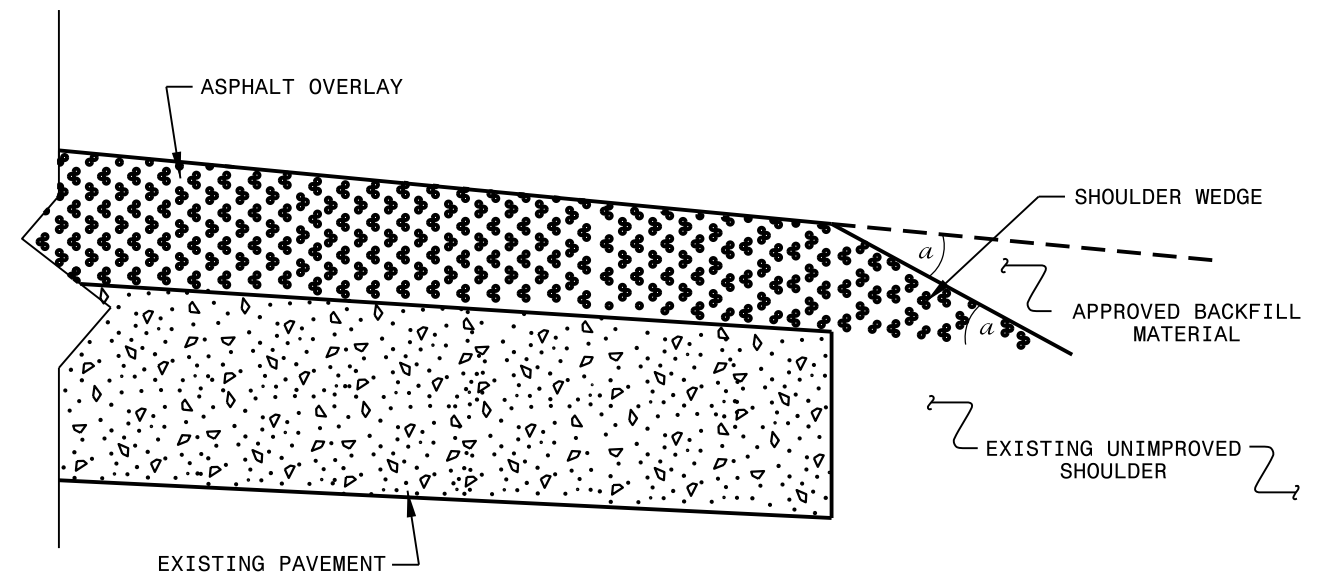

SHOULDER WEDGE DETAIL
(Resurfacing Projects w/ NO Widening)

CONTRACT STANDARDS AND DEVELOPMENT UNIT			
Office 919-707-6950		FAX 919-250-4119	
SHOULDER WEDGE			
ORIGINAL BY:	T.SPELL	DATE:	7-19-11
MODIFIED BY:		DATE:	
CHECKED BY:		DATE:	
FILE SPEC.:	s:\usr\details\stand\shoulderwedge\detail.dgn		

WATTLE DETAIL

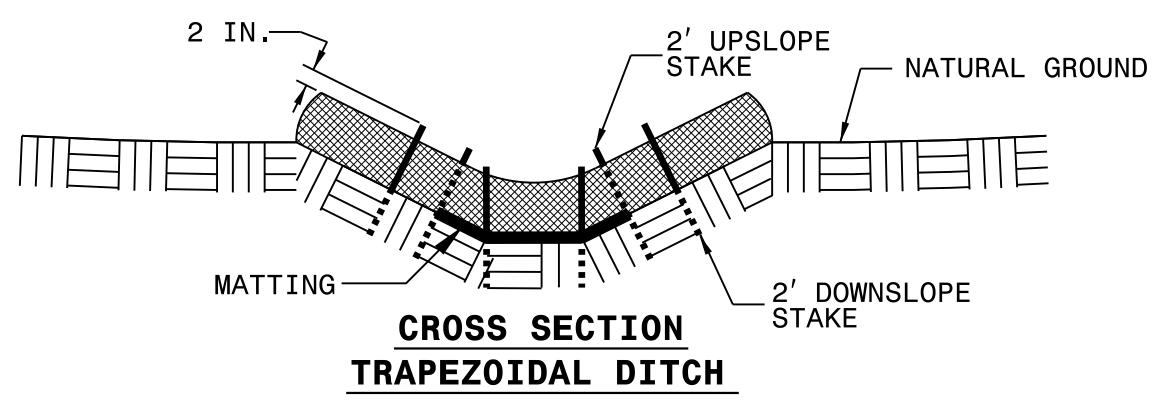
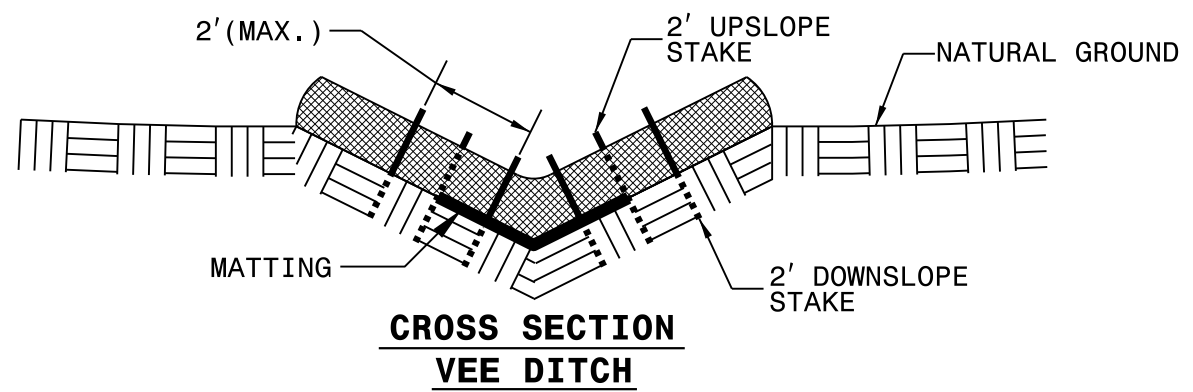
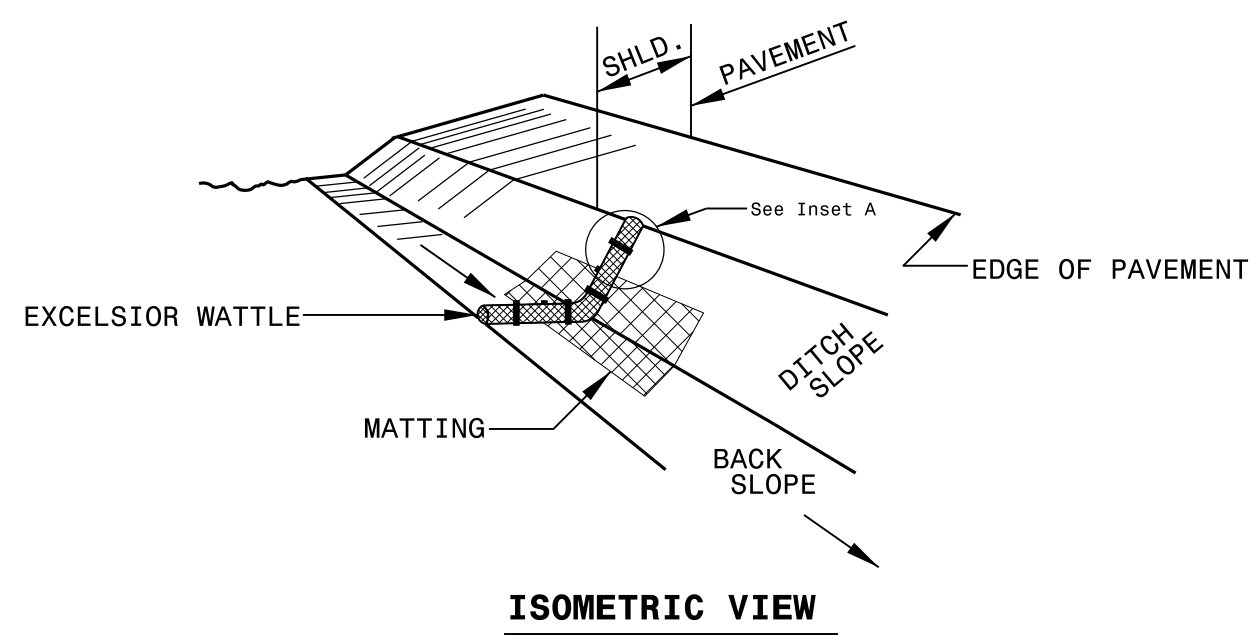

NOTES:

USE MINIMUM 12 IN. DIAMETER EXCELSIOR WATTLE.

USE 2 FT. WOODEN STAKES WITH A 2 IN. BY 2 IN. NOMINAL CROSS SECTION.

ONLY INSTALL WATTLE(S) TO A HEIGHT IN DITCH SO FLOW WILL NOT WASH AROUND WATTLE AND SCOUR DITCH SLOPES AND AS DIRECTED.

INSTALL A MINIMUM OF 2 UPSLOPE STAKES AND 4 DOWNSLOPE STAKES AT AN ANGLE TO WEDGE WATTLE TO BOTTOM OF DITCH.

PROVIDE STAPLES MADE OF 0.125 IN. DIAMETER STEEL WIRE FORMED INTO A U SHAPE NOT LESS THAN 12" IN LENGTH.

INSTALL STAPLES APPROXIMATELY EVERY 1 LINEAR FOOT ON BOTH SIDES OF WATTLE AND AT EACH END TO SECURE IT TO THE SOIL.

INSTALL MATTING IN ACCORDANCE WITH SECTION 1631 OF THE STANDARD SPECIFICATIONS.

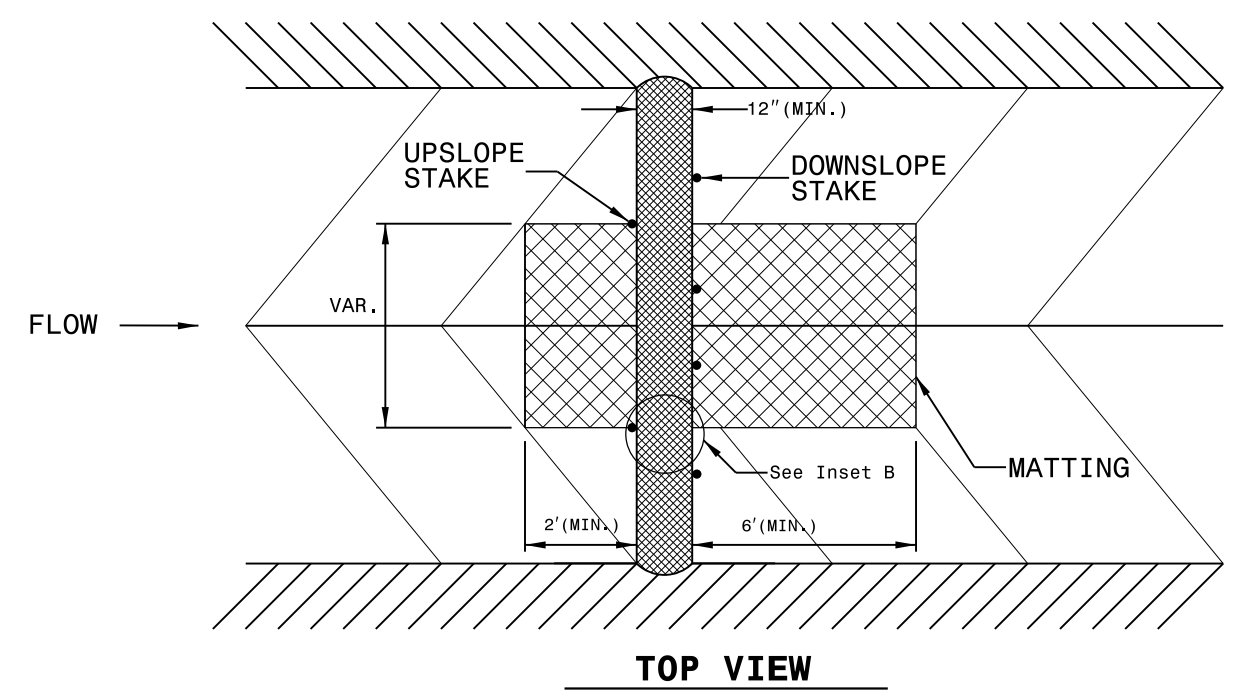
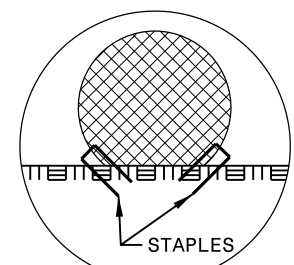
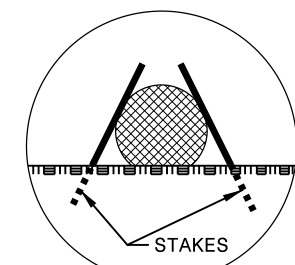

PROJECT NO.	SHEET NO.	TOTAL NO.
I-5793	8	

SUMMARY OF QUANTITIES

PROJECT NO	COUNTY	MAP NO	ROUTE	DESCRIPTION	TYP NO	LANES	LANE TYPE	FINAL SURFACE TESTING REQUIRED	WARM MIX ASPHALT REQUIRED	LENGTH	WIDTH	1106000000-E	0241000000-E	0241000000-E	1022000000-E	0234000000-E	0314000000-E	0220000000-E	1245000000-E	1297000000-E	1491000000-E	1523000000-E	1575000000-E	1840000000-E	1891000000-E	2738000000-E	2752000000-E	2762000000-E	2762000000-E	1891000000-E	0241000000-E	1881000000-E	6000000000-E	6071010000-E	6084000000-E							
												BORROW EXCAVATION	GENERIC GRADING ITEM-8" TRENCHING FOR SHOULDER CONSTRUCTION	GENERIC GRADING ITEM-7" TRENCHING FOR SHOULDER CONSTRUCTION	SEALING EXISTING PAVEMENT CRACKS	UNDERCUT EXCAVATION	SELECT MATERIAL, CLASS IV	INCIDENTAL STONE BASE	SHOULDER RECONSTRUCTION	MILLING ASPHALT PAVEMENT, 7"DEPTH	BASE COURSE, 625.0C	SURFACE COURSE, 59.5C	ASPHALT BINDER FOR PLANT MIX	MILLED RUMBLE STRIPS (ASPHALT SHOULDER)	REPAIR OF JOINTED CONCRETE PAVEMENT SLABS	GENERIC PAVING ITEM- ROLLER COMPACTED CONCRETE	GENERIC PAVING ITEM- MILLED RUMBLE STRIPS (CONCRETE SHOULDER)	PAVEMENT SLAB STABILIZATION MATERIAL	SEALING EXISTING PAVEMENT CRACKS (POLYMER PATCH)	GENERIC PAVING ITEM- DIAMOND GRINDING PCC	GEOTEXTILE FOR SOIL STABILIZATION	GENERIC PAVING ITEM- JOINT CONSTRUCTION, REPAIR, AND SEALING	TEMPORARY SILT FENCE	WATTLE	SEEDING AND MULCHING							
												MI	FT	CY	SY	SY	LB	CY	TON	TONS	SMI	SY	TONS	TONS	TONS	LF	SY	SY	LF	LBS	LB	SY	SY	LF	LF	LF	AC					
I-5793	Davidson	1	NORTH BOUND I-85	FROM PAVEMENT JT JUST NORTH OF US 64 TO BRIDGE # 479 OVER NC 109 (INCLUDES MERGE/EXIT LANES AT RAMPS TO/FROM GRASS GORES)	1	3	MU	NO	NO	6.63	36	445	36,908	15,559	17,500	500	250	250	13.34	15,559	6,176	1,534	362	35,008	433.00	36,908	36,084	10,500	125	184,552	2,500	295,284	1,482	148	0.5							
TOTAL FOR MAP NO. 1												6.63		445	36,908	15,559	17,500	500	250	250	13.34	15,559	6,176	1,534	362	35,008	433.00	36,908	36,084	10,500	125	184,552	2,500	295,284	1,482	148	0.5					
I-5793	Davidson	2	SOUTH BOUND I-85	FROM BRIDGE # 479 OVER NC 109 TO PAVEMENT JT JUST NORTH OF US 64 (INCLUDES MERGE/EXIT LANES AT RAMPS TO/FROM GRASS GORES)	1	3	MU	NO	NO	6.769	36	449	37,940	15,884	17,500	500	250	250	13.67		6,348	1,577	372	35,738	433.00	37,940	36,453	10,500	125	189,757	2,500	303,612	1,498	150	0.5							
TOTAL FOR MAP NO. 2												6.769		449	37,940	15,884	17,500	500	250	250	13.67		6,348	1,577	372	35,738	433.00	37,940	36,453	10,500	125	189,757	2,500	303,612	1,498	150	0.5					
TOTAL FOR PROJ NO. I-5793														894	74,848	31,443	35,000	1,000	500	500	27.01	15,559	12,524	3,111	734	70,746	866.00	74,848	72,537	21,000	250		374,309	5,000	598,896	2,980	298	1.0				
GRAND TOTAL												13.399		894	74,848	31,443	35,000	1,000	500	500	27.01	15,559	12,524	3,111	734	70,746	866.00	74,848	72,537	21,000	250		374,309	5,000	598,896	2,980	298	1.0				

THERMOPLASTIC AND PAINT QUANTITIES

PROJECT NO	COUNTY	MAP NO	ROUTE	DESCRIPTION	TYP NO	LANES	LANE TYPE	LENGTH	WIDTH	1600000000-N	4400000000-E	4405000000-E	4410000000-E	4415000000-N	4420000000-N	4422000000-N	4430000000-N	4445000000-E	4480000000-N	4510000000-N	4805000000-N	4815000000-E			4845000000-N	4847100000-E		4847120000-E	4855000000-E	4865000000-E	4905000000-N	4875000000-N	5255000000-N			
										SEQUENTIAL FLASHING WARNING LIGHTS	WORK ZONE PRESENCE LIGHTING	DIGITAL SPEED LIMIT SIGNS	WORK ZONE SIGNS (STATIONARY)	WORK ZONE SIGNS (PORTABLE)	BARRICADE MOUNTED WORK ZONE SIGN	FLASHING ARROW BOARD	PORTABLE CHANGEABLE MESSAGE SIGN	PORTABLE CHANGEABLE MESSAGE SIGN (SHORT TERM)	DRUMS	BARRICADES (TYPE III)	TMA	LAW ENFORCEMENT	COLD APPLIED PLASTIC PAVEMENT MARKING SYMBOL, TYPE 2 MERGE ARROW	6" YELLOW PAINT	6" WHITE PAINT	12" WHITE PAINT	PAINT MERGE ARROWS	6" WHITE POLYUREA (20 mils)	6" YELLOW POLYUREA (20 mils)	12" WHITE POLYUREA (20 mils)	6" LINE REMOVAL	12" LINE REMOVAL	SNOW PLOWABLE MARKERS	REMOVAL OF PAVEMENT MARKING SYMBOLS & CHARACTERS	PORTABLE LIGHTING	
									EA	EA	EA	SF	SF	SF	EA	EA	DAY	EA	LF	EA	HR	EA	LF	LF	LF	EA	EA	EA	EA	EA	EA	LS				
I-5793	Davidson	1	NORTH BOUND I-85	FROM PAVEMENT JT JUST NORTH OF US 64 TO BRIDGE # 479 OVER NC 109 (INCLUDES MERGE/EXIT LANES AT RAMPS TO/FROM GRASS GORES)	1	3	MU	6.63	36	21	8	3	175	350	13	2	2	30	181	32	2	235	4	36,062	54,665	4,198	4	54,665	36,062	4,198	90,727	4,198	1,268	4	1	
TOTAL FOR MAP NO. 1									6.63		21	8	3	175	350	13	2	2	30	181	32	2	235	4	36,062	54,665	4,198	4	54,665	36,062	4,198	90,727	4,198	1,268	4	1
I-5793	Davidson	2	SOUTH BOUND I-85	FROM BRIDGE # 479 OVER NC 109 TO PAVEMENT JT JUST NORTH OF US 64 (INCLUDES MERGE/EXIT LANES AT RAMPS TO/FROM GRASS GORES)	1	3	MU	6.769	36	21	7	2	175	350	13	1	1	30	181	32	2	235	6	36,538	55,499	5,024	6	55,499	36,538	5,024	92,037	5,024	1,297	6	1	
TOTAL FOR MAP NO. 2									6.769		21	7	2	175	350	13	1	1	30	181	32	2	235	6	36,538	55,499	5,024	6	55,499	36,538	5,024	92,037	5,024	1,297	6	1
TOTAL FOR PROJ NO. I-5793									13.399		42	15	5	350	700	26	3	3	60	362	64	4	470	10	72,600	110,164	9,222	10	110,164	72,600	9,222	182,764	9,222	2,565	10	1
GRAND TOTAL									13.399		42	15	5	350	700	26	3	3	60	362	64	4	470	10	72,600	110,164	9,222	10	110,164	72,600	9,222	182,764	9,222	2,565	10	1