

SIGNAL FACE	PHASE							
	01+5	01+6	02+5	02+6	03+7	03+8	04+7	04+8
11	←	←	←	←	←	←	←	←
21	R	R	G	G	R	R	R	Y
22	R	R	G	G	R	R	R	Y
31	←	←	←	←	←	←	←	←
41, 42	R	R	R	R	R	R	G	G
51	←	←	←	←	←	←	←	←
61, 62, 63	R	G	R	G	R	R	R	Y
71	←	←	←	←	←	←	←	←
81	R	R	R	R	R	G	R	G
82, 83	R	R	R	R	R	G	R	G

SIGNAL FACE I.D.
All Heads L.E.D.

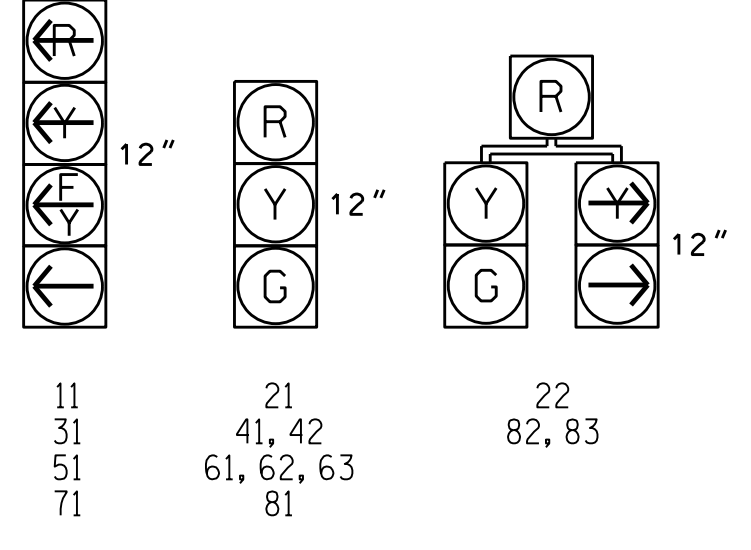

ASC/3 DETECTOR INSTALLATION CHART											
DETECTOR				PROGRAMMING							
LOOP	SIZE (FT)	DISTANCE FROM STOPBAR (FT)	TURNS	NEW LOOP	PHASE	CALLING	EXTEND TIME	DELAY TIME	TYPE	SYSTEM LOOP	NEW CARD
1A*	6X40	0	*	Y	1	Yes	-	15	S	-	Y
1B	6X40	0	2-4-2	Y	1	Yes	-	15	S	-	Y
1C	6X40	0	2-4-2	Y	1	Yes	-	15	S	-	Y
2A	6X6	300	EXIST	-	2	Yes	-	-	S	-	Y
2B	6X6	300	EXIST	-	2	Yes	-	-	S	-	Y
3A	6X40	0	2-4-2	Y	3	Yes	-	15	S	-	Y
4A	6X40	0	2-4-2	-	4	Yes	-	10	S	-	Y
5A	6X60	0	2-4-2	-	2	Yes	-	3	G	-	Y
6A*	6X6	300	*	Y	6	Yes	-	-	S	-	Y
6B*	6X6	300	*	Y	6	Yes	-	-	S	-	Y
6C*	6X6	300	*	Y	6	Yes	-	-	S	-	Y
6D*	6X40	0	*	Y	6	Yes	2.0	5	G	-	Y
6E*	6X40	0	*	Y	6	Yes	2.0	5	G	-	Y
6F*	6X40	0	*	Y	6	Yes	2.0	5	G	-	Y
7A	6X40	0	2-4-2	-	7	Yes	-	15	S	-	Y
8A	6X40	0	2-4-2	Y	8	Yes	-	-	S	-	Y

8 Phase Fully Actuated Concord Mills Blvd. CLS

- NOTES**
- Refer to "Roadway Standard Drawings NCDOT" dated January 2012 and "Standard Specifications for Roads and Structures" dated January 2012.
 - Do not program signal for late night flashing operation unless otherwise directed by the Engineer.
 - Install new 2070E Controller in new cabinet.
 - Phase 1 and/or phase 5 may be lagged.
 - Phase 3 and/or phase 7 may be lagged.
 - Set all detector units to presence mode.
 - In the event of loop replacement, refer to the current ITS and Signals Design Manual and submit a Plan of Record to the Signal Design Section.
 - Locate new cabinet so as not to obstruct sight distance of vehicles turning right on red.
 - Pavement markings are existing.
 - Maximum times shown in timing chart are for free-run operation only. Coordinated signal system timing values supersede these values.
 - Closed loop system data: Controller Asset #: 1733

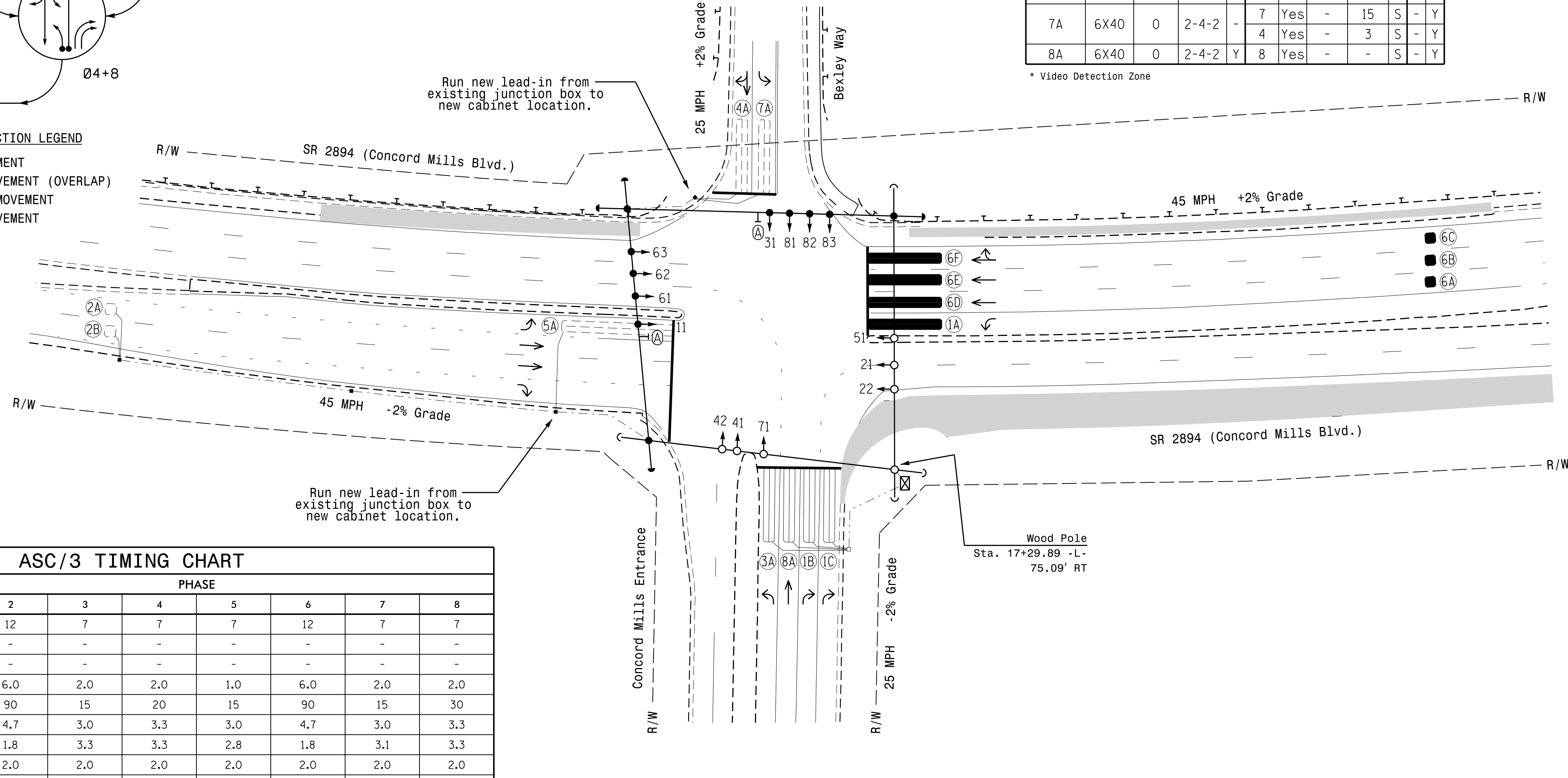
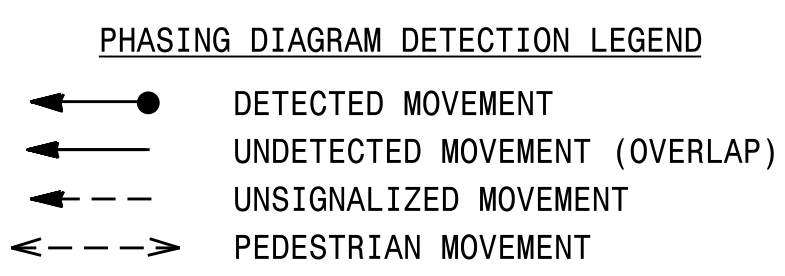

FEATURE	ASC/3 TIMING CHART							
	1	2	3	4	5	6	7	8
Min Green *	7	12	7	7	7	12	7	7
Walk *	-	-	-	-	-	-	-	-
Ped Clear	-	-	-	-	-	-	-	-
Veh. Extension *	2.0	6.0	2.0	2.0	1.0	6.0	2.0	2.0
Max I *	30	90	15	20	15	90	15	30
Yellow	3.0	4.7	3.0	3.3	3.0	4.7	3.0	3.3
Red Clear	3.1	1.8	3.3	3.3	2.8	1.8	3.1	3.3
Red Revert	2.0	2.0	2.0	2.0	2.0	2.0	2.0	2.0
Actuations B4 Add *	-	-	-	-	-	-	-	-
Seconds / Actuation *	-	1.5	-	-	-	-	-	-
Max Initial *	-	34	-	-	-	-	-	-
Time Before Reduction *	-	15	-	-	-	15	-	-
Time To Reduce *	-	45	-	-	-	45	-	-
Minimum Gap	-	3.0	-	-	-	3.0	-	-
Locking Detector	-	X	-	-	-	X	-	-
Recall Position	-	VEH. RECALL	-	-	-	VEH. RECALL	-	-
Dual Entry	-	-	-	X	-	-	-	X
Simultaneous Gap	X	X	X	X	X	X	X	X

* These values may be field adjusted. Do not adjust Min Green and Extension times for phases 2 and 6 lower than what is shown. Min Green for all other phases should not be lower than 4 seconds.

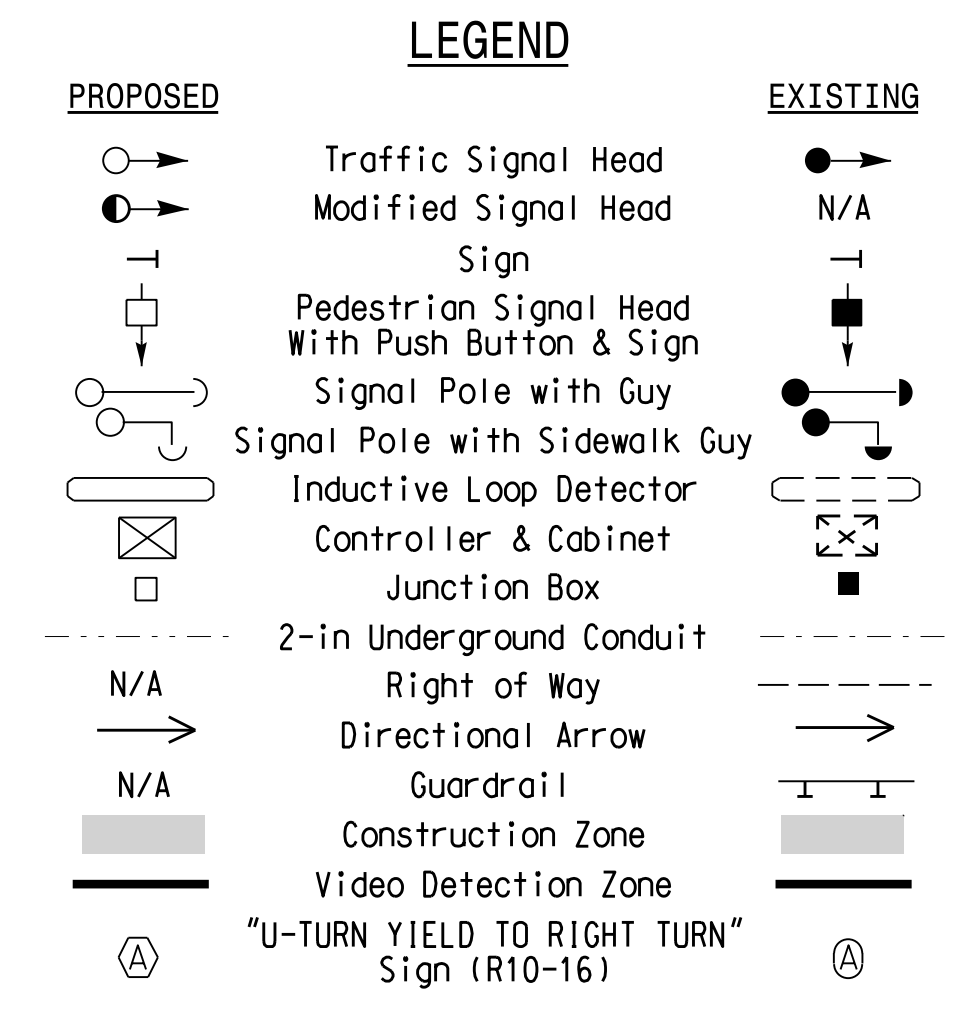

Signal Upgrade - Temporary Design 1 - Phase I

Prepared in the Offices of:

750 N. Greenfield Pkwy, Garner, NC 27529

SR 2894 (Concord Mills Blvd.)
at
Concord Mills Entrance/
Bexley Way

Divison 10 Cabarrus County Concord

PLAN DATE: August 2017 REVIEWED BY: T.J. Williams
PREPARED BY: R.N. Zinser REVIEWED BY:

DOCUMENT NOT CONSIDERED FINAL UNLESS ALL SIGNATURES COMPLETED

SEAL

DATE: 9/25/2017