

REFERENCE: U-4751

PROJECT: 40191

STATE OF NORTH CAROLINA
DEPARTMENT OF TRANSPORTATION
DIVISION OF HIGHWAYS
GEOTECHNICAL ENGINEERING UNIT

STRUCTURE
SUBSURFACE INVESTIGATION

COUNTY NEW HANOVER
PROJECT DESCRIPTION SR 1409 (MILITARY CUTOFF RD. EXTENSION) FROM SR 1409 (MILITARY CUTOFF RD.) TO US 17 IN WILMINGTON
SITE DESCRIPTION RETAINING WALL 2 LEFT OF -L- STA. 30+00

CONTENTS

<u>SHEET NO.</u>	<u>DESCRIPTION</u>
1	TITLE SHEET
2	LEGEND
3	SITE PLAN
4	WALL ENVELOPE

STATE	STATE PROJECT REFERENCE NO.	SHEET NO.	TOTAL SHEETS
N.C.	U-4751	1	4

CAUTION NOTICE

THE SUBSURFACE INFORMATION AND THE SUBSURFACE INVESTIGATION ON WHICH IT IS BASED WERE MADE FOR THE PURPOSE OF STUDY, PLANNING AND DESIGN, AND NOT FOR CONSTRUCTION OR PAY PURPOSES. THE VARIOUS FIELD BORING LOGS, ROCK CORES AND SOIL TEST DATA AVAILABLE MAY BE REVIEWED OR INSPECTED IN RALEIGH BY CONTACTING THE N. C. DEPARTMENT OF TRANSPORTATION, GEOTECHNICAL ENGINEERING UNIT AT (919) 707-6850. THE SUBSURFACE PLANS AND REPORTS, FIELD BORING LOGS, ROCK CORES AND SOIL TEST DATA ARE NOT PART OF THE CONTRACT.

GENERAL SOIL AND ROCK STRATA DESCRIPTIONS AND INDICATED BOUNDARIES ARE BASED ON A GEOTECHNICAL INTERPRETATION OF ALL AVAILABLE SUBSURFACE DATA AND MAY NOT NECESSARILY REFLECT THE ACTUAL SUBSURFACE CONDITIONS BETWEEN BORINGS OR BETWEEN SAMPLED STRATA WITHIN THE BOREHOLE. THE LABORATORY SAMPLE DATA AND THE IN SITU (IN-PLACE) TEST DATA CAN BE RELIED ON ONLY TO THE DEGREE OF RELIABILITY INHERENT IN THE STANDARD TEST METHOD. THE OBSERVED WATER LEVELS OR SOIL MOISTURE CONDITIONS INDICATED IN THE SUBSURFACE INVESTIGATIONS ARE AS RECORDED AT THE TIME OF THE INVESTIGATION. THESE WATER LEVELS OR SOIL MOISTURE CONDITIONS MAY VARY CONSIDERABLY WITH TIME ACCORDING TO CLIMATIC CONDITIONS INCLUDING TEMPERATURES, PRECIPITATION AND WIND, AS WELL AS OTHER NON-CLIMATIC FACTORS.

THE BIDDER OR CONTRACTOR IS CAUTIONED THAT DETAILS SHOWN ON THE SUBSURFACE PLANS ARE PRELIMINARY ONLY AND IN MANY CASES THE FINAL DESIGN DETAILS ARE DIFFERENT. FOR BIDDING AND CONSTRUCTION PURPOSES, REFER TO THE CONSTRUCTION PLANS AND DOCUMENTS FOR FINAL DESIGN INFORMATION ON THIS PROJECT. THE DEPARTMENT DOES NOT WARRANT OR GUARANTEE THE SUFFICIENCY OR ACCURACY OF THE INVESTIGATION MADE, NOR THE INTERPRETATIONS MADE, OR OPINION OF THE DEPARTMENT AS TO THE TYPE OF MATERIALS AND CONDITIONS TO BE ENCOUNTERED. THE BIDDER OR CONTRACTOR IS CAUTIONED TO MAKE SUCH INDEPENDENT SUBSURFACE INVESTIGATIONS AS HE DEEMS NECESSARY TO SATISFY HIMSELF AS TO CONDITIONS TO BE ENCOUNTERED ON THE PROJECT. THE CONTRACTOR SHALL HAVE NO CLAIM FOR ADDITIONAL COMPENSATION OR FOR AN EXTENSION OF TIME FOR ANY REASON RESULTING FROM THE ACTUAL CONDITIONS ENCOUNTERED AT THE SITE DIFFERING FROM THOSE INDICATED IN THE SUBSURFACE INFORMATION.

- NOTES:
1. THE INFORMATION CONTAINED HEREIN IS NOT IMPLIED OR GUARANTEED BY THE N. C. DEPARTMENT OF TRANSPORTATION AS ACCURATE NOR IS IT CONSIDERED PART OF THE PLANS, SPECIFICATIONS OR CONTRACT FOR THE PROJECT.
 2. BY HAVING REQUESTED THIS INFORMATION, THE CONTRACTOR SPECIFICALLY WAIVES ANY CLAIMS FOR INCREASED COMPENSATION OR EXTENSION OF TIME BASED ON DIFFERENCES BETWEEN THE CONDITIONS INDICATED HEREIN AND THE ACTUAL CONDITIONS AT THE PROJECT SITE.

PERSONNEL

C.M. WRIKE

CATLIN PERSONNEL

MID ATLANTIC PER.

INVESTIGATED BY J.L. STONE

DRAWN BY J.L. STONE

CHECKED BY D.N. ARGENBRIGHT

SUBMITTED BY D.N. ARGENBRIGHT

DATE MARCH 2015



DocuSigned by:
Tyler C. Bottoms 6/5/2017
48A2D9BD08CF446 SIGNATURE DATE

**NORTH CAROLINA DEPARTMENT OF TRANSPORTATION
DIVISION OF HIGHWAYS
GEOTECHNICAL ENGINEERING UNIT**

SUBSURFACE INVESTIGATION

SOIL AND ROCK LEGEND, TERMS, SYMBOLS, AND ABBREVIATIONS

SOIL DESCRIPTION										GRADATION										ROCK DESCRIPTION										TERMS AND DEFINITIONS																																																																																																																																																																	
<p>SOIL IS CONSIDERED UNCONSOLIDATED, SEMI-CONSOLIDATED, OR WEATHERED EARTH MATERIALS THAT CAN BE PENETRATED WITH A CONTINUOUS FLIGHT POWER AUGER AND YIELD LESS THAN 100 BLOWS PER FOOT ACCORDING TO THE STANDARD PENETRATION TEST (ASTM T 206, ASTM D1586). SOIL CLASSIFICATION IS BASED ON THE AASHTO SYSTEM. BASIC DESCRIPTIONS GENERALLY INCLUDE THE FOLLOWING: CONSISTENCY, COLOR, TEXTURE, MOISTURE, AASHTO CLASSIFICATION, AND OTHER PERTINENT FACTORS SUCH AS MINERALOGICAL COMPOSITION, ANGULARITY, STRUCTURE, PLASTICITY, ETC. FOR EXAMPLE, <i>VERY STIFF, GRAY, SILTY CLAY, MOIST WITH INTERBEDDED FINE SAND LAYERS, HIGHLY PLASTIC, A-7-6</i></p>										<p>WELL GRADED - INDICATES A GOOD REPRESENTATION OF PARTICLE SIZES FROM FINE TO COARSE. UNIFORMLY GRADED - INDICATES THAT SOIL PARTICLES ARE ALL APPROXIMATELY THE SAME SIZE. GAP-GRADED - INDICATES A MIXTURE OF UNIFORM PARTICLE SIZES OF TWO OR MORE SIZES.</p>										<p>HARD ROCK IS NON-COASTAL PLAIN MATERIAL THAT WOULD YIELD SPT REFUSAL IF TESTED, AN INFERRED ROCK LINE INDICATES THE LEVEL AT WHICH NON-COASTAL PLAIN MATERIAL WOULD YIELD SPT REFUSAL. SPT REFUSAL IS PENETRATION BY A SPLIT SPOON SAMPLER EQUAL TO OR LESS THAN 0.1 FOOT PER 60 BLOWS IN NON-COASTAL PLAIN MATERIAL. THE TRANSITION BETWEEN SOIL AND ROCK IS OFTEN REPRESENTED BY A ZONE OF WEATHERED ROCK. ROCK MATERIALS ARE TYPICALLY DIVIDED AS FOLLOWS:</p>										<p>ALLUVIUM (ALLUV.) - SOILS THAT HAVE BEEN TRANSPORTED BY WATER. AQUIFER - A WATER BEARING FORMATION OR STRATA. ARENACEOUS - APPLIED TO ROCKS THAT HAVE BEEN DERIVED FROM SAND OR THAT CONTAIN SAND. ARGILLACEOUS - APPLIED TO ALL ROCKS OR SUBSTANCES COMPOSED OF CLAY MINERALS, OR HAVING A NOTABLE PROPORTION OF CLAY IN THEIR COMPOSITION, SUCH AS SHALE, SLATE, ETC. ARTESIAN - GROUND WATER THAT IS UNDER SUFFICIENT PRESSURE TO RISE ABOVE THE LEVEL AT WHICH IT IS ENCOUNTERED, BUT WHICH DOES NOT NECESSARILY RISE TO OR ABOVE THE GROUND SURFACE. CALCAREOUS (CALC.) - SOILS THAT CONTAIN APPRECIABLE AMOUNTS OF CALCIUM CARBONATE. COLLUVIUM - ROCK FRAGMENTS MIXED WITH SOIL DEPOSITED BY GRAVITY ON SLOPE OR AT BOTTOM OF SLOPE. CORE RECOVERY (REC.) - TOTAL LENGTH OF ALL MATERIAL RECOVERED IN THE CORE BARREL DIVIDED BY TOTAL LENGTH OF CORE RUN AND EXPRESSED AS A PERCENTAGE. DIKE - A TABULAR BODY OF IGNEOUS ROCK THAT CUTS ACROSS THE STRUCTURE OF ADJACENT ROCKS OR CUTS MASSIVE ROCK. DIP - THE ANGLE AT WHICH A STRATUM OR ANY PLANAR FEATURE IS INCLINED FROM THE HORIZONTAL. DIP DIRECTION (DIP AZIMUTH) - THE DIRECTION OR BEARING OF THE HORIZONTAL TRACE OF THE LINE OF DIP, MEASURED CLOCKWISE FROM NORTH. FAULT - A FRACTURE OR FRACTURE ZONE ALONG WHICH THERE HAS BEEN DISPLACEMENT OF THE SIDES RELATIVE TO ONE ANOTHER PARALLEL TO THE FRACTURE. FISSILE - A PROPERTY OF SPLITTING ALONG CLOSELY SPACED PARALLEL PLANES. FLOAT - ROCK FRAGMENTS ON SURFACE NEAR THEIR ORIGINAL POSITION AND DISLOGGED FROM PARENT MATERIAL. FLOOD PLAIN (FP) - LAND BORDERING A STREAM, BUILT OF SEDIMENTS DEPOSITED BY THE STREAM. FORMATION (FM) - A MAPPABLE GEOLOGIC UNIT THAT CAN BE RECOGNIZED AND TRACED IN THE FIELD. JOINT - FRACTURE IN ROCK ALONG WHICH NO APPRECIABLE MOVEMENT HAS OCCURRED. LEDGE - A SHELF-LIKE RIDGE OR PROJECTION OF ROCK WHOSE THICKNESS IS SMALL COMPARED TO ITS LATERAL EXTENT. LENS - A BODY OF SOIL OR ROCK THAT THINS OUT IN ONE OR MORE DIRECTIONS. MOTTLED (MOT.) - IRREGULARLY MARKED WITH SPOTS OF DIFFERENT COLORS. MOTTLING IN SOILS USUALLY INDICATES POOR AERATION AND LACK OF GOOD DRAINAGE. PERCHED WATER - WATER MAINTAINED ABOVE THE NORMAL GROUND WATER LEVEL BY THE PRESENCE OF AN INTERVENING IMPERVIOUS STRATUM. RESIDUAL (RES.) SOIL - SOIL FORMED IN PLACE BY THE WEATHERING OF ROCK. ROCK QUALITY DESIGNATION (ROD) - A MEASURE OF ROCK QUALITY DESCRIBED BY TOTAL LENGTH OF ROCK SEGMENTS EQUAL TO OR GREATER THAN 4 INCHES DIVIDED BY THE TOTAL LENGTH OF CORE RUN AND EXPRESSED AS A PERCENTAGE. SAPROLITE (SAP.) - RESIDUAL SOIL THAT RETAINS THE RELIC STRUCTURE OR FABRIC OF THE PARENT ROCK. SILL - AN INTRUSIVE BODY OF IGNEOUS ROCK OF APPROXIMATELY UNIFORM THICKNESS AND RELATIVELY THIN COMPARED WITH ITS LATERAL EXTENT, THAT HAS BEEN EMPLACED PARALLEL TO THE BEDDING OR SCHISTOSITY OF THE INTRUDED ROCKS. SLICKENSIDE - POLISHED AND STRIATED SURFACE THAT RESULTS FROM FRICTION ALONG A FAULT OR SLIP PLANE. STANDARD PENETRATION TEST (PENETRATION RESISTANCE) (SPT) - NUMBER OF BLOWS (N OR BPF) OF A 140 LB. HAMMER FALLING 30 INCHES REQUIRED TO PRODUCE A PENETRATION OF 1 FOOT INTO SOIL WITH A 2 INCH OUTSIDE DIAMETER SPLIT SPOON SAMPLER. SPT REFUSAL IS PENETRATION EQUAL TO OR LESS THAN 0.1 FOOT PER 60 BLOWS. STRATA CORE RECOVERY (SREC.) - TOTAL LENGTH OF STRATA MATERIAL RECOVERED DIVIDED BY TOTAL LENGTH OF STRATUM AND EXPRESSED AS A PERCENTAGE. STRATA ROCK QUALITY DESIGNATION (SROD) - A MEASURE OF ROCK QUALITY DESCRIBED BY TOTAL LENGTH OF ROCK SEGMENTS WITHIN A STRATUM EQUAL TO OR GREATER THAN 4 INCHES DIVIDED BY THE TOTAL LENGTH OF STRATA AND EXPRESSED AS A PERCENTAGE. TOPSOIL (TS.) - SURFACE SOILS USUALLY CONTAINING ORGANIC MATTER.</p>																																																																																																																																																																	
<p style="text-align: center;">SOIL LEGEND AND AASHTO CLASSIFICATION</p> <table border="1" style="width: 100%; border-collapse: collapse;"> <thead> <tr> <th rowspan="2">GENERAL CLASS.</th> <th colspan="5">GRANULAR MATERIALS (≤ 35% PASSING #200)</th> <th colspan="5">SILT-CLAY MATERIALS (> 35% PASSING #200)</th> <th colspan="5">ORGANIC MATERIALS</th> </tr> <tr> <th>A-1</th> <th>A-1-a</th> <th>A-1-b</th> <th>A-2</th> <th>A-2-4</th> <th>A-2-5</th> <th>A-2-6</th> <th>A-2-7</th> <th>A-4</th> <th>A-5</th> <th>A-6</th> <th>A-7</th> <th>A-1, A-2</th> <th>A-3</th> <th>A-4, A-5</th> <th>A-6, A-7</th> </tr> </thead> <tbody> <tr> <td>GROUP CLASS.</td> <td>A-1-a</td> <td>A-1-b</td> <td>A-2</td> <td>A-2-4</td> <td>A-2-5</td> <td>A-2-6</td> <td>A-2-7</td> <td>A-4</td> <td>A-5</td> <td>A-6</td> <td>A-7</td> <td>A-1, A-2</td> <td>A-3</td> <td>A-4, A-5</td> <td>A-6, A-7</td> </tr> <tr> <td>SYMBOL</td> <td></td> <td></td> <td></td> <td></td> <td></td> <td></td> <td></td> <td></td> <td></td> <td></td> <td></td> <td></td> <td></td> <td></td> <td></td> </tr> <tr> <td>% PASSING #10 #40 #200</td> <td>50 MX 30 MX 15 MX</td> <td>50 MX 25 MX</td> <td>51 MN 10 MX 35 MX</td> <td>35 MX 35 MX</td> <td>35 MX 35 MX</td> <td>35 MX 35 MX</td> <td>35 MX 35 MX</td> <td>36 MN 36 MN</td> <td>36 MN 36 MN</td> <td>36 MN 36 MN</td> <td>36 MN 36 MN</td> <td>GRANULAR SOILS</td> <td>SILT-CLAY SOILS</td> <td>MUCK, PEAT</td> <td></td> </tr> <tr> <td>MATERIAL PASSING #40 LL PI</td> <td>-</td> <td>-</td> <td>40 MX 41 MN</td> <td>40 MX 41 MN</td> <td>40 MX 41 MN</td> <td>40 MX 41 MN</td> <td>40 MX 41 MN</td> <td>40 MX 41 MN</td> <td>40 MX 41 MN</td> <td>40 MX 41 MN</td> <td>40 MX 41 MN</td> <td>SOILS WITH LITTLE OR MODERATE AMOUNTS OF ORGANIC MATTER</td> <td>HIGHLY ORGANIC SOILS</td> <td></td> <td></td> </tr> <tr> <td>GROUP INDEX</td> <td>0</td> <td>0</td> <td>0</td> <td>0</td> <td>0</td> <td>0</td> <td>0</td> <td>0</td> <td>0</td> <td>0</td> <td>0</td> <td></td> <td></td> <td></td> <td></td> </tr> <tr> <td>USUAL TYPES OF MAJOR MATERIALS</td> <td>STONE FRAGS. GRAVEL, AND SAND</td> <td>FINE SAND</td> <td>SILTY OR CLAYEY GRAVEL AND SAND</td> <td>SILTY SOILS</td> <td>CLAYEY SOILS</td> <td></td> <td></td> <td></td> <td></td> <td></td> <td></td> <td></td> <td></td> <td></td> <td></td> </tr> <tr> <td>GEN. RATING AS SUBGRADE</td> <td colspan="5">EXCELLENT TO GOOD</td> <td colspan="5">FAIR TO POOR</td> <td>FAIR TO POOR</td> <td>POOR</td> <td>UNSATURABLE</td> </tr> <tr> <td colspan="10">PI OF A-7-5 SUBGROUP IS ≤ LL - 30 ; PI OF A-7-6 SUBGROUP IS > LL - 30</td> <td colspan="10"></td> </tr> </tbody> </table>										GENERAL CLASS.	GRANULAR MATERIALS (≤ 35% PASSING #200)					SILT-CLAY MATERIALS (> 35% PASSING #200)					ORGANIC MATERIALS					A-1	A-1-a	A-1-b	A-2	A-2-4	A-2-5	A-2-6	A-2-7	A-4	A-5	A-6	A-7	A-1, A-2	A-3	A-4, A-5	A-6, A-7	GROUP CLASS.	A-1-a	A-1-b	A-2	A-2-4	A-2-5	A-2-6	A-2-7	A-4	A-5	A-6	A-7	A-1, A-2	A-3	A-4, A-5	A-6, A-7	SYMBOL																% PASSING #10 #40 #200	50 MX 30 MX 15 MX	50 MX 25 MX	51 MN 10 MX 35 MX	35 MX 35 MX	35 MX 35 MX	35 MX 35 MX	35 MX 35 MX	36 MN 36 MN	36 MN 36 MN	36 MN 36 MN	36 MN 36 MN	GRANULAR SOILS	SILT-CLAY SOILS	MUCK, PEAT		MATERIAL PASSING #40 LL PI	-	-	40 MX 41 MN	40 MX 41 MN	40 MX 41 MN	40 MX 41 MN	40 MX 41 MN	40 MX 41 MN	40 MX 41 MN	40 MX 41 MN	40 MX 41 MN	SOILS WITH LITTLE OR MODERATE AMOUNTS OF ORGANIC MATTER	HIGHLY ORGANIC SOILS			GROUP INDEX	0	0	0	0	0	0	0	0	0	0	0					USUAL TYPES OF MAJOR MATERIALS	STONE FRAGS. GRAVEL, AND SAND	FINE SAND	SILTY OR CLAYEY GRAVEL AND SAND	SILTY SOILS	CLAYEY SOILS											GEN. RATING AS SUBGRADE	EXCELLENT TO GOOD					FAIR TO POOR					FAIR TO POOR	POOR	UNSATURABLE	PI OF A-7-5 SUBGROUP IS ≤ LL - 30 ; PI OF A-7-6 SUBGROUP IS > LL - 30																				<p style="text-align: center;">MINERALOGICAL COMPOSITION</p> <p>MINERAL NAMES SUCH AS QUARTZ, FELDSPAR, MICA, TALC, KAOLIN, ETC. ARE USED IN DESCRIPTIONS WHEN THEY ARE CONSIDERED OF SIGNIFICANCE.</p>										<p style="text-align: center;">WEATHERING</p> <p>FRESH: ROCK FRESH, CRYSTALS BRIGHT, FEW JOINTS MAY SHOW SLIGHT STAINING. ROCK RINGS UNDER HAMMER IF CRYSTALLINE.</p> <p>VERY SLIGHT (V SL.): ROCK GENERALLY FRESH, JOINTS STAINED, SOME JOINTS MAY SHOW THIN CLAY COATINGS IF OPEN. CRYSTALS ON A BROKEN SPECIMEN FACE SHINE BRIGHTLY. ROCK RINGS UNDER HAMMER BLOWS IF OF A CRYSTALLINE NATURE.</p> <p>SLIGHT (SL.): ROCK GENERALLY FRESH, JOINTS STAINED AND DISCOLORATION EXTENDS INTO ROCK UP TO 1 INCH. OPEN JOINTS MAY CONTAIN CLAY. IN GRANITOID ROCKS SOME OCCASIONAL FELDSPAR CRYSTALS ARE DULL AND DISCOLORED. CRYSTALLINE ROCKS RING UNDER HAMMER BLOWS.</p> <p>MODERATE (MOD.): SIGNIFICANT PORTIONS OF ROCK SHOW DISCOLORATION AND WEATHERING EFFECTS. IN GRANITOID ROCKS, MOST FELDSPARS ARE DULL AND DISCOLORED, SOME SHOW CLAY. ROCK HAS DULL SOUND UNDER HAMMER BLOWS AND SHOWS SIGNIFICANT LOSS OF STRENGTH AS COMPARED WITH FRESH ROCK.</p> <p>MODERATELY SEVERE (MOD. SEV.): ALL ROCK EXCEPT QUARTZ DISCOLORED OR STAINED. IN GRANITOID ROCKS, ALL FELDSPARS DULL AND DISCOLORED AND A MAJORITY SHOW KAOLINIZATION. ROCK SHOWS SEVERE LOSS OF STRENGTH AND CAN BE EXCAVATED WITH A GEOLOGIST'S PICK. ROCK GIVES "CLUNK" SOUND WHEN STRUCK. <i>IF TESTED, WOULD YIELD SPT REFUSAL</i></p> <p>SEVERE (SEV.): ALL ROCK EXCEPT QUARTZ DISCOLORED OR STAINED. ROCK FABRIC CLEAR AND EVIDENT BUT REDUCED IN STRENGTH TO STRONG SOIL. IN GRANITOID ROCKS ALL FELDSPARS ARE KAOLINIZED TO SOME EXTENT. SOME FRAGMENTS OF STRONG ROCK USUALLY REMAIN. <i>IF TESTED, WOULD YIELD SPT N VALUES > 100 BPF</i></p> <p>VERY SEVERE (V SEV.): ALL ROCK EXCEPT QUARTZ DISCOLORED OR STAINED. ROCK FABRIC ELEMENTS ARE DISCERNIBLE BUT MASS IS EFFECTIVELY REDUCED TO SOIL STATUS, WITH ONLY FRAGMENTS OF STRONG ROCK REMAINING. SAPROLITE IS AN EXAMPLE OF ROCK WEATHERED TO A DEGREE THAT ONLY MINOR VESTIGES OF ORIGINAL ROCK FABRIC REMAIN. <i>IF TESTED, WOULD YIELD SPT N VALUES < 100 BPF</i></p> <p>COMPLETE: ROCK REDUCED TO SOIL. ROCK FABRIC NOT DISCERNIBLE, OR DISCERNIBLE ONLY IN SMALL AND SCATTERED CONCENTRATIONS. QUARTZ MAY BE PRESENT AS DIKES OR STRINGERS. SAPROLITE IS ALSO AN EXAMPLE.</p>									
GENERAL CLASS.	GRANULAR MATERIALS (≤ 35% PASSING #200)					SILT-CLAY MATERIALS (> 35% PASSING #200)					ORGANIC MATERIALS																																																																																																																																																																																				
	A-1	A-1-a	A-1-b	A-2	A-2-4	A-2-5	A-2-6	A-2-7	A-4	A-5	A-6	A-7	A-1, A-2	A-3	A-4, A-5	A-6, A-7																																																																																																																																																																															
GROUP CLASS.	A-1-a	A-1-b	A-2	A-2-4	A-2-5	A-2-6	A-2-7	A-4	A-5	A-6	A-7	A-1, A-2	A-3	A-4, A-5	A-6, A-7																																																																																																																																																																																
SYMBOL																																																																																																																																																																																															
% PASSING #10 #40 #200	50 MX 30 MX 15 MX	50 MX 25 MX	51 MN 10 MX 35 MX	35 MX 35 MX	35 MX 35 MX	35 MX 35 MX	35 MX 35 MX	36 MN 36 MN	36 MN 36 MN	36 MN 36 MN	36 MN 36 MN	GRANULAR SOILS	SILT-CLAY SOILS	MUCK, PEAT																																																																																																																																																																																	
MATERIAL PASSING #40 LL PI	-	-	40 MX 41 MN	40 MX 41 MN	40 MX 41 MN	40 MX 41 MN	40 MX 41 MN	40 MX 41 MN	40 MX 41 MN	40 MX 41 MN	40 MX 41 MN	SOILS WITH LITTLE OR MODERATE AMOUNTS OF ORGANIC MATTER	HIGHLY ORGANIC SOILS																																																																																																																																																																																		
GROUP INDEX	0	0	0	0	0	0	0	0	0	0	0																																																																																																																																																																																				
USUAL TYPES OF MAJOR MATERIALS	STONE FRAGS. GRAVEL, AND SAND	FINE SAND	SILTY OR CLAYEY GRAVEL AND SAND	SILTY SOILS	CLAYEY SOILS																																																																																																																																																																																										
GEN. RATING AS SUBGRADE	EXCELLENT TO GOOD					FAIR TO POOR					FAIR TO POOR	POOR	UNSATURABLE																																																																																																																																																																																		
PI OF A-7-5 SUBGROUP IS ≤ LL - 30 ; PI OF A-7-6 SUBGROUP IS > LL - 30																																																																																																																																																																																															
<p style="text-align: center;">COMPRESSION</p> <p>SLIGHTLY COMPRESSIBLE LL < 31 MODERATELY COMPRESSIBLE LL = 31 - 50 HIGHLY COMPRESSIBLE LL > 50</p>										<p style="text-align: center;">PERCENTAGE OF MATERIAL</p> <table border="1" style="width: 100%; border-collapse: collapse;"> <thead> <tr> <th></th> <th>GRANULAR SOILS</th> <th>SILT - CLAY SOILS</th> <th>OTHER MATERIAL</th> </tr> </thead> <tbody> <tr> <td>TRACE OF ORGANIC MATTER</td> <td>2 - 3%</td> <td>3 - 5%</td> <td>TRACE 1 - 10%</td> </tr> <tr> <td>LITTLE ORGANIC MATTER</td> <td>3 - 5%</td> <td>5 - 12%</td> <td>LITTLE 10 - 20%</td> </tr> <tr> <td>MODERATELY ORGANIC</td> <td>5 - 10%</td> <td>12 - 20%</td> <td>SOME 20 - 35%</td> </tr> <tr> <td>HIGHLY ORGANIC</td> <td>> 10%</td> <td>> 20%</td> <td>HIGHLY 35% AND ABOVE</td> </tr> </tbody> </table>											GRANULAR SOILS	SILT - CLAY SOILS	OTHER MATERIAL	TRACE OF ORGANIC MATTER	2 - 3%	3 - 5%	TRACE 1 - 10%	LITTLE ORGANIC MATTER	3 - 5%	5 - 12%	LITTLE 10 - 20%	MODERATELY ORGANIC	5 - 10%	12 - 20%	SOME 20 - 35%	HIGHLY ORGANIC	> 10%	> 20%	HIGHLY 35% AND ABOVE																																																																																																																																																								
	GRANULAR SOILS	SILT - CLAY SOILS	OTHER MATERIAL																																																																																																																																																																																												
TRACE OF ORGANIC MATTER	2 - 3%	3 - 5%	TRACE 1 - 10%																																																																																																																																																																																												
LITTLE ORGANIC MATTER	3 - 5%	5 - 12%	LITTLE 10 - 20%																																																																																																																																																																																												
MODERATELY ORGANIC	5 - 10%	12 - 20%	SOME 20 - 35%																																																																																																																																																																																												
HIGHLY ORGANIC	> 10%	> 20%	HIGHLY 35% AND ABOVE																																																																																																																																																																																												
<p style="text-align: center;">GROUND WATER</p> <p> WATER LEVEL IN BORE HOLE IMMEDIATELY AFTER DRILLING</p> <p> STATIC WATER LEVEL AFTER 24 HOURS</p> <p> PERCHED WATER, SATURATED ZONE, OR WATER BEARING STRATA</p> <p> SPRING OR SEEP</p>										<p style="text-align: center;">MISCELLANEOUS SYMBOLS</p> <p> ROADWAY EMBANKMENT (RE) WITH SOIL DESCRIPTION</p> <p> SOIL SYMBOL</p> <p> ARTIFICIAL FILL (AF) OTHER THAN ROADWAY EMBANKMENT</p> <p> INFERRED SOIL BOUNDARY</p> <p> INFERRED ROCK LINE</p> <p> ALLUVIAL SOIL BOUNDARY</p> <p> DIP & DIP DIRECTION OF ROCK STRUCTURES</p> <p> TEST BORING</p> <p> AUGER BORING</p> <p> CORE BORING</p> <p> MONITORING WELL</p> <p> PIEZOMETER INSTALLATION</p> <p> SLOPE INDICATOR INSTALLATION</p> <p> CONE PENETROMETER TEST</p> <p> SOUNDING ROD</p> <p> TEST BORING WITH CORE</p> <p> SPT N-VALUE</p>																																																																																																																																																																																					
<p style="text-align: center;">CONSISTENCY OR DENSENESS</p> <table border="1" style="width: 100%; border-collapse: collapse;"> <thead> <tr> <th>PRIMARY SOIL TYPE</th> <th>COMPACTNESS OR CONSISTENCY</th> <th>RANGE OF STANDARD PENETRATION RESISTANCE (N-VALUE)</th> <th>RANGE OF UNCONFINED COMPRESSIVE STRENGTH (TONS/FT²)</th> </tr> </thead> <tbody> <tr> <td>GENERALLY GRANULAR MATERIAL (NON-COHESIVE)</td> <td>VERY LOOSE LOOSE MEDIUM DENSE DENSE VERY DENSE</td> <td>< 4 4 TO 10 10 TO 30 30 TO 50 > 50</td> <td>N/A</td> </tr> <tr> <td>GENERALLY SILT-CLAY MATERIAL (COHESIVE)</td> <td>VERY SOFT SOFT MEDIUM STIFF STIFF VERY STIFF HARD</td> <td>< 2 2 TO 4 4 TO 8 8 TO 15 15 TO 30 > 30</td> <td>< 0.25 0.25 TO 0.5 0.5 TO 1.0 1 TO 2 2 TO 4 > 4</td> </tr> </tbody> </table>										PRIMARY SOIL TYPE	COMPACTNESS OR CONSISTENCY	RANGE OF STANDARD PENETRATION RESISTANCE (N-VALUE)	RANGE OF UNCONFINED COMPRESSIVE STRENGTH (TONS/FT ²)	GENERALLY GRANULAR MATERIAL (NON-COHESIVE)	VERY LOOSE LOOSE MEDIUM DENSE DENSE VERY DENSE	< 4 4 TO 10 10 TO 30 30 TO 50 > 50	N/A	GENERALLY SILT-CLAY MATERIAL (COHESIVE)	VERY SOFT SOFT MEDIUM STIFF STIFF VERY STIFF HARD	< 2 2 TO 4 4 TO 8 8 TO 15 15 TO 30 > 30	< 0.25 0.25 TO 0.5 0.5 TO 1.0 1 TO 2 2 TO 4 > 4	<p style="text-align: center;">RECOMMENDATION SYMBOLS</p> <p> UNDERCUT EXCAVATION</p> <p> UNCLASSIFIED EXCAVATION - UNSUITABLE WASTE</p> <p> UNCLASSIFIED EXCAVATION - ACCEPTABLE DEGRADABLE ROCK</p> <p> SHALLOW UNDERCUT</p> <p> UNCLASSIFIED EXCAVATION - ACCEPTABLE, BUT NOT TO BE USED IN THE TOP 3 FEET OF EMBANKMENT OR BACKFILL</p>																																																																																																																																																																									
PRIMARY SOIL TYPE	COMPACTNESS OR CONSISTENCY	RANGE OF STANDARD PENETRATION RESISTANCE (N-VALUE)	RANGE OF UNCONFINED COMPRESSIVE STRENGTH (TONS/FT ²)																																																																																																																																																																																												
GENERALLY GRANULAR MATERIAL (NON-COHESIVE)	VERY LOOSE LOOSE MEDIUM DENSE DENSE VERY DENSE	< 4 4 TO 10 10 TO 30 30 TO 50 > 50	N/A																																																																																																																																																																																												
GENERALLY SILT-CLAY MATERIAL (COHESIVE)	VERY SOFT SOFT MEDIUM STIFF STIFF VERY STIFF HARD	< 2 2 TO 4 4 TO 8 8 TO 15 15 TO 30 > 30	< 0.25 0.25 TO 0.5 0.5 TO 1.0 1 TO 2 2 TO 4 > 4																																																																																																																																																																																												
<p style="text-align: center;">TEXTURE OR GRAIN SIZE</p> <table border="1" style="width: 100%; border-collapse: collapse;"> <thead> <tr> <th>U.S. STD. SIEVE SIZE OPENING (MM)</th> <th>4</th> <th>10</th> <th>40</th> <th>60</th> <th>200</th> <th>270</th> </tr> </thead> <tbody> <tr> <td></td> <td>4.76</td> <td>2.00</td> <td>0.42</td> <td>0.25</td> <td>0.075</td> <td>0.053</td> </tr> <tr> <td>BOULDER (BLDR.)</td> <td></td> <td></td> <td></td> <td></td> <td></td> <td></td> </tr> <tr> <td>COBBLE (COB.)</td> <td></td> <td></td> <td></td> <td></td> <td></td> <td></td> </tr> <tr> <td>GRAVEL (GR.)</td> <td></td> <td></td> <td></td> <td></td> <td></td> <td></td> </tr> <tr> <td>COARSE SAND (CS, SD.)</td> <td></td> <td></td> <td></td> <td></td> <td></td> <td></td> </tr> <tr> <td>FINE SAND (F SD.)</td> <td></td> <td></td> <td></td> <td></td> <td></td> <td></td> </tr> <tr> <td>SILT (SL.)</td> <td></td> <td></td> <td></td> <td></td> <td></td> <td></td> </tr> <tr> <td>CLAY (CL.)</td> <td></td> <td></td> <td></td> <td></td> <td></td> <td></td> </tr> </tbody> </table>										U.S. STD. SIEVE SIZE OPENING (MM)	4	10	40	60	200	270		4.76	2.00	0.42	0.25	0.075	0.053	BOULDER (BLDR.)							COBBLE (COB.)							GRAVEL (GR.)							COARSE SAND (CS, SD.)							FINE SAND (F SD.)							SILT (SL.)							CLAY (CL.)							<p style="text-align: center;">ABBREVIATIONS</p> <table border="1" style="width: 100%; border-collapse: collapse;"> <thead> <tr> <th>AR - AUGER REFUSAL</th> <th>BT - BORING TERMINATED</th> <th>CL - CLAY</th> <th>CPT - COARSE PENETRATION TEST</th> <th>CSE - COARSE</th> <th>DMT - DILATOMETER TEST</th> <th>DPT - DYNAMIC PENETRATION TEST</th> <th>e - VOID RATIO</th> <th>F - FINE</th> <th>FOSS. - FOSSILIFEROUS</th> <th>FRAC. - FRACTURED, FRACTURES</th> <th>FRAGS. - FRAGMENTS</th> <th>HI. - HIGHLY</th> <th>MED. - MEDIUM</th> <th>MICA. - MICACEOUS</th> <th>MOD. - MODERATELY</th> <th>NP - NON PLASTIC</th> <th>ORG. - ORGANIC</th> <th>PMT - PRESSUREMETER TEST</th> <th>SAP. - SAPROLITIC</th> <th>SD. - SAND, SANDY</th> <th>SL. - SILT, SILTY</th> <th>SLI. - SLIGHTLY</th> <th>TCR - TRICONE REFUSAL</th> <th>w - MOISTURE CONTENT</th> <th>V - VERY</th> <th>VST - VANE SHEAR TEST</th> <th>WEA. - WEATHERED</th> <th>UNIT WEIGHT</th> <th>DRY UNIT WEIGHT</th> </tr> </thead> <tbody> <tr> <td></td> <td></td> <td></td> <td></td> <td></td> <td></td> <td></td> <td></td> <td></td> <td></td> <td></td> <td></td> <td></td> <td></td> <td></td> <td></td> <td></td> <td></td> <td></td> <td></td> <td></td> <td></td> <td></td> <td></td> <td></td> <td></td> <td></td> <td></td> <td></td> <td></td> <td></td> </tr> </tbody> </table>										AR - AUGER REFUSAL	BT - BORING TERMINATED	CL - CLAY	CPT - COARSE PENETRATION TEST	CSE - COARSE	DMT - DILATOMETER TEST	DPT - DYNAMIC PENETRATION TEST	e - VOID RATIO	F - FINE	FOSS. - FOSSILIFEROUS	FRAC. - FRACTURED, FRACTURES	FRAGS. - FRAGMENTS	HI. - HIGHLY	MED. - MEDIUM	MICA. - MICACEOUS	MOD. - MODERATELY	NP - NON PLASTIC	ORG. - ORGANIC	PMT - PRESSUREMETER TEST	SAP. - SAPROLITIC	SD. - SAND, SANDY	SL. - SILT, SILTY	SLI. - SLIGHTLY	TCR - TRICONE REFUSAL	w - MOISTURE CONTENT	V - VERY	VST - VANE SHEAR TEST	WEA. - WEATHERED	UNIT WEIGHT	DRY UNIT WEIGHT																																																																															
U.S. STD. SIEVE SIZE OPENING (MM)	4	10	40	60	200	270																																																																																																																																																																																									
	4.76	2.00	0.42	0.25	0.075	0.053																																																																																																																																																																																									
BOULDER (BLDR.)																																																																																																																																																																																															
COBBLE (COB.)																																																																																																																																																																																															
GRAVEL (GR.)																																																																																																																																																																																															
COARSE SAND (CS, SD.)																																																																																																																																																																																															
FINE SAND (F SD.)																																																																																																																																																																																															
SILT (SL.)																																																																																																																																																																																															
CLAY (CL.)																																																																																																																																																																																															
AR - AUGER REFUSAL	BT - BORING TERMINATED	CL - CLAY	CPT - COARSE PENETRATION TEST	CSE - COARSE	DMT - DILATOMETER TEST	DPT - DYNAMIC PENETRATION TEST	e - VOID RATIO	F - FINE	FOSS. - FOSSILIFEROUS	FRAC. - FRACTURED, FRACTURES	FRAGS. - FRAGMENTS	HI. - HIGHLY	MED. - MEDIUM	MICA. - MICACEOUS	MOD. - MODERATELY	NP - NON PLASTIC	ORG. - ORGANIC	PMT - PRESSUREMETER TEST	SAP. - SAPROLITIC	SD. - SAND, SANDY	SL. - SILT, SILTY	SLI. - SLIGHTLY	TCR - TRICONE REFUSAL	w - MOISTURE CONTENT	V - VERY	VST - VANE SHEAR TEST	WEA. - WEATHERED	UNIT WEIGHT	DRY UNIT WEIGHT																																																																																																																																																																		
<p style="text-align: center;">SOIL MOISTURE - CORRELATION OF TERMS</p> <table border="1" style="width: 100%; border-collapse: collapse;"> <thead> <tr> <th>SOIL MOISTURE SCALE (ATTERBERG LIMITS)</th> <th>FIELD MOISTURE DESCRIPTION</th> <th>GUIDE FOR FIELD MOISTURE DESCRIPTION</th> </tr> </thead> <tbody> <tr> <td>LL - LIQUID LIMIT</td> <td>- SATURATED - (SAT.)</td> <td>USUALLY LIQUID; VERY WET, USUALLY FROM BELOW THE GROUND WATER TABLE</td> </tr> <tr> <td>PL - PLASTIC LIMIT</td> <td>- WET - (W)</td> <td>SEMISOLID; REQUIRES DRYING TO ATTAIN OPTIMUM MOISTURE</td> </tr> <tr> <td>OM - OPTIMUM MOISTURE SHRINKAGE LIMIT</td> <td>- MOIST - (M)</td> <td>SOLID; AT OR NEAR OPTIMUM MOISTURE</td> </tr> <tr> <td>SL - SHRINKAGE LIMIT</td> <td>- DRY - (D)</td> <td>REQUIRES ADDITIONAL WATER TO ATTAIN OPTIMUM MOISTURE</td> </tr> </tbody> </table>										SOIL MOISTURE SCALE (ATTERBERG LIMITS)	FIELD MOISTURE DESCRIPTION	GUIDE FOR FIELD MOISTURE DESCRIPTION	LL - LIQUID LIMIT	- SATURATED - (SAT.)	USUALLY LIQUID; VERY WET, USUALLY FROM BELOW THE GROUND WATER TABLE	PL - PLASTIC LIMIT	- WET - (W)	SEMISOLID; REQUIRES DRYING TO ATTAIN OPTIMUM MOISTURE	OM - OPTIMUM MOISTURE SHRINKAGE LIMIT	- MOIST - (M)	SOLID; AT OR NEAR OPTIMUM MOISTURE	SL - SHRINKAGE LIMIT	- DRY - (D)	REQUIRES ADDITIONAL WATER TO ATTAIN OPTIMUM MOISTURE	<p style="text-align: center;">EQUIPMENT USED ON SUBJECT PROJECT</p> <table border="1" style="width: 100%; border-collapse: collapse;"> <thead> <tr> <th>DRILL UNITS:</th> <th>ADVANCING TOOLS:</th> <th>HAMMER TYPE:</th> </tr> </thead> <tbody> <tr> <td><input type="checkbox"/> CME-45C</td> <td><input type="checkbox"/> CLAY BITS</td> <td><input checked="" type="checkbox"/> AUTOMATIC <input type="checkbox"/> MANUAL</td> </tr> <tr> <td><input checked="" type="checkbox"/> CME-55</td> <td><input type="checkbox"/> 6" CONTINUOUS FLIGHT AUGER</td> <td></td> </tr> <tr> <td><input type="checkbox"/> CME-550</td> <td><input type="checkbox"/> 8" HOLLOW AUGERS</td> <td></td> </tr> <tr> <td><input type="checkbox"/> VANE SHEAR TEST</td> <td><input type="checkbox"/> HARD FACED FINGER BITS</td> <td></td> </tr> <tr> <td><input type="checkbox"/> PORTABLE HOIST</td> <td><input type="checkbox"/> TUNG-CARBIDE INSERTS</td> <td></td> </tr> <tr> <td></td> <td><input checked="" type="checkbox"/> CASING <input type="checkbox"/> W/ ADVANCER</td> <td></td> </tr> <tr> <td></td> <td><input checked="" type="checkbox"/> TRICONE <input type="checkbox"/> 2 1/8" STEEL TEETH</td> <td></td> </tr> <tr> <td></td> <td><input type="checkbox"/> TRICONE <input type="checkbox"/> TUNG-CARB.</td> <td></td> </tr> <tr> <td></td> <td><input type="checkbox"/> CORE BIT</td> <td></td> </tr> <tr> <td></td> <td></td> <td></td> </tr> </tbody> </table>										DRILL UNITS:	ADVANCING TOOLS:	HAMMER TYPE:	<input type="checkbox"/> CME-45C	<input type="checkbox"/> CLAY BITS	<input checked="" type="checkbox"/> AUTOMATIC <input type="checkbox"/> MANUAL	<input checked="" type="checkbox"/> CME-55	<input type="checkbox"/> 6" CONTINUOUS FLIGHT AUGER		<input type="checkbox"/> CME-550	<input type="checkbox"/> 8" HOLLOW AUGERS		<input type="checkbox"/> VANE SHEAR TEST	<input type="checkbox"/> HARD FACED FINGER BITS		<input type="checkbox"/> PORTABLE HOIST	<input type="checkbox"/> TUNG-CARBIDE INSERTS			<input checked="" type="checkbox"/> CASING <input type="checkbox"/> W/ ADVANCER			<input checked="" type="checkbox"/> TRICONE <input type="checkbox"/> 2 1/8" STEEL TEETH			<input type="checkbox"/> TRICONE <input type="checkbox"/> TUNG-CARB.			<input type="checkbox"/> CORE BIT																																																																																																																																
SOIL MOISTURE SCALE (ATTERBERG LIMITS)	FIELD MOISTURE DESCRIPTION	GUIDE FOR FIELD MOISTURE DESCRIPTION																																																																																																																																																																																													
LL - LIQUID LIMIT	- SATURATED - (SAT.)	USUALLY LIQUID; VERY WET, USUALLY FROM BELOW THE GROUND WATER TABLE																																																																																																																																																																																													
PL - PLASTIC LIMIT	- WET - (W)	SEMISOLID; REQUIRES DRYING TO ATTAIN OPTIMUM MOISTURE																																																																																																																																																																																													
OM - OPTIMUM MOISTURE SHRINKAGE LIMIT	- MOIST - (M)	SOLID; AT OR NEAR OPTIMUM MOISTURE																																																																																																																																																																																													
SL - SHRINKAGE LIMIT	- DRY - (D)	REQUIRES ADDITIONAL WATER TO ATTAIN OPTIMUM MOISTURE																																																																																																																																																																																													
DRILL UNITS:	ADVANCING TOOLS:	HAMMER TYPE:																																																																																																																																																																																													
<input type="checkbox"/> CME-45C	<input type="checkbox"/> CLAY BITS	<input checked="" type="checkbox"/> AUTOMATIC <input type="checkbox"/> MANUAL																																																																																																																																																																																													
<input checked="" type="checkbox"/> CME-55	<input type="checkbox"/> 6" CONTINUOUS FLIGHT AUGER																																																																																																																																																																																														
<input type="checkbox"/> CME-550	<input type="checkbox"/> 8" HOLLOW AUGERS																																																																																																																																																																																														
<input type="checkbox"/> VANE SHEAR TEST	<input type="checkbox"/> HARD FACED FINGER BITS																																																																																																																																																																																														
<input type="checkbox"/> PORTABLE HOIST	<input type="checkbox"/> TUNG-CARBIDE INSERTS																																																																																																																																																																																														
	<input checked="" type="checkbox"/> CASING <input type="checkbox"/> W/ ADVANCER																																																																																																																																																																																														
	<input checked="" type="checkbox"/> TRICONE <input type="checkbox"/> 2 1/8" STEEL TEETH																																																																																																																																																																																														
	<input type="checkbox"/> TRICONE <input type="checkbox"/> TUNG-CARB.																																																																																																																																																																																														
	<input type="checkbox"/> CORE BIT																																																																																																																																																																																														
<p style="text-align: center;">PLASTICITY</p> <table border="1" style="width: 100%; border-collapse: collapse;"> <thead> <tr> <th>NON PLASTIC</th> <th>PLASTICITY INDEX (PI)</th> <th>DRY STRENGTH</th> </tr> </thead> <tbody> <tr> <td></td> <td>0-5</td> <td>VERY LOW</td> </tr> <tr> <td></td> <td>6-15</td> <td>SLIGHT</td> </tr> <tr> <td></td> <td>16-25</td> <td>MEDIUM</td> </tr> <tr> <td></td> <td>26 OR MORE</td> <td>HIGH</td> </tr> </tbody> </table>										NON PLASTIC	PLASTICITY INDEX (PI)	DRY STRENGTH		0-5	VERY LOW		6-15	SLIGHT		16-25	MEDIUM		26 OR MORE	HIGH	<p style="text-align: center;">ROCK HARDNESS</p> <table border="1" style="width: 100%; border-collapse: collapse;"> <thead> <tr> <th>VERY HARD</th> <th>HARD</th> <th>MODERATELY HARD</th> <th>MEDIUM HARD</th> <th>SOFT</th> <th>VERY SOFT</th> </tr> </thead> <tbody> <tr> <td>CANNOT BE SCRATCHED BY KNIFE OR SHARP PICK. BREAKING OF HAND SPECIMENS REQUIRES SEVERAL HARD BLOWS OF THE GEOLOGIST'S PICK.</td> <td>CAN BE SCRATCHED BY KNIFE OR PICK ONLY WITH DIFFICULTY. HARD HAMMER BLOWS REQUIRED TO DETACH HAND SPECIMEN.</td> <td>CAN BE SCRATCHED BY KNIFE OR PICK. GOUGES OR GROOVES TO 0.25 INCHES DEEP CAN BE EXCAVATED BY HARD BLOW OF A GEOLOGIST'S PICK. HAND SPECIMENS CAN BE DETACHED BY MODERATE BLOWS.</td> <td>CAN BE GROOVED OR GOUGED 0.05 INCHES DEEP BY FIRM PRESSURE OF KNIFE OR PICK POINT. CAN BE EXCAVATED IN SMALL CHIPS TO PIECES 1 INCH MAXIMUM SIZE BY HARD BLOWS OF THE POINT OF A GEOLOGIST'S PICK.</td> <td>CAN BE GROOVED OR GOUGED READILY BY KNIFE OR PICK. CAN BE EXCAVATED IN FRAGMENTS FROM CHIPS TO SEVERAL INCHES IN SIZE BY MODERATE BLOWS OF A PICK POINT. SMALL, THIN PIECES CAN BE BROKEN BY FINGER PRESSURE.</td> <td>CAN BE CARVED WITH KNIFE. CAN BE EXCAVATED READILY WITH POINT OF PICK. PIECES 1 INCH OR MORE IN THICKNESS CAN BE BROKEN BY FINGER PRESSURE. CAN BE SCRATCHED READILY BY FINGER NAIL.</td> </tr> </tbody> </table>										VERY HARD	HARD	MODERATELY HARD	MEDIUM HARD	SOFT	VERY SOFT	CANNOT BE SCRATCHED BY KNIFE OR SHARP PICK. BREAKING OF HAND SPECIMENS REQUIRES SEVERAL HARD BLOWS OF THE GEOLOGIST'S PICK.	CAN BE SCRATCHED BY KNIFE OR PICK ONLY WITH DIFFICULTY. HARD HAMMER BLOWS REQUIRED TO DETACH HAND SPECIMEN.	CAN BE SCRATCHED BY KNIFE OR PICK. GOUGES OR GROOVES TO 0.25 INCHES DEEP CAN BE EXCAVATED BY HARD BLOW OF A GEOLOGIST'S PICK. HAND SPECIMENS CAN BE DETACHED BY MODERATE BLOWS.	CAN BE GROOVED OR GOUGED 0.05 INCHES DEEP BY FIRM PRESSURE OF KNIFE OR PICK POINT. CAN BE EXCAVATED IN SMALL CHIPS TO PIECES 1 INCH MAXIMUM SIZE BY HARD BLOWS OF THE POINT OF A GEOLOGIST'S PICK.	CAN BE GROOVED OR GOUGED READILY BY KNIFE OR PICK. CAN BE EXCAVATED IN FRAGMENTS FROM CHIPS TO SEVERAL INCHES IN SIZE BY MODERATE BLOWS OF A PICK POINT. SMALL, THIN PIECES CAN BE BROKEN BY FINGER PRESSURE.	CAN BE CARVED WITH KNIFE. CAN BE EXCAVATED READILY WITH POINT OF PICK. PIECES 1 INCH OR MORE IN THICKNESS CAN BE BROKEN BY FINGER PRESSURE. CAN BE SCRATCHED READILY BY FINGER NAIL.																																																																																																																																																	
NON PLASTIC	PLASTICITY INDEX (PI)	DRY STRENGTH																																																																																																																																																																																													
	0-5	VERY LOW																																																																																																																																																																																													
	6-15	SLIGHT																																																																																																																																																																																													
	16-25	MEDIUM																																																																																																																																																																																													
	26 OR MORE	HIGH																																																																																																																																																																																													
VERY HARD	HARD	MODERATELY HARD	MEDIUM HARD	SOFT	VERY SOFT																																																																																																																																																																																										
CANNOT BE SCRATCHED BY KNIFE OR SHARP PICK. BREAKING OF HAND SPECIMENS REQUIRES SEVERAL HARD BLOWS OF THE GEOLOGIST'S PICK.	CAN BE SCRATCHED BY KNIFE OR PICK ONLY WITH DIFFICULTY. HARD HAMMER BLOWS REQUIRED TO DETACH HAND SPECIMEN.	CAN BE SCRATCHED BY KNIFE OR PICK. GOUGES OR GROOVES TO 0.25 INCHES DEEP CAN BE EXCAVATED BY HARD BLOW OF A GEOLOGIST'S PICK. HAND SPECIMENS CAN BE DETACHED BY MODERATE BLOWS.	CAN BE GROOVED OR GOUGED 0.05 INCHES DEEP BY FIRM PRESSURE OF KNIFE OR PICK POINT. CAN BE EXCAVATED IN SMALL CHIPS TO PIECES 1 INCH MAXIMUM SIZE BY HARD BLOWS OF THE POINT OF A GEOLOGIST'S PICK.	CAN BE GROOVED OR GOUGED READILY BY KNIFE OR PICK. CAN BE EXCAVATED IN FRAGMENTS FROM CHIPS TO SEVERAL INCHES IN SIZE BY MODERATE BLOWS OF A PICK POINT. SMALL, THIN PIECES CAN BE BROKEN BY FINGER PRESSURE.	CAN BE CARVED WITH KNIFE. CAN BE EXCAVATED READILY WITH POINT OF PICK. PIECES 1 INCH OR MORE IN THICKNESS CAN BE BROKEN BY FINGER PRESSURE. CAN BE SCRATCHED READILY BY FINGER NAIL.																																																																																																																																																																																										
<p style="text-align: center;">FRACTURE SPACING</p> <table border="1" style="width: 100%; border-collapse: collapse;"> <thead> <tr> <th>TERM</th> <th>SPACING</th> </tr> </thead> <tbody> <tr> <td>VERY WIDE</td> <td>MORE THAN 10 FEET</td> </tr> <tr> <td>WIDE</td> <td>3 TO 10 FEET</td> </tr> <tr> <td>MODERATELY CLOSE</td> <td>1 TO 3 FEET</td> </tr> <tr> <td>CLOSE</td> <td>0.16 TO 1 FOOT</td> </tr> <tr> <td>VERY CLOSE</td> <td>LESS THAN 0.16 FEET</td> </tr> </tbody> </table>										TERM	SPACING	VERY WIDE	MORE THAN 10 FEET	WIDE	3 TO 10 FEET	MODERATELY CLOSE	1 TO 3 FEET	CLOSE	0.16 TO 1 FOOT	VERY CLOSE	LESS THAN 0.16 FEET	<p style="text-align: center;">BEDDING</p> <table border="1" style="width: 100%; border-collapse: collapse;"> <thead> <tr> <th>TERM</th> <th>THICKNESS</th> </tr> </thead> <tbody> <tr> <td>VERY THICKLY BEDDED</td> <td>4 FEET</td> </tr> <tr> <td>THICKLY BEDDED</td> <td>1.5 - 4 FEET</td> </tr> <tr> <td>THINLY BEDDED</td> <td>0.16 - 1.5 FEET</td> </tr> <tr> <td>VERY THINLY BEDDED</td> <td>0.03 - 0.16 FEET</td> </tr> <tr> <td>THICKLY LAMINATED</td> <td>0.008 - 0.03 FEET</td> </tr> <tr> <td>THINLY LAMINATED</td> <td>< 0.008 FEET</td> </tr> </tbody> </table>										TERM	THICKNESS	VERY THICKLY BEDDED	4 FEET	THICKLY BEDDED	1.5 - 4 FEET	THINLY BEDDED	0.16 - 1.5 FEET	VERY THINLY BEDDED	0.03 - 0.16 FEET	THICKLY LAMINATED	0.008 - 0.03 FEET	THINLY LAMINATED	< 0.008 FEET																																																																																																																																																		
TERM	SPACING																																																																																																																																																																																														
VERY WIDE	MORE THAN 10 FEET																																																																																																																																																																																														
WIDE	3 TO 10 FEET																																																																																																																																																																																														
MODERATELY CLOSE	1 TO 3 FEET																																																																																																																																																																																														
CLOSE	0.16 TO 1 FOOT																																																																																																																																																																																														
VERY CLOSE	LESS THAN 0.16 FEET																																																																																																																																																																																														
TERM	THICKNESS																																																																																																																																																																																														
VERY THICKLY BEDDED	4 FEET																																																																																																																																																																																														
THICKLY BEDDED	1.5 - 4 FEET																																																																																																																																																																																														
THINLY BEDDED	0.16 - 1.5 FEET																																																																																																																																																																																														
VERY THINLY BEDDED	0.03 - 0.16 FEET																																																																																																																																																																																														
THICKLY LAMINATED	0.008 - 0.03 FEET																																																																																																																																																																																														
THINLY LAMINATED	< 0.008 FEET																																																																																																																																																																																														
<p style="text-align: center;">INDURATION</p> <p>FOR SEDIMENTARY ROCKS, INDURATION IS THE HARDENING OF MATERIAL BY CEMENTING, HEAT, PRESSURE, ETC.</p> <p>FRIABLE: RUBBING WITH FINGER FREES NUMEROUS GRAINS; GENTLE BLOW BY HAMMER DISINTEGRATES SAMPLE.</p> <p>MODERATELY INDURATED: GRAINS CAN BE SEPARATED FROM SAMPLE WITH STEEL PROBE; BREAKS EASILY WHEN HIT WITH HAMMER.</p> <p>INDURATED: GRAINS ARE DIFFICULT TO SEPARATE WITH STEEL PROBE; DIFFICULT TO BREAK WITH HAMMER.</p> <p>EXTREMELY INDURATED: SHARP HAMMER BLOWS REQUIRED TO BREAK SAMPLE; SAMPLE BREAKS ACROSS GRAINS.</p>										<p style="text-align: center;">BENCH MARK:</p> <p style="text-align: right;">ELEVATION: _____ FEET</p> <p>NOTES:</p>																																																																																																																																																																																					
<p style="text-align: center;">COLOR</p> <p>DESCRIPTIONS MAY INCLUDE COLOR OR COLOR COMBINATIONS (TAN, RED, YELLOW-BROWN, BLUE-GRAY). MODIFIERS SUCH AS LIGHT, DARK, STREAKED, ETC. ARE USED TO DESCRIBE APPEARANCE.</p>																																																																																																																																																																																															

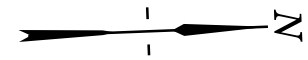

30

35

END RETAINING WALL-2
 -W2- STA 45+22.97 =
 -L- STA 30+00.00 (47.00' LT)

BEGIN RETAINING WALL-2
 -W2- STA 37+67.50 =
 -L- STA 37+67.50 (57.00' LT)

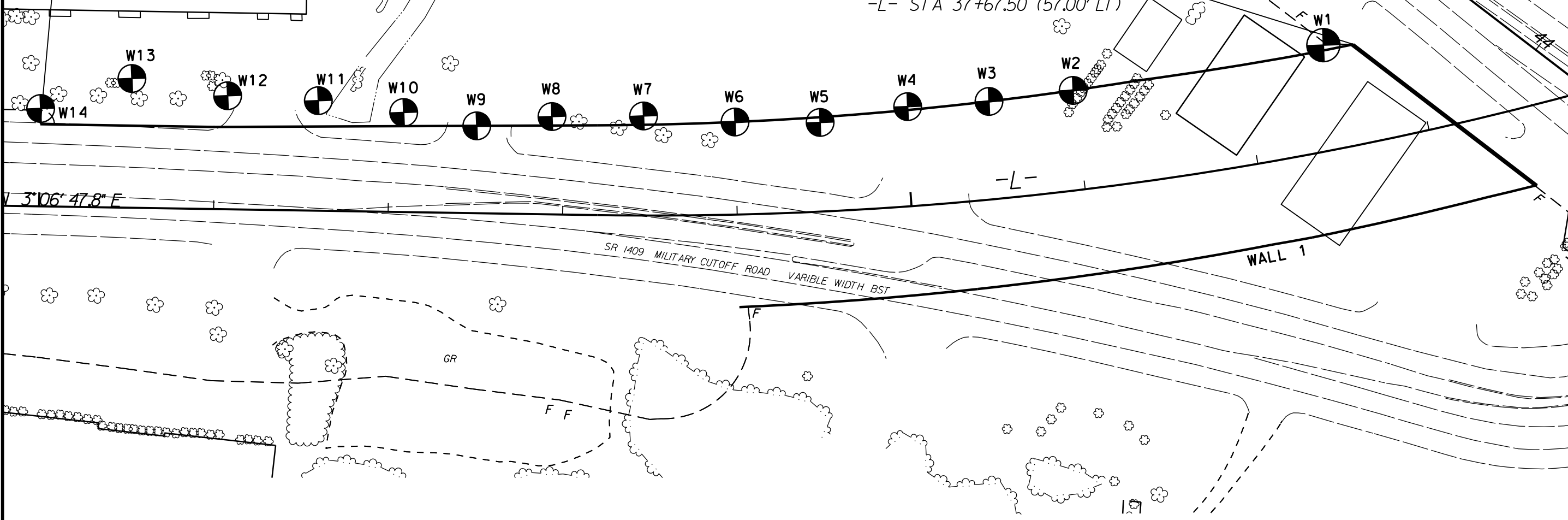

3°06'47.8" E

SR 1409 MILITARY CUTOFF ROAD
 VARIABLE WIDTH BST

WALL 1

GR

F F

-L-

W1

W2

W3

W4

W5

W6

W7

W8

W9

W10

W11

W12

W13

W14

US HWY 77 MARKET STREET
 VARIABLE WIDTH BST

42

-Y1-

43

44

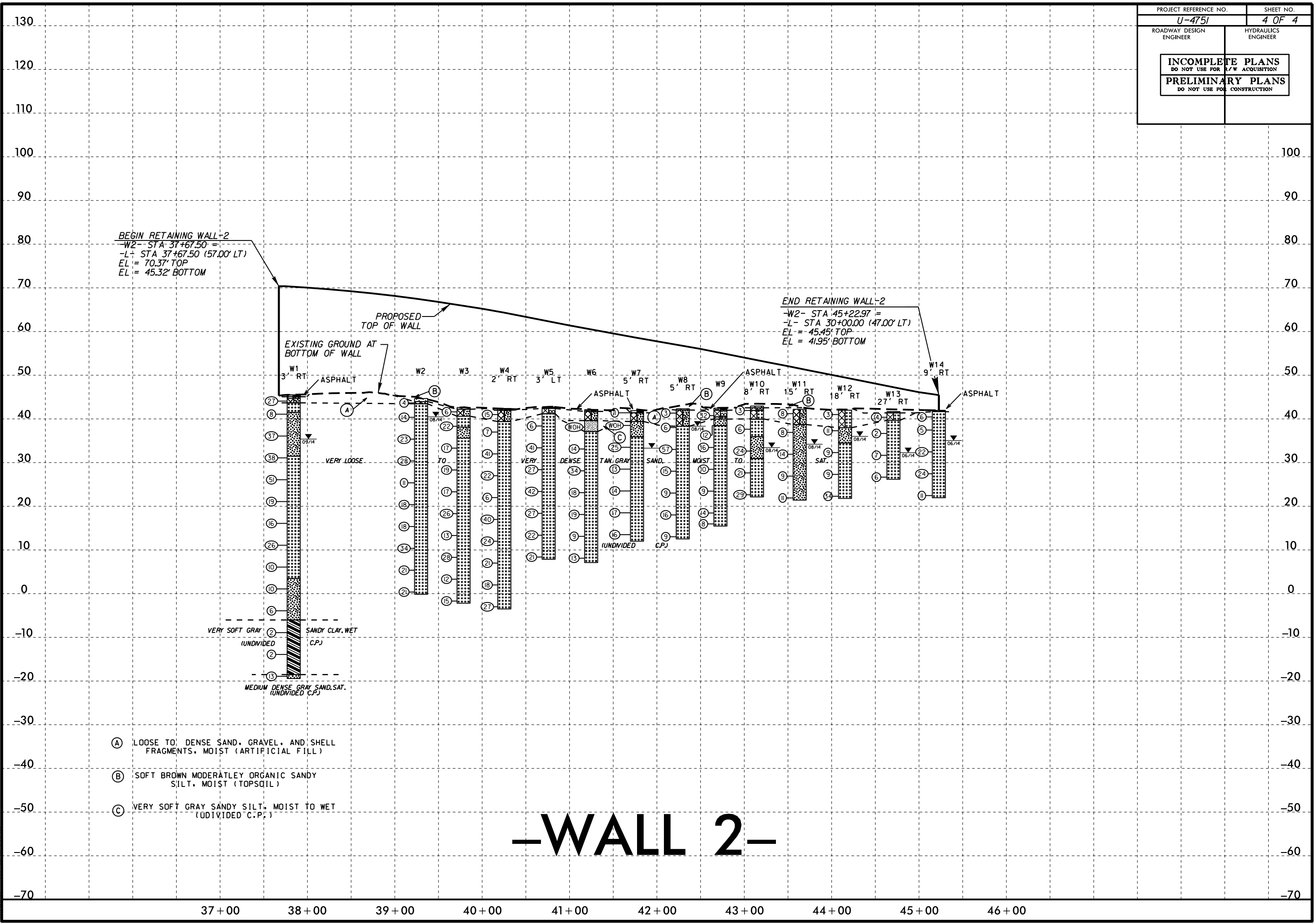

5/14/99
 02-MAR-2015 14:50
 L:\ERON\Greenville_Investigation\TIP_U4751_GEO_RWAL2\CADD_GEO\TECH\PI\onPr\of\U4751_GEO_WALL2_PFL.dgn
 11:58:41 AM 02/27/18