

SUPERSTRUCTURE REINFORCING STEEL LENGTHS ARE BASED ON THE FOLLOWING MINIMUM SPLICE LENGTHS

BAR SIZE	SUPERSTRUCTURE EXCEPT APPROACH SLABS, PARAPET, AND BARRIER RAIL		APPROACH SLABS		PARAPET AND BARRIER RAIL
	EPOXY COATED	UNCOATED	EPOXY COATED	UNCOATED	
#4	2'-0"	1'-9"	2'-0"	1'-9"	2'-9"
#5	2'-6"	2'-2"	2'-6"	2'-2"	3'-5"
#6	3'-0"	2'-7"	3'-10"	2'-7"	4'-4"
#7	5'-3"	3'-6"			
#8	6'-10"	4'-7"			

GROOVING BRIDGE FLOORS

APPROACH SLABS	1,670	SQ.FT.
BRIDGE DECK	7,346	SQ.FT.
TOTAL	9,016	SQ.FT.

SUPERSTRUCTURE BILL OF MATERIAL			
	CLASS AA CONCRETE	REINFORCING STEEL	EPOXY COATED REINFORCING STEEL
	( CU. YDS. )	( LBS. )	( LBS. )
POUR #1	131.0	--	--
POUR #2	167.2	--	--
POUR #3	16.2	--	--
TOTALS**	314.4	29,519	28,593

\*\*QUANTITIES FOR BARRIER RAIL ARE NOT INCLUDED

BILL OF MATERIAL						BILL OF MATERIAL					
BAR	NO.	SIZE	TYPE	LENGTH	WEIGHT	BAR	NO.	SIZE	TYPE	LENGTH	WEIGHT
*A1	364	#5	STR	41'-1"	15,597	*B1	56	#5	STR	41'-0"	2,395
A2	364	#5	STR	41'-1"	15,597	*B2	28	#7	STR	60'-0"	3,434
*A100	1	#5	STR	3'-0"	3	*B3	27	#7	STR	32'-0"	1,766
*A101	1	#5	STR	4'-9"	5	*B4	27	#7	STR	22'-0"	1,214
*A102	2	#5	STR	5'-5"	11	B5	90	#5	STR	47'-8"	4,474
*A103	2	#5	STR	7'-2"	15	B6	45	#7	STR	32'-0"	2,943
*A104	2	#5	STR	8'-11"	19	*B7	56	#5	STR	39'-10"	2,327
*A105	2	#5	STR	10'-8"	22	B8	90	#5	STR	46'-7"	4,373
*A106	2	#5	STR	12'-4"	26	*G1	1	#5	STR	41'-10"	44
*A107	2	#5	STR	14'-1"	29	*G2	1	#5	STR	44'-8"	47
*A108	2	#5	STR	15'-10"	33	*J1	82	#4	8	1'-5"	78
*A109	2	#5	STR	17'-7"	37						
*A110	2	#5	STR	19'-3"	40	*K1	4	#8	1	16'-6"	176
*A111	2	#5	STR	21'-0"	44	*K2	4	#8	2	25'-11"	277
*A112	2	#5	STR	21'-4"	45	K3	3	#6	STR	7'-2"	32
*A113	2	#5	STR	19'-9"	41	K4	3	#6	STR	8'-1"	36
*A114	2	#5	STR	18'-1"	38	K5	3	#6	STR	10'-9"	48
*A115	2	#5	STR	16'-6"	34	K6	30	#4	STR	10'-7"	212
*A116	2	#5	STR	14'-10"	31	K7	6	#4	STR	8'-10"	35
*A117	2	#5	STR	13'-3"	28	K8	12	#4	9	7'-0"	56
*A118	2	#5	STR	11'-7"	24	K9	12	#4	10	13'-11"	112
*A119	2	#5	STR	10'-0"	21	*K10	4	#8	1	17'-4"	185
*A120	2	#5	STR	8'-4"	17	K11	3	#6	STR	7'-10"	35
*A121	2	#5	STR	6'-9"	14	K12	3	#6	STR	9'-2"	41
*A122	2	#5	STR	5'-2"	11	K13	3	#6	STR	11'-2"	50
*A123	1	#5	STR	4'-5"	5	*K14	4	#8	2	27'-3"	291
*A124	1	#5	STR	2'-10"	3						
A200	1	#5	STR	3'-0"	3	*S1	48	#4	4	5'-2"	166
A201	1	#5	STR	4'-9"	5	S2	48	#5	3	6'-1"	300
A202	2	#5	STR	5'-3"	11	S3	138	#4	5	2'-9"	254
A203	2	#5	STR	7'-0"	15	S4	6	#4	6	11'-1"	44
A204	2	#5	STR	8'-9"	18						
A205	2	#5	STR	10'-6"	22	U1	24	#4	7	18'-0"	289
A206	2	#5	STR	12'-2"	25	REINFORCING STEEL		29,519		LBS.	
A207	2	#5	STR	13'-11"	29	*EPOXY COATED REINFORCING STEEL		28,593		LBS.	
A208	2	#5	STR	15'-8"	33						
A209	2	#5	STR	17'-5"	36						
A210	2	#5	STR	19'-1"	40						
A211	2	#5	STR	20'-10"	43						
A212	2	#5	STR	21'-2"	44						
A213	2	#5	STR	19'-7"	41						
A214	2	#5	STR	17'-11"	37						
A215	2	#5	STR	16'-4"	34						
A216	2	#5	STR	14'-8"	31						
A217	2	#5	STR	13'-1"	27						
A218	2	#5	STR	11'-5"	24						
A219	2	#5	STR	9'-10"	21						
A220	2	#5	STR	8'-2"	17						
A221	2	#5	STR	6'-7"	14						
A222	2	#5	STR	5'-0"	10						
A223	1	#5	STR	4'-5"	5						
A224	1	#5	STR	2'-10"	3						

BAR TYPES

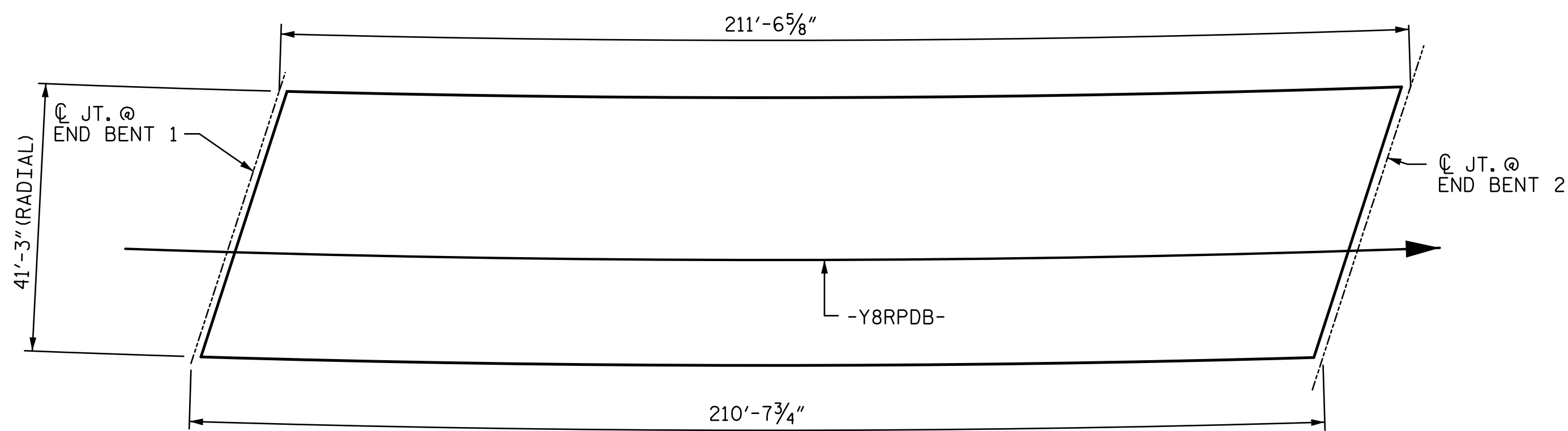
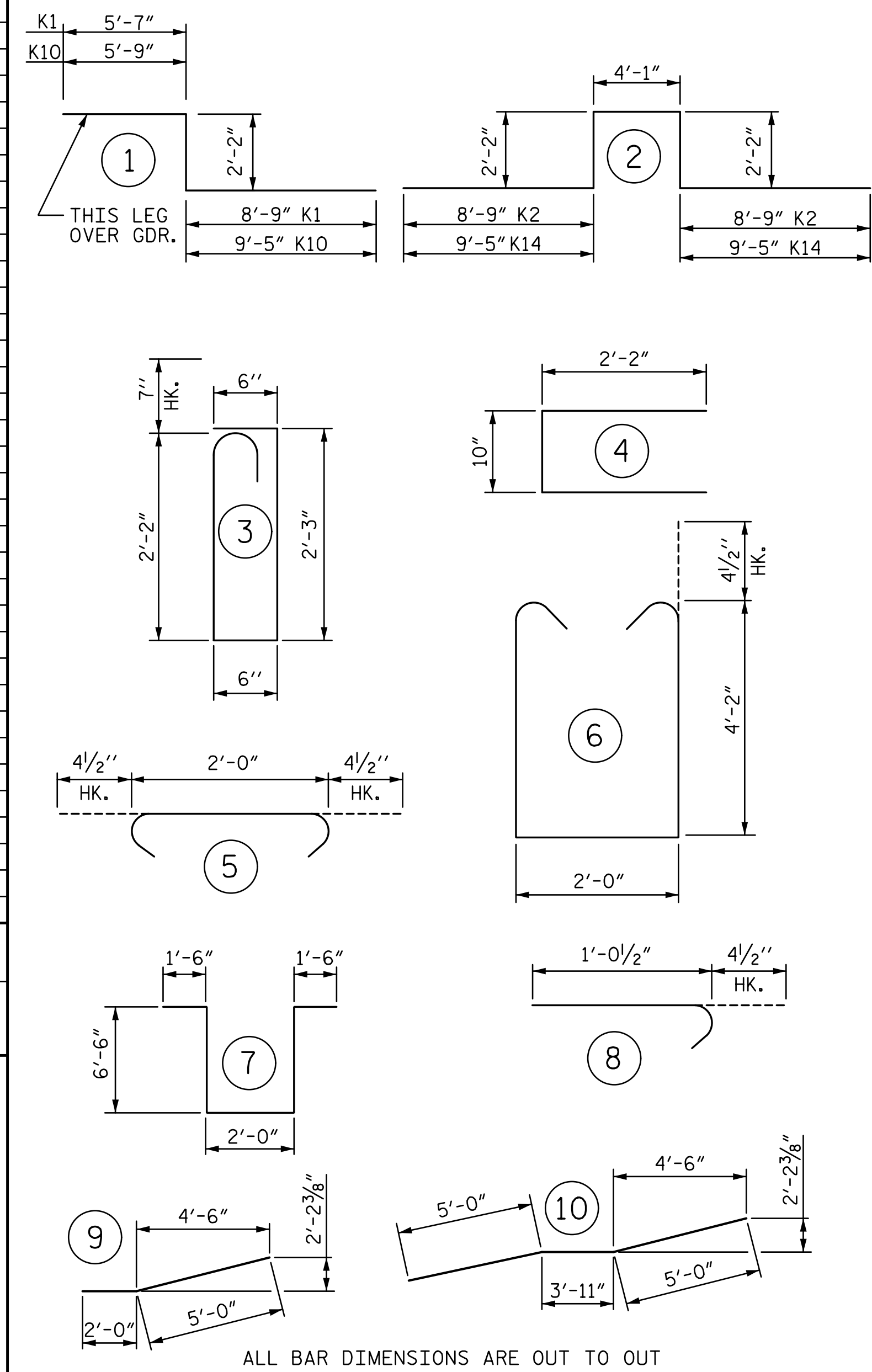

LAYOUT FOR COMPUTING AREA REINFORCED CONCRETE DECK SLAB (SQ. FT. = 8,708)

PROJECT NO. U-4751  
 NEW HANOVER COUNTY  
 STATION: 35+12.05 -Y8RPDB-

DOCUMENT NOT CONSIDERED FINAL UNLESS ALL SIGNATURES COMPLETED			STATE OF NORTH CAROLINA DEPARTMENT OF TRANSPORTATION RALEIGH SUPERSTRUCTURE BILL OF MATERIAL		
	REVISIONS				SHEET NO. S4-24 TOTAL SHEETS 36
	NO.	BY:	DATE:	NO.	
1			3		
2			4		