

**PHASING DIAGRAM**

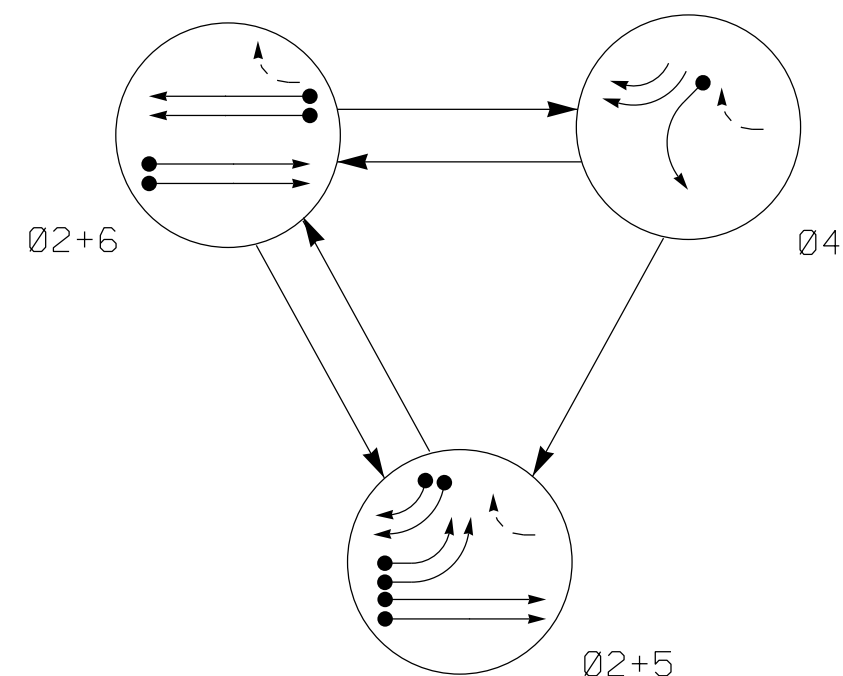

**TABLE OF OPERATION**

SIGNAL FACE	PHASE			
	Ø 2+5	Ø 2+6	Ø 4	FLASH
21, 22	G	G	R	Y
41	-R	-R	-R	-R
42, 43	-	R	-	R
51, 52	-R	-R	-R	-R
61, 62	R	G	R	Y

**SIGNAL FACE I.D.**

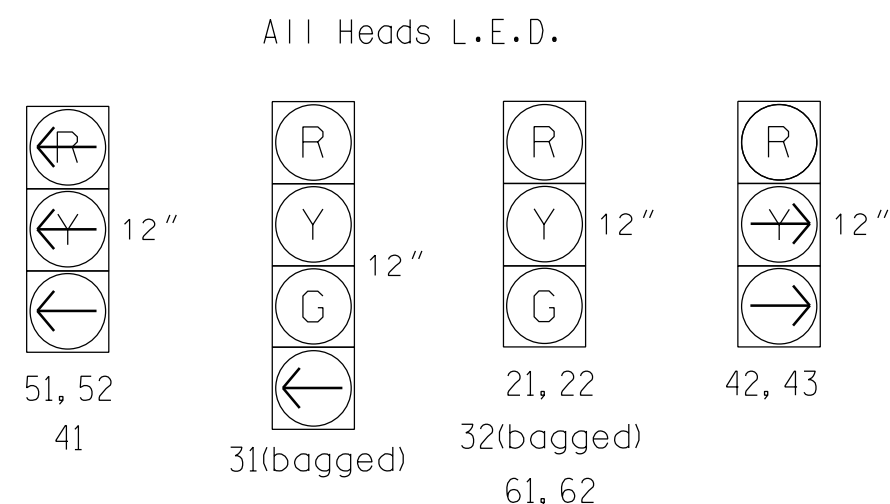

**OASIS 2070 LOOP & DETECTOR INSTALLATION CHART**

LOOP	SIZE (FT)	DISTANCE FROM STOPBAR (FT)	TURNS	DETECTOR PROGRAMMING								
				NEW LOOP	PHASE	CALLING	EXTENSION	STRETCH TIME	DELAY TIME	SYSTEM LOOP	NEW CARD	
2A/S1	6x6	300	6	-	2	Y	Y	-	-	-	Y	-
2B/S2	6x6	300	6	-	2	Y	Y	-	-	-	Y	-
4A	6x60	0	2-4-2	-	4	Y	Y	-	-	-	-	-
5A	6x60	0	2-4-2	-	5	Y	Y	-	-	-	-	-
5B	6x60	0	2-4-2	-	5	Y	Y	-	-	-	-	-
5C	6x60	0	2-4-2	-	5	Y	Y	-	-	15	-	-
5D	6x60	0	2-4-2	-	5	Y	Y	-	-	15	-	-
6A/S5	6x6	300	4	-	6	Y	Y	-	-	-	Y	-
6B/S6	6x6	300	4	-	6	Y	Y	-	-	-	Y	-
S3	6x6	+210	4	-	-	-	-	-	-	-	Y	-
S4	6x6	+210	4	-	-	-	-	-	-	-	Y	-

**3 Phase Fully Actuated Wilmington Signal System**

**NOTES**

1. Refer to "Roadway Standard Drawings NCDOT" dated January 2012 and "Standard Specifications for Roads and Structures" dated January 2012.
2. Do not program signal for late night flashing operation unless otherwise directed by the Engineer.
3. Remove Westbound Market Street left-turn head.
4. Disable and bag heads 31 and 32.
5. Phase 5 may be lagged.
6. Set all detector units to presence mode.
7. Maximum times shown in timing charts are for free-run operation only. Coordinated signal system timing values supersede these values.
8. Signal system data: Controller Asset #0884

**PHASING DIAGRAM DETECTION LEGEND**

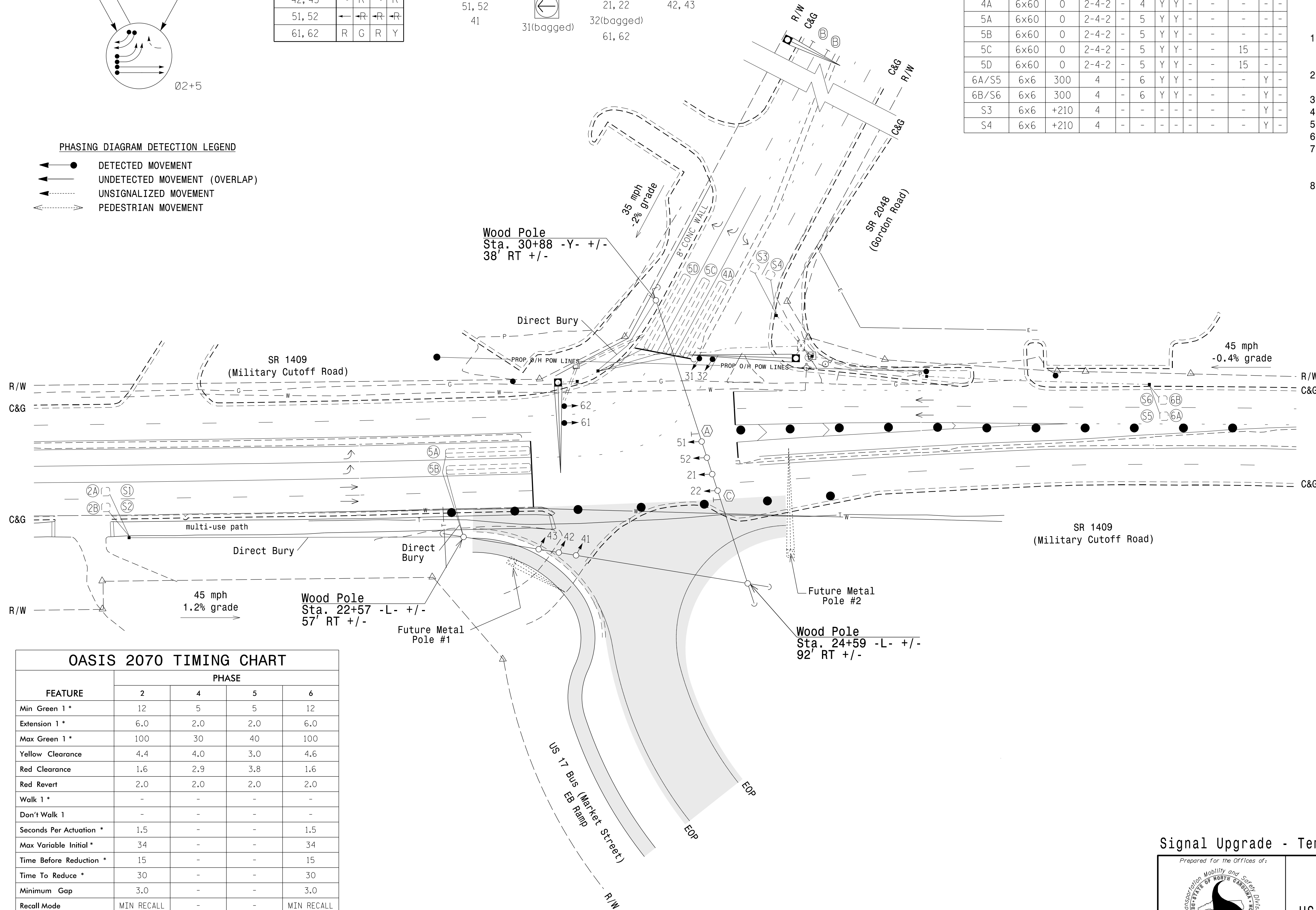
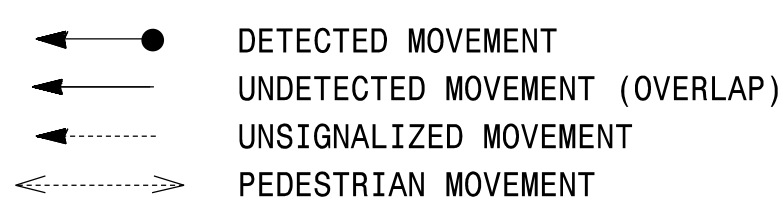

**OASIS 2070 TIMING CHART**

FEATURE	PHASE			
	2	4	5	6
Min Green 1 *	12	5	5	12
Extension 1 *	6.0	2.0	2.0	6.0
Max Green 1 *	100	30	40	100
Yellow Clearance	4.4	4.0	3.0	4.6
Red Clearance	1.6	2.9	3.8	1.6
Red Revert	2.0	2.0	2.0	2.0
Walk 1 *	-	-	-	-
Don't Walk 1	-	-	-	-
Seconds Per Actuation *	1.5	-	-	1.5
Max Variable Initial *	34	-	-	34
Time Before Reduction *	15	-	-	15
Time To Reduce *	30	-	-	30
Minimum Gap	3.0	-	-	3.0
Recall Mode	MIN RECALL	-	-	MIN RECALL
Vehicle Call Memory	YELLOW	-	-	YELLOW
Dual Entry	-	-	-	-
Simultaneous Gap	ON	ON	ON	ON

\* These values may be field adjusted. Do not adjust Min Green and Extension times for phases 2 and 6 lower than what is shown. Min Green for all other phases should not be lower than 4 seconds.

**LEGEND**

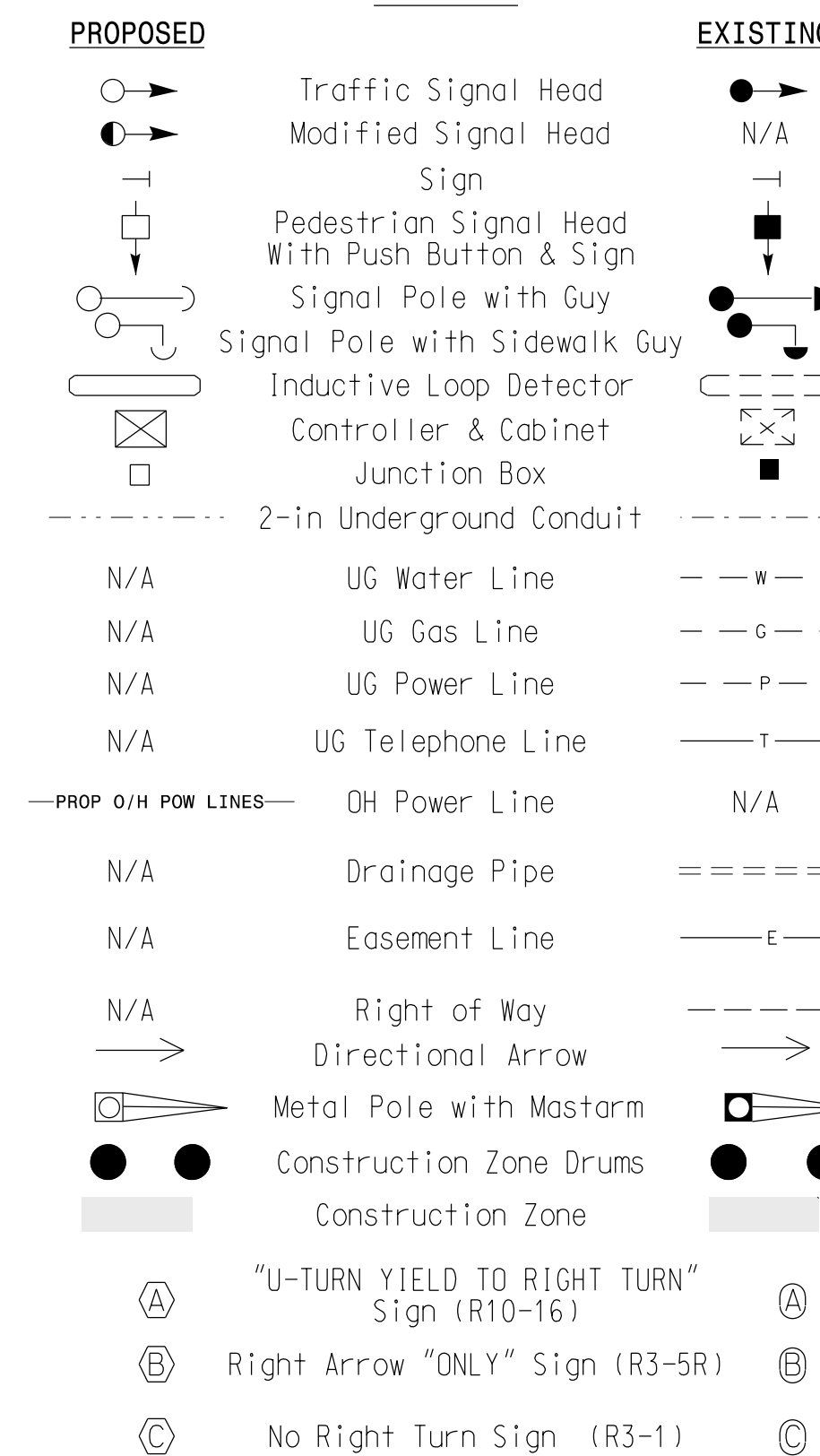

**DOCUMENT NOT CONSIDERED FINAL UNLESS ALL SIGNATURES COMPLETED**

**Signal Upgrade - Temporary Design 1 (TMP Phase I)**

 SEAL NORTH CAROLINA PROFESSIONAL ENGINEER MELISSA B. TOTH 025892	SR 1409 (Military Cutoff Road) at SR 2048 (Gordon Road)/ US 17 Bus (Market St) SB Ramp Division 03 New Hanover County Wilmington	
	PLAN DATE: April 2017 PREPARED BY: LD Stouchko	REVIEWED BY: MB Toth REVIEWED BY:
SCALE: 1"=40' REVISIONS:	INIT. DATE	Date: 6/6/2017 Signature: Melissa B. Toth

**ATKINS** 1616 EAST MILLBROOK ROAD, SUITE 160  
 RALEIGH, NORTH CAROLINA 27609  
 (919) 876-6888 NCBEES #F-0326