

**CLEARING AND GRUBBING
 EROSION CONTROL FOR
 CONSTRUCTION SHEET 14**

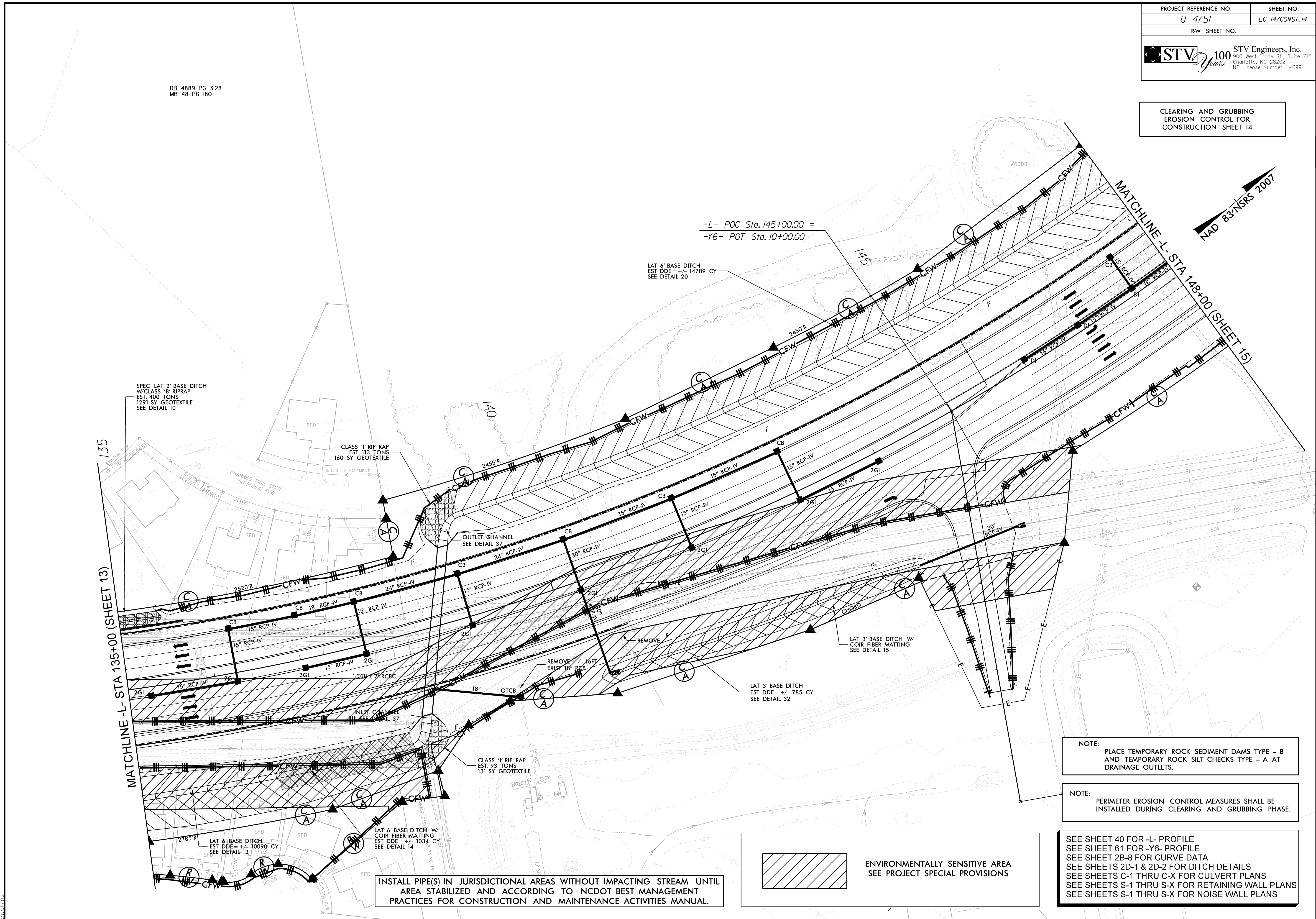
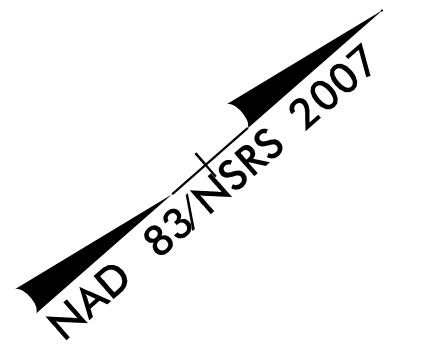

SPEC. LAT 2' BASE DITCH
 W/CLASS 'B' RIPRAP
 EST. 400 TONS
 1291 SY GEOTEXTILE
 SEE DETAIL 10

CLASS 'I' RIP RAP
 EST. 113 TONS
 160 SY GEOTEXTILE

CLASS 'I' RIP RAP
 EST. 93 TONS
 131 SY GEOTEXTILE

LAT 6' BASE DITCH
 EST DDE = +/- 10090 CY
 SEE DETAIL 13

LAT 6' BASE DITCH W/
 COIR FIBER MATTING
 EST DDE = +/- 1034 CY
 SEE DETAIL 14

-L- POC Sta. 145+00.00 =
 -Y6- POT Sta. 10+00.00

LAT 6' BASE DITCH
 EST DDE = +/- 14789 CY
 SEE DETAIL 20

LAT 3' BASE DITCH W/
 COIR FIBER MATTING
 SEE DETAIL 15

LAT 3' BASE DITCH
 EST DDE = +/- 785 CY
 SEE DETAIL 32

NOTE:
 PLACE TEMPORARY ROCK SEDIMENT DAMS TYPE - B
 AND TEMPORARY ROCK SILT CHECKS TYPE - A AT
 DRAINAGE OUTLETS.

NOTE:
 PERIMETER EROSION CONTROL MEASURES SHALL BE
 INSTALLED DURING CLEARING AND GRUBBING PHASE.

SEE SHEET 40 FOR -L- PROFILE
 SEE SHEET 61 FOR -Y6- PROFILE
 SEE SHEET 2B-8 FOR CURVE DATA
 SEE SHEETS 2D-1 & 2D-2 FOR DITCH DETAILS
 SEE SHEETS C-1 THRU C-X FOR CULVERT PLANS
 SEE SHEETS S-1 THRU S-X FOR RETAINING WALL PLANS
 SEE SHEETS S-1 THRU S-X FOR NOISE WALL PLANS

INSTALL PIPE(S) IN JURISDICTIONAL AREAS WITHOUT IMPACTING STREAM UNTIL
 AREA STABILIZED AND ACCORDING TO NCDOT BEST MANAGEMENT
 PRACTICES FOR CONSTRUCTION AND MAINTENANCE ACTIVITIES MANUAL.

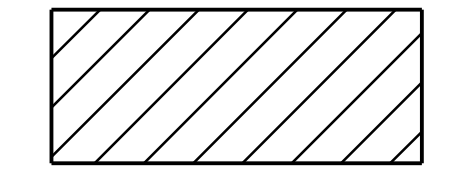

ENVIRONMENTALLY SENSITIVE AREA
 SEE PROJECT SPECIAL PROVISIONS