

**END OF RAIL DETAILS**

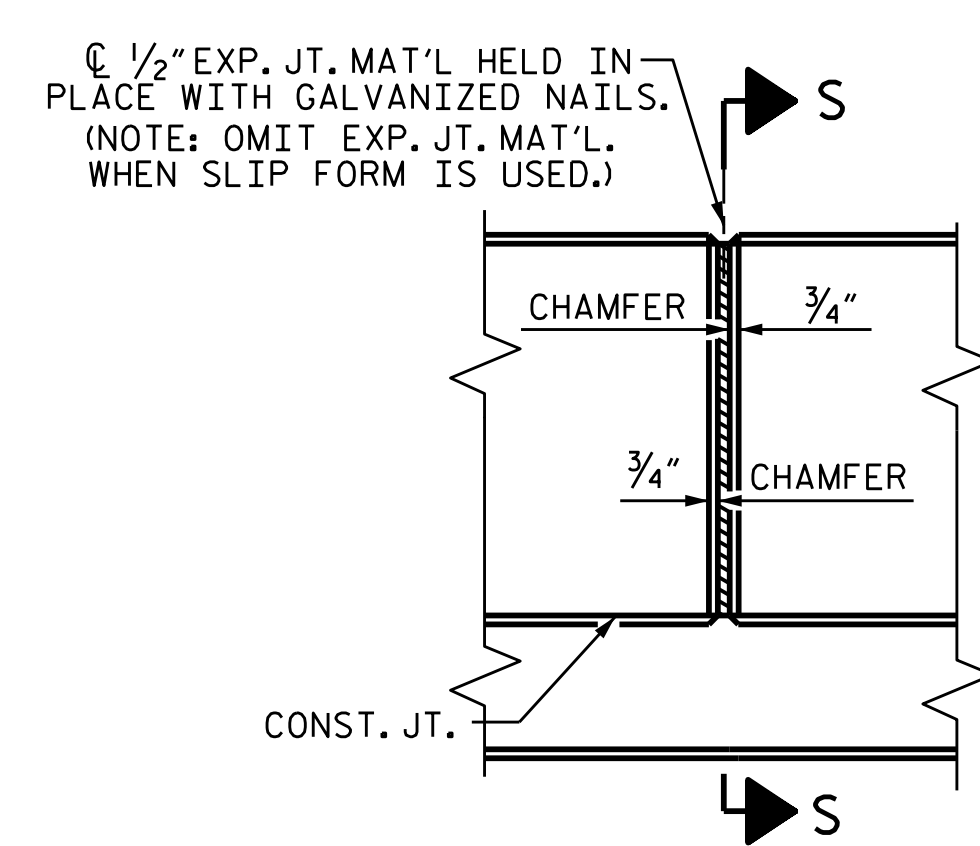
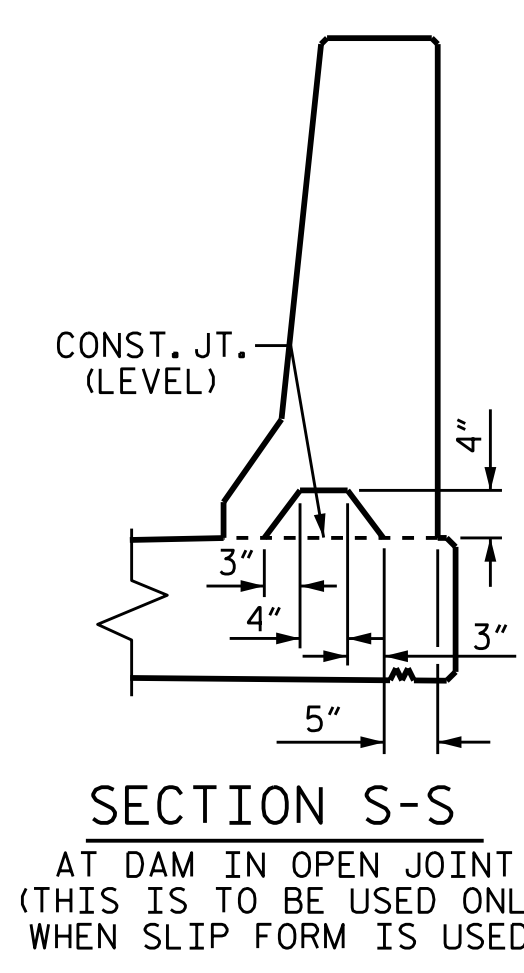
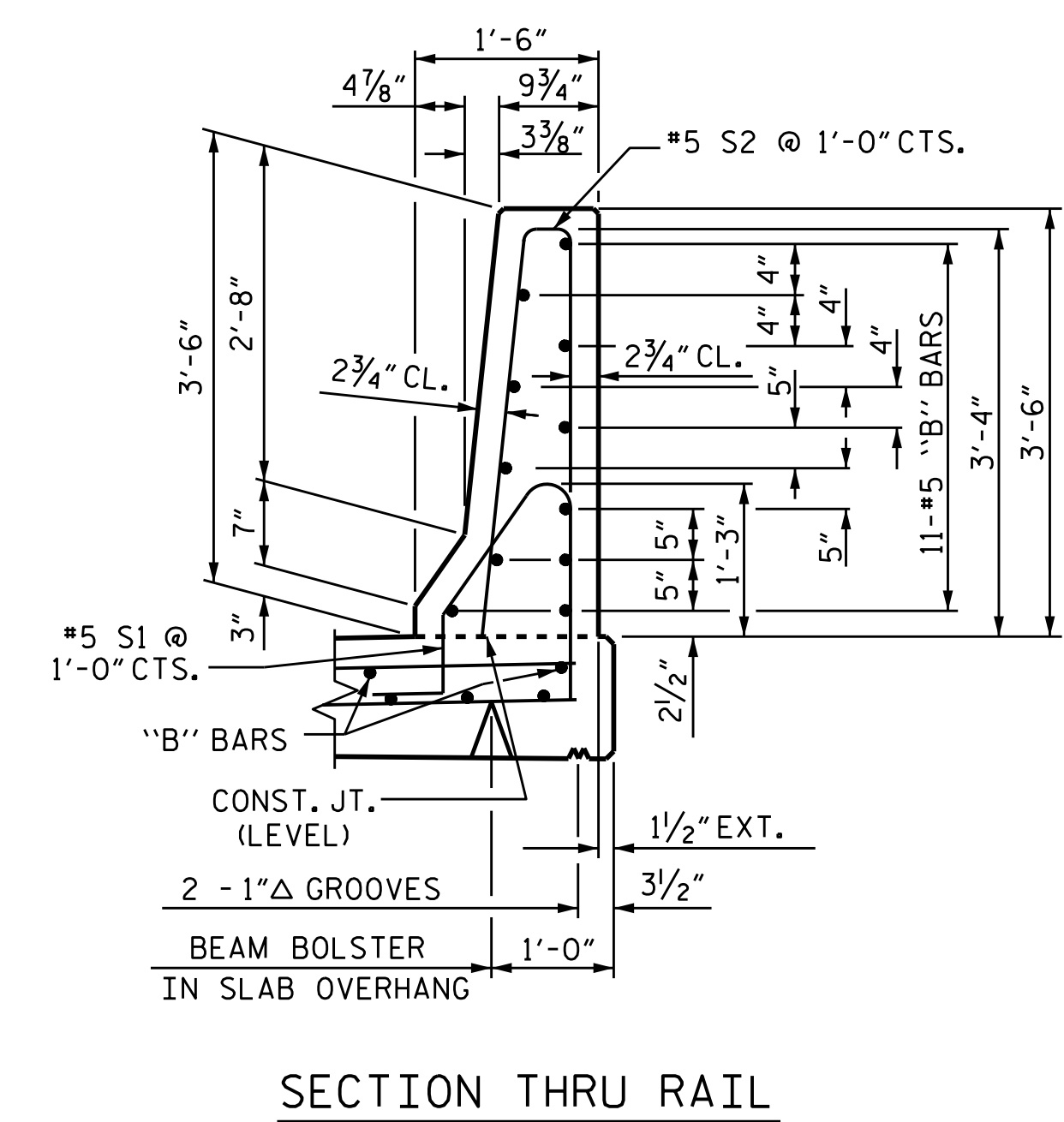

SECTION THRU RAIL

SECTION S-S  
AT DAM IN OPEN JOINT  
(THIS IS TO BE USED ONLY  
WHEN SLIP FORM IS USED)

ELEVATION AT EXPANSION JOINTS

**BARRIER RAIL DETAILS**

**NOTES**

THE BARRIER RAIL IN THE CONTINUOUS UNIT SHALL NOT BE CAST UNTIL ALL SLAB CONCRETE IN THAT UNIT HAS BEEN CAST AND HAS REACHED A MINIMUM COMPRESSIVE STRENGTH OF 3,000 PSI.

ALL REINFORCING STEEL IN BARRIER RAILS SHALL BE EPOXY COATED.

GROOVED CONTRACTION JOINTS, 1/2" IN DEPTH, SHALL BE TOOLED IN ALL EXPOSED FACES OF THE BARRIER RAIL AND IN ACCORDANCE WITH ARTICLE 825-10(B) OF THE STANDARD SPECIFICATIONS, THE CONTRACTION JOINT SHALL BE LOCATED AT EACH THIRD POINT BETWEEN BARRIER RAIL EXPANSION JOINTS. ONLY ONE CONTRACTION JOINT IS REQUIRED AT MIDPOINT OF BARRIER RAIL SEGMENTS LESS THAN 20 FEET IN LENGTH AND NO CONTRACTION JOINTS ARE REQUIRED FOR THOSE SEGMENTS LESS THAN 10 FEET IN LENGTH.

THE #5 S1 AND #5 S2 BARS MAY BE SHIFTED SLIGHTLY IN ORDER TO MAINTAIN 2" MINIMUM CLEARANCE TO THE 1/2" EXPANSION JOINT MATERIAL IN THE BARRIER RAIL.

**BAR TYPES**

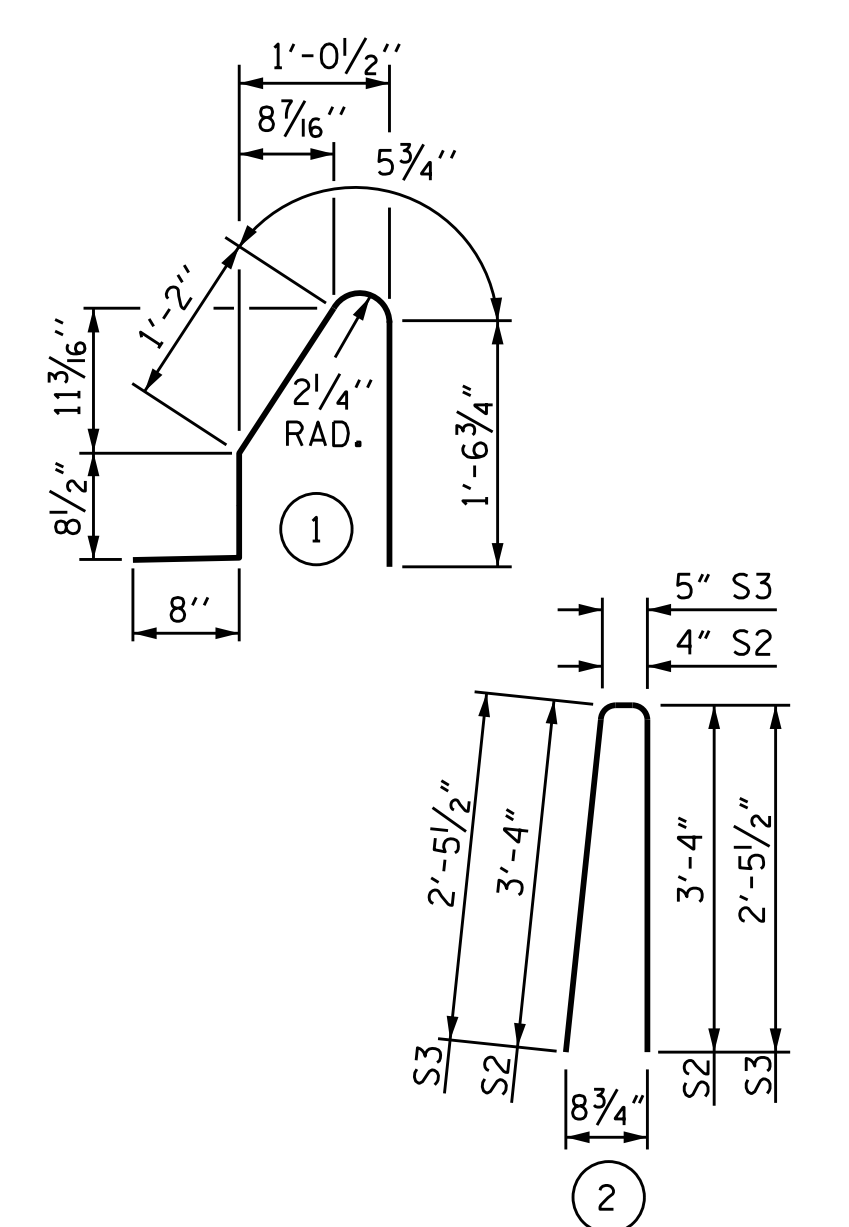

ALL BAR DIMENSIONS ARE OUT TO OUT.

**BILL OF MATERIAL**

FOR CONCRETE BARRIER RAIL ONLY					
BAR	NO.	SIZE	TYPE	LENGTH	WEIGHT
* B1	198	#5	STR	23'-4"	4819
* B2	44	#5	STR	9'-11"	455
* B3	44	#5	STR	13'-1"	600
* S1	506	#5	1	4'-7"	2419
* S2	498	#5	2	7'-0"	3636
* S3	8	#5	2	5'-4"	45
* EPOXY COATED REINFORCING STEEL				LBS.	11,974
CLASS AA CONCRETE				C.Y.	68.9
CONCRETE BARRIER RAIL				LIN. FT.	506.55

PROJECT NO. U-2579C  
FORSYTH COUNTY  
 STATION: 473+70.00 -L-

SHEET 2 OF 2

STATE OF NORTH CAROLINA  
 DEPARTMENT OF TRANSPORTATION  
 RALEIGH

**3'-6" CONCRETE BARRIER RAIL**  
 (RIGHT LANE)



DRAWN BY : T. L. AVERETTE DATE : 3/02/17  
 CHECKED BY : H. T. BARBOUR DATE : 3/14/17  
 DESIGN ENGINEER OF RECORD : H. A. LOCKLEAR DATE : 6/2017

DOCUMENT NOT CONSIDERED FINAL UNLESS ALL SIGNATURES COMPLETED

REVISIONS						SHEET NO.
NO.	BY:	DATE:	NO.	BY:	DATE:	S4-18
1			3			TOTAL SHEETS
2			4			33