

PROJECT REFERENCE NO. U-2579C	SHEET NO. 8
RW SHEET NO.	
ROADWAY DESIGN ENGINEER	HYDRAULICS ENGINEER
DOCUMENT NOT CONSIDERED FINAL UNLESS ALL SIGNATURES COMPLETED	

PAVED SHOULDER

NOTE:
 FOR -L- PROFILE, SEE SHEET 18
 FOR -YIRPD- PROFILE, SEE SHEET 27
 FOR -SRSA- PROFILE, SEE SHEET 33
 FOR DRAINAGE DETAILS, SEE SHEETS 2D-1 TO 2D-4
 FOR CULVERT PLANS, SEE SHEETS C2-1 TO C2-5

-L-
 Pls Sta 419+61.31 PI Sta 431+38.42 Pls Sta 442+77.35
 $\Delta = 1'52''13.3''$ $\Delta = 26'23''06.6''(LT)$ $\Delta = 1'52''13.3''$
 $L_s = 300.00'$ $D = 1'14''48.9''$ $L_s = 300.00'$
 $LT = 200.01'$ $L = 2,116.03'$ $LT = 200.01'$
 $ST = 100.01'$ $T = 1,077.12'$ $ST = 100.01'$
 $R = 4,595.00'$
 $SE = 05$
 $RO = \text{SEE PLANS}$

FARRELL B. & MARILYN BYERS
DB 1242 PG 1262

FARRELL B. & MARILYN BYERS
DB 1346 PG 1549

LEE ANN HOLDER &
JEFFREY H. HOLDER, JR.
DB 2264 PG 2181

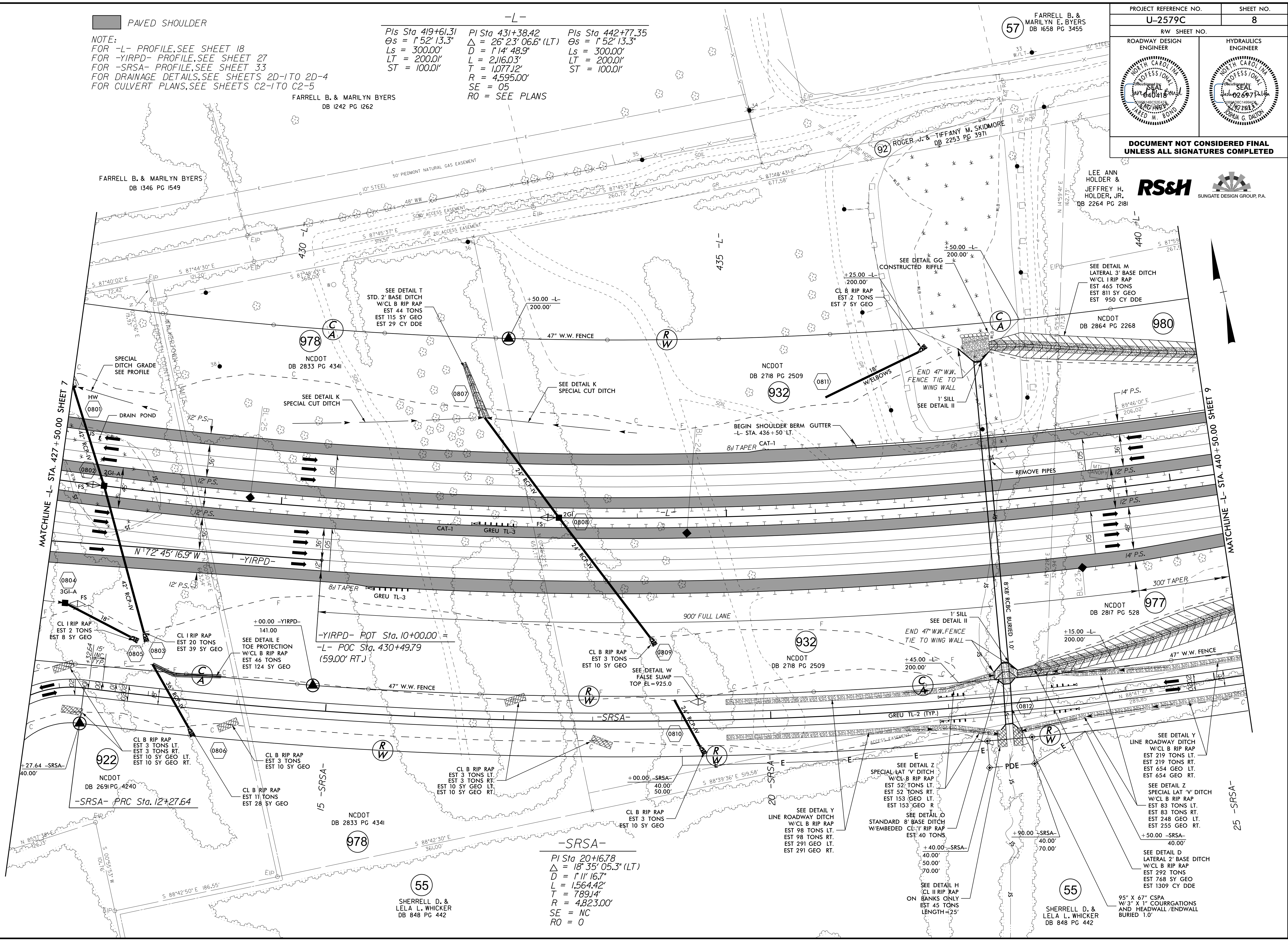

MATCHLINE -L- STA. 427 + 50.00 SHEET 7

MATCHLINE -L- STA. 440 + 50.00 SHEET 9

-YIRPD- POT Sta. 10+00.00 =
 -L- POC Sta. 430+49.79
 (59.00' RT.)

-SRSA-
 PI Sta 20+16.78
 $\Delta = 18'35''05.3''(LT)$
 $D = 1'11''16.7''$
 $L = 1,564.42'$
 $T = 789.14'$
 $R = 4,823.00'$
 $SE = NC$
 $RO = 0$

55
SHERRELL D. &
LELA L. WHICKER
DB 848 PG 442

55
SHERRELL D. &
LELA L. WHICKER
DB 848 PG 442

REVISIONS

07-AUG-2017 14:31
 R:\Projects\2017\U-2579C_psh_8.dgn
 \$\$\$\$\$\$