

MSE ABUTMENT WALL WITH PRECAST PANELS - TYPICAL SECTION

*SEE ROADWAY PLANS FOR FINISHED GRADE DETAILS.
 **SEE MSE RETAINING WALLS PROVISION AND MSE WALL NOTES FOR EMBEDMENT AND REINFORCEMENT LENGTH REQUIREMENTS.

GEOTECHNICAL ENGINEER
 NORTH CAROLINA PROFESSIONAL SEAL 040231
 MATTHEW J. ALEXANDER
 ENGINEER
 DATE: 8/10/2017
 SIGNATURE: _____ DATE: _____
DOCUMENT NOT CONSIDERED FINAL UNLESS ALL SIGNATURES COMPLETED

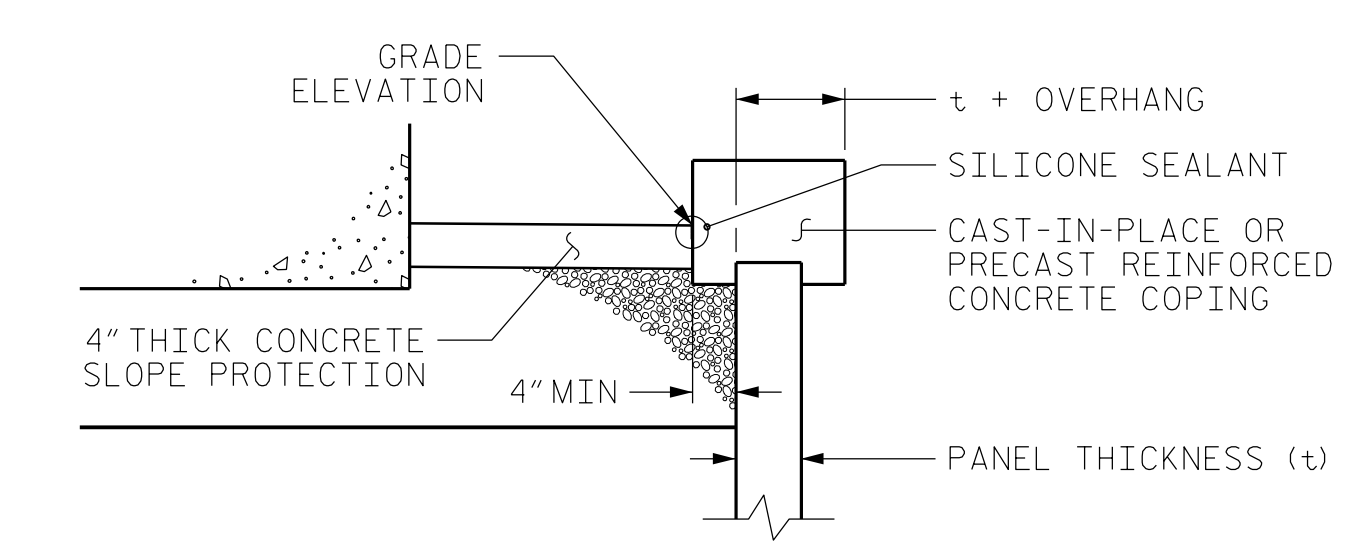
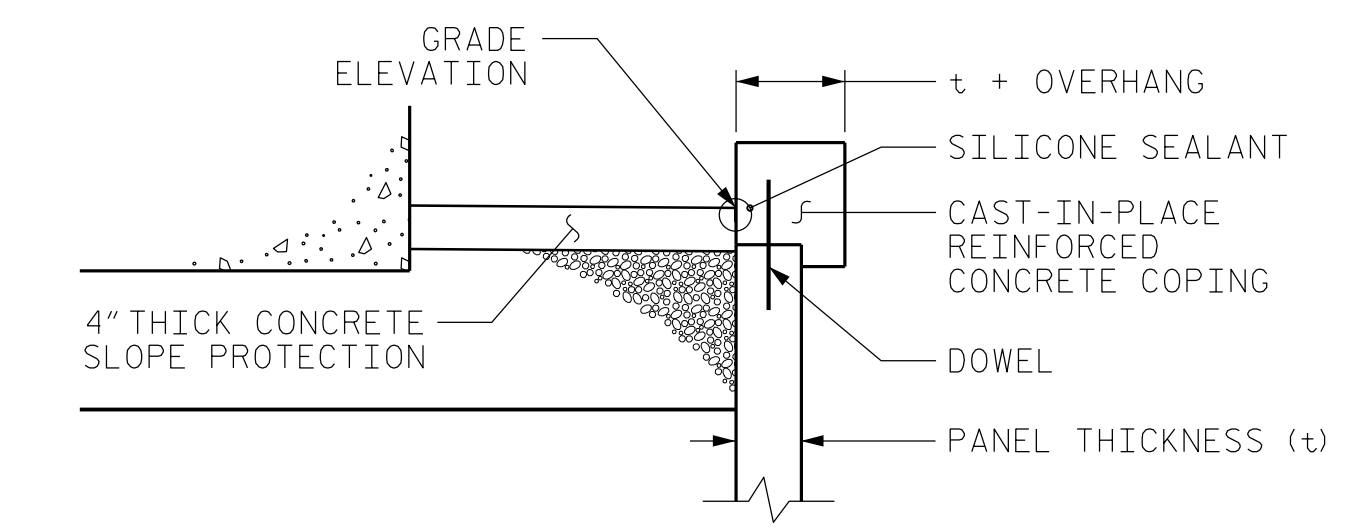

COPING DETAILS

AT THE CONTRACTOR'S OPTION, CONNECT COPING TO PANELS WITH DOWELS OR EXTEND COPING DOWN BACK OF PANELS.

PROJECT NO.: 34243.1.4 (I-4729A)
 POLK COUNTY
 STATION: VARIES
 SHEET 7 OF 8

Terracon
 Consulting Engineers & Scientists
 2401 BRENTWOOD ROAD, SUITE 107
 RALEIGH, NORTH CAROLINA 27604
 PHONE: (919) 873-2211 FAX: (919) 873-9555
 NC REGISTERED FIRM: F-0869

MSE RETAINING WALLS NO. 1, NO. 2, NO. 3, AND NO. 4 TYPICAL SECTION AT BRIDGE ABUTMENT

REVISIONS						SHEET NO.
NO.	BY	DATE	NO.	BY	DATE	
1			3			W-7
2			4			

PREPARED BY: M. J. ALEXANDER	DATE: 8/4/2017
REVIEWED BY: A. F. RIGGS	DATE: 8/4/2017