

PLAN OF APPROACH SLAB AT END BENT 1

PLAN OF APPROACH SLAB AT END BENT 2

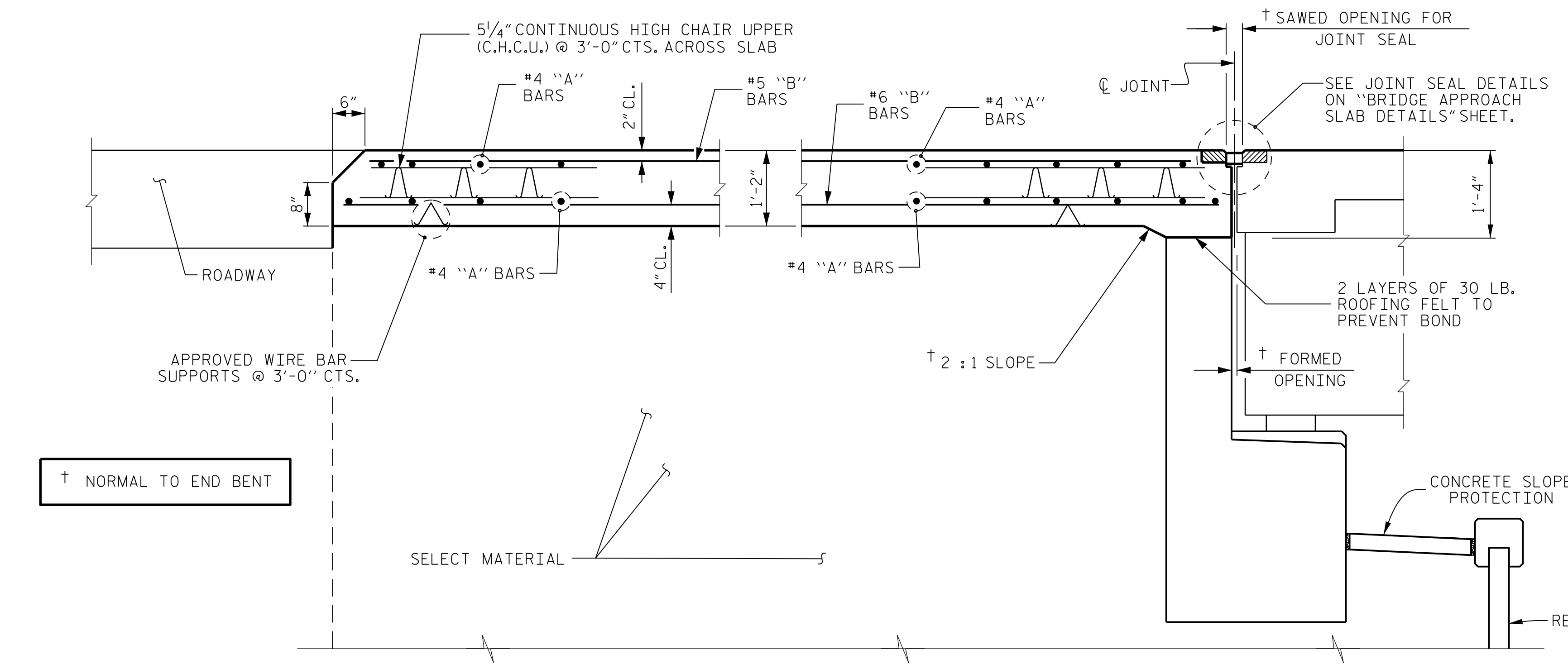

SECTION THRU SLAB

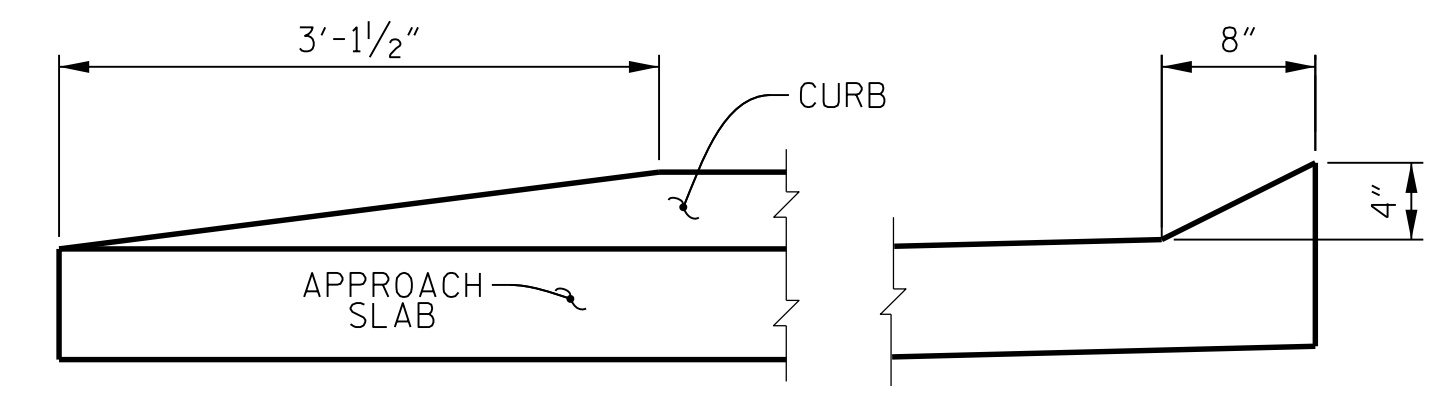

CURB DETAILS

ASSEMBLED BY :	K. E. LOFTON	DATE :	5-17
CHECKED BY :	A. D. SHAH	DATE :	7-17
DRAWN BY :	TLA	10/05	REV. 10/11
CHECKED BY :	GM	5/06	REV. 12/21/11
			REV. 6/13

DRAWN BY :	K. E. LOFTON	DATE :	5-17
CHECKED BY :	A. D. SHAH	DATE :	7-17
DESIGN ENGINEER :	A. D. SHAH	DATE :	8-17

PLANS PREPARED BY :

PARSONS

5540 CenterView Drive, Suite 217
Raleigh, NC 27606-3386
NC LICENSE No. F-0246

FOR NORTH CAROLINA DEPARTMENT OF TRANSPORTATION

DOCUMENT NOT CONSIDERED FINAL
UNLESS ALL SIGNATURES COMPLETED

NORTH CAROLINA
PROFESSIONAL
SEAL
029979
A. D. SHAH
8/10/2017

BILL OF MATERIAL

APPROACH SLAB AT END BENT 1

BAR No.	SIZE	TYPE	LENGTH	WEIGHT
*A1	50	#4	STR 22'-6"	752
A2	52	#4	STR 22'-4"	776
*B1	67	#5	STR 24'-1"	1,683
B2	67	#6	STR 24'-8"	2,482
REINFORCING STEEL				3,258 LBS.
*EPOXY COATED REINFORCING STEEL				2,435 LBS.
CLASS "AA" CONCRETE				36.7 CU. YDS.

APPROACH SLAB AT END BENT 2

BAR No.	SIZE	TYPE	LENGTH	WEIGHT
*A3	50	#4	STR 20'-8"	690
A4	52	#4	STR 20'-6"	712
*B1	67	#5	STR 24'-1"	1,683
B2	67	#6	STR 24'-8"	2,482
REINFORCING STEEL				3,194 LBS.
*EPOXY COATED REINFORCING STEEL				2,373 LBS.
CLASS "AA" CONCRETE				36.5 CU. YDS.

NOTES

APPROACH SLAB SHALL NOT BE CONSTRUCTED PRIOR TO COMPLETION OF THE BRIDGE DECK.

AREA BETWEEN THE WINGWALL AND APPROACH SLAB SHALL BE GRADED TO DRAIN THE WATER AWAY FROM THE FILL FACE OF THE BRIDGE AND SHALL BE PAVED. SEE ROADWAY PLANS.

THE JOINT SHALL BE SAWS PRIOR TO THE CASTING OF THE BARRIER RAIL.

SELECT BACKFILL MATERIAL SHALL BE THE AGGREGATE USED IN THE REINFORCED ZONE FOR THE MSE RETAINING WALL.

REINFORCED BRIDGE APPROACH FILLS ARE NOT REQUIRED AT END BENTS DUE TO MSE WALL REINFORCEMENT CONNECTED TO THE BACKWALL OF THE END BENT CAP.

FOR ARC OFFSETS, SEE SHEET 2 OF 2.

WITH FOAM JOINT SEAL

FOR FOAM JOINT SEALS, SEE SPECIAL PROVISIONS.

THE NOMINAL UNCOMPRESSED SEAL WIDTH OF THE FOAM JOINT SEAL SHALL BE 2 1/2".

FOR ELASTOMERIC CONCRETE, SEE SPECIAL PROVISIONS.

PROJECT NO. **I-4729A**

POLK COUNTY

STATION: **22+87.20 -RP_E-**

SHEET 1 OF 2

STATE OF NORTH CAROLINA
DEPARTMENT OF TRANSPORTATION
RALEIGH

STANDARD

BRIDGE APPROACH SLAB FOR FLEXIBLE PAVEMENT

REVISIONS						SHEET No.
No.	BY:	DATE:	No.	BY:	DATE:	ST-22
1			3			TOTAL SHEETS
2			4			24