

8/17/99

8/28/2017 09:41:53 EC_dsn_psh_06.cgd.dgn

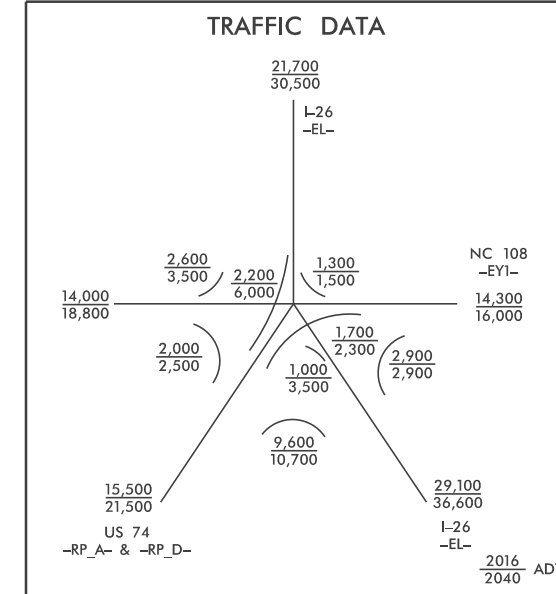

PROJECT REFERENCE NO.	SHEET NO.
I-4725A	EC-06/CONST.06
ROADWAY DESIGN ENGINEER	HYDRAULICS ENGINEER

CLEARING AND GRUBBING
EROSION CONTROL FOR
CONSTRUCTION SHEET 06

NOTE: PLACE TEMPORARY ROCK SEDIMENT DAMS TYPE - B AND TEMPORARY ROCK SET CHECKS TYPE - A AT DRAINAGE OUTLETS.

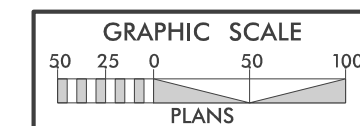
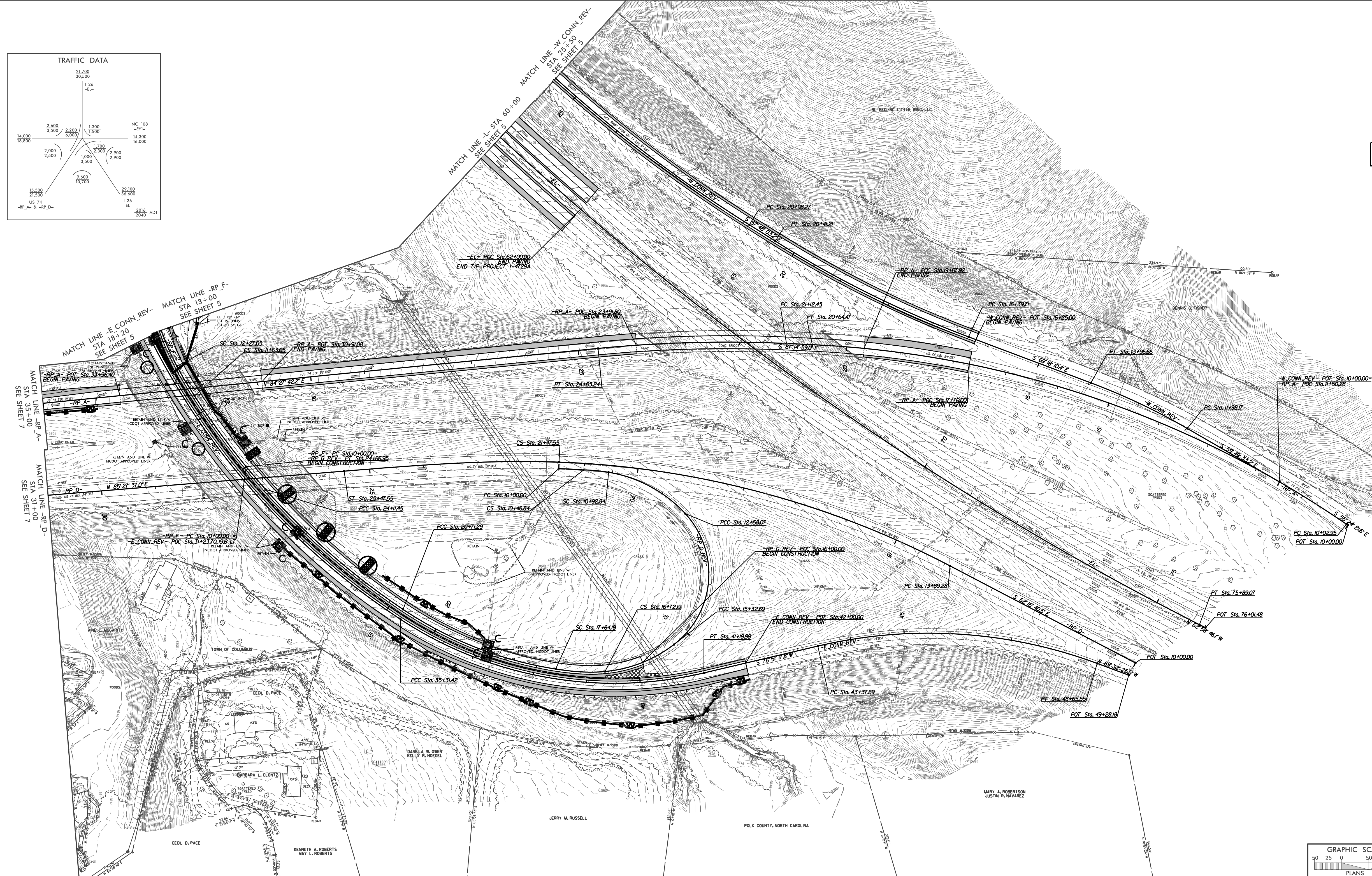

LOCATION: I-74 INTERCHANGE MODIFICATION BY THE TOWN OF COLUMBUS	
TP NO. I-4725A	COUNTY: POLK
DESIGNED BY: J. MATTHEW PICKENS, PE	
CHECKED BY: DAVID L. WELVE, PE DATE	