

PROJECT REFERENCE NO.	SHEET NO.
U-4751	2D-4
RW SHEET NO.	
HYDRAULICS ENGINEER	
DOCUMENT NOT CONSIDERED FINAL UNLESS ALL SIGNATURES COMPLETED	

DETAIL 58 REMOVABLE ORIFICE TRASH RACK

NOT TO SCALE

SEE PLAN SHEET 6 & 2D-3 FOR DETAIL

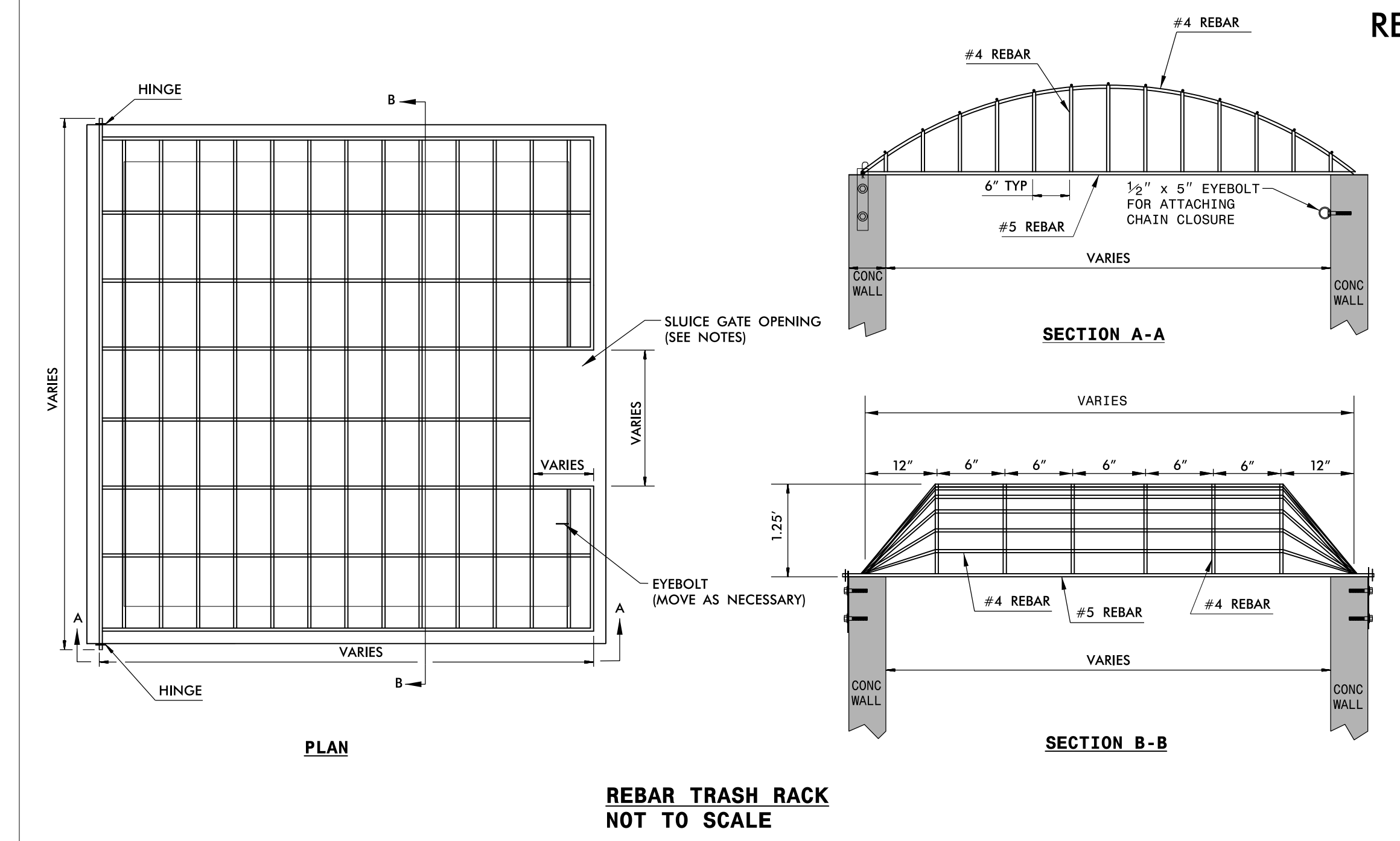

- RISER TRASH RACK NOTES:**
- ALL JOINTS SHALL BE FULLY WELDED AROUND JOINT WITH A MINIMUM OF A 1/4" BEAD.
 - IF BOLTS ARE ANCHORED IN CONCRETE, FOLLOW STD. DWG. 862.03 AND 862.04 FOR ANCHORING PROCEDURE.
 - EYEBOLT FOR CHAIN CLOSURE SHALL BE INSTALLED BY THE SAME METHOD AS THE HINGE PLATE BOLTS.
 - RACK AND HARDWARE SHALL BE ALUMINUM OR REBAR AND GALVANIZED IN ACCORDANCE WITH ASTM A-153.
 - PROVIDE OPENING IN TRASH RACK TO ACCOMMODATE SLUICE GATE ON THE OUTLET PIPE. ENSURE TRASH RACK OPENS FREELY AND WITHOUT INTERFERENCE WITH SLUICE GATE.
 - TRASH RACK IS INCIDENTAL TO THE MASONRY DRAINAGE STRUCTURE.

DETAIL 59 WET DETENTION BASIN

NOT TO SCALE

SEE PLAN SHEET 6

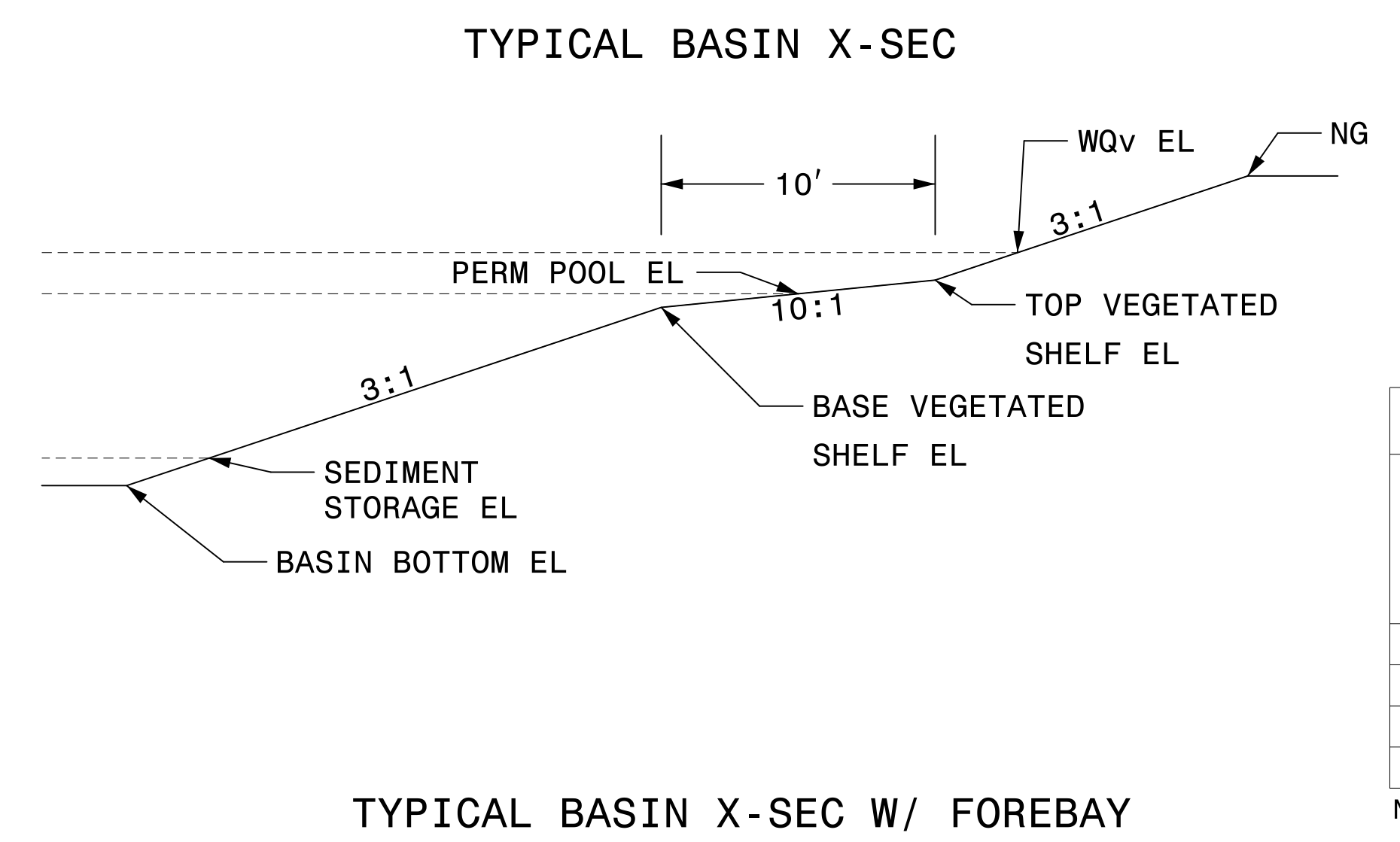

STATION	BASIN BOTTOM EL	SEDIMENT STORAGE EL	PERMANENT POOL EL	WQv EL	BASE VEGETATED SHELF EL	TOP VEGETATED SHELF EL	FOREBAY BOTTOM EL	BASIN BOTTOM DIMENSIONS (LXW)	FOREBAY BOTTOM DIMENSIONS (LXW)	WQ VOLUME (CF)	PERM POOL VOLUME (CF)	PERM POOL SURFACE AREA (SF)
-Y1- 45+ 42 RT	35.00	36.00	39.20	40.70	38.70	39.70	35.00	138.0 X 86.0	63.0 X 5.0	35,114	59,246	21,048
-Y1- 48+ 20 RT	35.00	36.00	39.20	40.70	38.70	39.70	NA	256.0 X 57.0	NA	42,359	79,453	25,291

NOTE: ALL DIMENSIONS ARE IN FEET UNLESS OTHERWISE NOTED.

