

BILL OF MATERIAL					
END BENT 2					
BAR	NO.	SIZE	TYPE	LENGTH	WEIGHT
B1	8	#9	1	45'-8"	1242
B2	20	#4	STR	22'-11"	306
B3	10	#4	STR	3'-2"	21
H1	22	#5	2	13'-0"	298
H2	22	#5	2	13'-1"	300
H3	22	#5	3	12'-10"	294
H4	22	#5	3	12'-11"	296
K1	28	#4	STR	3'-3"	61
S1	47	#4	4	11'-2"	351
S2	47	#4	5	3'-11"	123
S3	32	#4	6	6'-6"	139
V1	46	#4	STR	6'-3"	192
V2	68	#5	STR	10'-9"	762
REINFORCING STEEL				LBS.	4,385
CLASS A CONCRETE					
POUR #1 CAP, LOWER PART OF WINGS, & COLLARS				C.Y.	27.8
POUR #2 UPPER PART OF WINGS				C.Y.	8.0
TOTAL				C.Y.	35.8
HP 12 X 53 STEEL PILES				NO.: 8	LIN. FT. 460

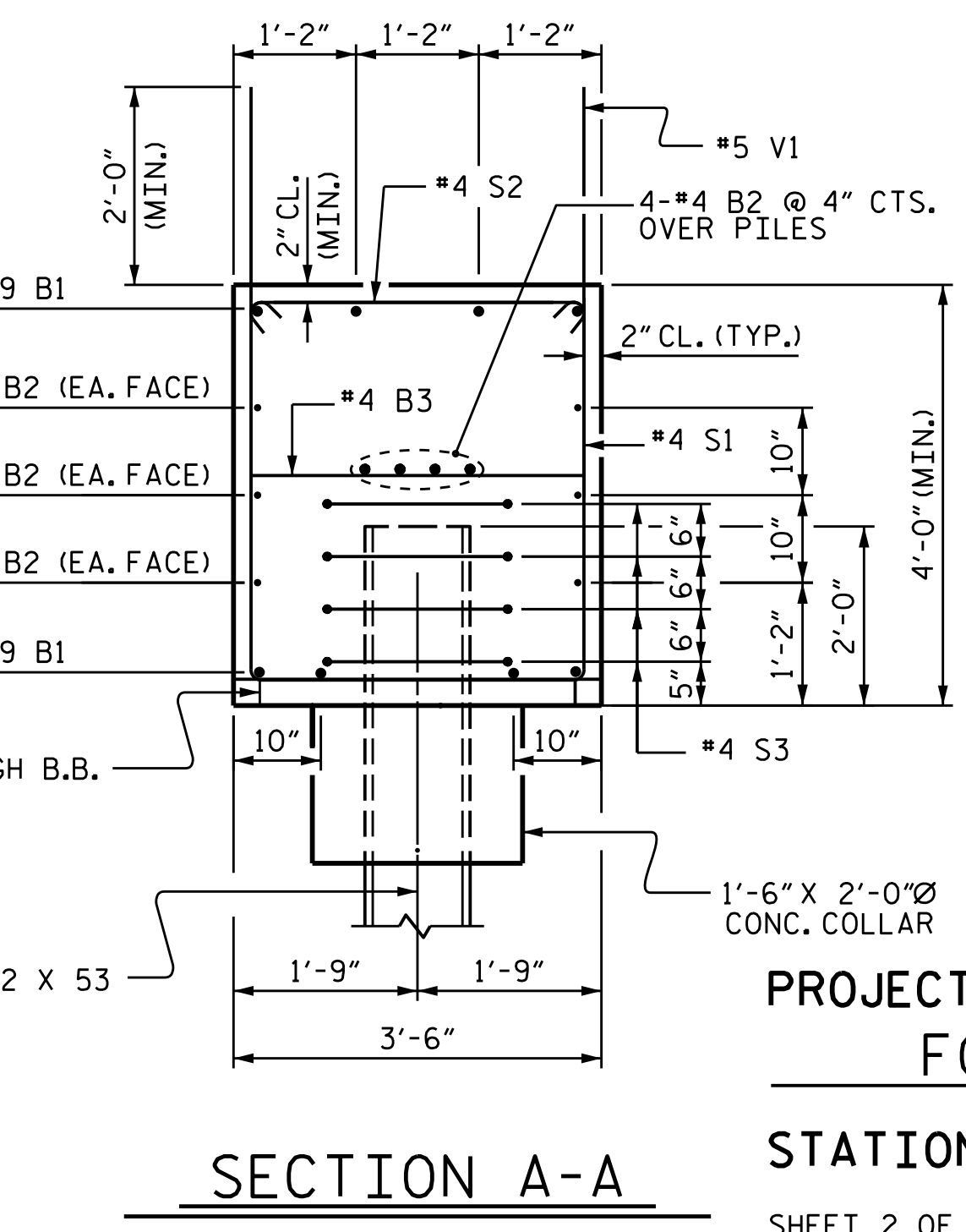

PROJECT NO. U-2579C  
 FORSYTH COUNTY  
 STATION: 21+27.27 -Y2-  
 SHEET 2 OF 2

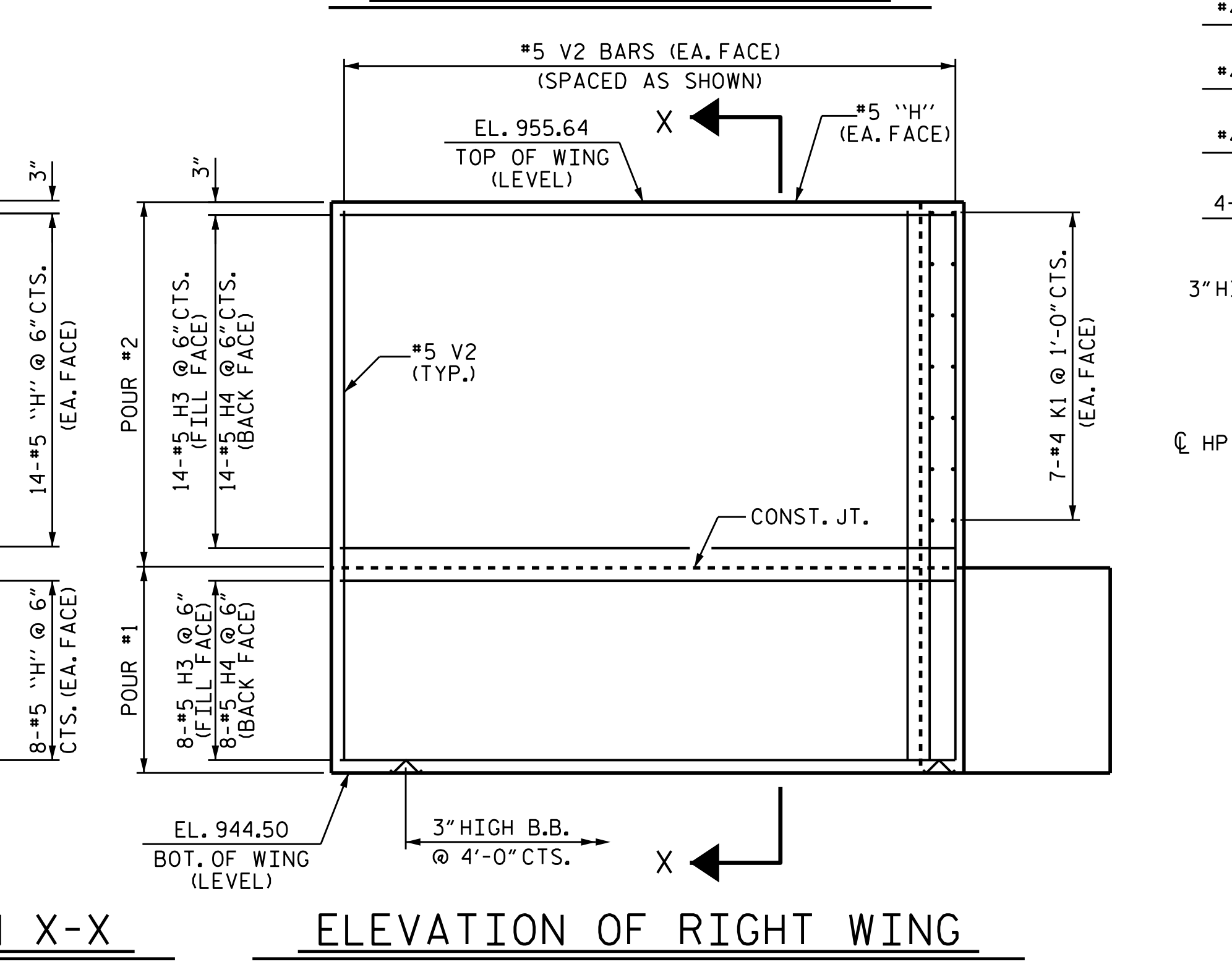
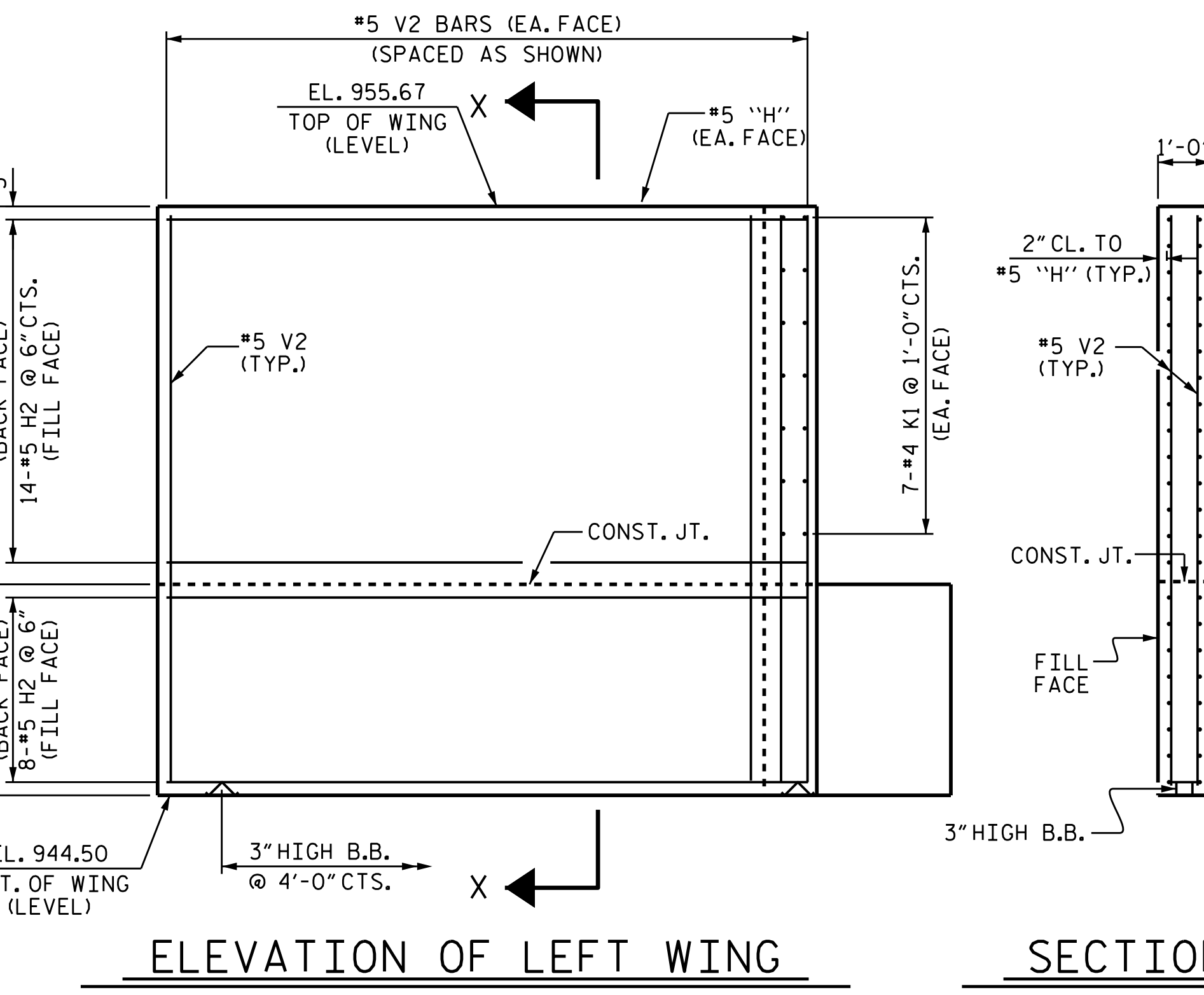
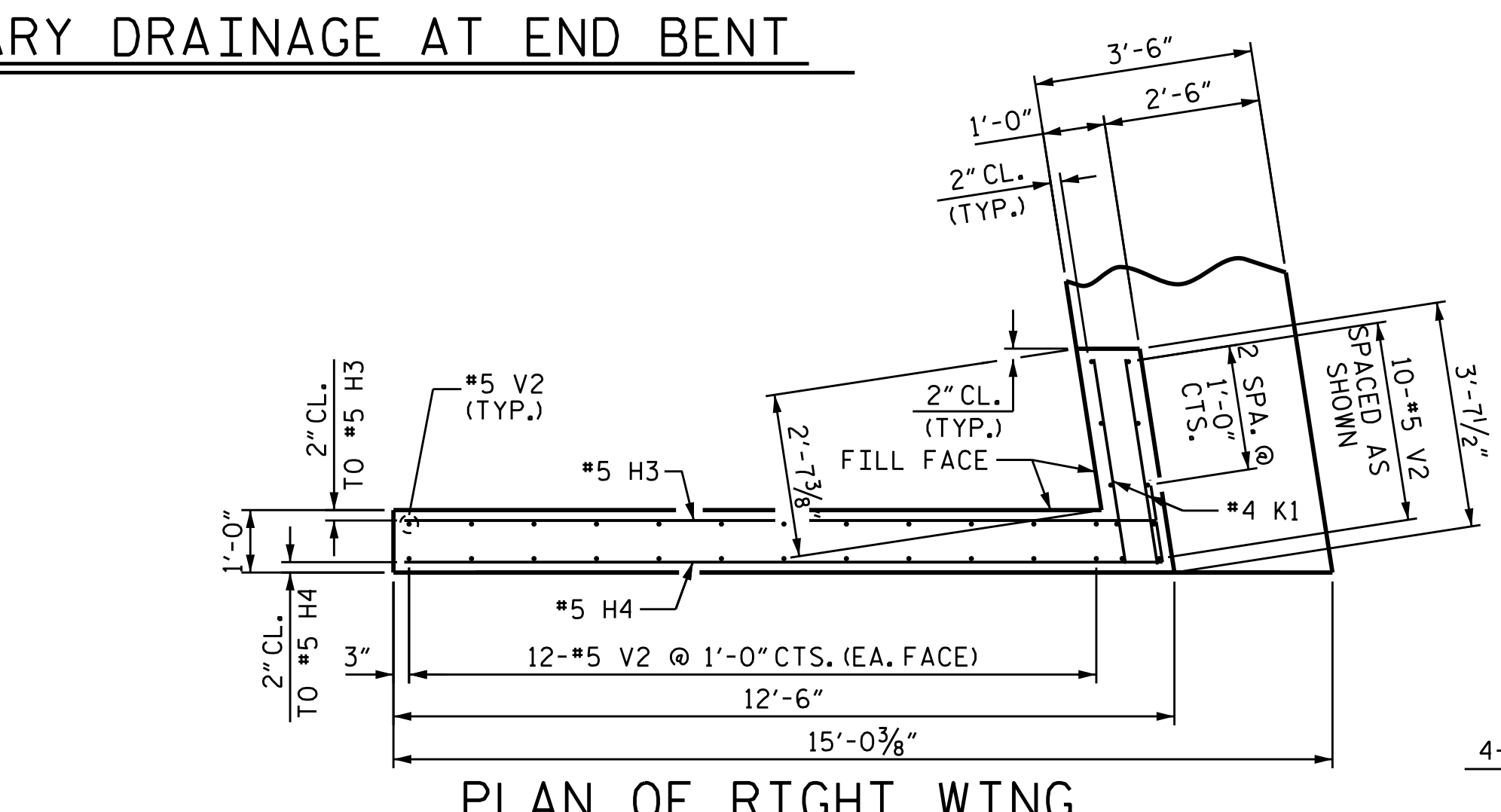
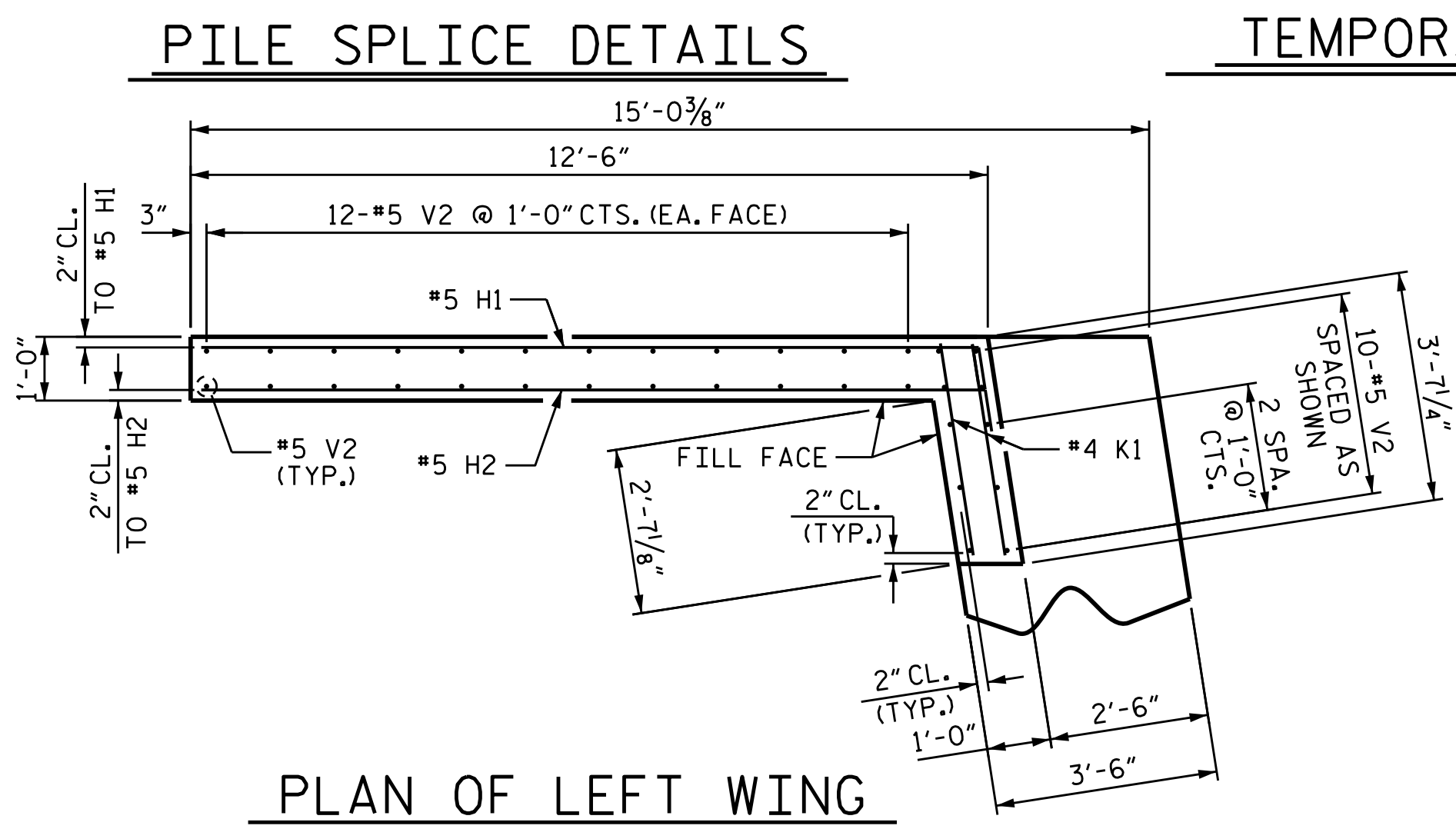
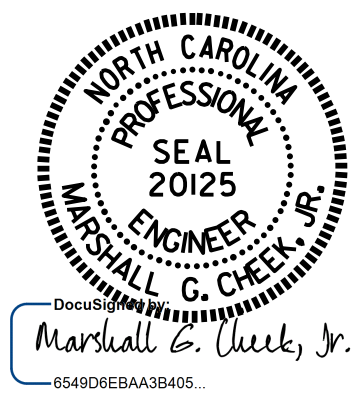

STATE OF NORTH CAROLINA  
 DEPARTMENT OF TRANSPORTATION  
 RALEIGH  
 SUBSTRUCTURE  
 INTEGRAL END BENT 2

DRAWN BY: J. K. BOWLES DATE: 5/10/16  
 CHECKED BY: K. D. LAYNE DATE: 7/21/2016  
 DESIGN ENGINEER OF RECORD: J. K. BOWLES DATE: 7/21/2016

DOCUMENT NOT CONSIDERED FINAL UNLESS ALL SIGNATURES COMPLETED

REVISIONS						SHEET NO.
NO.	BY:	DATE:	NO.	BY:	DATE:	S2-27
1			3			TOTAL SHEETS 30
2			4			