

5/14/99

PROJECT REFERENCE NO. <i>B-5348</i>	SHEET NO. <i>5</i>
ROADWAY DESIGN ENGINEER W. S. HOOD SEAL 014509 NORTH CAROLINA PROFESSIONAL ENGINEER	HYDRAULICS ENGINEER WILLIAM H. BLAM SEAL 019721 NORTH CAROLINA PROFESSIONAL ENGINEER
DocuSigned by <i>W. S. Hood</i>	DocuSigned by <i>William H. Blam, Jr.</i>
<b>DOCUMENT NOT CONSIDERED FINAL UNLESS ALL SIGNATURES COMPLETED</b>	

**BRIDGE HYDRAULIC DATA**

DESIGN DISCHARGE = 1730 CFS  
 DESIGN FREQUENCY = 25 YRS  
 DESIGN HW ELEVATION = 396.30 FT  
 BASE DISCHARGE = 2440 CFS  
 BASE FREQUENCY = 100 YRS  
 BASE HW ELEVATION = 397.42 FT  
 OVERTOPPING DISCHARGE = 6300 CFS  
 OVERTOPPING FREQUENCY = 500+ YRS  
 OVERTOPPING ELEVATION = 403.04 FT

DATE OF SURVEY = 10-29-15  
 W.S. ELEVATION AT DATE OF SURVEY = 387.50 +/- FT

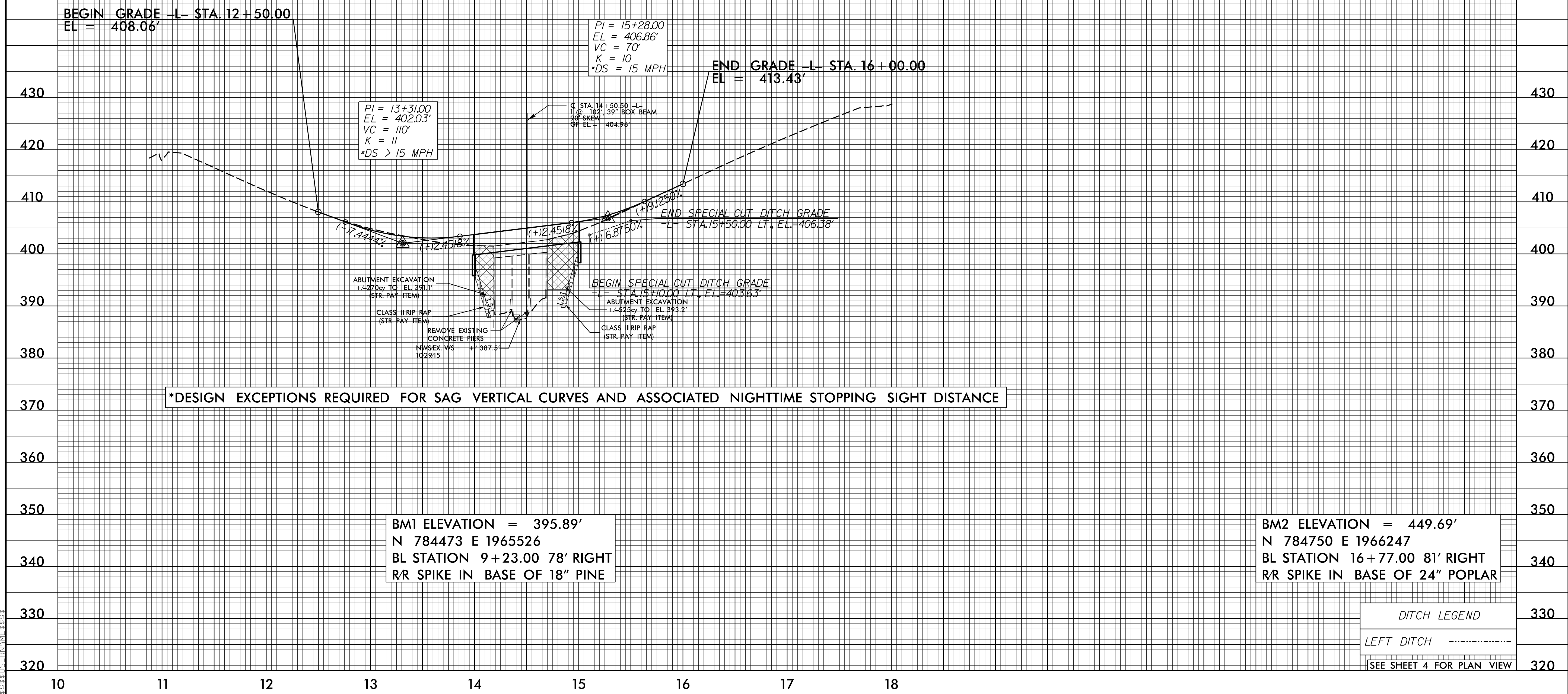

07 JUN 2017 09:09  
P:\ROAD\05348.Rdy\_pfl.dgn  
5/14/99