

8.17.17.99

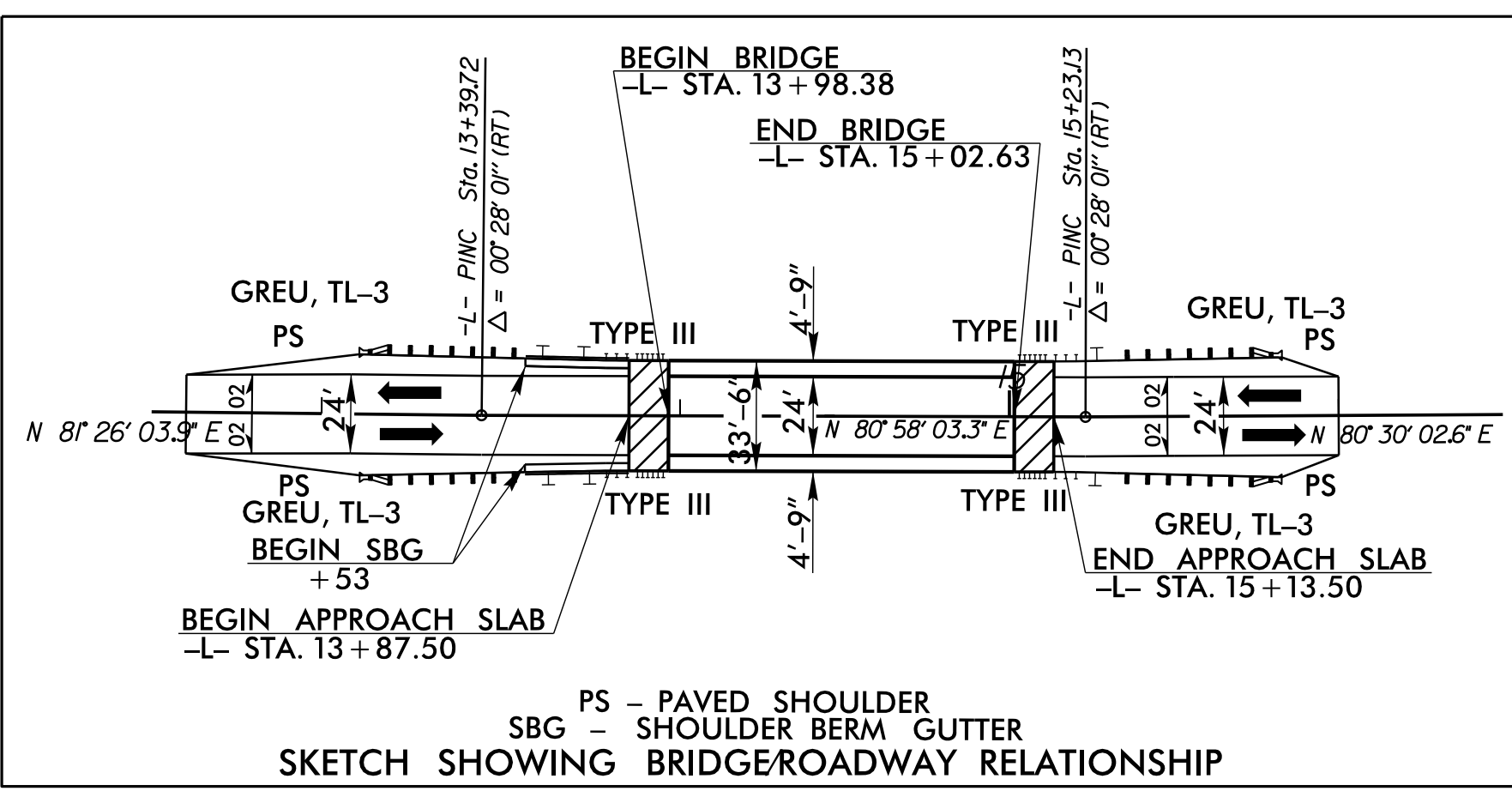

-L-

PI Sta 11+50.27
 $\Delta = 0^\circ 42' 15.0''$ (RT)
 $D = 1' 07' 14.7''$
 $L = 62.83'$
 $T = 31.42'$
 $R = 5,112.28'$
 SE = SEE PLANS

PROJECT REFERENCE NO. B-5348	SHEET NO. 4
RW SHEET NO.	
ROADWAY DESIGN ENGINEER W. S. HOOD SEAL 014509 ENGINEER	HYDRAULICS ENGINEER Wm. H. Elam, Jr. SEAL 019721 ENGINEER
DOCUMENT NOT CONSIDERED FINAL UNLESS ALL SIGNATURES COMPLETED	

**DOCUMENT NOT CONSIDERED FINAL
UNLESS ALL SIGNATURES COMPLETED**

NAD 83 NA 2011

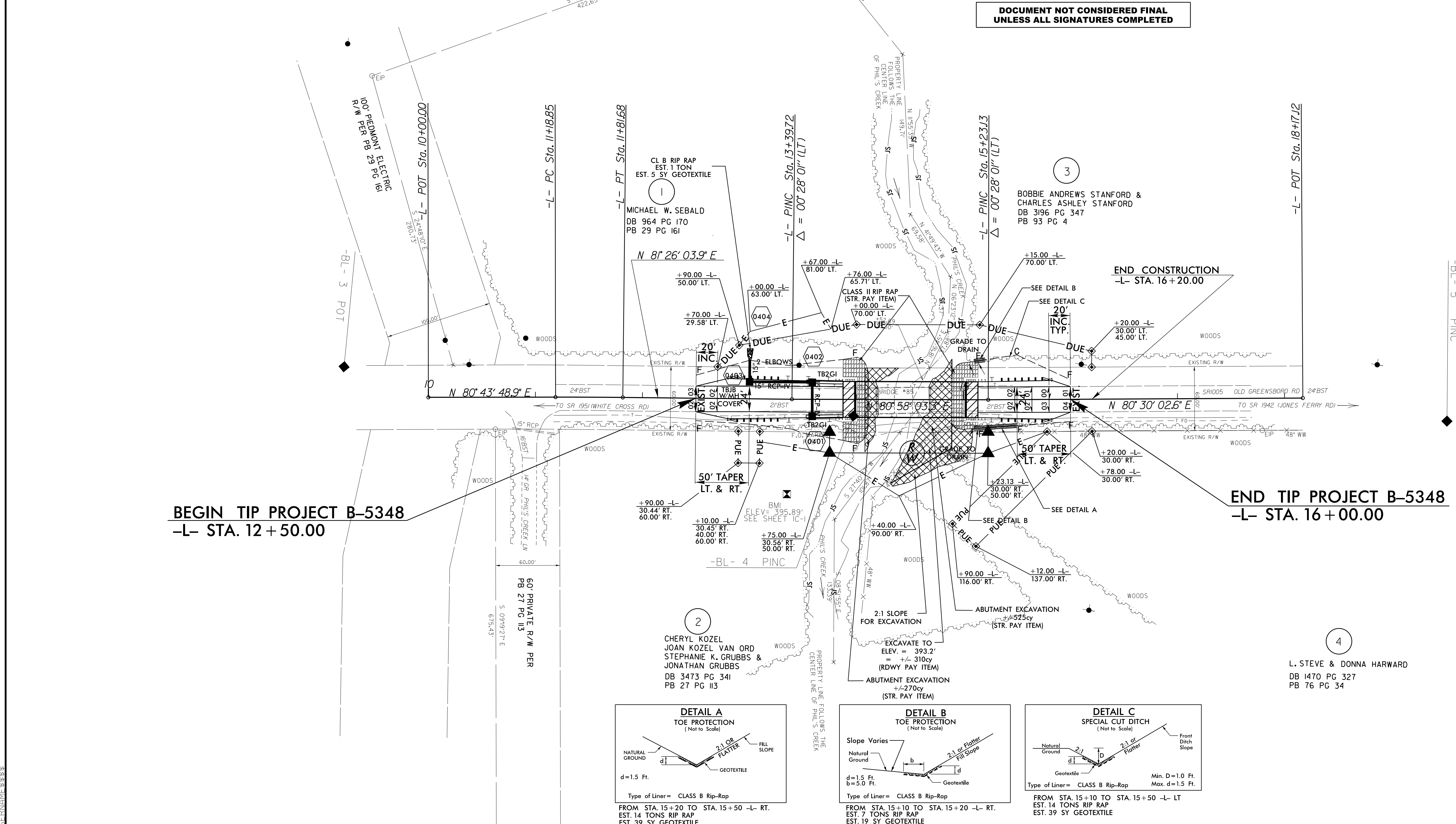

BM2
ELEV. = 449.69'
SEE SHEET 1C-1

**BEGIN TIP PROJECT B-5348
-L- STA. 12+50.00**

**END TIP PROJECT B-5348
-L- STA. 16+00.00**

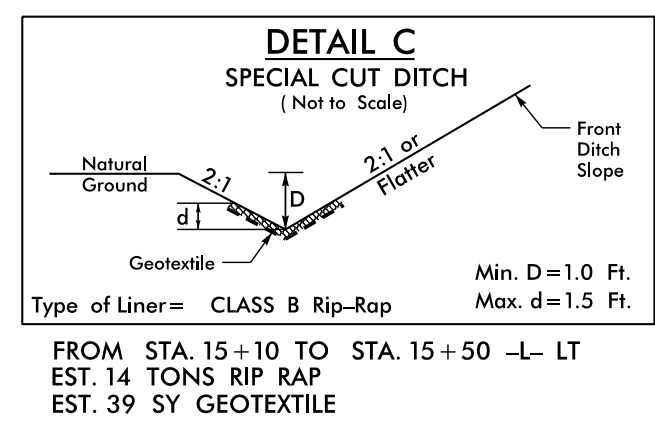
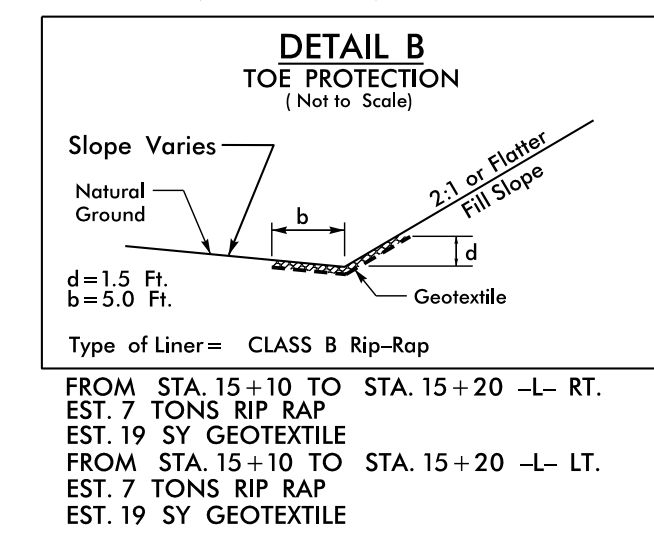
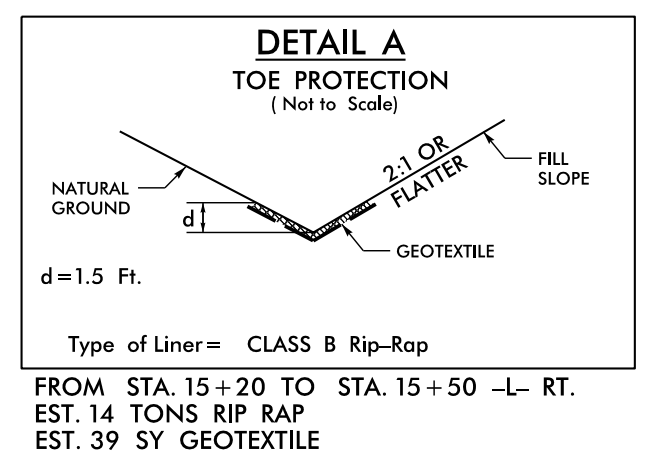

SEE SHEET 5 FOR PROFILE
SEE SHEETS S-1 THRU S-18 FOR STRUCTURE PLANS

07-JUN-2017 09:08
R:\Roadwork\B5348_Rdw_psh4.dgn
W.S. Hood