

STATE	STATE PROJECT REFERENCE NO.	SHEET NO.	TOTAL SHEETS
N.C.	B-5348	1	
STATE PROJ. NO.	F.A. PROJ. NO.	DESCRIPTION	
46062.1.1	BRSTP-1005(31)	P.E.	
46062.2.1		RW & UTILITIES	
46062.3.1		CONSTR.	

STATE OF NORTH CAROLINA
DIVISION OF HIGHWAYS

ORANGE COUNTY

**LOCATION: BRIDGE NO. 85 OVER PHIL'S CREEK ON
SR 1005 (OLD GREENSBORO ROAD)**

**TYPE OF WORK: GRADING, DRAINAGE, PAVING
AND STRUCTURE**

TIP PROJECT: B-5348

CONTRACT: C203946

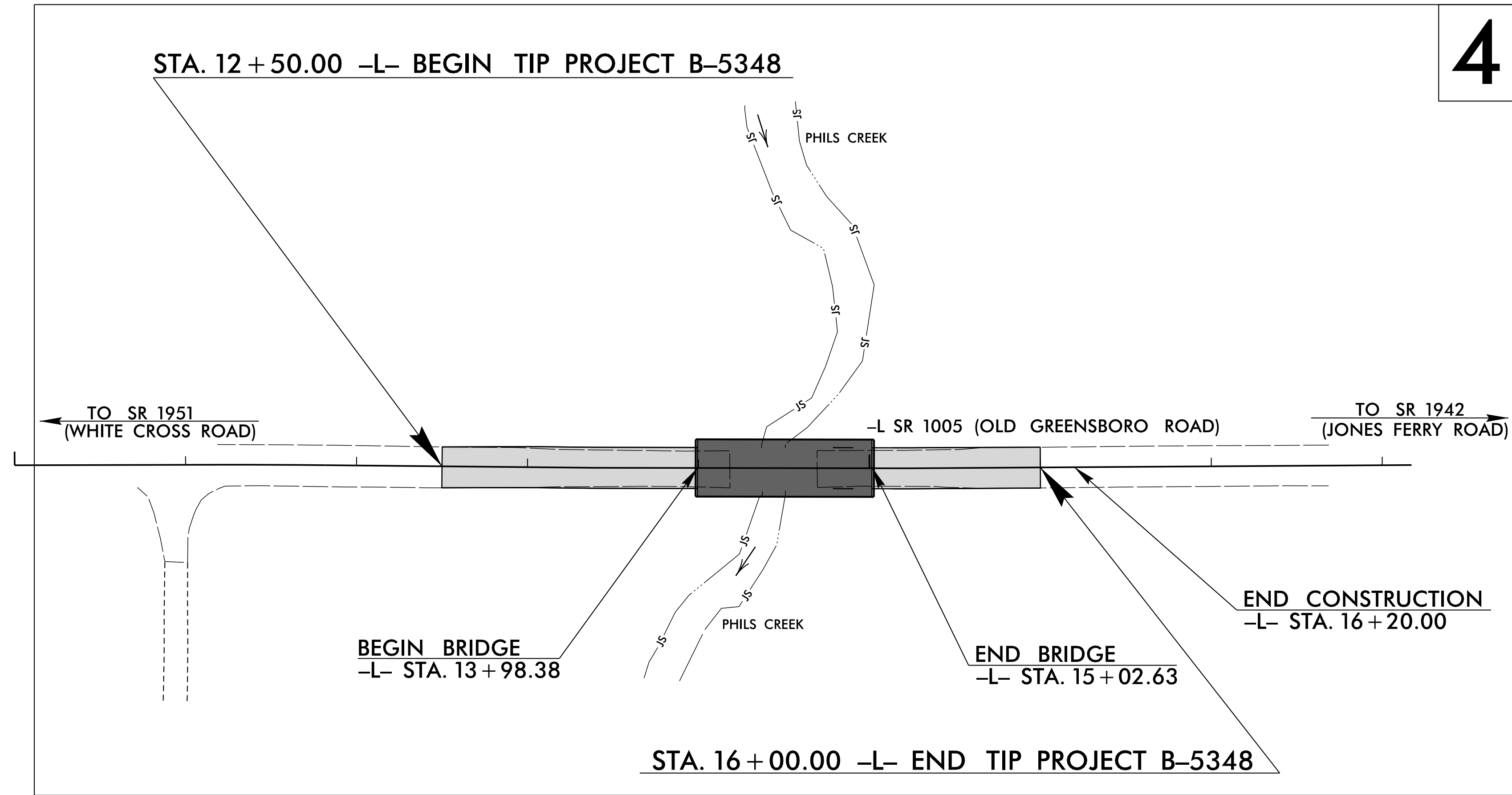
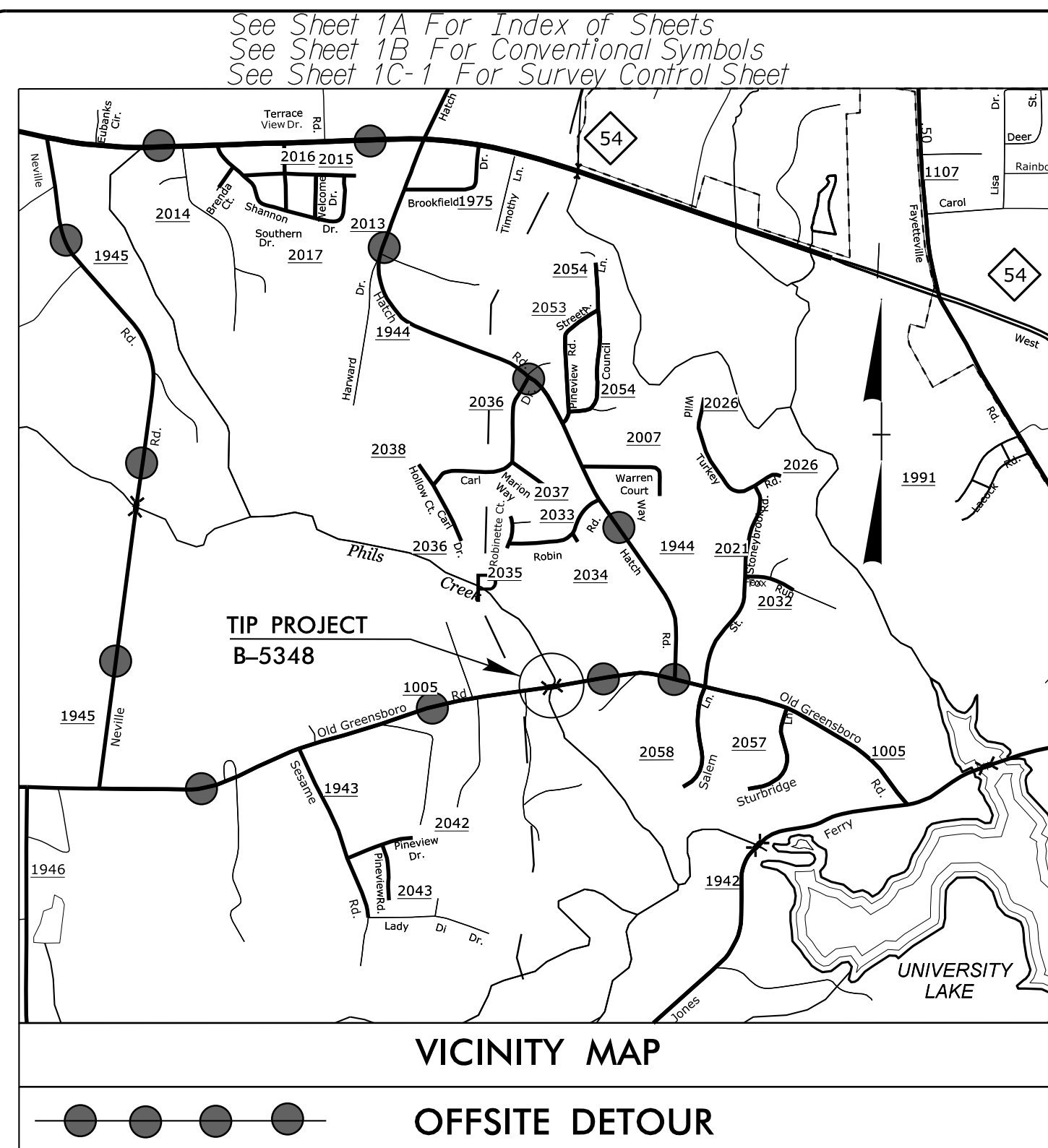

*DESIGN EXCEPTION REQUIRED FOR SAG VERTICAL CURVES AND ASSOCIATED NIGHTTIME STOPPING SIGHT DISTANCE.

DOCUMENT NOT CONSIDERED FINAL UNLESS ALL SIGNATURES COMPLETED

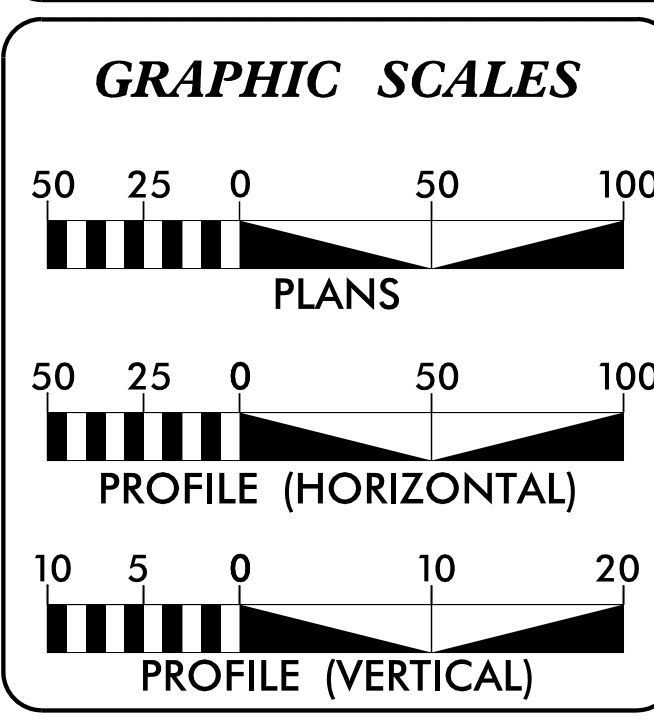

DESIGN DATA

ADT 2017 = 4,575
ADT 2037 = 5,940
K = 9 %
D = 65 %
T = 3 % *
V = 50 MPH
* TTST = 1% DUAL = 2%
FUNC CLASS = COLLECTOR
"SUB-REGIONAL TIER"

PROJECT LENGTH

LENGTH ROADWAY TIP PROJECT B-5348 = 0.046 MI.
LENGTH STRUCTURE TIP PROJECT B-5348 = 0.020 MI.
TOTAL LENGTH OF TIP PROJECT B-5348 = 0.066 MI.

Plans Prepared for NCDOT by:
AMEC Foster Wheeler Environment & Infrastructure, Inc.
4021 Stirrup Creek Drive, Suite 100
Durham, North Carolina 27703
NC Engineering F-1253 NC Geology C-247
(919) 381-9900

2012 STANDARD SPECIFICATIONS

RIGHT OF WAY DATE:
AUGUST 19, 2016

LETTING DATE:
JULY 18, 2017

BILL HOOD, PE
PROJECT ENGINEER

CHRISTOPHER H. LEE
PROJECT DESIGN ENGINEER

GARY LOVERING, PE
PROJECT ENGINEER
NCDOT ROADWAY DESIGN

HYDRAULICS ENGINEER

DocuSigned by:
Wm. H. Elam, Jr.
SIGNATURE

DocuSigned by:
W. S. Hood
SIGNATURE

ROADWAY DESIGN ENGINEER

6/9/2017

6/9/2017

