

4/3/2017 0:\Transportation\Traffic\NCDOT 10 Bridges TMP\00053591 - B-5332 TMP Bridge Replace 59\TrafficControl\TCP\B-5332 TCP 03.dgn User:STOUTJ940

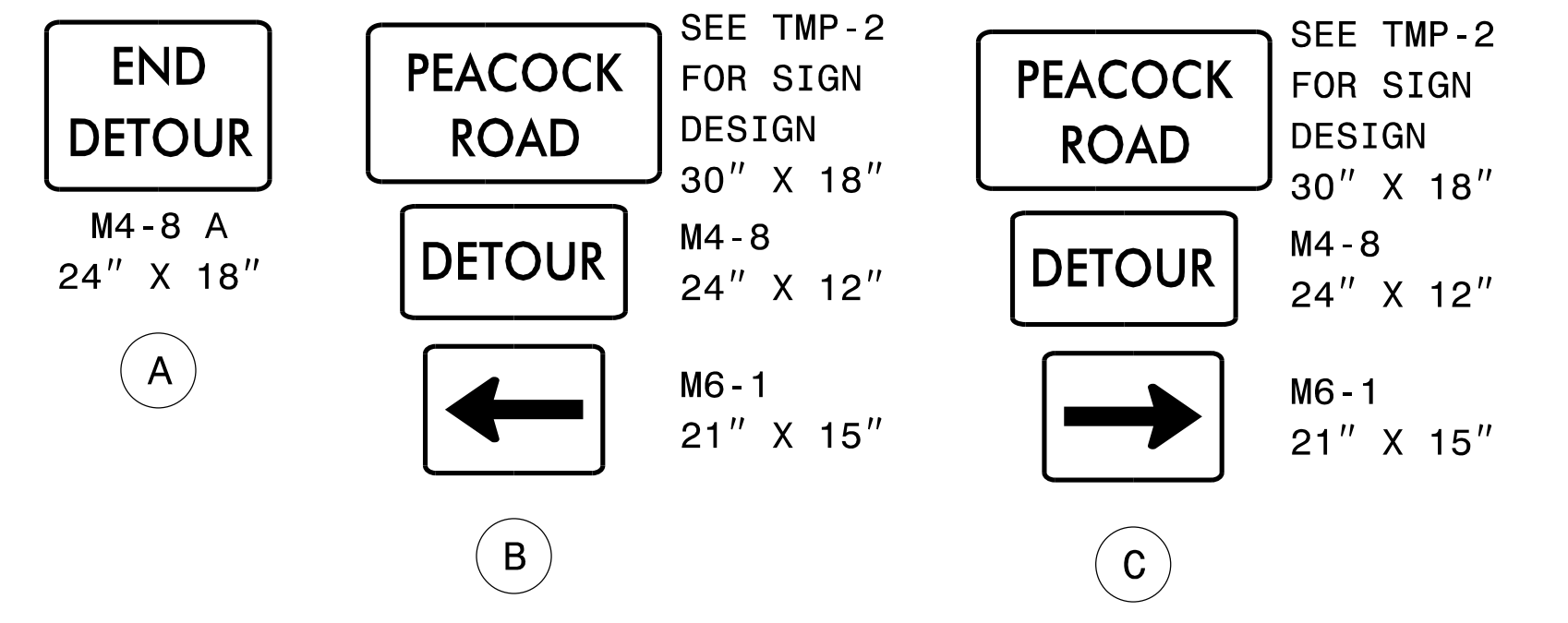
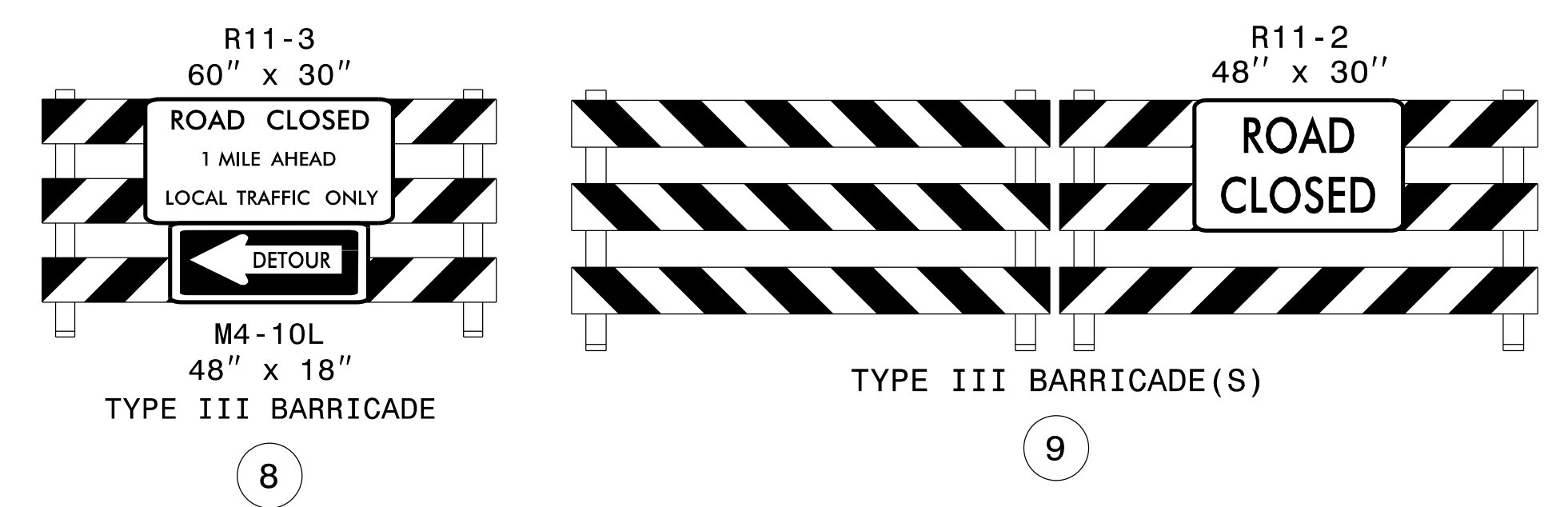
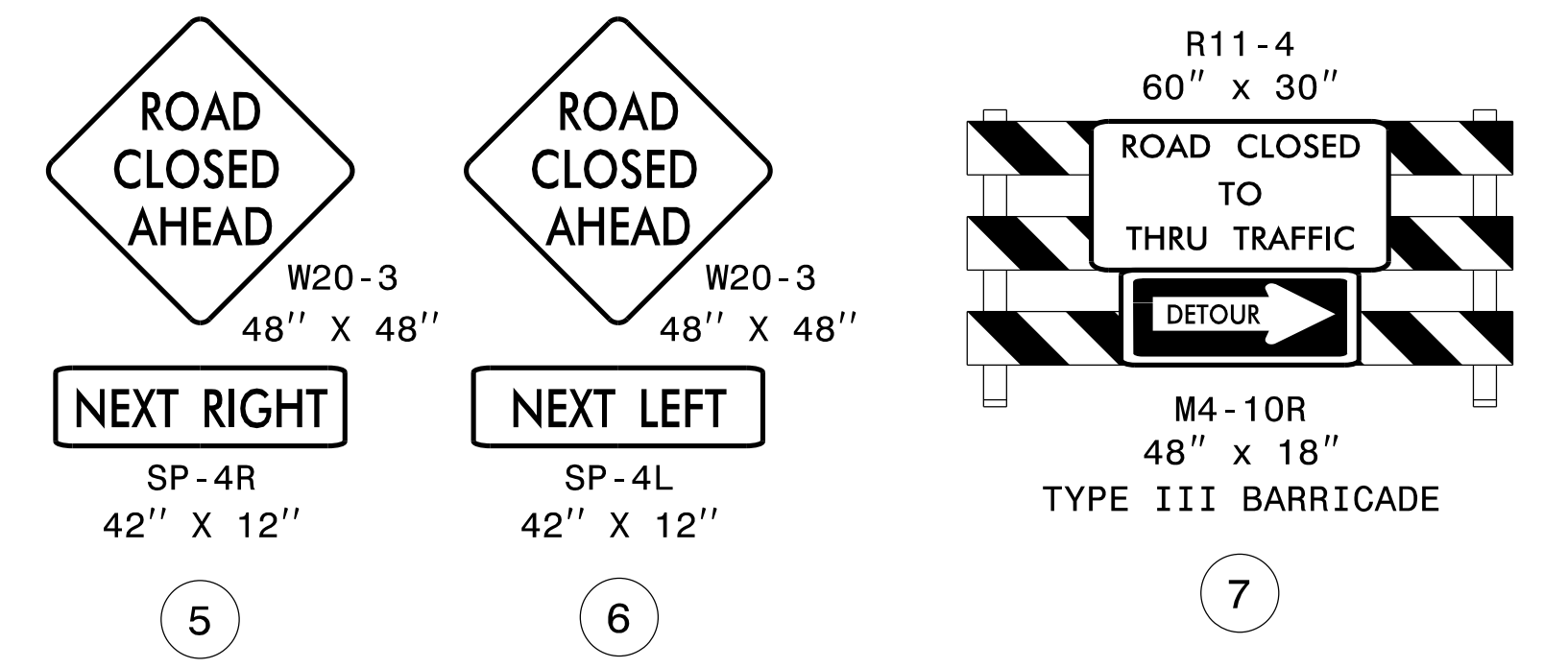
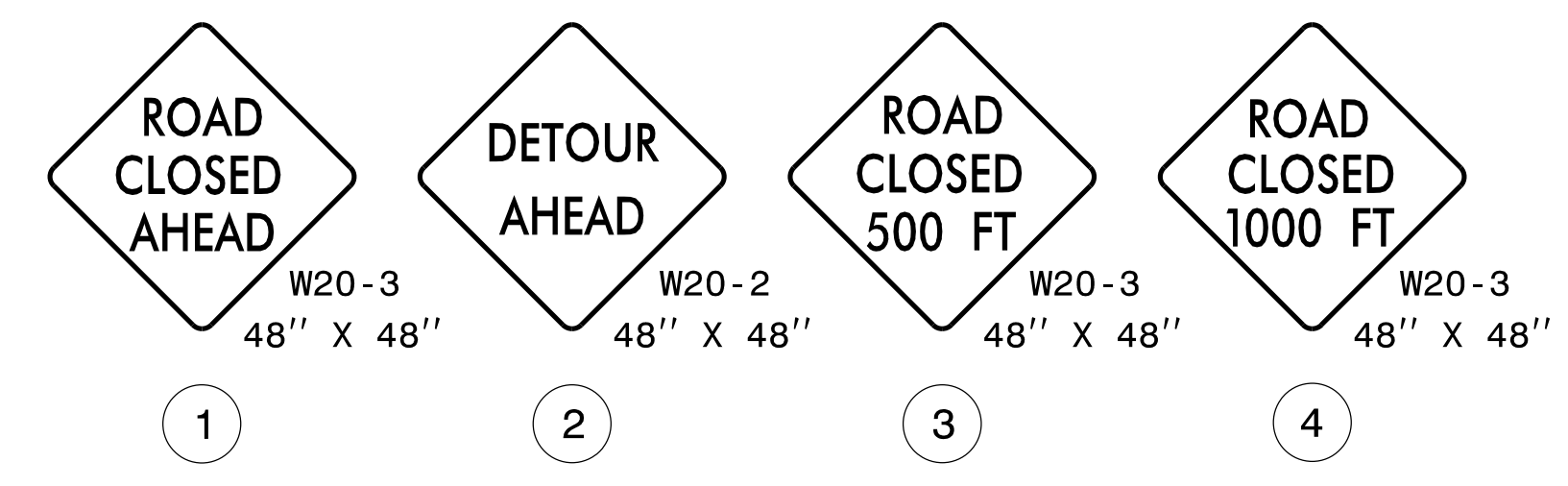
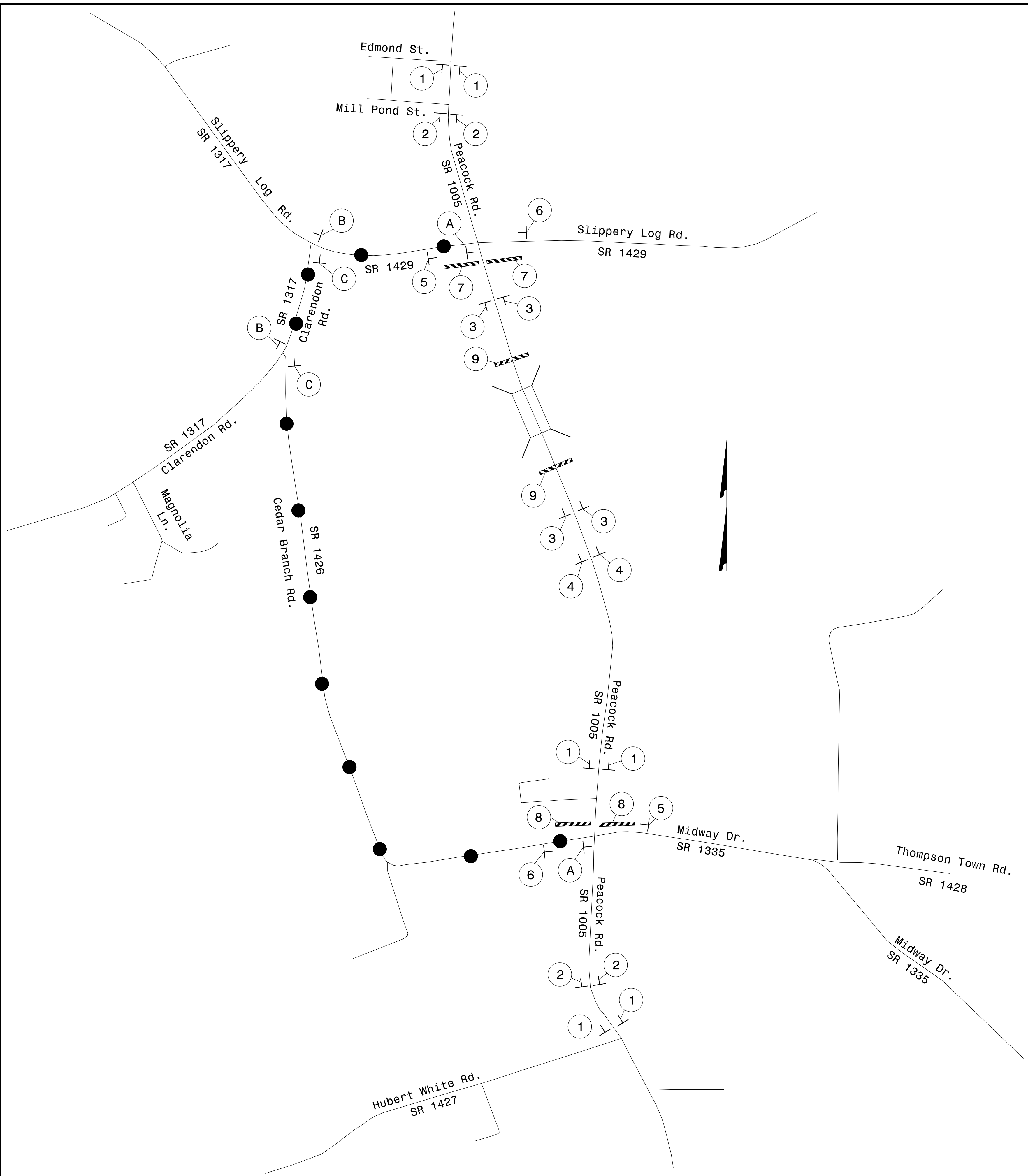

DETOUR ROUTE ●—●—●—●—●

SEE RSD 1101.03, SHEET 1 OF 9, FOR ADDITIONAL INFORMATION ON SIGN LOCATIONS AND NOTES.

ATKINS 1616 EAST MILLBROOK ROAD, SUITE 160 RALEIGH, NORTH CAROLINA 27609 (919) 876-6888 NCBEES #F-0326

APPROVED: *Lori D. Stouchko*
 DATE: 4/3/2017

SEAL
 034437
 ENGINEER
 LORI D. STOUCHKO

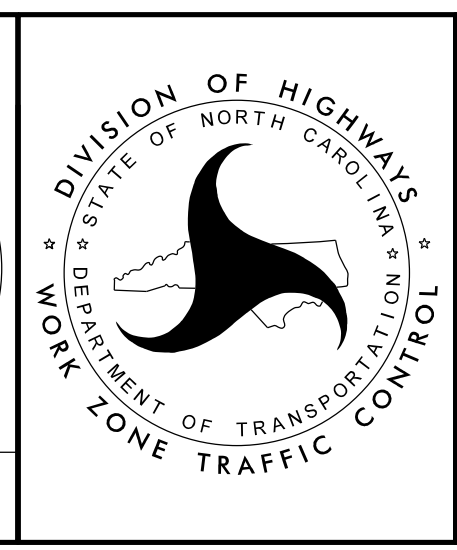

OFF-SITE DETOUR AND DETOUR SIGNS
 SR 1005
 (PEACOCK ROAD)

DOCUMENT NOT CONSIDERED FINAL UNLESS ALL SIGNATURES COMPLETED