

PARAPET AND END POST FOR TWO BAR RAIL

NOTES

THE PARAPET IN THE CONTINUOUS UNIT SHALL NOT BE CAST UNTIL ALL SLAB CONCRETE IN THE UNIT HAS BEEN CAST AND HAS REACHED A MINIMUM COMPRESSIVE STRENGTH OF 3,000 PSI.

ALL REINFORCING STEEL IN PARAPET SHALL BE EPOXY COATED.

THE #5 S1 & S2 BARS MAY BE SHIFTED SLIGHTLY IN ORDER TO MAINTAIN A 2" MINIMUM CLEARANCE TO THE 1/2" EXPANSION JOINT MATERIAL IN PARAPET.

FOR DETAILS OF CONCRETE INSERTS IN END POSTS, SEE "RAIL POST SPACINGS AND END OF RAIL DETAILS" SHEET.

FOR DETAILS OF GUARDRAIL ANCHOR ASSEMBLIES, SEE "GUARDRAIL ANCHORAGE DETAILS FOR METAL RAILS" SHEET.

GROOVED CONTRACTION JOINTS, 1/2" IN DEPTH, SHALL BE TOOLED IN ALL EXPOSED FACES OF THE PARAPET IN ACCORDANCE WITH ARTICLE 825-10(B) OF THE STANDARD SPECIFICATIONS. THE CONTRACTION JOINT SHALL BE LOCATED AT EACH THIRD POINT BETWEEN EXPANSION JOINTS.

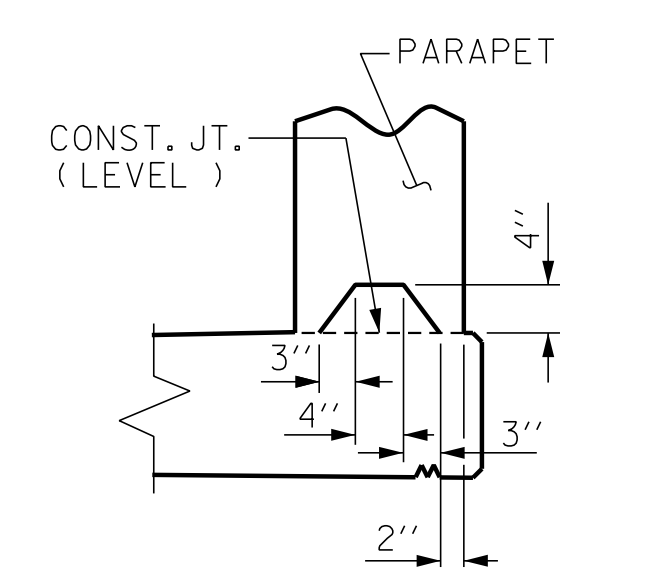

SECTION S-S
AT DAM IN OPEN JOINT
(THIS IS TO BE USED ONLY WHEN SLIP FORM IS USED)

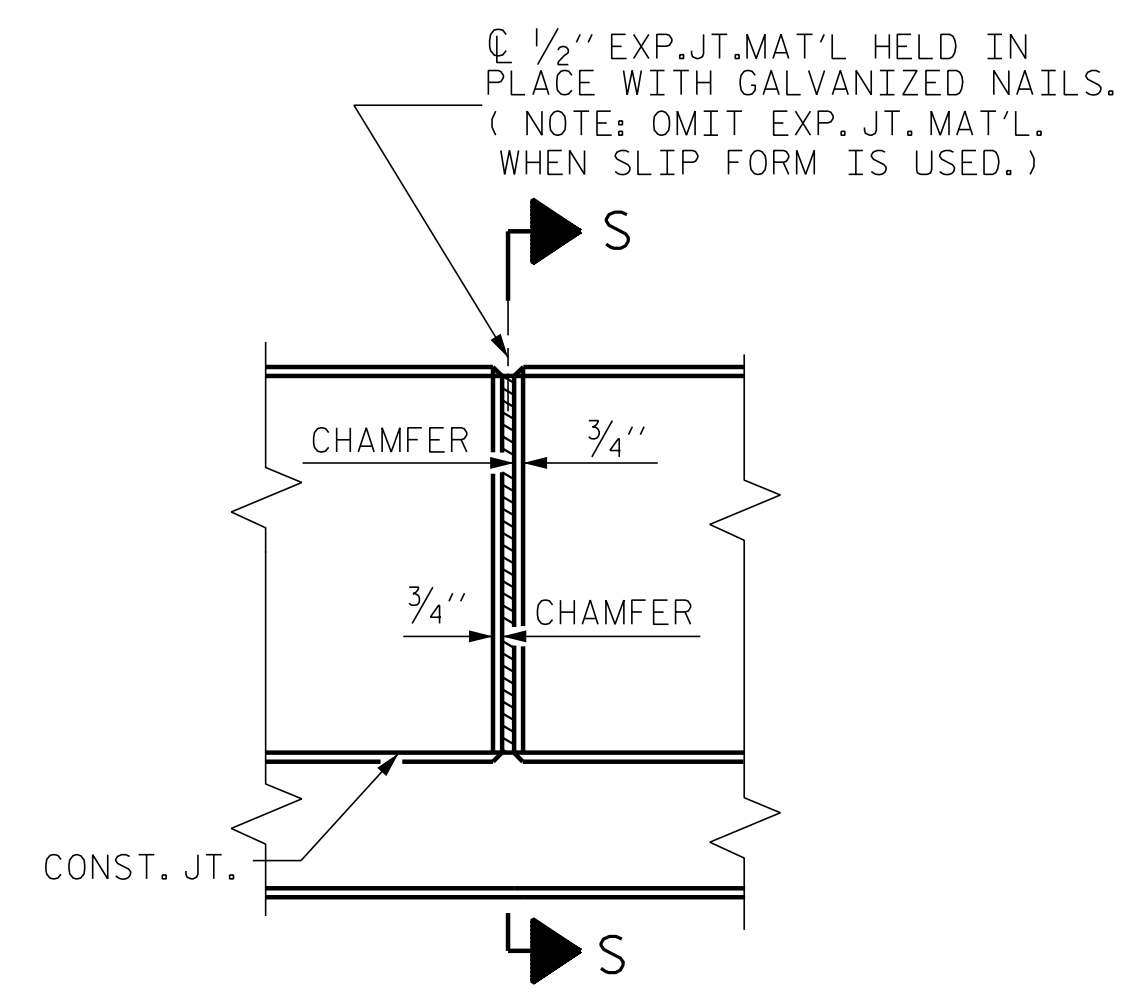

ELEVATION AT EXPANSION JOINTS

BILL OF MATERIAL

FOR CONCRETE PARAPET & END POST ONLY						
BAR	No.	SIZE	TYPE	LENGTH	WEIGHT	
* B1	32	#5	STR.	15'-0"	501	
* B2	96	#5	STR.	24'-7"	2461	
* B3	32	#5	STR.	14'-5"	481	
* E1	8	#7	STR.	2'-6"	41	
* E2	8	#7	STR.	3'-0"	49	
* E3	8	#7	STR.	3'-6"	57	
* E4	8	#7	STR.	4'-0"	65	
* E5	8	#7	STR.	4'-4"	71	
* F1	8	#6	STR.	1'-10"	22	
* F2	8	#6	STR.	3'-0"	36	
* F3	8	#6	STR.	3'-8"	44	
* S1	406	#5	1	5'-5"	2294	
* S2	406	#5	2	5'-6"	2329	
* EPOXY COATED REINFORCING STEEL					8451 LBS.	
CLASS AA CONCRETE					44.5 C.Y.	
1'-2" x 2'-6" CONCRETE PARAPET					404.65 L.F.	

* THESE BARS ARE EPOXY COATED

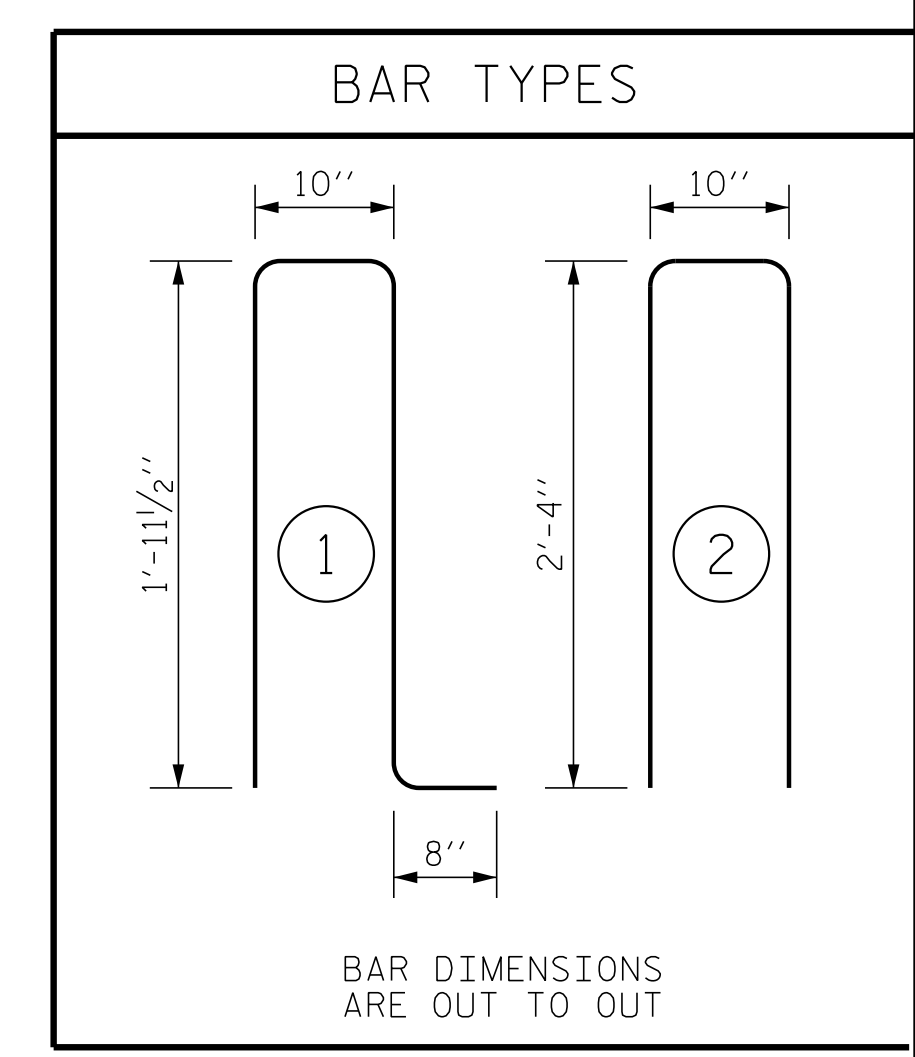

BAR DIMENSIONS ARE OUT TO OUT

PROJECT NO. U-5796
WAYNE COUNTY
STATION: 27+41.30 -Y8-

SHEET 2 OF 2

ENGINEER OF RECORD

DocuSigned by:
Evel Charles Hunt
915C8978A4EC

1223 Jones Franklin Rd.
Raleigh, N.C. 27606
Bus: 919 851 8077
Fax: 919 851 8107
LICENSE NO. F-0377

STATE OF NORTH CAROLINA
DEPARTMENT OF TRANSPORTATION
RALEIGH

SUPERSTRUCTURE
CONCRETE PARAPET

REVISIONS					
NO.	BY:	DATE:	NO.	BY:	DATE:
1			3		
2			4		

SHEET NO. S01-16
TOTAL SHEETS 34

DRAWN BY: J. PENDERGRAFT DATE: 10-15
CHECKED BY: J. DILWORTH DATE: 10-15

DOCUMENT NOT CONSIDERED FINAL
UNLESS ALL SIGNATURES COMPLETED

P:\2015\U-5796\Structures\DG\U5796_PARA.WE I.dgn
 12/7/2016 10:57:59 AM