

UTILITIES BY OTHERS

NOTE:  
ALL PROPOSED UTILITY WORK SHOWN ON THIS SHEET WILL BE DONE BY OTHERS. NO PAYMENT WILL BE MADE TO THE CONTRACTOR FOR PROPOSED UTILITY WORK SHOWN ON THIS SHEET.

NAD 83/NSRS 2007

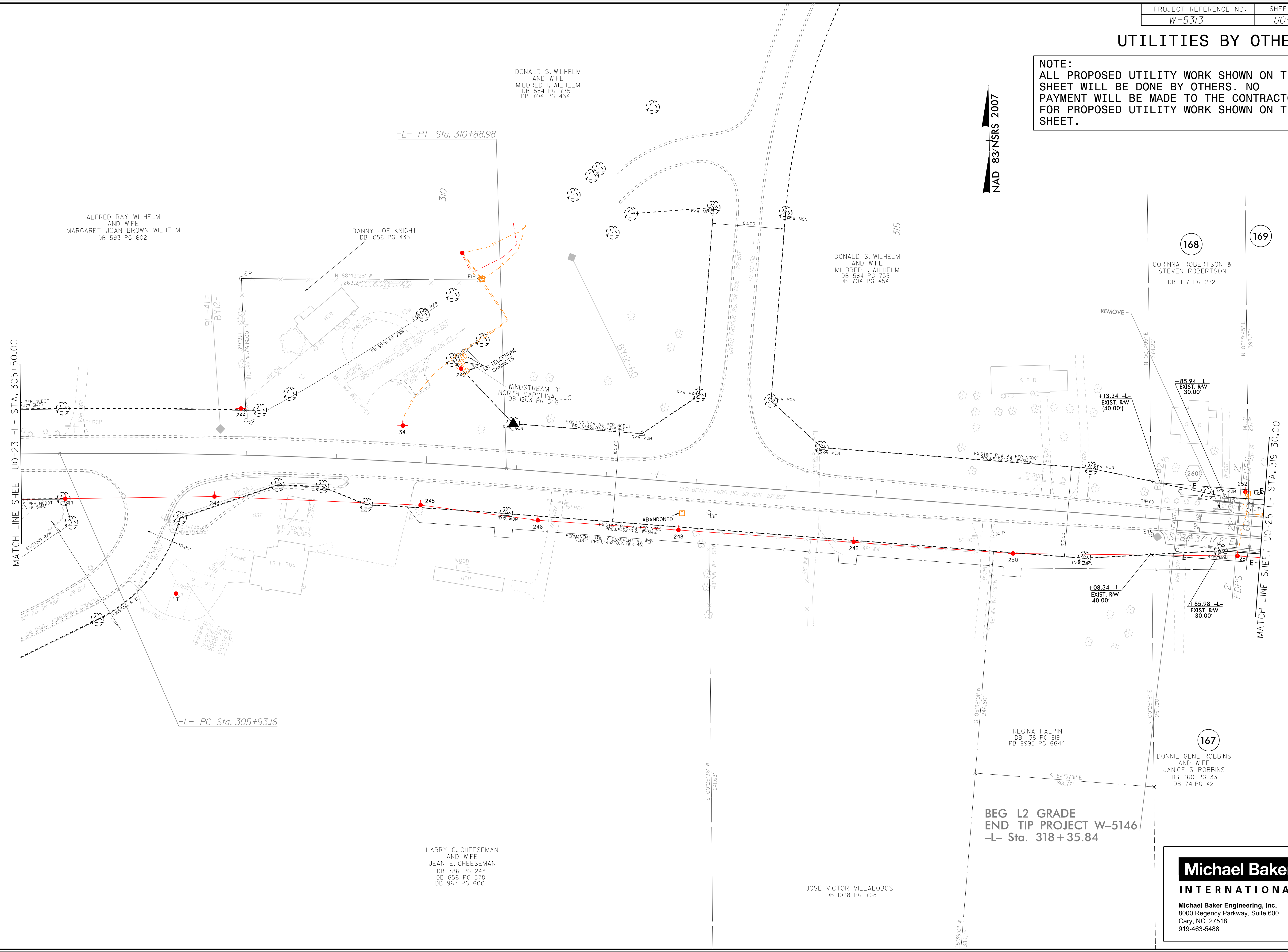

MATCH LINE SHEET U0-23 -L- STA. 305+50.00

MATCH LINE SHEET U0-25 -L- STA. 319+30.00

DONALD S. WILHELM AND WIFE  
MILDRED L. WILHELM  
DB 984 PG 735  
DB 704 PG 454

ALFRED RAY WILHELM AND WIFE  
MARGARET JOAN BROWN WILHELM  
DB 593 PG 602

DANNY JOE KNIGHT  
DB 1058 PG 435

DONALD S. WILHELM AND WIFE  
MILDRED L. WILHELM  
DB 584 PG 735  
DB 704 PG 454

CORINNA ROBERTSON & STEVEN ROBERTSON  
DB 1197 PG 272

WINDSTREAM OF NORTH CAROLINA, LLC  
DB 1203 PG 366

-L- PC Sta. 305+93.16

-L- PT Sta. 310+88.98

BEG L2 GRADE  
END TIP PROJECT W-5146  
-L- Sta. 318+35.84

LARRY C. CHEESEMAN AND WIFE  
JEAN E. CHEESEMAN  
DB 786 PG 243  
DB 656 PG 578  
DB 967 PG 600

JOSE VICTOR VILLALOBOS  
DB 1078 PG 768

REGINA HALPIN  
DB 1138 PG 819  
PB 9955 PG 6644

DONNIE GENE ROBBINS AND WIFE  
JANICE S. ROBBINS  
DB 760 PG 33  
DB 741 PG 42

**Michael Baker**  
INTERNATIONAL

Michael Baker Engineering, Inc.  
8000 Regency Parkway, Suite 600  
Cary, NC 27518  
919-463-5488

5/14/99  
11-AUG-2016 15:02  
C:\Users\psh\OneDrive\Documents\Projects\W-5313\Rowan County Utilities\W-5313-ut-rdy26-U024\_psh.dgn  
AT: CARY\WIKIDONK