

**This electronic collection of documents is provided
for the convenience of the user
and is Not a Certified Document –**

**The documents contained herein were originally issued
and sealed by the individuals whose names and license
numbers appear on each page, on the dates appearing
with their signature on that page.**

**This file or an individual page
shall not be considered a certified document.**

UTILITIES BY OTHERS

NOTE:
ALL UTILITY WORK SHOWN ON THIS SHEET WILL BE DONE BY OTHERS. NO PAYMENT WILL BE MADE TO THE CONTRACTOR FOR UTILITY WORK SHOWN ON THIS SHEET.

BEGIN TIP PROJECT B-4616

-L- STA 17+00.00

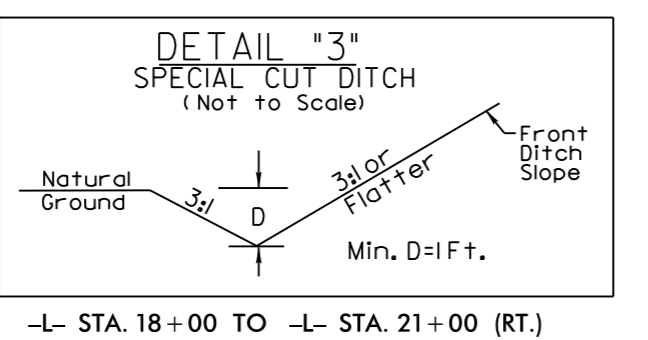
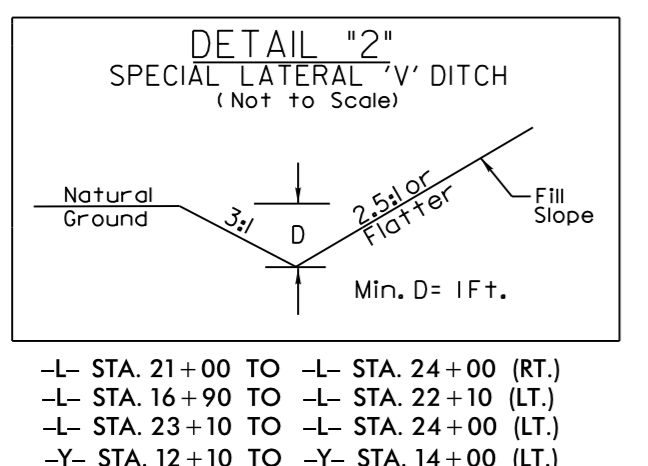
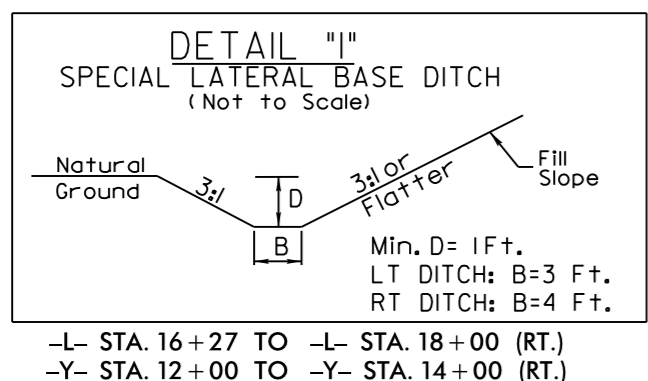
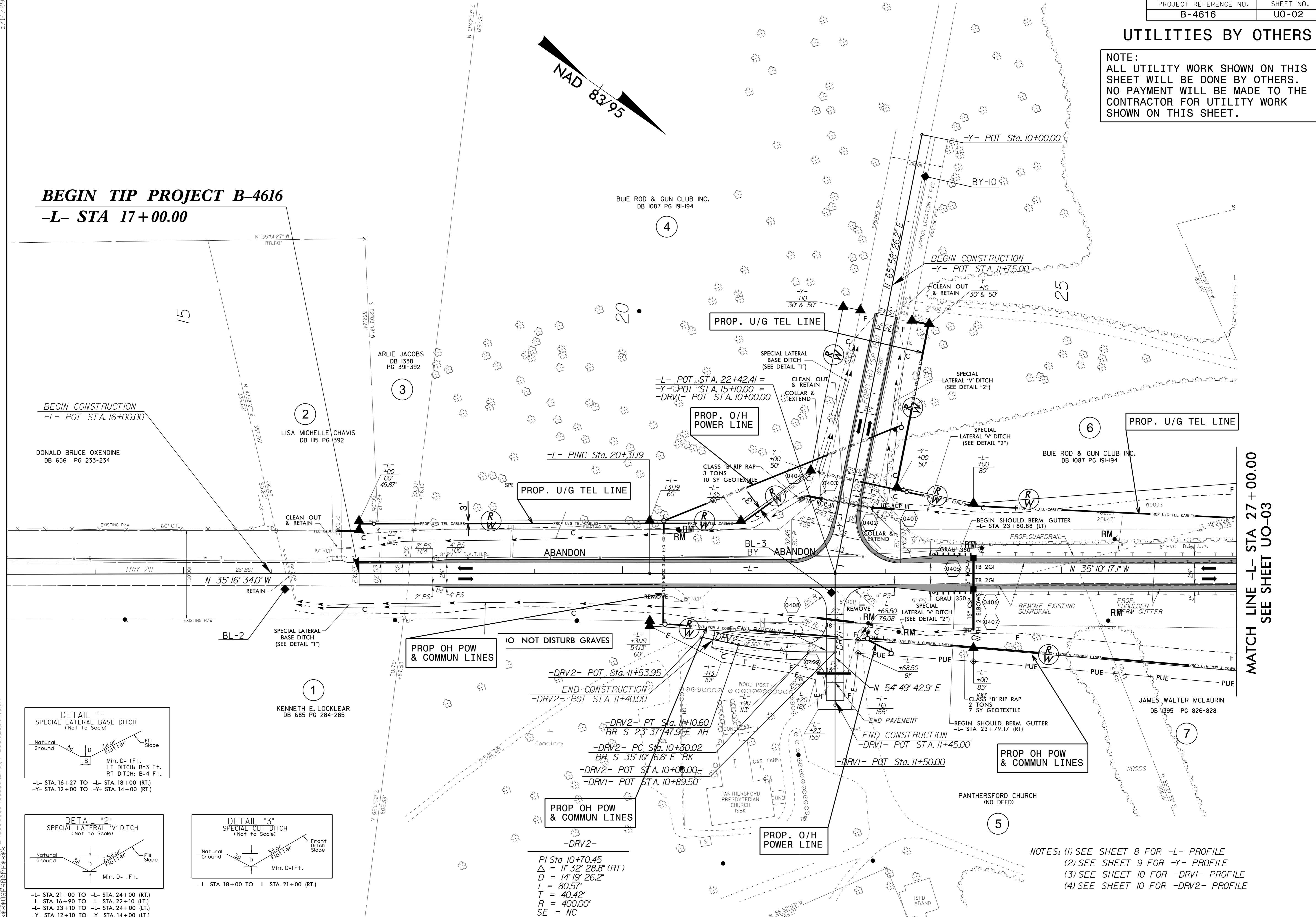
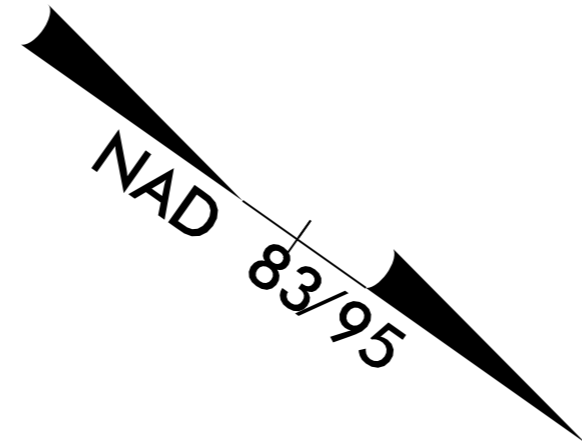

PROP O/H POW & COMMUN LINES

-DRV2-

PI Sta 10+70.45
Δ = 11° 32' 28.8" (RT)
D = 14' 19" 26.2"
L = 80.57'
T = 40.42'
R = 400.00'
SE = NC

NOTES: (1) SEE SHEET 8 FOR -L- PROFILE
(2) SEE SHEET 9 FOR -Y- PROFILE
(3) SEE SHEET 10 FOR -DRV1- PROFILE
(4) SEE SHEET 10 FOR -DRV2- PROFILE

MATCH LINE -L- STA 27+00.00
SEE SHEET UO-03

12/12/16 R/W REVISION: ADJUSTED OFFSETS BASED ON THE FIELD STAKING ON PARCELS 2 & 5 (WSP/PB,BAW)

5/14/99

11-APR-2017 11:52
C:\Users\jchavis\OneDrive\Documents\B-4616-UO-02.dwg 4 _U002.psh.edg

UTILITIES BY OTHERS

NOTE:
 ALL UTILITY WORK SHOWN ON THIS SHEET WILL BE DONE BY OTHERS. NO PAYMENT WILL BE MADE TO THE CONTRACTOR FOR UTILITY WORK SHOWN ON THIS SHEET.

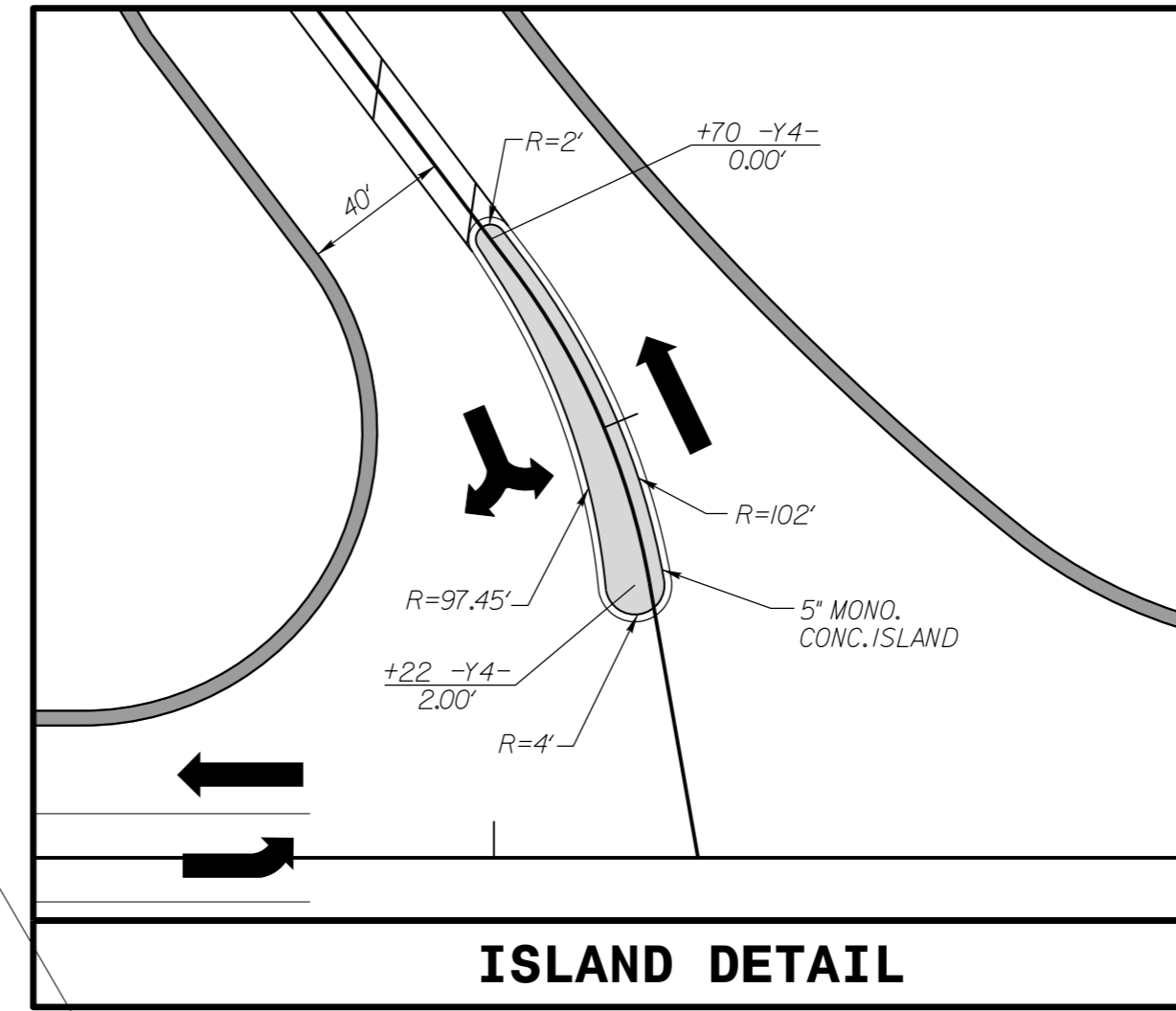

ISLAND DETAIL

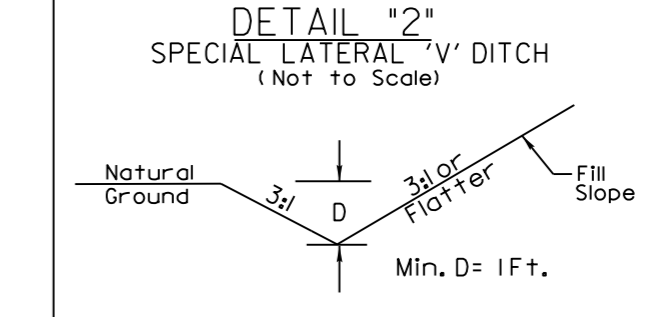

-Y3- STA. 11+30 TO -Y3- STA. 12+00 (LT.)
 -Y3- STA. 16+00 TO -Y3- STA. 16+67 (LT.)
 -Y4- STA. 15+00 TO -Y4- STA. 15+84 (RT.)

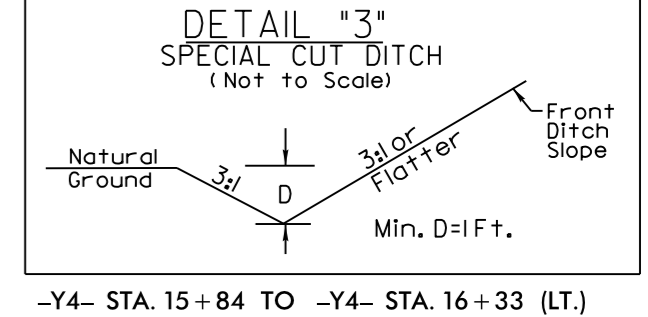

-Y4- STA. 15+84 TO -Y4- STA. 16+33 (LT.)

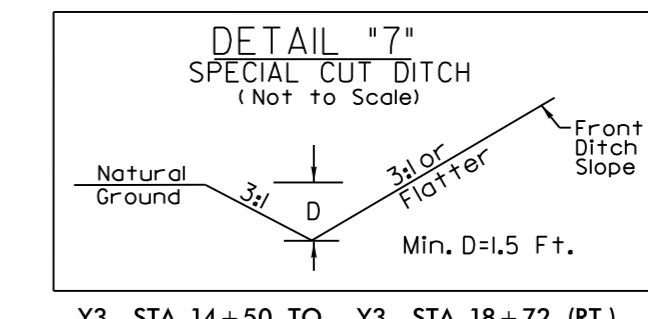

-Y3- STA. 14+50 TO -Y3- STA. 18+72 (RT.)

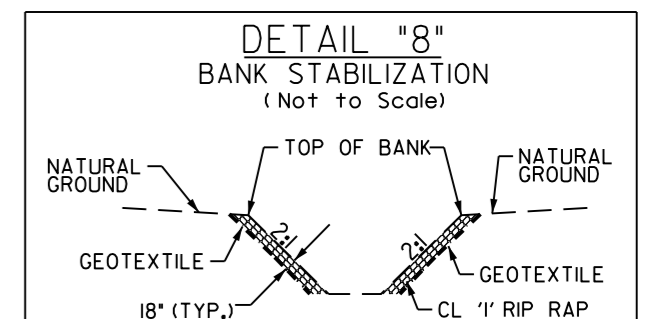

DRAINAGE STRUCTURE 0704: -Y3- STA. 18+74 (RT.)
 30 TONS CL '1' RIP RAP, 50 SY GEOTEXTILE, 10 CY DDE

-Y3-
 PI Sta 13+56.76
 $\Delta = 9' 12' 36.7''$ (RT)
 D = 3' 05' 49.4"
 L = 297.38'
 T = 149.01'
 R = 1,850.00'
 SE = EXIST.

PI Sta 23+91.33
 $\Delta = 5' 08' 53.2''$ (RT)
 D = 2' 23' 14.4"
 L = 215.64'
 T = 107.89'
 R = 2,400.00'
 SE = EXIST.

-Y4-
 PI Sta 15+98.95
 $\Delta = 27' 01' 44.5''$ (RT)
 D = 57' 17' 44.8"
 L = 471.7'
 T = 24.03'
 R = 100.00'
 SE = EXIST.

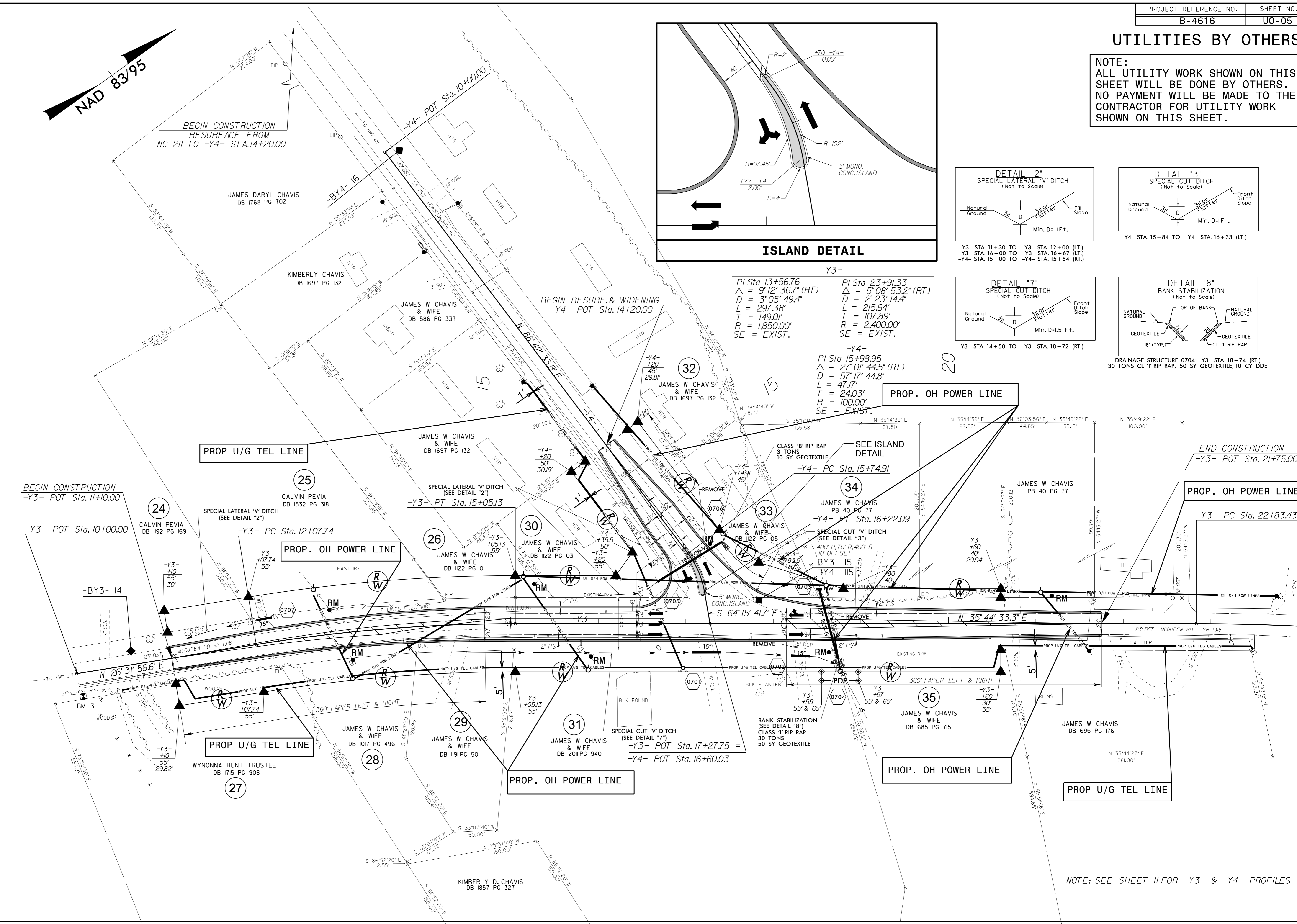

NOTE: SEE SHEET 11 FOR -Y3- & -Y4- PROFILES

12/12/16 RAW REVISION: ADJUSTED OFFSETS BASED ON THE FIELD STAKING ON PARCELS 24, 27, 30, 32, 34 & 35 (WSP/PB, BAW)

04-MAY-2017 08:49
 12-20 009-B4616-ut-rdy7-U005-psh.dgn