

1

35

40

45

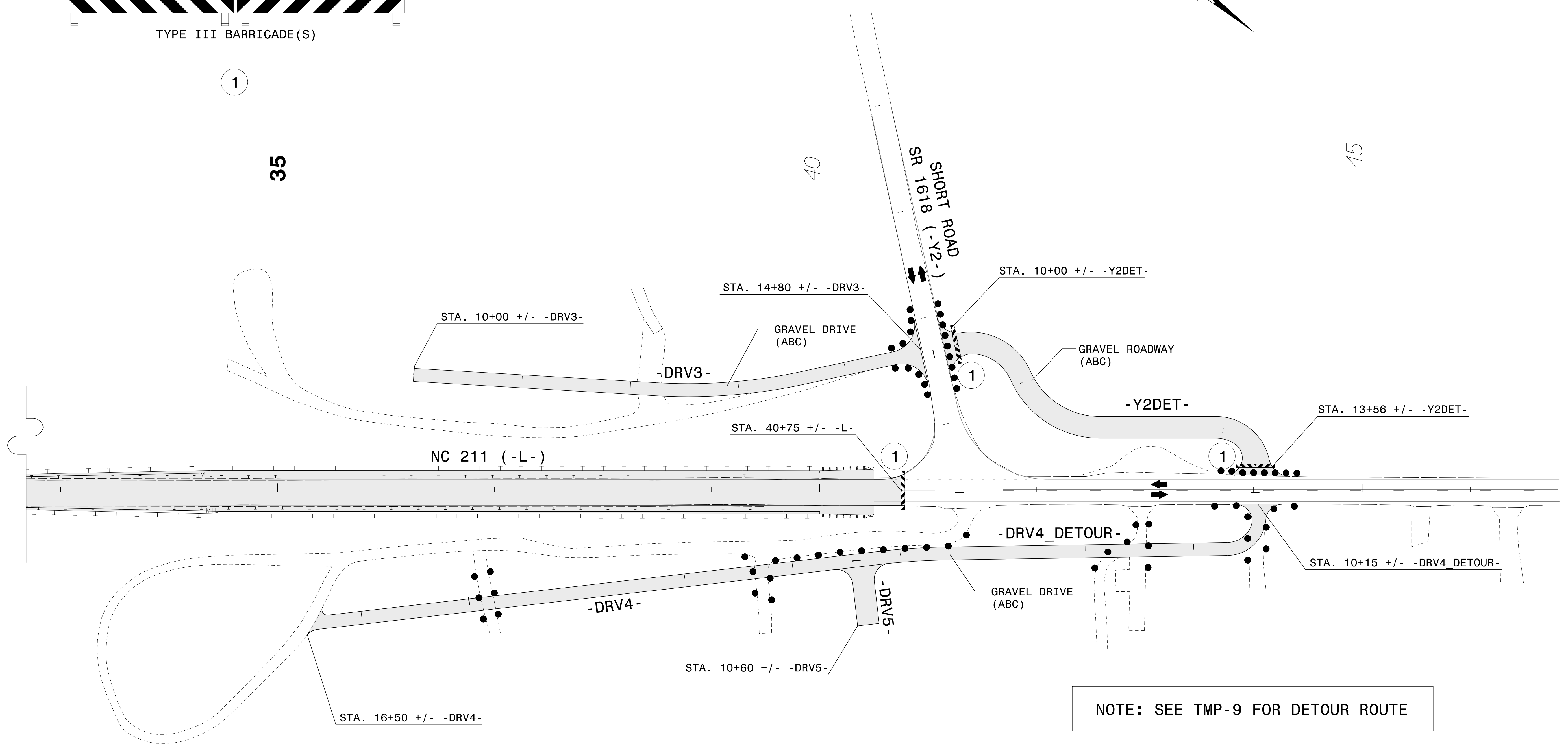

NOTE: SEE TMP-9 FOR DETOUR ROUTE

NEW CONSTRUCTION

APPROVED: *Steve Kite*
DATE: 3/27/2017

**DOCUMENT NOT CONSIDERED FINAL
UNLESS ALL SIGNATURES COMPLETED**

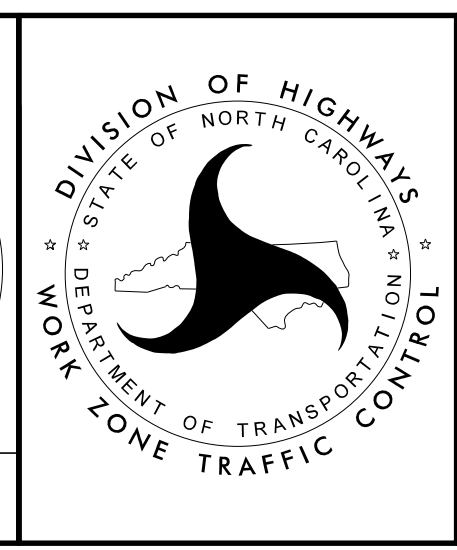

**TEMPORARY
TRAFFIC CONTROL
DETAIL - PHASE II,
STEP 2, 3**

3/27/2017 R:\TrafficControl\CP\B-4616_TC_TMP_06.dgn User: sbjennings