

PROJECT REFERENCE NO. B-4598	SHEET NO. EC-5/CONST.4
RW SHEET NO.	
ROADWAY DESIGN ENGINEER	HYDRAULICS ENGINEER

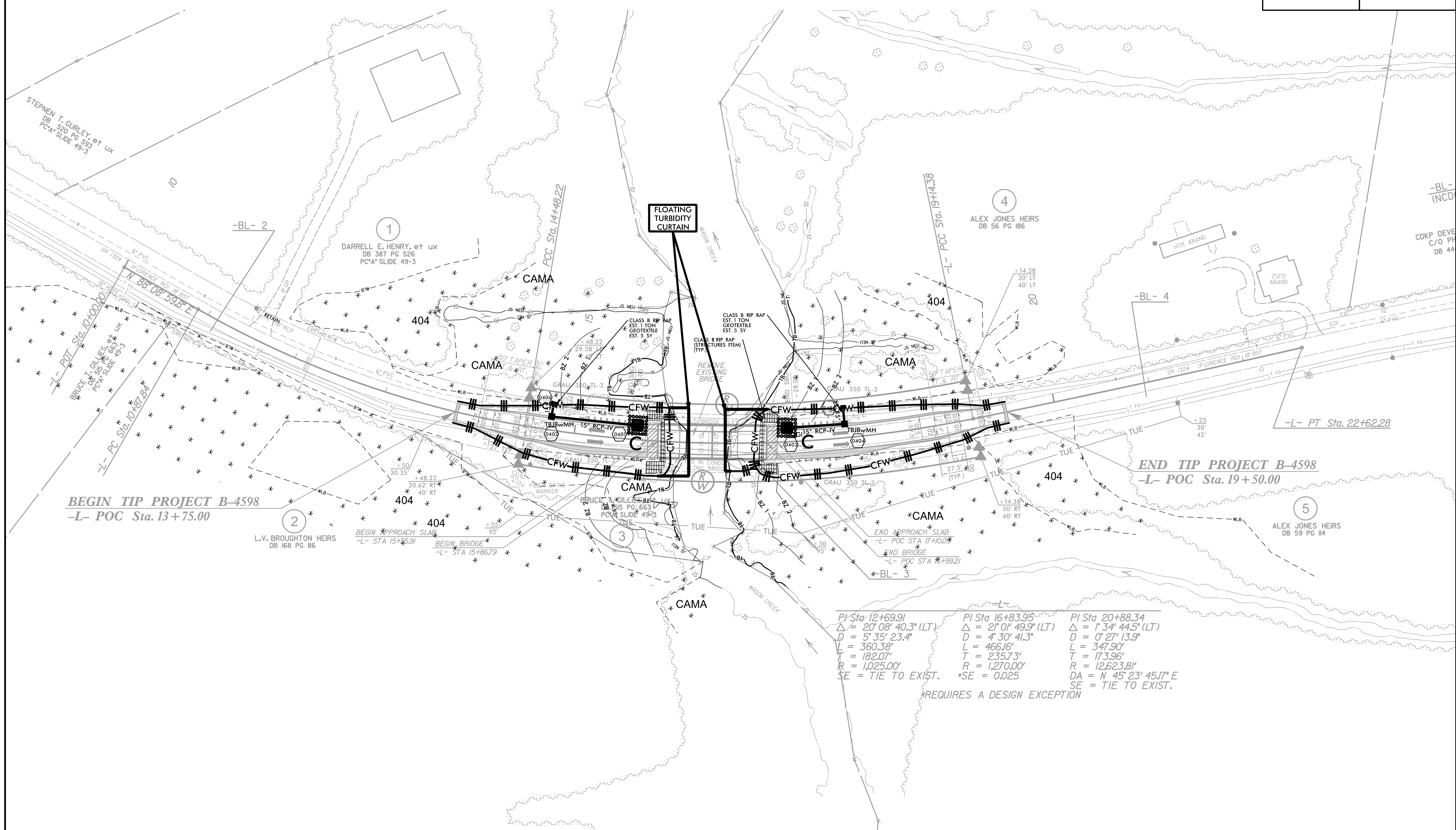
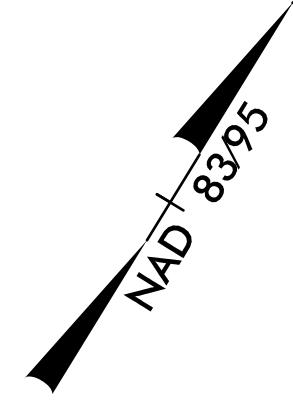

BEGIN TIP PROJECT B-4598
-L- POC Sta. 13+75.00

END TIP PROJECT B-4598
-L- POC Sta. 19+50.00

PI Sta 12+69.91 Δ = 20' 08" 40.3" (LT) D = 5' 35" 23.4" L = 360.38' T = 182.07' R = 1,025.00' SE = TIE TO EXIST.	PI Sta 16+83.95 Δ = 21' 01" 49.9" (LT) D = 4' 30" 41.3" L = 466.16' T = 235.73' R = 1,270.00' *SE = 0.025	PI Sta 20+88.34 Δ = 1' 34" 44.5" (LT) D = 0' 27" 13.9" L = 347.90' T = 173.96' R = 12,623.81' DA = N 45° 23' 45.17" E SE = TIE TO EXIST.
--	---	---

REQUIRES A DESIGN EXCEPTION

NOTE:
UTILIZE SPECIAL STILLING BASIN(S) AS STILLING BASIN WHERE APPLICABLE.

FLOATING TURBIDITY CURTAIN WILL BE REQUIRED DURING THE CONSTRUCTION OF INTERIOR PILES. FINAL PLACEMENT OF FLOATING TURBIDITY CURTAIN WILL BE DIRECTED BY THE DIVISION ENVIRONMENTAL FIELD OPERATIONS ENGINEER.

Place Matting for Erosion Control on Slopes Adjacent to Permitted Wetlands as Work Allows.