

TMP PHASE I

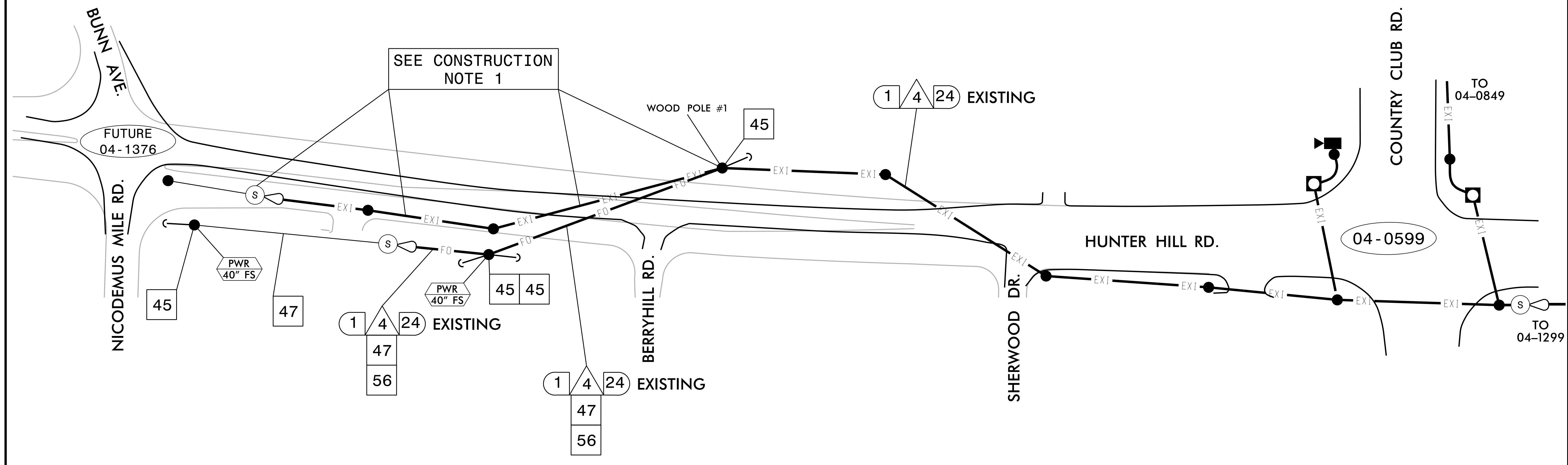

CONSTRUCTION NOTES:

- 1) UNLASH EXISTING 24-FIBER CABLE AND AERIAL SPlice ENCLOSURE AND BACKPULL TO "WOOD POLE #1". REMOVE OLD MESSENGER CABLE AND LASH BACKPULLED CABLE AND SPlice ENCLOSURE TO NEW MESSENGER CABLE AS SHOWN.

NOTES:

- 1) NOTIFY THE CITY OF ROCKY MOUNT SIGNAL SYSTEM OPERATOR, MICHAEL WEBB, AT 252-972-1132 FIVE (5) DAYS PRIOR TO BEGINNING WORK ON SIGNAL SYSTEM COMMUNICATIONS CABLE. NOTIFY THE SIGNAL SYSTEM OPERATOR AFTER ALL WORK IS PERFORMED TO ENSURE THAT ALL FIBER CIRCUITS ARE FUNCTIONING PROPERLY. ALL WORK IS NOT COMPLETE UNTIL THE SIGNAL SYSTEM IS BACK UP AND OPERATIONAL.
- 2) CONTRACTOR TO RECORD EXISTING SPlice ARRANGEMENT FOR COMPARISON TO THE SUPPLIED SPlice DETAILS. IF DISCREPANCIES EXIST, CONTACT THE ENGINEER TO DETERMINE HOW TO PROCEED WITH RESPLICING. PROVIDE AS-BUILT PLANS TO THE ENGINEER IF FINAL SPlice ARRANGEMENT DIFFERS FROM THE SUPPLIED SPlice DETAILS.

TMP PHASE 1

DOCUMENT NOT CONSIDERED FINAL UNLESS ALL SIGNATURES COMPLETED

	<p>COMMUNICATIONS CABLE AND CONDUIT ROUTING PLANS</p>	
	<p>DIVISION 04 NASH COUNTY ROCKY MOUNT</p> <p>PLAN DATE: FEBRUARY 2017</p> <p>PREPARED BY: A. J. SKUCE</p>	<p>REVIEWED BY: <i>Neil Avery</i></p> <p>DATE: _____</p>
<p>750 N. Greenfield Pkwy., Garner, NC 27529</p> <p>SCALE: 1" = 55'</p>	<p>REVISIONS</p> <p>INIT. DATE</p>	<p>DocuSign by: <i>Gregory A. Fuller</i> 2/15/2017</p> <p>CADD Filename: _____</p>