

PROJECT REFERENCE NO. <b>U-3621A</b>	SHEET NO. <b>5</b>
RW SHEET NO.	
ROADWAY DESIGN ENGINEER	HYDRAULICS ENGINEER
<p><b>DOCUMENT NOT CONSIDERED FINAL</b> <b>UNLESS ALL SIGNATURES COMPLETED</b></p>	

-L-  
PI Sta 43+41.88  
 $\Delta = 18^{\circ}29'36.8''$  (RT)  
D = 3'10" 59.2"  
L = 580.99'  
T = 293.04'  
R = 1,800.00'  
SE = SEE PLANS

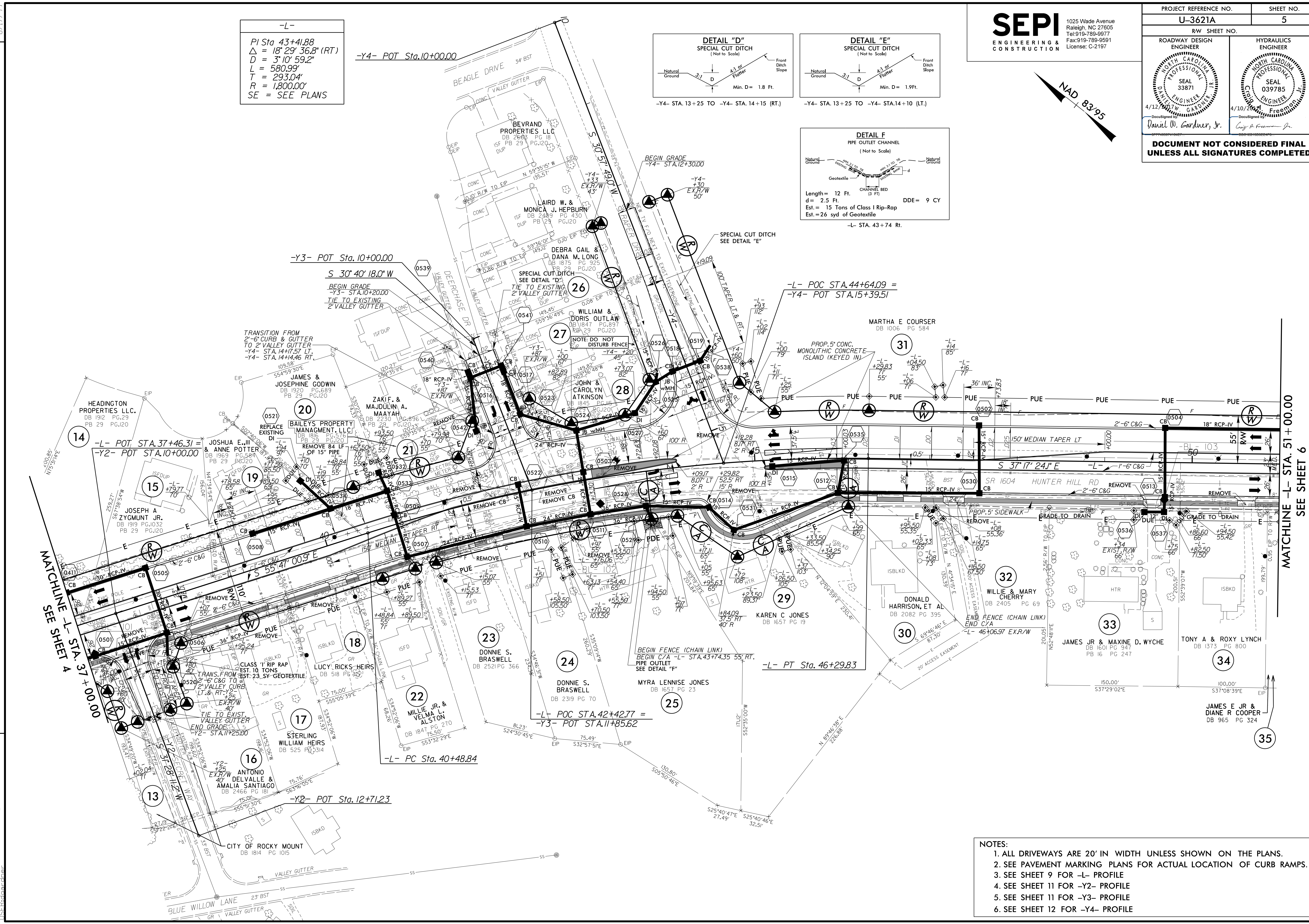
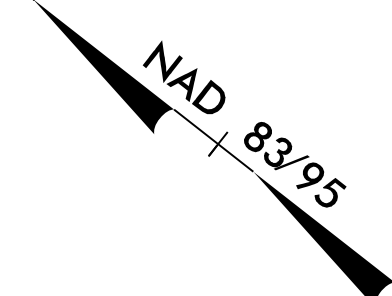
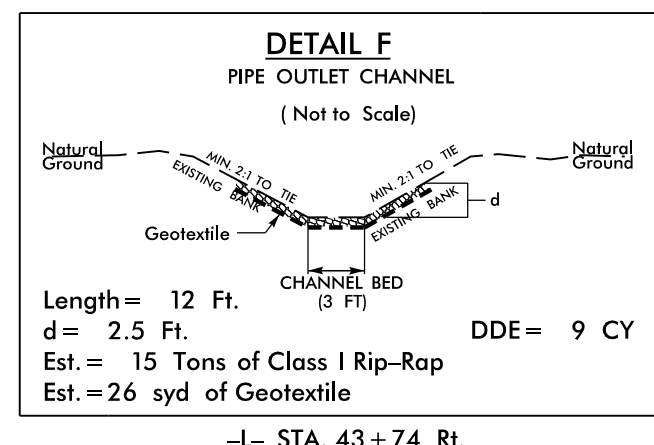
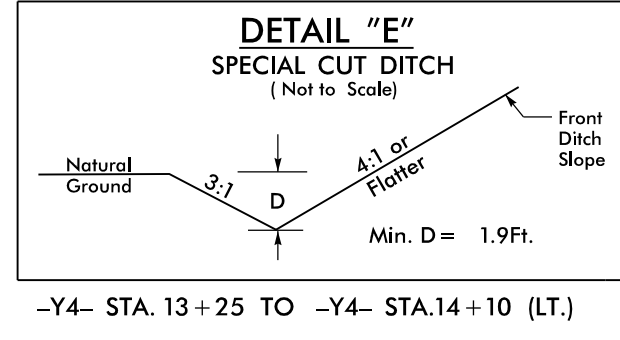
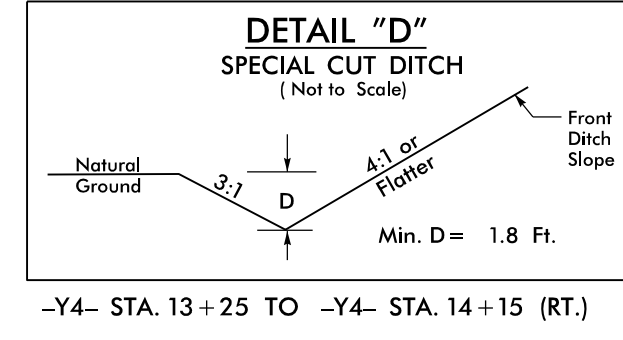

- NOTES:**
1. ALL DRIVEWAYS ARE 20' IN WIDTH UNLESS SHOWN ON THE PLANS.
  2. SEE PAVEMENT MARKING PLANS FOR ACTUAL LOCATION OF CURB RAMPS.
  3. SEE SHEET 9 FOR -L- PROFILE
  4. SEE SHEET 11 FOR -Y2- PROFILE
  5. SEE SHEET 11 FOR -Y3- PROFILE
  6. SEE SHEET 12 FOR -Y4- PROFILE

REVISIONS

3/3/2017 U-3621A\_Rdwy\_psh\_5.dgn  
11:58:00 am

MATCHLINE SEE SHEET 4  
-L- STA. 37+00.00

MATCHLINE -L- STA. 51+00.00  
SEE SHEET 6