

8.17.99

PROJECT REFERENCE NO. R-5311A SHEET NO. EC-5/CONST.2B-7  
 ROADSIDE ENVIRONMENTAL PROJECT ENGINEER  
 LEVEL III CERTIFIED BY: STACEY H. BAILEY, PE  
 CERTIFICATION NUMBER: 3074  
 ISSUED: JANUARY 13, 2017

**ICA Engineering**  
 5121 Kingdom Way, Suite 100  
 Raleigh, NC 27607  
 NC License No. F-0258

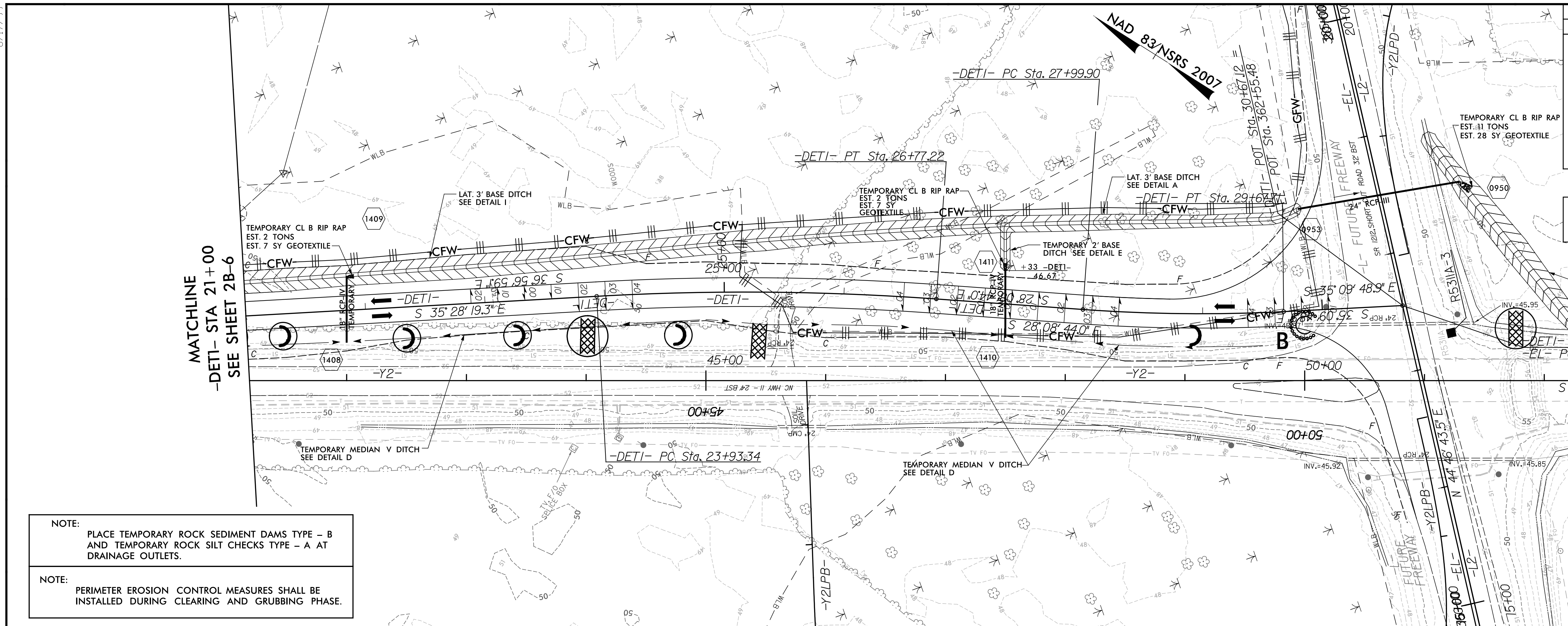

NOTE: PLACE TEMPORARY ROCK SEDIMENT DAMS TYPE - B AND TEMPORARY ROCK SILT CHECKS TYPE - A AT DRAINAGE OUTLETS.  
 NOTE: PERIMETER EROSION CONTROL MEASURES SHALL BE INSTALLED DURING CLEARING AND GRUBBING PHASE.

CLEARING AND GRUBBING EROSION CONTROL FOR CONSTRUCTION SHEET 2B-7  
 GRAPHIC SCALE: 50' 25' 0' 50' 100'

# -DETI-

PIPE HYDRAULIC DATA  
 TEMPORARY 18" RCP STA 21+84 -DETI-

DRAINAGE AREA	= 1	AC
DESIGN FREQUENCY	= 50	YRS
DESIGN DISCHARGE	= 6	CFS
DESIGN HW ELEVATION	= 49.0	FT
100 YEAR DISCHARGE	= 6	CFS
100 YEAR HW ELEVATION	= 49.0	FT
OVERTOPPING FREQUENCY	= 500+	YRS
OVERTOPPING DISCHARGE	= 27	CFS
OVERTOPPING ELEVATION	= 50.3	FT

INV IN = 47.60    INV OUT = 47.08

PIPE HYDRAULIC DATA  
 TEMPORARY 18" RCP STA 27+35 -DETI-

DRAINAGE AREA	= 1	AC
DESIGN FREQUENCY	= 50	YRS
DESIGN DISCHARGE	= 5	CFS
DESIGN HW ELEVATION	= 48.3	FT
100 YEAR DISCHARGE	= 5	CFS
100 YEAR HW ELEVATION	= 48.3	FT
OVERTOPPING FREQUENCY	= 500+	YRS
OVERTOPPING DISCHARGE	= 27	CFS
OVERTOPPING ELEVATION	= 52.2	FT

INV IN = 47.01    INV OUT = 46.67

END GRADE  
 -DETI- STA 30+30.56=  
 -EL- STA 362+61.83, 36' LT  
 EL 51.49'

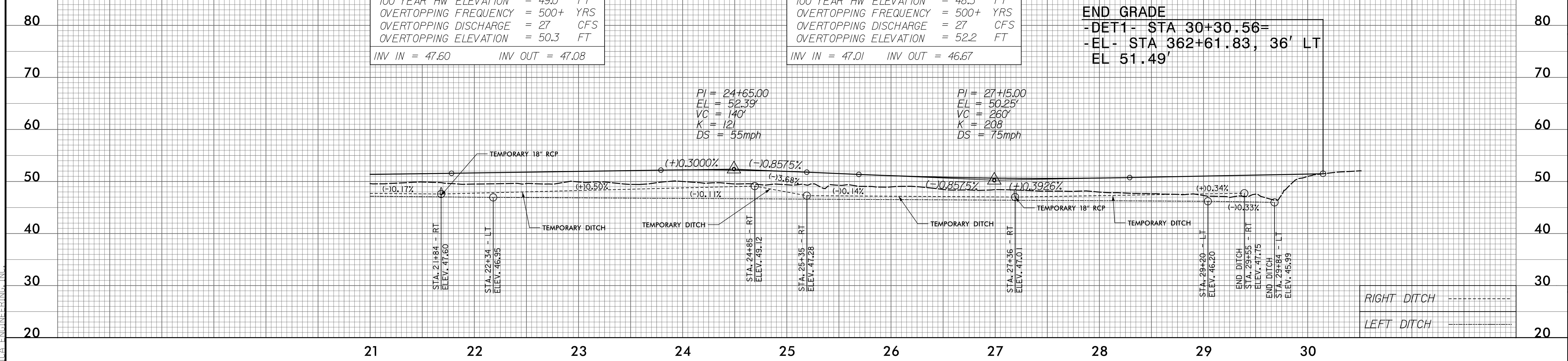

1/3/2017  
 R:\Projects\2017\170111A\hyd\_erosion\c&g\_psh2b-7.dgn  
 Control\Cadd\proj\_future\_freeway\170111A\_hyd\_erosion\_c&g\_psh2b-7.dgn  
 ICA ENGINEERING, INC.