

DATE: 4/11/2017
TIME: 5:32:30 PM

USER: jmorris@aec.com Room: 400_Technical\408_Structure\401_245_S49_R5516_SML_A501.dgn

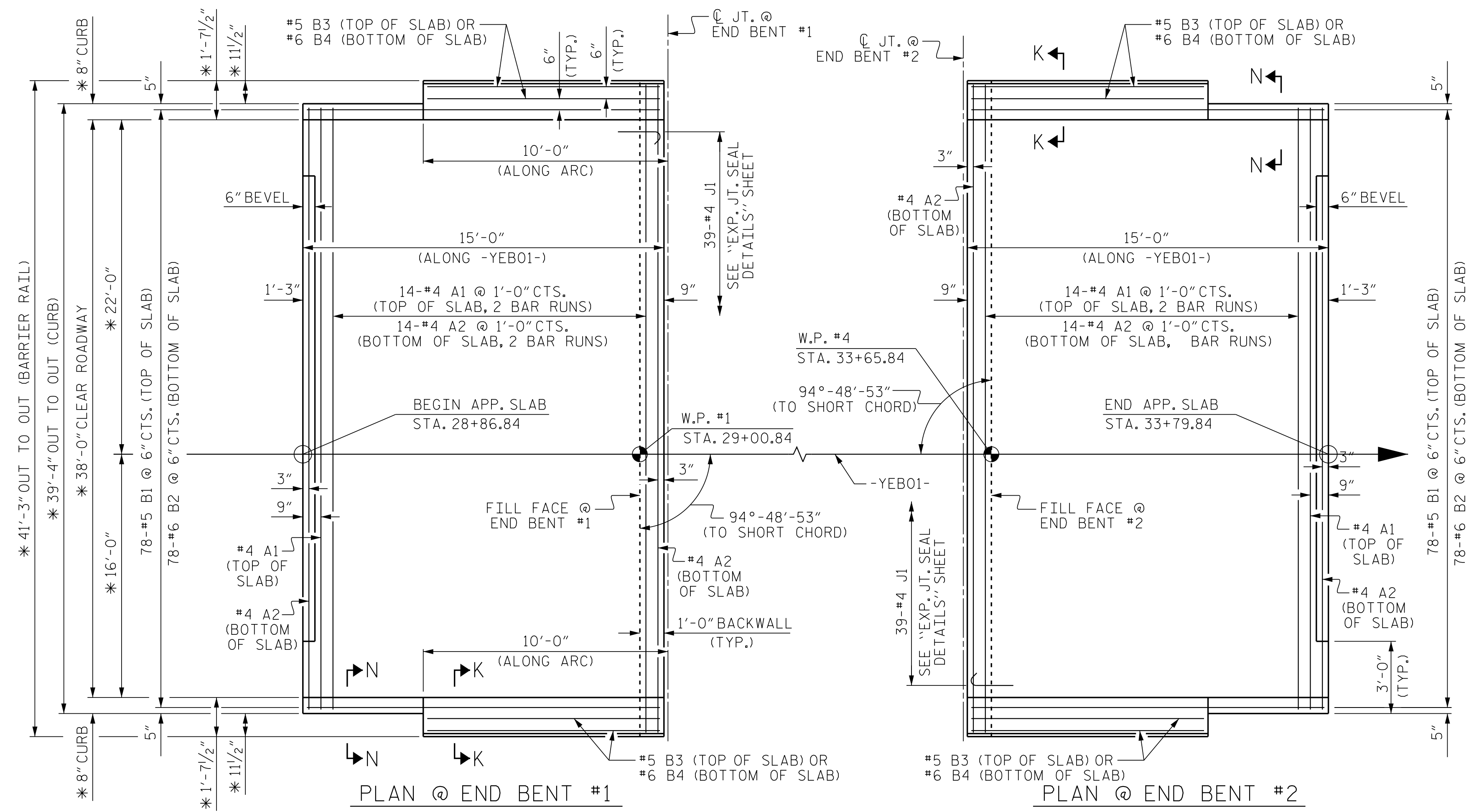

DIMENSIONS SHOWN ARE TYPICAL FOR BOTH APPROACH SLABS

*RADIAL DIMENSIONS

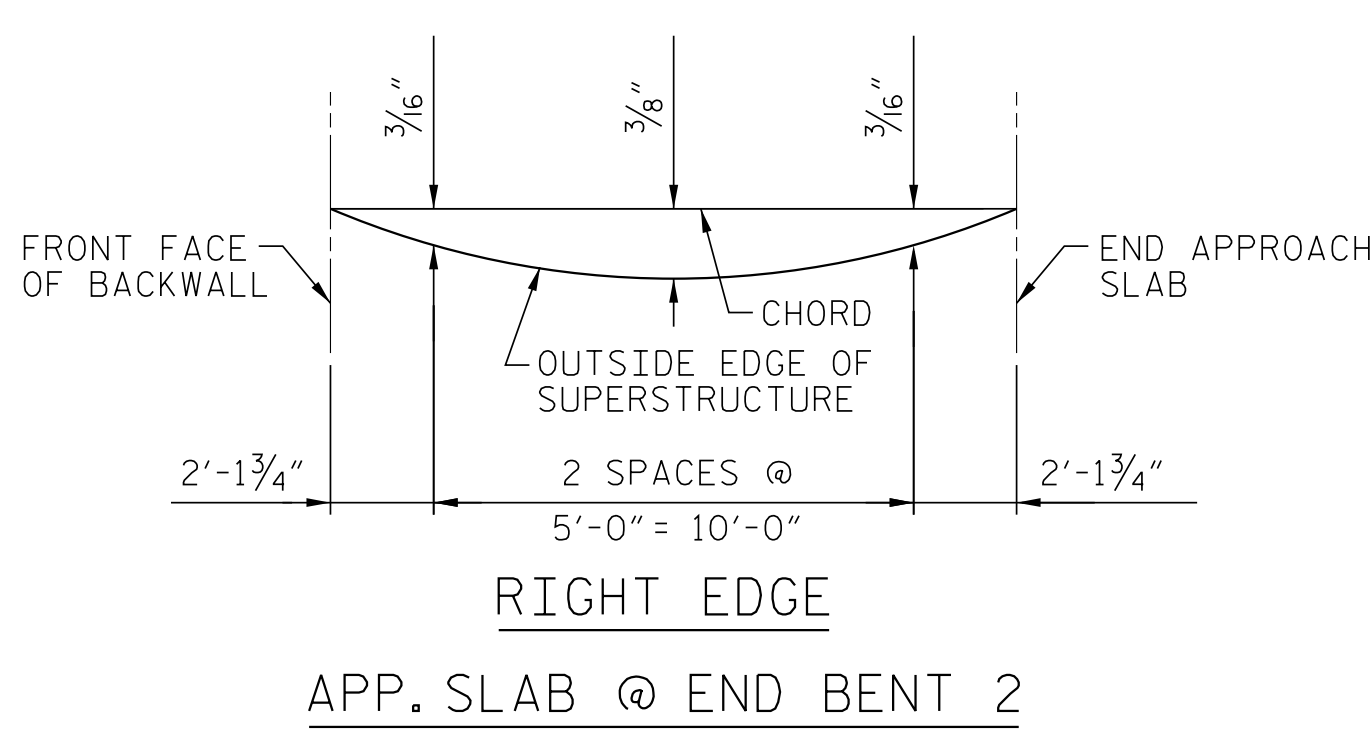
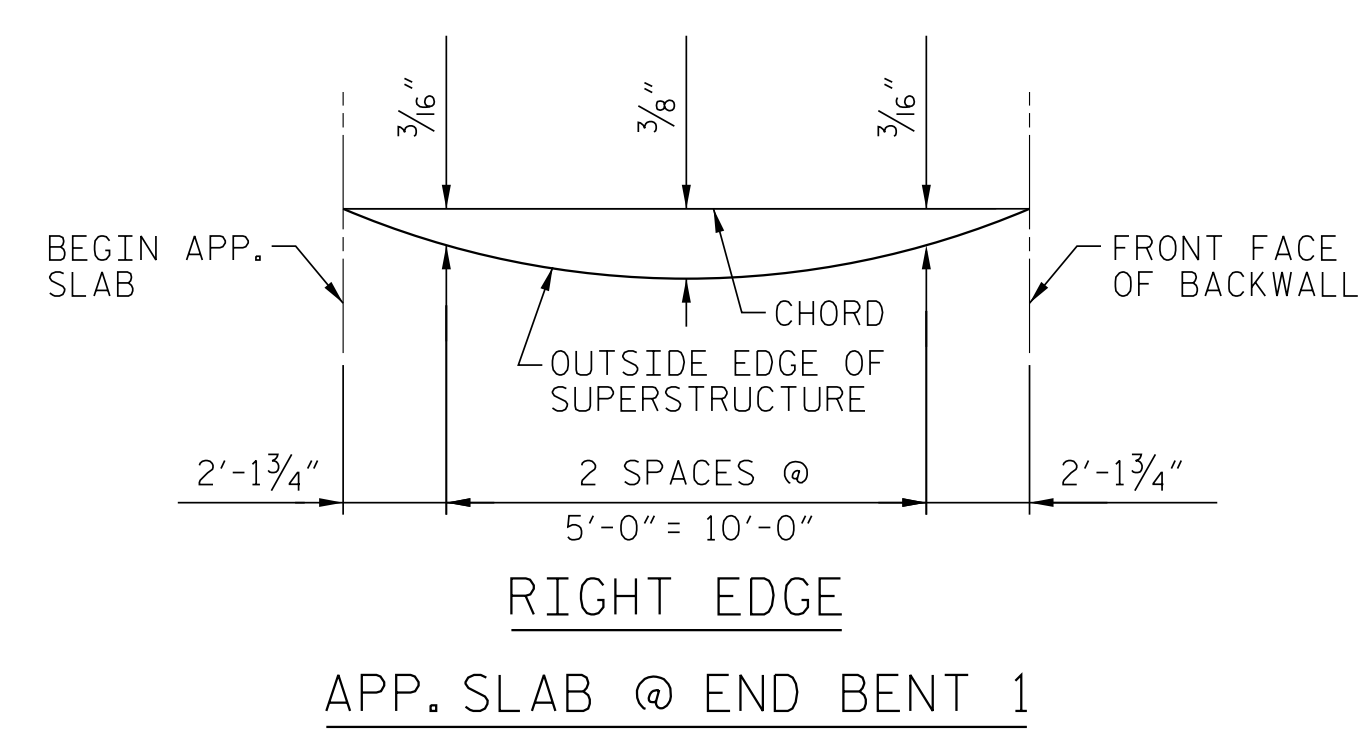
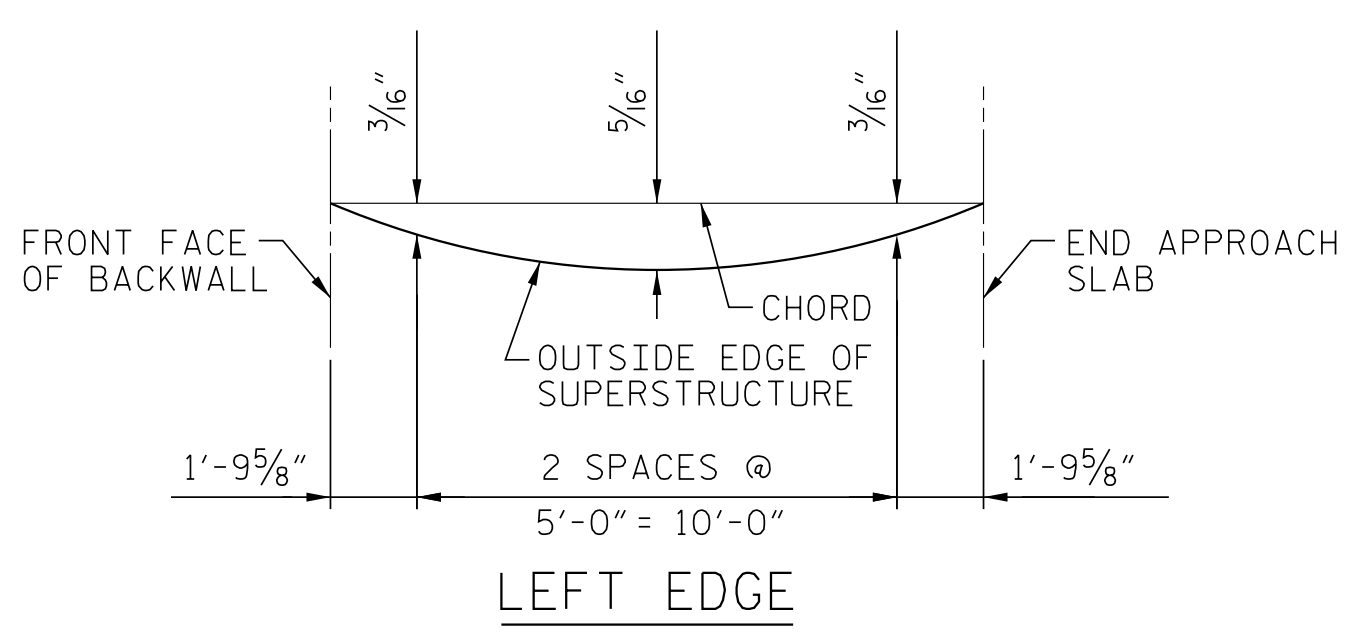
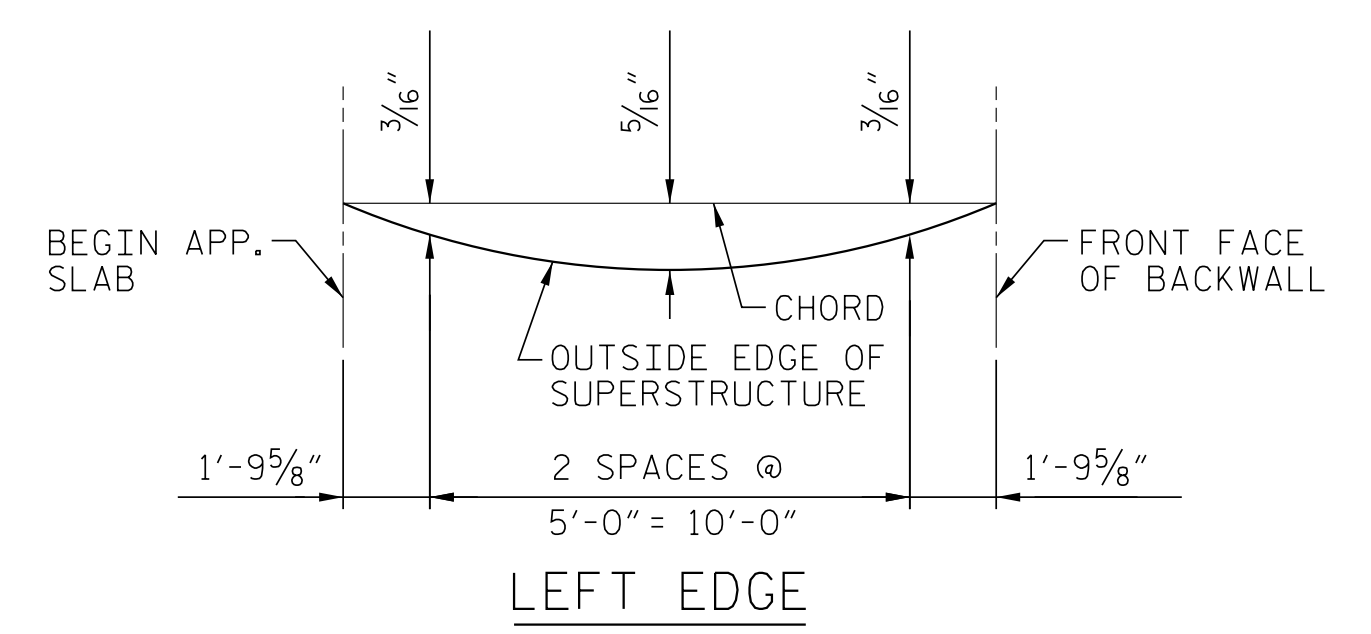

ARC OFFSETS

NOTES

APPROACH SLAB SHALL NOT BE CONSTRUCTED PRIOR TO COMPLETION OF THE BRIDGE DECK.

AREA BETWEEN THE WINGWALL AND APPROACH SLAB SHALL BE GRADED TO DRAIN THE WATER AWAY FROM THE FILL FACE OF THE BRIDGE AND SHALL BE PAVED. SEE ROADWAY PLANS.

FOR EXPANSION JOINT SEALS, SEE SPECIAL PROVISIONS.

FOR REINFORCED BRIDGE APPROACH FILL INCLUDING GEOTEXTILE, IMPERMEABLE GEOMEMBRANE, 4" Ø DRAINAGE PIPE, #78M STONE, AND SELECT MATERIAL, SEE ROADWAY PLANS.

FOR GALVANIZED REINFORCING STRAPS AND BACKFILL MATERIAL, SEE WALL PLANS AND SPECIAL PROVISIONS.

BARRIER RAIL LENGTH SHOWN IS MEASURED FROM CL JOINT ALONG BACKFACE OF RAIL.

SPLICE LENGTHS			
BAR SIZE	EPOXY COATED	UNCOATED	
#4	2'-0"	1'-9"	
#5	2'-6"	2'-2"	
#6	3'-10"	2'-7"	

BILL OF MATERIAL					
APPROACH SLAB AT EB #1					
BAR	NO.	SIZE	TYPE	LENGTH	WEIGHT
*A1	30	#4	STR	21'-6"	426
A2	32	#4	STR	21'-4"	451
*B1	78	#5	STR	14'-2"	1153
B2	78	#6	STR	14'-8"	1719
*B3	4	#5	STR	9'-8"	41
B4	4	#6	STR	9'-8"	59
*J1	39	#4	1	1'-5"	37
REINFORCING STEEL **				LBS.	3886
* EPOXY COATED REINFORCING STEEL **				LBS.	1657
CLASS AA CONCRETE **				C. Y.	26.4
APPROACH SLAB AT EB #2					
BAR	NO.	SIZE	TYPE	LENGTH	WEIGHT
*A1	30	#4	STR	21'-6"	426
A2	32	#4	STR	21'-4"	451
*B1	78	#5	STR	14'-2"	1153
B2	78	#6	STR	14'-8"	1719
*B3	4	#5	STR	9'-8"	41
B4	4	#6	STR	9'-8"	59
*J1	39	#4	1	1'-5"	37
REINFORCING STEEL **				LBS.	3886
* EPOXY COATED REINFORCING STEEL **				LBS.	1657
CLASS AA CONCRETE **				C. Y.	26.4
BAR TYPE					
ALL BAR DIMENSIONS ARE OUT TO OUT					

** QUANTITIES FOR BARRIER RAIL ARE NOT INCLUDED. SEE SHEET 3 OF 3.

THE QUANTITY OF #4 J1 BARS ON THE BILL OF MATERIAL IS BASED ON 1'-0" CENTERS. J1 BARS SHALL BE PLACED AT EACH VERTICAL STUD ANCHOR BOLT. IN THE EVENT THAT THE NUMBER OF VERTICAL STUD ANCHORS EXCEEDS THE NUMBER OF J1 BARS SPECIFIED, ADDITIONAL J1 BARS WILL NOT BE REQUIRED.

PROJECT NO. R-5516
CRAVEN COUNTY
 STATION: 32+25.84 -YEB01-
75+13.29 -L-
 SHEET 1 OF 3

AECOM
 AECOM TECHNICAL SERVICES, INC.
 701 CORPORATE CENTER DRIVE, SUITE 475
 RALEIGH, NC 27607
 (919) 854-6200 www.aecom.com
 AECOM License No. F43942

4/12/2017
 NORTH CAROLINA PROFESSIONAL ENGINEER
 SEAL 030474
 JOHN C. MORRISON

STATE OF NORTH CAROLINA DEPARTMENT OF TRANSPORTATION RALEIGH					
STANDARD BRIDGE APPROACH SLAB FOR FLEXIBLE PAVEMENT					
REVISIONS				SHEET NO.	
NO.	BY:	DATE:	NO.	BY:	DATE:
1			3		
2			4		
				S-49	
				TOTAL SHEETS 51	

ASSEMBLED BY : NKB	DATE : 03/16
CHECKED BY : JCM	DATE : 03/16
DRAWN BY : EEM 3/95	REV. 10/1/11 MAA/GM
CHECKED BY : VAP 3/95	REV. 12/21/11 MAA/GM
	REV. 6/13 MAA/GM

DOCUMENT NOT CONSIDERED FINAL UNLESS ALL SIGNATURES COMPLETED