

BENCH MARK: BM#8 - R/R SPIKE SET IN LIGHT POLE ID#129M02, -L- STA. 70+55.80, 137.2' LEFT  
 N 871980 E 1783179, ELEV. = 28.88', NAVD 1988

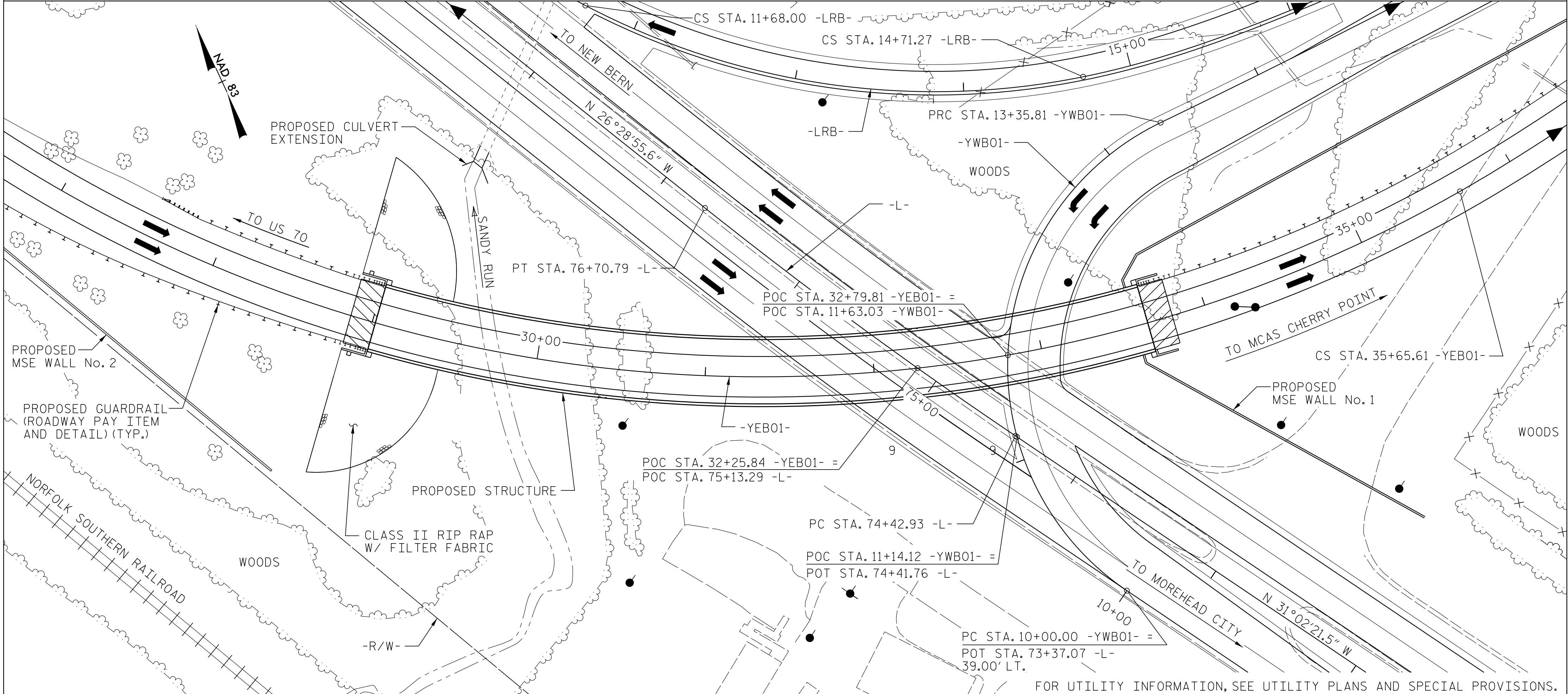

LOCATION SKETCH

**NOTES:**

- ASSUMED LIVE LOAD = HL-93 OR ALTERNATE LOADING.
- THIS BRIDGE IS DESIGNED IN ACCORDANCE WITH THE REQUIREMENTS OF THE AASHTO LRFD BRIDGE DESIGN SPECIFICATIONS.
- THIS BRIDGE IS LOCATED IN SEISMIC ZONE 1.
- THIS STRUCTURE HAS BEEN DESIGNED IN ACCORDANCE WITH "HEC-18 - EVALUATING SCOUR AT BRIDGES".
- FOR OTHER DESIGN DATA AND GENERAL NOTES, SEE SHEET SN.
- FOR SUBMITTAL OF WORKING DRAWINGS, SEE SPECIAL PROVISIONS.
- FOR FALSEWORK AND FORMWORK, SEE SPECIAL PROVISIONS.
- FOR CRANE SAFETY, SEE SPECIAL PROVISIONS.
- FOR GROUT FOR STRUCTURES, SEE SPECIAL PROVISIONS.
- FOR PLACING LOAD ON STRUCTURE MEMBERS, SEE SPECIAL PROVISIONS.
- FOR EROSION CONTROL MEASURES, SEE EROSION CONTROL PLANS.
- THE ELEVATIONS AND CLEARANCES SHOWN ON THE PLANS AT THE POINT OF MINIMUM VERTICAL CLEARANCE ARE FROM THE BEST INFORMATION AVAILABLE. PRIOR TO BEGINNING BRIDGE CONSTRUCTION, VERIFY THE ELEVATIONS ON THE EXISTING PAVEMENT AND CHECK THE CLEARANCE. REPORT ANY VARIATIONS TO THE ENGINEER. ANY PLAN REVISIONS NECESSARY TO ACHIEVE THE REQUIRED MINIMUM VERTICAL CLEARANCE WILL BE PROVIDED BY THE DEPARTMENT.
- FOR MAINTENANCE AND PROTECTION OF TRAFFIC BENEATH PROPOSED STRUCTURE, SEE SPECIAL PROVISIONS.
- REMOVABLE FORMS MAY BE USED IN LIEU OF METAL STAY-IN-PLACE FORMS IN ACCORDANCE WITH ARTICLE 420-3 OF THE STANDARD SPECIFICATIONS.
- NEEDLE BEAMS WILL NOT BE ALLOWED UNLESS OTHERWISE CALLED FOR ON THE PLANS OR APPROVED BY THE ENGINEER.
- ALL STRUCTURAL STEEL SHALL BE AASHTO M270 GRADE 50 AND PAINTED IN ACCORDANCE WITH SYSTEM 1 OF ARTICLE 442-8 OF THE STANDARD SPECIFICATIONS UNLESS OTHERWISE NOTED ON THE PLANS.
- FOR FOUNDATION NOTES, SEE "FOUNDATION LAYOUT" SHEET.
- FOR LIMITS OF TEMPORARY SHORING FOR MAINTENANCE OF TRAFFIC, SEE TRAFFIC CONTROL PLANS. FOR PAY ITEM FOR TEMPORARY SHORING FOR MAINTENANCE OF TRAFFIC, SEE ROADWAY PLANS.
- FOR INTERIOR BENTS 1 AND 2, ONLY PARTIAL GALVANIZING OF THE PILES IS REQUIRED. SEE BENT SHEETS FOR REQUIRED GALVANIZED LENGTHS. PAYMENT FOR PARTIALLY GALVANIZED PILES WILL BE MADE UNDER THE CONTRACT UNIT PRICE FOR GALVANIZED STEEL PILES.

**TOTAL BILL OF MATERIAL**

	FOUNDATION EXCAVATION AT BENT	PDA TESTING	REINFORCED CONCRETE DECK SLAB	GROOVING BRIDGE FLOORS	CLASS A CONCRETE	BRIDGE APPROACH SLABS	REINFORCING STEEL	STRUCTURAL STEEL (APPROX.)	PILE DRIVING EQUIPMENT SETUP FOR HP 12X53 STEEL PILES	PILE DRIVING EQUIPMENT SETUP FOR PP 18X0.50 GALVANIZED STEEL PILES	HP 12x53 STEEL PILES		PP 18x0.50 GALVANIZED STEEL PILES		PILE REDRIVES	CONCRETE BARRIER RAIL	4" SLOPE PROTECTION
											NO.	LIN. FT.	NO.	LIN. FT.			
SUPERSTRUCTURE	LUMP SUM	EA.	SQ. FT.	SQ. FT.	CU. YDS.	LUMP SUM	LBS.	LBS.	EA.	EA.	NO.	LIN. FT.	NO.	LIN. FT.	EA.	LIN. FT.	SQ. YD.
END BENT NO. 1					58.4		7546		12		12	1260			6		
BENT NO. 1					171.1		33535			21			21	1680	12		
BENT NO. 2	LUMP SUM				177.2		33790			21			21	1630	11		
END BENT NO. 2					55.1		7154		9		9	990			5		80
TOTAL	LUMP SUM	2	19091	17126	461.8	LUMP SUM	82025	887,980	21	42	21	2250	42	3310	34	962.32	80

	RIP RAP CLASS II (2'-0" THICK)	GEOTEXTILE FOR DRAINAGE	DISC BEARINGS	EXPANSION JOINT SEALS
SUPERSTRUCTURE				
END BENT NO. 1	923	1025		
BENT NO. 1				
BENT NO. 2				
END BENT NO. 2				
TOTAL	923	1025	LUMP SUM	LUMP SUM

DRAWN BY: S.G. STREDNAK DATE: 04/17  
 CHECKED BY: N.K. BROWN DATE: 04/17  
 DESIGN E.O.R.: J.C. MORRISON DATE: 04/17

DOCUMENT NOT CONSIDERED FINAL UNLESS ALL SIGNATURES COMPLETED

**AECOM**  
 AECOM TECHNICAL SERVICES, INC.  
 701 CORPORATE CENTER DRIVE, SUITE 475  
 RALEIGH, NC 27607  
 (919) 854-6200 www.aecom.com  
 AECOM License No. F4392

4/12/2017

NORTH CAROLINA PROFESSIONAL SEAL 030474  
 JOHN C. MORRISON  
 ENGINEER

PROJECT NO. R-5516  
CRAVEN COUNTY  
 STATION: 32+25.84 -YEB01-  
75+13.29 -L-  
 SHEET 6 OF 6

STATE OF NORTH CAROLINA  
 DEPARTMENT OF TRANSPORTATION  
 RALEIGH

GENERAL DRAWING

BRIDGE ON US 70 FLYOVER TO SLOCUM ROAD OVER US 70 INTERCHANGE

REVISIONS						SHEET NO.
NO.	BY:	DATE:	NO.	BY:	DATE:	
1			3			S-06
2			4			TOTAL SHEETS 51

DATE: 4/7/2017 TIME: 2:45:41 PM

USER: pnc1593; PATH: P:\0321454\_Siteum\_Road\002\_Technical\08\_Structural\04\030\_506\_R5516\_SML\0006.dgn