



STATE OF NORTH CAROLINA  
DEPARTMENT OF TRANSPORTATION

ROY COOPER  
GOVERNOR

JAMES H. TROGDON, III  
SECRETARY

June 14, 2017

**Addendum No. 1**

RE: Contract # C203955

WBS # 45492.3.1

F. A. # NHS-0070(154)

**Craven County (R-5516)**

Interchange From US-70 To Slocum Road At The Cherry

Point Military Base

**June 20, 2017 Letting**

To Whom It May Concern:

Reference is made to the plans and proposal form furnished to you on this project.

The following revision has been made to the Roadway plans:

Sheet No.	Revisions
3B-1	Revised to change the below noted quantity changes to Undercut and Select Granular Material associated with Line -Y09A-

Please void Sheet No. 3B-1 in your plans and staple revised Sheet No. 3B-1 thereto.

The following revisions have been made to the Cross-Section plans:

Sheet No.	Revisions
X-0B and X-44 thru X-50	Revised to correct the Undercut figures associated with Line -Y09A-

Please void Sheets No. X-0B and X-44 thru X-50 in your plans and staple the revised sheets thereto.

The Earthwork Balance Sheet in the online Digital Files folder has been revised to reflect these changes in the "Undercut".

*Mailing Address:*  
NC DEPARTMENT OF TRANSPORTATION  
CONTRACT STANDARDS AND DEVELOPMENT  
1591 MAIL SERVICE CENTER  
RALEIGH, NC 27699-1591

*Telephone:* (919) 707-6900  
*Fax:* (919) 250-4127  
*Customer Service:* 1-877-368-4968

*Location:*  
1020 BIRCH RIDGE DR.  
RALEIGH, NC 27610

*Website:* www.ncdot.gov

The following revisions have been made to the proposal:

<u>Page No.</u>	<u>Revisions</u>
Proposal Cover	Note added that reads "Includes Addendum No. 1 Dated 06-14-2017".
G-5	Revised the Line# for Utility Construction within the project special provision entitled "Specialty Items"

Please void the Proposal Cover and Page No. G-5 and staple the revised pages thereto.

On the item sheets the following pay item quantities have been changed and an item has been deleted:

<u>Item</u>	<u>Description</u>	<u>Old Quantity</u>	<u>New Quantity</u>
005-0036000000-E-225	Undercut Excavation	20,000 CY	22,600 CY
010-0195000000-E-265	Select Granular Material	34,700 CY	37,300 CY
179-5872300000-E-1550	Trenchless Installation Of 30" In Soil	375 LF	<b>DELETED</b>

The Contractor's bid must be based on these revised pay item quantities and must not include the deleted pay item. The contract will be prepared accordingly.

The Expedite File has been updated to reflect these revisions. Please download the Expedite Addendum File and follow the instructions for applying the addendum. Bid Express will not accept your bid unless the addendum has been applied.

Sincerely,

DocuSigned by:  
*Ronald Elton Davenport, Jr.*

F81B6038A47A442...  
Ronald. E. Davenport, Jr., PE  
State Contract Officer

RED/jag  
Attachments

cc: Mr. Lamar Sylvester, PE  
Mr. John Rouse PE  
Mr. Bobby Lewis, PE  
Mr. Ken Kennedy, PE  
Ms. Jaci Kincaid  
Ms. Lori Strickland  
Project File (2)

Mr. Ray Arnold, PE  
Ms. Theresa Canales, PE  
Mr. Mike Gwyn  
Ms. Penny Higgins  
Mr. Mitchell Dixon

STATE OF NORTH CAROLINA  
DEPARTMENT OF TRANSPORTATION  
RALEIGH, N.C.

PROPOSAL

**INCLUDES ADDENDUM No. 1 DATED 06-14-2017**

DATE AND TIME OF BID OPENING: **JUNE 20, 2017 AT 2:00 PM**

CONTRACT ID C203955  
WBS 45492.3.1

FEDERAL-AID NO. NHS-0070(154)

COUNTY CRAVEN

T.I.P. NO. R-5516

MILES 1.169

ROUTE NO. US 70

LOCATION INTERCHANGE FROM US-70 TO SLOCUM ROAD AT THE CHERRY POINT  
MILITARY BASE.

TYPE OF WORK GRADING, DRAINAGE, PAVING, SIGNALS & STRUCTURES.

**NOTICE:**

ALL BIDDERS SHALL COMPLY WITH ALL APPLICABLE LAWS REGULATING THE PRACTICE OF GENERAL CONTRACTING AS CONTAINED IN CHAPTER 87 OF THE GENERAL STATUTES OF NORTH CAROLINA WHICH REQUIRES THE BIDDER TO BE LICENSED BY THE N.C. LICENSING BOARD FOR CONTRACTORS WHEN BIDDING ON ANY NON-FEDERAL AID PROJECT WHERE THE BID IS \$30,000 OR MORE, EXCEPT FOR CERTAIN SPECIALTY WORK AS DETERMINED BY THE LICENSING BOARD. BIDDERS SHALL ALSO COMPLY WITH ALL OTHER APPLICABLE LAWS REGULATING THE PRACTICES OF ELECTRICAL, PLUMBING, HEATING AND AIR CONDITIONING AND REFRIGERATION CONTRACTING AS CONTAINED IN CHAPTER 87 OF THE GENERAL STATUTES OF NORTH CAROLINA. NOTWITHSTANDING THESE LIMITATIONS ON BIDDING, THE BIDDER WHO IS AWARDED ANY FEDERAL - AID FUNDED PROJECT SHALL COMPLY WITH CHAPTER 87 OF THE GENERAL STATUTES OF NORTH CAROLINA FOR LICENSING REQUIREMENTS WITHIN 60 CALENDAR DAYS OF BID OPENING.

**BIDS WILL BE RECEIVED AS SHOWN BELOW:**

**THIS IS A ROADWAY & STRUCTURE PROPOSAL**

**5% BID BOND OR BID DEPOSIT REQUIRED**

---

**SPECIALTY ITEMS:**

(7-1-95)(Rev. 1-17-12)

108-6

SP1 G37

Items listed below will be the specialty items for this contract (see Article 108-6 of the 2012 Standard Specifications).

<b>Line #</b>	<b>Description</b>
80-87	Guardrail
88-94	Fencing
98-113	Signing
129-140, 145	Long-Life Pavement Markings
146-147	Permanent Pavement Markers
150-178	Utility Construction
180-211, 213	Erosion Control
212	Reforestation
214-262	Signals/ITS System

**SPECIAL REQUIREMENTS FOR WORK IN NATIONAL FOREST:**

(7-1-95)

107-13

SP1 G40

In addition to other requirements in this proposal with respect to clearing, erosion control, protection of environment, etc., comply with the following requirements:

- (A) Comply with the portions of these Special Requirements, entitled "Fire Plan," "Clearing Plan," and "Landscape and Erosion Control Plan." Note the fact that merchantable timber within Forest Service Property will become the property of the Contractor.
- (B) Comply with the following recommendations of the State Fish and Game Department and Forest Service for wildlife and fish management:
  - (1) Take all necessary precautions to avoid damage to fish habitat and exercise every reasonable precaution to prevent muddying or silting live streams.
  - (2) Do not deposit material removed from the roadway or channel changes in live streams or into the streams or stream channel where it would be washed away by high stream flows.
  - (3) Do not haul materials, including logs, brush, and debris, by fording live streams. Instead, provide temporary bridges or other structures for this purpose.
- (C) Dispose of waste material resulting from slides during construction and surplus material at locations approved by the Forest Supervisor. Submit a plan showing the proposed method of disposal at the time approval is requested.
- (D) Treat sections of existing road to be abandoned as a result of the proposed new construction, as designated by the Forest Supervisor, to restore them to their natural state. The necessary treatment will be determined during a joint review between the Forest Service and the State and may include ripping of roadbed, removal of drainage structure, and opening drainage channels. Plans and specifications as mutually deemed appropriate to accomplish the objective will become a part of this stipulation.

County : Craven

Line #	Item Number	Sec #	Description	Quantity	Unit Cost	Amount
<b>ROADWAY ITEMS</b>						
0001	0000100000-N	800	MOBILIZATION	Lump Sum	L.S.	
0002	0000400000-N	801	CONSTRUCTION SURVEYING	Lump Sum	L.S.	
0003	0000700000-N	SP	FIELD OFFICE	Lump Sum	L.S.	
0004	0029000000-N	SP	REINFORCED BRIDGE APPROACH FILL, STATION ***** (32+25.84 -YEB01-)	Lump Sum	L.S.	
0005	0036000000-E	225	UNDERCUT EXCAVATION	22,600 CY		
0006	0043000000-N	226	GRADING	Lump Sum	L.S.	
0007	0050000000-E	226	SUPPLEMENTARY CLEARING & GRUB- BING	2 ACR		
0008	0134000000-E	240	DRAINAGE DITCH EXCAVATION	2,900 CY		
0009	0192000000-N	260	PROOF ROLLING	15 HR		
0010	0195000000-E	265	SELECT GRANULAR MATERIAL	37,300 CY		
0011	0196000000-E	270	GEOTEXTILE FOR SOIL STABILIZA- TION	70,000 SY		
0012	0199000000-E	SP	TEMPORARY SHORING	780 SF		
0013	0318000000-E	300	FOUNDATION CONDITIONING MATE- RIAL, MINOR STRUCTURES	1,732 TON		
0014	0320000000-E	300	FOUNDATION CONDITIONING GEO- TEXTILE	8,298 SY		
0015	0342000000-E	310	*** SIDE DRAIN PIPE (30")	244 LF		
0016	0343000000-E	310	15" SIDE DRAIN PIPE	132 LF		
0017	0344000000-E	310	18" SIDE DRAIN PIPE	148 LF		
0018	0345000000-E	310	24" SIDE DRAIN PIPE	244 LF		
0019	0366000000-E	310	15" RC PIPE CULVERTS, CLASS III	1,192 LF		

County : Craven

Line #	Item Number	Sec #	Description	Quantity	Unit Cost	Amount
0020	0372000000-E	310	18" RC PIPE CULVERTS, CLASS III	644	LF	
0021	0378000000-E	310	24" RC PIPE CULVERTS, CLASS III	140	LF	
0022	0384000000-E	310	30" RC PIPE CULVERTS, CLASS III	428	LF	
0023	0408000000-E	310	54" RC PIPE CULVERTS, CLASS III	136	LF	
0024	0420000000-E	310	66" RC PIPE CULVERTS, CLASS III	320	LF	
0025	0448200000-E	310	15" RC PIPE CULVERTS, CLASS IV	1,724	LF	
0026	0448300000-E	310	18" RC PIPE CULVERTS, CLASS IV	1,128	LF	
0027	0448400000-E	310	24" RC PIPE CULVERTS, CLASS IV	100	LF	
0028	0448500000-E	310	30" RC PIPE CULVERTS, CLASS IV	96	LF	
0029	0546000000-E	310	*** CAA PIPE CULVERTS, ***** THICK (15", 0.064")	412	LF	
0030	0546000000-E	310	*** CAA PIPE CULVERTS, ***** THICK (18", 0.064")	160	LF	
0031	0564000000-E	310	*** CAA PIPE ELBOWS, ***** THICK (15", 0.064")	10	EA	
0032	0564000000-E	310	*** CAA PIPE ELBOWS, ***** THICK (18", 0.064")	2	EA	
0033	0973100000-E	330	*** WELDED STEEL PIPE, ***** THICK, GRADE B IN SOIL (18", 0.5")	80	LF	
0034	0973100000-E	330	*** WELDED STEEL PIPE, ***** THICK, GRADE B IN SOIL (30", 0.5")	380	LF	
0035	0995000000-E	340	PIPE REMOVAL	2,803	LF	

County : Craven

Line #	Item Number	Sec #	Description	Quantity	Unit Cost	Amount
0036	1077000000-E	SP	#57 STONE	5 TON		
0037	1099500000-E	505	SHALLOW UNDERCUT	10,520 CY		
0038	1099700000-E	505	CLASS IV SUBGRADE STABILIZATION	20,300 TON		
0039	1111000000-E	SP	CLASS IV AGGREGATE STABILIZATION	6,750 TON		
0040	1121000000-E	520	AGGREGATE BASE COURSE	3,354 TON		
0041	1220000000-E	545	INCIDENTAL STONE BASE	200 TON		
0042	1275000000-E	600	PRIME COAT	1,048.6 GAL		
0043	1489000000-E	610	ASPHALT CONC BASE COURSE, TYPE B25.0B	5,090 TON		
0044	1491000000-E	610	ASPHALT CONC BASE COURSE, TYPE B25.0C	11,620 TON		
0045	1498000000-E	610	ASPHALT CONC INTERMEDIATE COURSE, TYPE I19.0B	1,380 TON		
0046	1503000000-E	610	ASPHALT CONC INTERMEDIATE COURSE, TYPE I19.0C	10,740 TON		
0047	1519000000-E	610	ASPHALT CONC SURFACE COURSE, TYPE S9.5B	5,320 TON		
0048	1523000000-E	610	ASPHALT CONC SURFACE COURSE, TYPE S9.5C	11,490 TON		
0049	1575000000-E	620	ASPHALT BINDER FOR PLANT MIX	2,315 TON		
0050	1693000000-E	654	ASPHALT PLANT MIX, PAVEMENT REPAIR	200 TON		
0051	2022000000-E	815	SUBDRAIN EXCAVATION	168 CY		
0052	2026000000-E	815	GEOTEXTILE FOR SUBSURFACE DRAINS	500 SY		
0053	2036000000-E	815	SUBDRAIN COARSE AGGREGATE	84 CY		

County : Craven

Line #	Item Number	Sec #	Description	Quantity	Unit Cost	Amount
0054	2044000000-E	815	6" PERFORATED SUBDRAIN PIPE	500 LF		
0055	2070000000-N	815	SUBDRAIN PIPE OUTLET	1 EA		
0056	2077000000-E	815	6" OUTLET PIPE	6 LF		
0057	2220000000-E	838	REINFORCED ENDWALLS	13.7 CY		
0058	2253000000-E	840	PIPE COLLARS	1.34 CY		
0059	2264000000-E	840	PIPE PLUGS	0.35 CY		
0060	2275000000-E	SP	FLOWABLE FILL	11 CY		
0061	2286000000-N	840	MASONRY DRAINAGE STRUCTURES	67 EA		
0062	2297000000-E	840	MASONRY DRAINAGE STRUCTURES	30.8 CY		
0063	2308000000-E	840	MASONRY DRAINAGE STRUCTURES	7.8 LF		
0064	2364000000-N	840	FRAME WITH TWO GRATES, STD 840.16	27 EA		
0065	2364200000-N	840	FRAME WITH TWO GRATES, STD 840.20	7 EA		
0066	2365000000-N	840	FRAME WITH TWO GRATES, STD 840.22	21 EA		
0067	2366000000-N	840	FRAME WITH TWO GRATES, STD 840.24	5 EA		
0068	2367000000-N	840	FRAME WITH TWO GRATES, STD 840.29	3 EA		
0069	2374000000-N	840	FRAME WITH GRATE & HOOD, STD 840.03, TYPE ** (G)	3 EA		
0070	2396000000-N	840	FRAME WITH COVER, STD 840.54	1 EA		
0071	2407000000-N	840	STEEL FRAME WITH TWO GRATES, STD 840.37	1 EA		



County : Craven

Line #	Item Number	Sec #	Description	Quantity	Unit Cost	Amount
0072	2451000000-N	852	CONCRETE TRANSITIONAL SECTION FOR DROP INLET	23 EA		
0073	2549000000-E	846	2'-6" CONCRETE CURB & GUTTER	280 LF		
0074	2556000000-E	846	SHOULDER BERM GUTTER	910 LF		
0075	2619000000-E	850	4" CONCRETE PAVED DITCH	110 SY		
0076	2655000000-E	852	5" MONOLITHIC CONCRETE ISLANDS (KEYED IN)	1,610 SY		
0077	2724000000-E	857	PRECAST REINFORCED CONCRETE BARRIER, SINGLE FACED	40 LF		
0078	2815000000-N	858	ADJUSTMENT OF DROP INLETS	1 EA		
0079	2938000000-N	859	CONVERT EXISTING DROP INLET TO JUNCTION BOX WITH MANHOLE	1 EA		
0080	3000000000-N	SP	IMPACT ATTENUATOR UNIT, TYPE 350	4 EA		
0081	3030000000-E	862	STEEL BM GUARDRAIL	2,375 LF		
0082	3105000000-N	862	STEEL BM GUARDRAIL TERMINAL SECTIONS	2 EA		
0083	3150000000-N	862	ADDITIONAL GUARDRAIL POSTS	10 EA		
0084	3210000000-N	862	GUARDRAIL ANCHOR UNITS, TYPE CAT-1	2 EA		
0085	3270000000-N	SP	GUARDRAIL ANCHOR UNITS, TYPE 350	3 EA		
0086	3317000000-N	862	GUARDRAIL ANCHOR UNITS, TYPE B-77	7 EA		
0087	3360000000-E	863	REMOVE EXISTING GUARDRAIL	440 LF		
0088	3503000000-E	866	WOVEN WIRE FENCE, 47" FABRIC	6,360 LF		
0089	3506000000-E	866	4" TIMBER FENCE POSTS, ***** LONG (8')	386 EA		

County : Craven

Line #	Item Number	Sec #	Description	Quantity	Unit Cost	Amount
0090	3515000000-E	866	5" TIMBER FENCE POSTS, 8'-0" LONG	127 EA		
0091	3533000000-E	866	CHAIN LINK FENCE, *** FABRIC (84")	5,310 LF		
0092	3539000000-E	866	METAL LINE POSTS FOR *** CHAIN LINK FENCE (84")	447 EA		
0093	3545000000-E	866	METAL TERMINAL POSTS FOR *** CHAIN LINK FENCE (84")	37 EA		
0094	3578000000-N	SP	GENERIC FENCING ITEM 24' STEEL PIPE GATE	1 EA		
0095	3628000000-E	876	RIP RAP, CLASS I	730 TON		
0096	3649000000-E	876	RIP RAP, CLASS B	380 TON		
0097	3656000000-E	876	GEOTEXTILE FOR DRAINAGE	3,915 SY		
0098	4048000000-E	902	REINFORCED CONCRETE SIGN FOUNDATIONS	4 CY		
0099	4054000000-E	902	PLAIN CONCRETE SIGN FOUNDATIONS	1 CY		
0100	4057000000-E	SP	OVERHEAD FOOTING	37 CY		
0101	4060000000-E	903	SUPPORTS, BREAKAWAY STEEL BEAM	4,814 LB		
0102	4072000000-E	903	SUPPORTS, 3-LB STEEL U-CHANNEL	220 LF		
0103	4082000000-E	903	SUPPORTS, WOOD	1,905 LF		
0104	4082100000-N	SP	SUPPORTS, OVERHEAD SIGN STRUCTURE AT STA ***** (21+00 -YWB01-)	Lump Sum	L.S.	
0105	4082100000-N	SP	SUPPORTS, OVERHEAD SIGN STRUCTURE AT STA ***** (96+78 -L-)	Lump Sum	L.S.	
0106	4096000000-N	904	SIGN ERECTION, TYPE D	5 EA		

County : Craven

Line #	Item Number	Sec #	Description	Quantity	Unit Cost	Amount
0107	4102000000-N	904	SIGN ERECTION, TYPE E	78 EA		
0108	4108000000-N	904	SIGN ERECTION, TYPE F	11 EA		
0109	4110000000-N	904	SIGN ERECTION, TYPE *** (GROUND MOUNTED) (A)	9 EA		
0110	4116100000-N	904	SIGN ERECTION, RELOCATE, TYPE **** (GROUND MOUNTED) (D)	4 EA		
0111	4141000000-N	907	DISPOSAL OF SUPPORT, WOOD	4 EA		
0112	4158000000-N	907	DISPOSAL OF SIGN SYSTEM, WOOD	49 EA		
0113	4370000000-N	SP	GENERIC SIGNING ITEM DISPOSAL OF FLASHER SYSTEM	Lump Sum	L.S.	
0114	4400000000-E	1110	WORK ZONE SIGNS (STATIONARY)	256 SF		
0115	4405000000-E	1110	WORK ZONE SIGNS (PORTABLE)	580 SF		
0116	4410000000-E	1110	WORK ZONE SIGNS (BARRICADE MOUNTED)	214 SF		
0117	4415000000-N	1115	FLASHING ARROW BOARD	2 EA		
0118	4420000000-N	1120	PORTABLE CHANGEABLE MESSAGE SIGN	2 EA		
0119	4430000000-N	1130	DRUMS	500 EA		
0120	4435000000-N	1135	CONES	100 EA		
0121	4445000000-E	1145	BARRICADES (TYPE III)	232 LF		
0122	4455000000-N	1150	FLAGGER	360 DAY		
0123	4465000000-N	1160	TEMPORARY CRASH CUSHIONS	5 EA		
0124	4480000000-N	1165	TMA	2 EA		
0125	4490000000-E	1170	PORTABLE CONCRETE BARRIER (ANCHORED)	721 LF		

County : Craven

Line #	Item Number	Sec #	Description	Quantity	Unit Cost	Amount
0126	4510000000-N	SP	LAW ENFORCEMENT	240	HR	
0127	4516000000-N	1180	SKINNY DRUM	200	EA	
0128	4650000000-N	1251	TEMPORARY RAISED PAVEMENT MARKERS	268	EA	
0129	4685000000-E	1205	THERMOPLASTIC PAVEMENT MARKING LINES (4", 90 MILS)	22,017	LF	
0130	4686000000-E	1205	THERMOPLASTIC PAVEMENT MARKING LINES (4", 120 MILS)	9,685	LF	
0131	4688000000-E	1205	THERMOPLASTIC PAVEMENT MARKING LINES (6", 90 MILS)	24,947	LF	
0132	4690000000-E	1205	THERMOPLASTIC PAVEMENT MARKING LINES (6", 120 MILS)	6,069	LF	
0133	4695000000-E	1205	THERMOPLASTIC PAVEMENT MARKING LINES (8", 90 MILS)	2,838	LF	
0134	4697000000-E	1205	THERMOPLASTIC PAVEMENT MARKING LINES (8", 120 MILS)	899	LF	
0135	4700000000-E	1205	THERMOPLASTIC PAVEMENT MARKING LINES (12", 90 MILS)	2,035	LF	
0136	4702000000-E	1205	THERMOPLASTIC PAVEMENT MARKING LINES (12", 120 MILS)	1,090	LF	
0137	4705000000-E	1205	THERMOPLASTIC PAVEMENT MARKING LINES (16", 120 MILS)	95	LF	
0138	4710000000-E	1205	THERMOPLASTIC PAVEMENT MARKING LINES (24", 120 MILS)	580	LF	
0139	4721000000-E	1205	THERMOPLASTIC PAVEMENT MARKING CHARACTER (120 MILS)	24	EA	
0140	4725000000-E	1205	THERMOPLASTIC PAVEMENT MARKING SYMBOL (90 MILS)	98	EA	
0141	4810000000-E	1205	PAINT PAVEMENT MARKING LINES (4")	16,133	LF	
0142	4820000000-E	1205	PAINT PAVEMENT MARKING LINES (8")	222	LF	

County : Craven

Line #	Item Number	Sec #	Description	Quantity	Unit Cost	Amount
0143	4835000000-E	1205	PAINT PAVEMENT MARKING LINES (24")	137	LF	
0144	4845000000-N	1205	PAINT PAVEMENT MARKING SYMBOL	13	EA	
0145	4847000000-E	1205	POLYUREA PAVEMENT MARKING LINES (4", *****) (HIGHLY REFLECTIVE ELEMENTS)	1,116	LF	
0146	4900000000-N	1251	PERMANENT RAISED PAVEMENT MARKERS	6	EA	
0147	4905000000-N	1253	SNOWPLOWABLE PAVEMENT MARKERS	800	EA	
0148	4935000000-N	1267	FLEXIBLE DELINEATORS (CRYSTAL)	76	EA	
0149	4940000000-N	1267	FLEXIBLE DELINEATORS (YELLOW)	64	EA	
0150	5325200000-E	1510	2" WATER LINE	12	LF	
0151	5325600000-E	1510	6" WATER LINE	85	LF	
0152	5325800000-E	1510	8" WATER LINE	4,450	LF	
0153	5326000000-E	1510	10" WATER LINE	5,402	LF	
0154	5326200000-E	1510	12" WATER LINE	4,224	LF	
0155	5329000000-E	SP	DUCTILE IRON WATER PIPE FITTINGS	13,510	LB	
0156	5536000000-E	1515	2" VALVE	1	EA	
0157	5540000000-E	1515	6" VALVE	2	EA	
0158	5546000000-E	1515	8" VALVE	5	EA	
0159	5552000000-E	1515	10" VALVE	4	EA	
0160	5558000000-E	1515	12" VALVE	1	EA	
0161	5571800000-E	1515	8" TAPPING VALVE	1	EA	

County : Craven

Line #	Item Number	Sec #	Description	Quantity	Unit Cost	Amount
0162	5589200000-E	1515	2" AIR RELEASE VALVE	2 EA		
0163	5648000000-N	1515	RELOCATE WATER METER	4 EA		
0164	5649000000-N	1515	RECONNECT WATER METER	2 EA		
0165	5672000000-N	1515	RELOCATE FIRE HYDRANT	4 EA		
0166	5709100000-E	1520	2" FORCE MAIN SEWER	476 LF		
0167	5709300000-E	1520	6" FORCE MAIN SEWER	60 LF		
0168	5709400000-E	1520	8" FORCE MAIN SEWER	2,957 LF		
0169	5769000000-E	SP	DUCTILE IRON SEWER PIPE FITTINGS	4,030 LB		
0170	5775000000-E	1525	4' DIA UTILITY MANHOLE	2 EA		
0171	5781000000-E	1525	UTILITY MANHOLE WALL, 4' DIA	2 LF		
0172	5798000000-E	1530	ABANDON *** UTILITY PIPE (2")	530 LF		
0173	5800000000-E	1530	ABANDON 6" UTILITY PIPE	165 LF		
0174	5801000000-E	1530	ABANDON 8" UTILITY PIPE	7,435 LF		
0175	5802000000-E	1530	ABANDON 10" UTILITY PIPE	5,353 LF		
0176	5804000000-E	1530	ABANDON 12" UTILITY PIPE	4,092 LF		
0177	5816000000-N	1530	ABANDON UTILITY MANHOLE	1 EA		
0178	5828000000-N	1530	REMOVE UTILITY MANHOLE	1 EA		
0180	6000000000-E	1605	TEMPORARY SILT FENCE	27,500 LF		
0181	6006000000-E	1610	STONE FOR EROSION CONTROL, CLASS A	2,680 TON		
0182	6009000000-E	1610	STONE FOR EROSION CONTROL, CLASS B	5,375 TON		

County : Craven

Line #	Item Number	Sec #	Description	Quantity	Unit Cost	Amount
0183	6012000000-E	1610	SEDIMENT CONTROL STONE	4,255 TON		
0184	6015000000-E	1615	TEMPORARY MULCHING	179.5 ACR		
0185	6018000000-E	1620	SEED FOR TEMPORARY SEEDING	7,800 LB		
0186	6021000000-E	1620	FERTILIZER FOR TEMPORARY SEED- ING	39 TON		
0187	6024000000-E	1622	TEMPORARY SLOPE DRAINS	5,000 LF		
0188	6029000000-E	SP	SAFETY FENCE	2,000 LF		
0189	6030000000-E	1630	SILT EXCAVATION	15,200 CY		
0190	6036000000-E	1631	MATTING FOR EROSION CONTROL	22,500 SY		
0191	6037000000-E	SP	COIR FIBER MAT	1,100 SY		
0192	6042000000-E	1632	1/4" HARDWARE CLOTH	800 LF		
0193	6043000000-E	SP	LOW PERMEABILITY GEOTEXTILE	500 SY		
0194	6045000000-E	SP	*** TEMPORARY PIPE (24")	110 LF		
0195	6069000000-E	1638	STILLING BASINS	686 CY		
0196	6071010000-E	SP	WATTLE	8,400 LF		
0197	6071013000-E	SP	WATTLE BARRIER	1,900 LF		
0198	6071020000-E	SP	POLYACRYLAMIDE (PAM)	5,620 LB		
0199	6071030000-E	1640	COIR FIBER BAFFLE	5,500 LF		
0200	6071050000-E	SP	*** SKIMMER (1-1/2")	11 EA		
0201	6071050000-E	SP	*** SKIMMER (2")	4 EA		
0202	6084000000-E	1660	SEEDING & MULCHING	126 ACR		

County : Craven

Line #	Item Number	Sec #	Description	Quantity	Unit Cost	Amount
0203	6087000000-E	1660	MOWING	67	ACR	
0204	6090000000-E	1661	SEED FOR REPAIR SEEDING	1,850	LB	
0205	6093000000-E	1661	FERTILIZER FOR REPAIR SEEDING	5.5	TON	
0206	6096000000-E	1662	SEED FOR SUPPLEMENTAL SEEDING	2,950	LB	
0207	6108000000-E	1665	FERTILIZER TOPDRESSING	88	TON	
0208	6111000000-E	SP	IMPERVIOUS DIKE	382	LF	
0209	6114500000-N	1667	SPECIALIZED HAND MOWING	10	MHR	
0210	6117000000-N	SP	RESPONSE FOR EROSION CONTROL	125	EA	
0211	6120000000-E	SP	CULVERT DIVERSION CHANNEL	160	CY	
0212	6123000000-E	1670	REFORESTATION	0.1	ACR	
0213	6132000000-N	SP	GENERIC EROSION CONTROL ITEM CONCRETE WASHOUT STRUCTURE	10	EA	
0214	7060000000-E	1705	SIGNAL CABLE	9,560	LF	
0215	7108000000-E	1705	VEHICLE SIGNAL HEAD (12", 1 SECTION)	8	EA	
0216	7120000000-E	1705	VEHICLE SIGNAL HEAD (12", 3 SECTION)	37	EA	
0217	7132000000-E	1705	VEHICLE SIGNAL HEAD (12", 4 SECTION)	4	EA	
0218	7144000000-E	1705	VEHICLE SIGNAL HEAD (12", 5 SECTION)	1	EA	
0219	7264000000-E	1710	MESSENGER CABLE (3/8")	2,200	LF	
0220	7279000000-E	1715	TRACER WIRE	3,797	LF	
0221	7300000000-E	1715	UNPAVED TRENCHING (***** (1, 2')	6,352	LF	



County : Craven

Line #	Item Number	Sec #	Description	Quantity	Unit Cost	Amount
0222	7300000000-E	1715	UNPAVED TRENCHING (***** (2, 2")	860	LF	
0223	7300000000-E	1715	UNPAVED TRENCHING (***** (3, 2")	250	LF	
0224	7300100000-E	1715	UNPAVED TRENCHING FOR TEMP- ORARY LEAD-IN	850	LF	
0225	7301000000-E	1715	DIRECTIONAL DRILL (***** (1, 2")	1,924	LF	
0226	7324000000-N	1716	JUNCTION BOX (STANDARD SIZE)	27	EA	
0227	7348000000-N	1716	JUNCTION BOX (OVER-SIZED, HEA- VY DUTY)	11	EA	
0228	7360000000-N	1720	WOOD POLE	7	EA	
0229	7372000000-N	1721	GUY ASSEMBLY	14	EA	
0230	7408000000-E	1722	1" RISER WITH WEATHERHEAD	2	EA	
0231	7420000000-E	1722	2" RISER WITH WEATHERHEAD	6	EA	
0232	7444000000-E	1725	INDUCTIVE LOOP SAWCUT	2,800	LF	
0233	7456000000-E	1726	LEAD-IN CABLE (***** (14-2)	13,070	LF	
0234	7481000000-N	SP	SITE SURVEY	1	EA	
0235	7481200000-N	SP	LUMINAIRE ARM FOR VIDEO SYSTEM	4	EA	
0236	7481240000-N	SP	CAMERA WITHOUT INTERNAL LOOP EMULATOR PROCESSING UNIT	4	EA	
0237	7481260000-N	SP	EXTERNAL LOOP EMULATOR PRO- CESSING UNIT	1	EA	
0238	7481280000-N	SP	RELOCATE CAMERA SENSOR UNIT	4	EA	
0239	7516000000-E	1730	COMMUNICATIONS CABLE (**FIBER) (12)	4,743	LF	

County : Craven

Line #	Item Number	Sec #	Description	Quantity	Unit Cost	Amount
0240	7528000000-E	1730	DROP CABLE	3		
				LF		
0241	7540000000-N	1731	SPLICE ENCLOSURE	4		
				EA		
0242	7541000000-N	1731	MODIFY SPLICE ENCLOSURE	1		
				EA		
0243	7552000000-N	1731	INTERCONNECT CENTER	3		
				EA		
0244	7564100000-N	1732	FIBER-OPTIC TRANSCEIVER, SELF-HEALING RING	3		
				EA		
0245	7566000000-N	1733	DELINEATOR MARKER	9		
				EA		
0246	7575142060-N	SP	MODIFY RADIO INSTALLATION	2		
				EA		
0247	7576000000-N	SP	METAL STRAIN SIGNAL POLE	7		
				EA		
0248	7613000000-N	SP	SOIL TEST	7		
				EA		
0249	7614100000-E	SP	DRILLED PIER FOUNDATION	64		
				CY		
0250	7636000000-N	1745	SIGN FOR SIGNALS	8		
				EA		
0251	7642200000-N	1743	TYPE II PEDESTAL WITH FOUNDATION	7		
				EA		
0252	7642300000-N	1743	TYPE III PEDESTAL WITH FOUNDATION	4		
				EA		
0253	7684000000-N	1750	SIGNAL CABINET FOUNDATION	3		
				EA		
0254	7756000000-N	1751	CONTROLLER WITH CABINET (TYPE 2070L, BASE MOUNTED)	3		
				EA		
0255	7768000000-N	1751	CONTROLLER WITH CABINET (TYPE 2070L, POLE MOUNTED)	1		
				EA		
0256	7780000000-N	1751	DETECTOR CARD (TYPE 2070L)	26		
				EA		
0257	7901000000-N	1753	CABINET BASE EXTENDER	3		
				EA		
0258	7960000000-N	SP	METAL POLE FOUNDATION REMOVAL	7		
				EA		
0259	7972000000-N	SP	METAL POLE REMOVAL	7		
				EA		

County : Craven

Line #	Item Number	Sec #	Description	Quantity	Unit Cost	Amount
0260	7980000000-N	SP	GENERIC SIGNAL ITEM RELOCATE EMERGENCY VEHICLE PHASE SELECTOR	1 EA		
0261	7980000000-N	SP	GENERIC SIGNAL ITEM RELOCATE EMERGENCY VEHICLE DETECTOR	2 EA		
0262	7990000000-E	SP	GENERIC SIGNAL ITEM EMERGENCY VEHICLE DETECTOR CABLE	750 LF		

**CULVERT ITEMS**

0263	8126000000-N	414	CULVERT EXCAVATION, STA ***** (26+94.23 -Y09A-)	Lump Sum	L.S.	
0264	8126000000-N	414	CULVERT EXCAVATION, STA ***** (78+05.84 -L-)	Lump Sum	L.S.	
0265	8133000000-E	414	FOUNDATION CONDITIONING MATER- IAL, BOX CULVERT	119.6 TON		
0266	8196000000-E	420	CLASS A CONCRETE (CULVERT)	180 CY		
0267	8245000000-E	425	REINFORCING STEEL (CULVERT)	41,114 LB		

**WALL ITEMS**

0268	8801000000-E	SP	MSE RETAINING WALL NO **** (1)	17,700 SF		
0269	8801000000-E	SP	MSE RETAINING WALL NO **** (2)	9,200 SF		

County : Craven

Line #	Item Number	Sec #	Description	Quantity	Unit Cost	Amount
<b>STRUCTURE ITEMS</b>						
0270	8091000000-N	410	FOUNDATION EXCAVATION FOR BENT ** AT STATION ***** (2, 32+25.84 -YEB01-)	Lump Sum	L.S.	
0271	8112730000-N	450	PDA TESTING	2 EA		
0272	8147000000-E	420	REINFORCED CONCRETE DECK SLAB	19,091 SF		
0273	8161000000-E	420	GROOVING BRIDGE FLOORS	17,126 SF		
0274	8182000000-E	420	CLASS A CONCRETE (BRIDGE)	461.8 CY		
0275	8210000000-N	422	BRIDGE APPROACH SLABS, STATION ***** (32+25.84 -YEB01-)	Lump Sum	L.S.	
0276	8217000000-E	425	REINFORCING STEEL (BRIDGE)	82,025 LB		
0277	8280000000-E	440	APPROX ..... LBS STRUCTURAL STEEL	887,980 LS		
0278	8328200000-E	SP	PILE DRIVING EQUIPMENT SETUP FOR *** STEEL PILES (HP 12 X 53)	21 EA		
0279	8328400000-E	SP	PILE DRIVING EQUIPMENT SETUP FOR *** GALVANIZED STEEL PILES (PP 18 X 0.50)	42 EA		
0280	8364000000-E	450	HP12X53 STEEL PILES	2,250 LF		
0281	8387000000-E	450	PP 18 X 0.50 GALVANIZED STEEL PILES	3,310 LF		
0282	8393000000-N	450	PILE REDRIVES	34 EA		
0283	8503000000-E	460	CONCRETE BARRIER RAIL	962.32 LF		
0284	8531000000-E	462	4" SLOPE PROTECTION	80 SY		
0285	8608000000-E	876	RIP RAP CLASS II (2'-0" THICK)	923 TON		
0286	8622000000-E	876	GEOTEXTILE FOR DRAINAGE	1,025 SY		
0287	8654000000-N	SP	DISC BEARINGS	Lump Sum	L.S.	

County : Craven

---

Line #	Item Number	Sec #	Description	Quantity	Unit Cost	Amount
--------	-------------	-------	-------------	----------	-----------	--------

---

0288	8706000000-N	SP	EXPANSION JOINT SEALS	Lump Sum	L.S.	
------	--------------	----	-----------------------	----------	------	--

---

---

1612/Jun13/Q1676088.41/D1349487025060/E287

Total Amount Of Bid For Entire Project :

---

## Earthwork Balance Sheet

Volumes in Cubic Yards

PROJECT: R-5516

COUNTY: Craven

DATE: 5/19/2017

COMPILED BY: EHW

SHEET \_\_\_ OF \_\_\_ SHEETS

STATION	STATION	EXCAVATION					EMBANKMENT				BORROW	WASTE			
		TOTAL UNCLASS.	ROCK	UNDERCUT	UNSUIT. UNCLASS.	SUITABLE UNCLASS.	TOTAL	ROCK	EARTH	EMBANK. +30%		ROCK	SUITABLE	UNSUIT.	TOTAL
-L- 60+00.00 (LEFT)	-L- 90+00.00 (LEFT)	2,550				2,550	1,513		1,513	1,967			583		583
-L- 60+00.00 (CENTER)	-L- 90+00.00 (CENTER)	718				718	200		200	260			458		458
-L- 60+00.00 (RIGHT)	-L- 90+00.00 (RIGHT)	5,723				5,723	3,024		3,024	3,931			1,792		1,792
-L- 90+00.00 (LEFT)	-L- 121+50.00 (LEFT)	6,431				6,431	5,266		5,266	6,846	415				
-L- 90+00.00 (CENTER)	-L- 121+50.00 (CENTER)	965				965	284		284	369			596		596
-L- 90+00.00 (RIGHT)	-L- 121+50.00 (RIGHT)	5,002				5,002	3,804		3,804	4,945			57		57
	<b>SUBTOTAL</b>	21,389				21,389	14,091		14,091	18,318	415		3,486		3,486
-LRA- 13+00.00	-LRA- 16+00.00	563		246		563	3,244		3,244	4,217	3,654			246	246
-LRB- 13+00.00	-LRB- 14+50.00	276		164		276	667		667	867	591			164	164
-YWB01- 12+00.00	-YWB01- 13+00.00	18		246		18	294		294	382	364			246	246
	<b>SUBTOTAL</b>	857		656		857	4,205		4,205	5,466	4,609			656	656
-YEB01- 15+00.00	-YEB01- 29+00.00 (BEG BRIDGE)	2,219		2,282		2,219	56,333		56,333	73,233	71,014			2,282	2,282
-YEB01- 34+00.00 (END BRIDGE)	-YEB01- 38+00.00	642		1,062		642	62,955		62,955	81,842	81,200			1,062	1,062
-YEB01- 38+00.00	-YEB01- 60+00.00	21,173		3,738		21,173	23,454		23,454	30,490	9,317			3,738	3,738
	<b>SUBTOTAL</b>	24,034		7,082		24,034	142,742		142,742	185,564	161,530			7,082	7,082
-Y09A- 10+50.00	-Y09A- 28+00.00	7,835		4,096		7,835	15,571		15,571	20,242	12,407			4,096	4,096
-Y10A- 12+00.00	-Y10A- 40+50.00	4,537		4,488		4,537	5,814		5,814	7,558	3,021			4,488	4,488
-Y11A- 18+00.00	-Y11A- 27+50.00	3,764		820		3,764	457		457	594		3,170	820		3,990
	<b>SUBTOTAL</b>	16,136		9,404		16,136	21,842		21,842	28,394	15,428	3,170	9,404		12,573
	<b>TOTAL</b>	62,416		17,142		62,416	182,880		182,880	237,742	181,982	6,655	17,142		23,797
	LOSS DUE TO CLEARING & GRUBBING	-7,000				-7,000					7,000				
	ADDITIONAL UNDERCUT (CONTINGENCY)			5,400			5,400		5,400	7,020			5,400		5,400
	UNCLASSIFIED EXCAVATION				620	-620					620		620		620
	WASTE IN LIEU OF BORROW										-6,655		-6,655		-6,655
	<b>PROJECT TOTAL</b>	55,416		22,542	620	54,796	188,280		188,280	244,762	189,967		23,162		23,162
	EST. 5% TO REPLACE TOP SOIL ON BORROW PIT										9,498				
	<b>GRAND TOTAL</b>	55,416		22,542	620	54,796	188,280		188,280	244,762	199,465		23,162		23,162
	<b>SAY</b>	56,000		22,600							200,000				

NOTE: EARTHWORK QUANTITIES ARE CALCULATED BY THE ROADWAY DESIGN UNIT. THESE EARTHWORK QUANTITIES ARE BASED IN PART ON SUBSURFACE DATA PROVIDED BY THE GEOTECHNICAL ENGINEERING UNIT.

- EST. DDE = 2,900 CUBIC YARDS
- EST. SELECT GRANULAR MATERIAL = 37,300 CUBIC YARDS
- EST. SHALLOW UNDERCUT BY STATIONS = 7,220 CUBIC YARDS
- EST. SHALLOW UNDERCUT CONTINGENCY = 3,300 CUBIC YARDS
- TOTAL SHALLOW UNDERCUT = 10,520 CUBIC YARDS
- EST. CLASS IV SUBGRADE STABILIZATION = 13,900 TONS
- CLASS IV SUBGRADE STABILIZATION CONTINGENCY = 6,400 TONS
- TOTAL CLASS IV SUBGRADE STABILIZATION = 20,300 TONS
- EST. GEOTEXTILE FOR SOIL STABILIZATION = 70,000 SQUARE YARDS







6/23/16

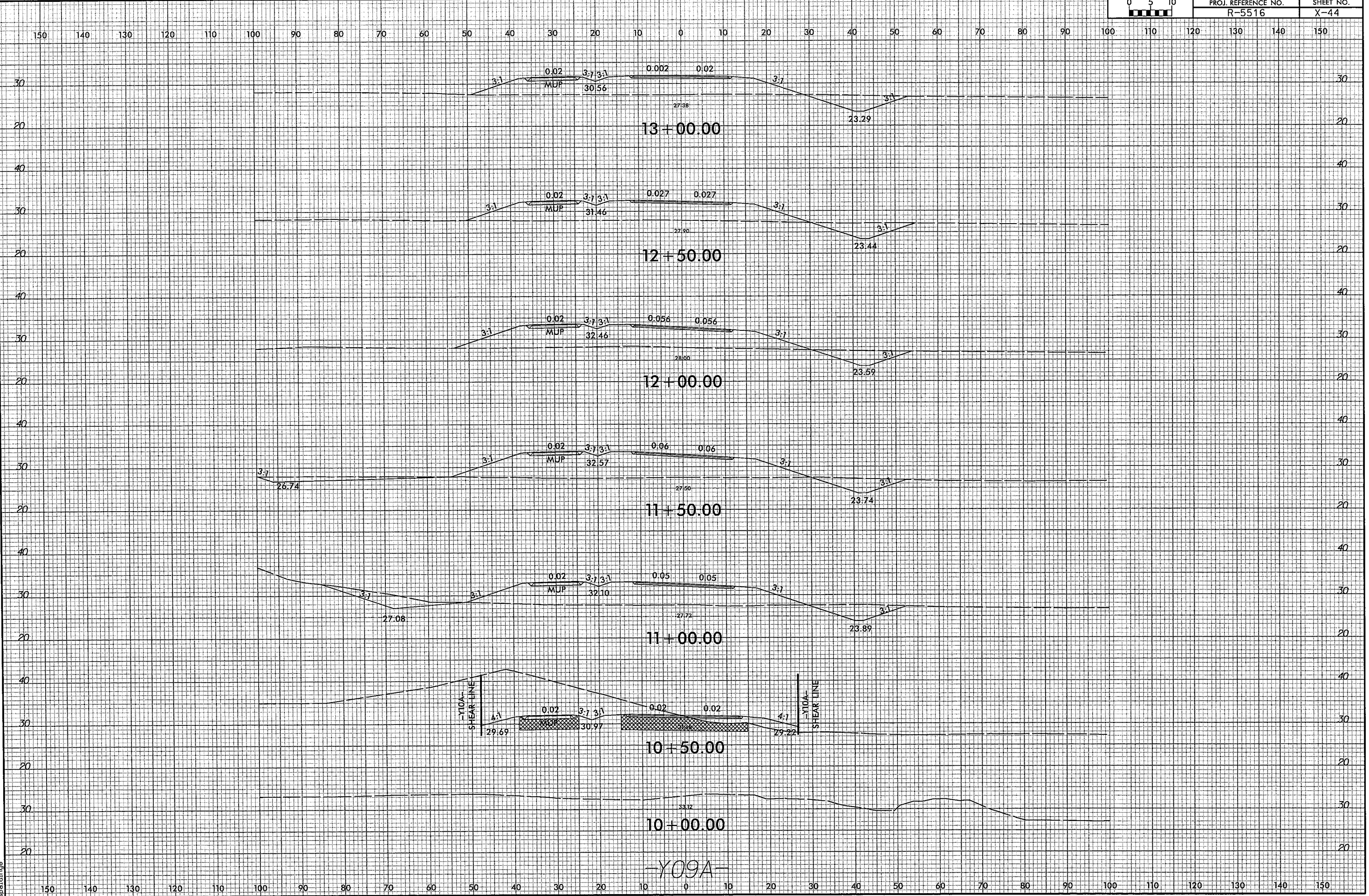

6/13/2017 8:15:20 AM \\sc\5516\_rdy.xpl\Y09A.dgn

6/23/16

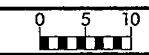

PROJ. REFERENCE NO.	SHEET NO.
R-5516	X-45

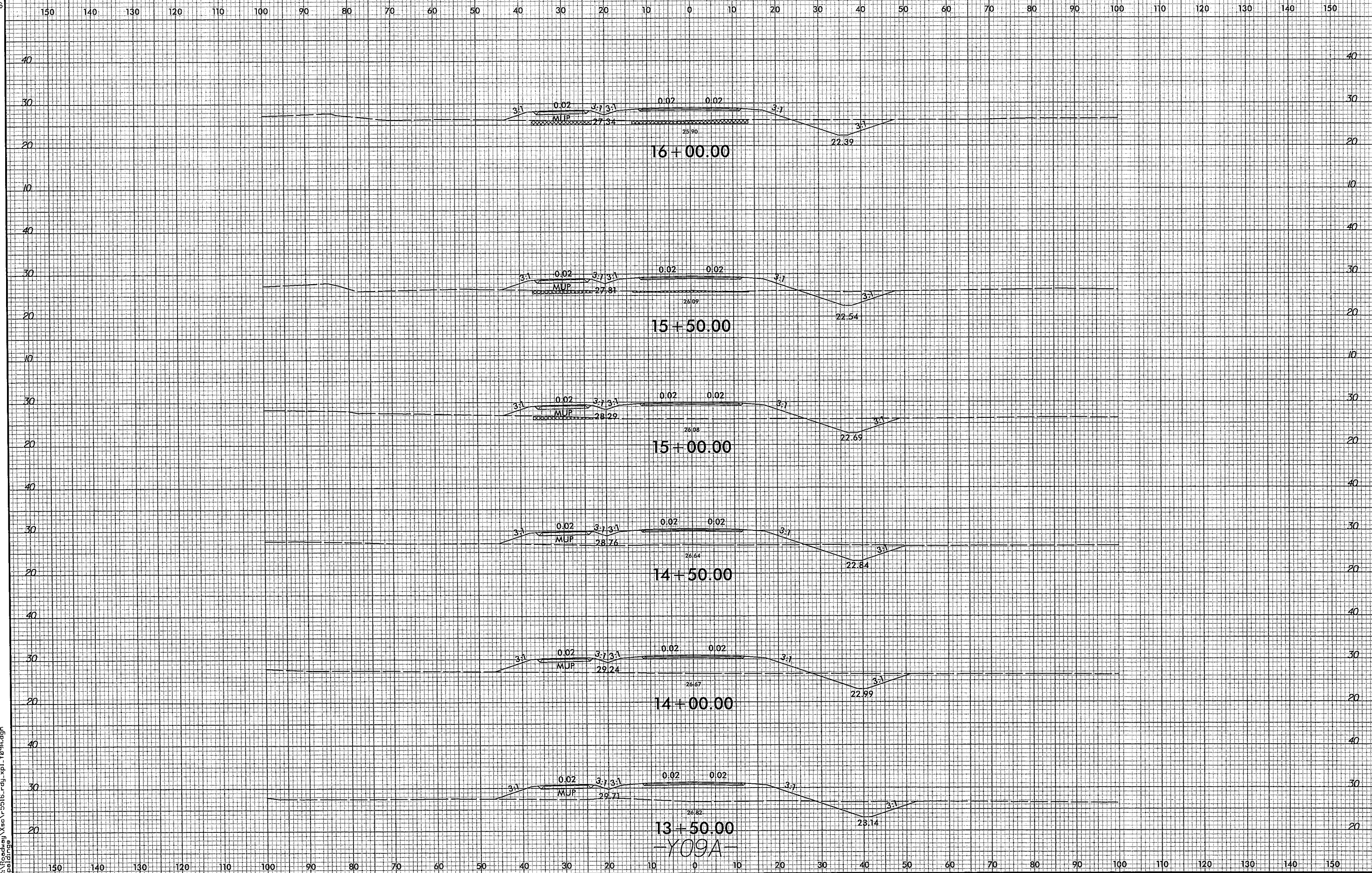

6/13/2017  
 6:\p\reg\kase\5516\_rdy\_xpl\_1\09a.dgn  
 spal  
 0:00

13+50.00  
-Y09A-

6/23/16

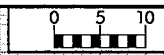

PROJ. REFERENCE NO.	SHEET NO.
R-5516	X-46

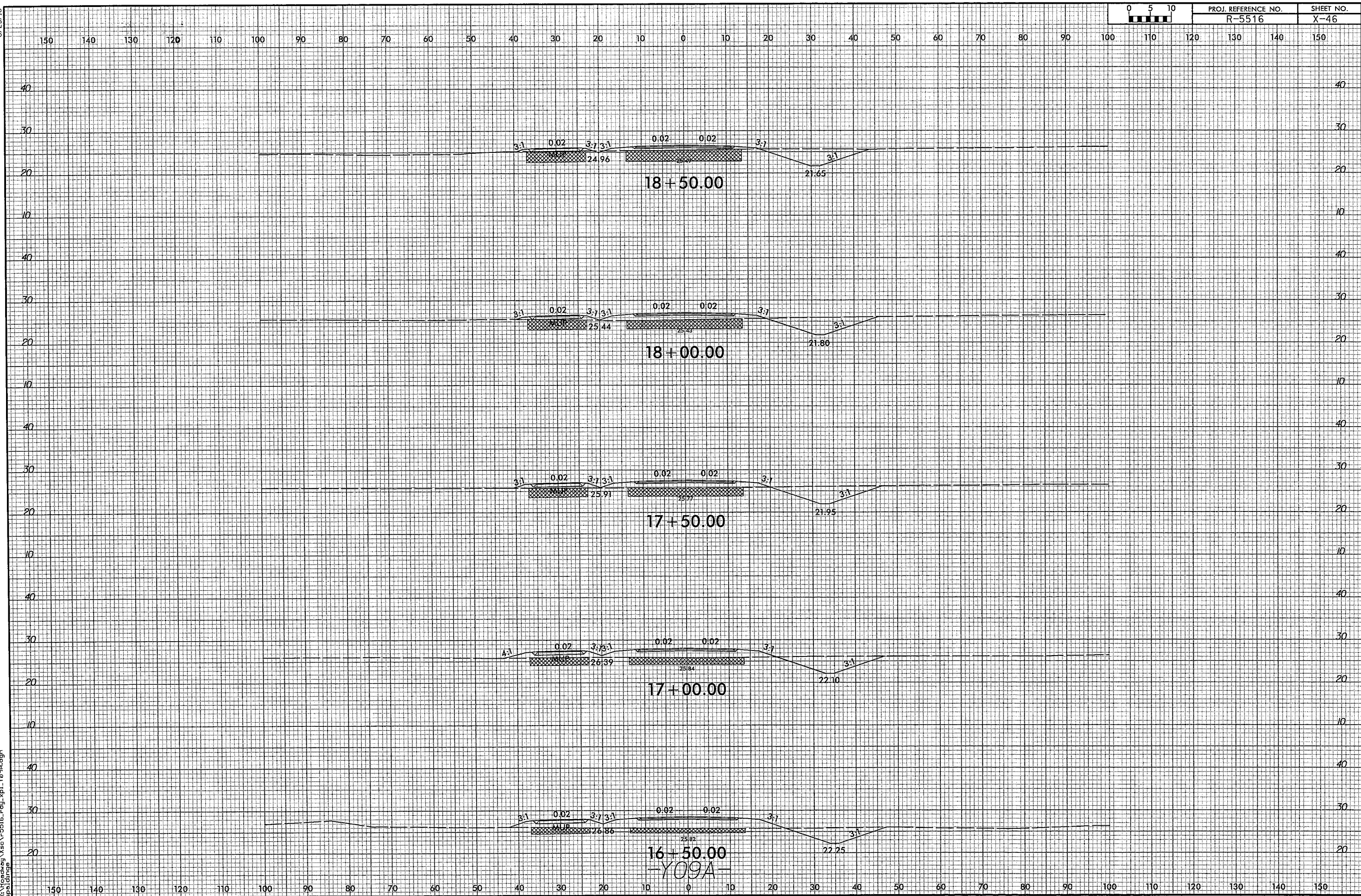

6/13/2017  
 R:\Projects\X-5516-rdy-xp1-Y09A.dgn  
 spalding

16+50.00  
-Y09A-

6/23/16



PROJ. REFERENCE NO.  
R-5516

SHEET NO.  
X-47

150 140 130 120 110 100 90 80 70 60 50 40 30 20 10 0 10 20 30 40 50 60 70 80 90 100 110 120 130 140 150

40 30 20 10 0 10 20 30 40 50 60 70 80 90 100 110 120 130 140 150

40 30 20 10 0 10 20 30 40 50 60 70 80 90 100 110 120 130 140 150

40 30 20 10 0 10 20 30 40 50 60 70 80 90 100 110 120 130 140 150

40 30 20 10 0 10 20 30 40 50 60 70 80 90 100 110 120 130 140 150

40 30 20 10 0 10 20 30 40 50 60 70 80 90 100 110 120 130 140 150

40 30 20 10 0 10 20 30 40 50 60 70 80 90 100 110 120 130 140 150

150 140 130 120 110 100 90 80 70 60 50 40 30 20 10 0 10 20 30 40 50 60 70 80 90 100 110 120 130 140 150

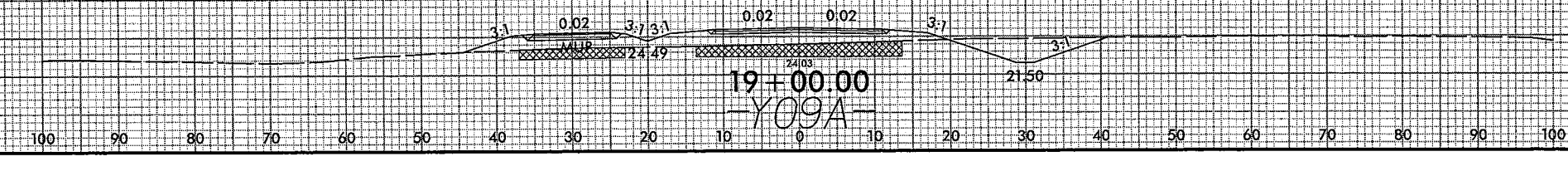
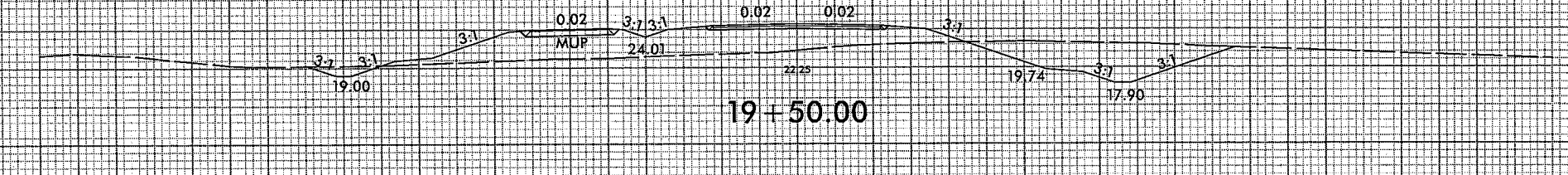
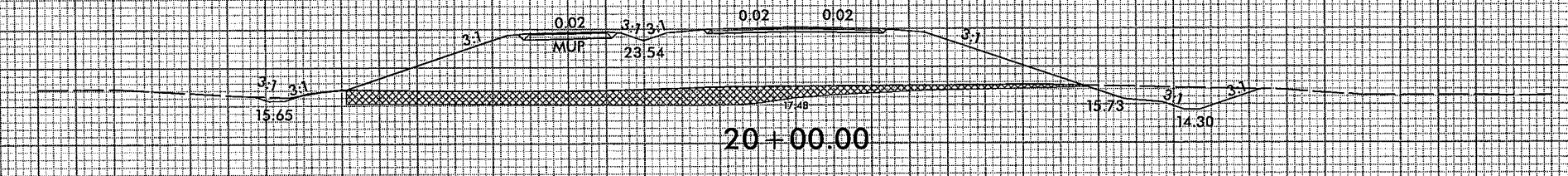
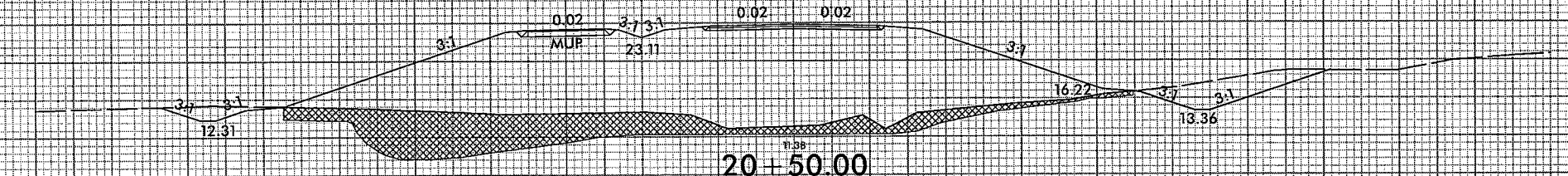
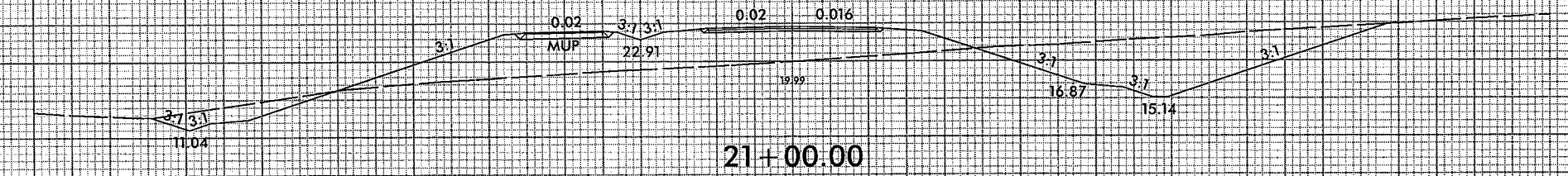

Y09A

6/13/2017 8:49:51 AM \\se\5516\_rdy\_xpl\Y09A.dgn

6/23/16



PROJ. REFERENCE NO.	SHEET NO.
R-5516	X-48

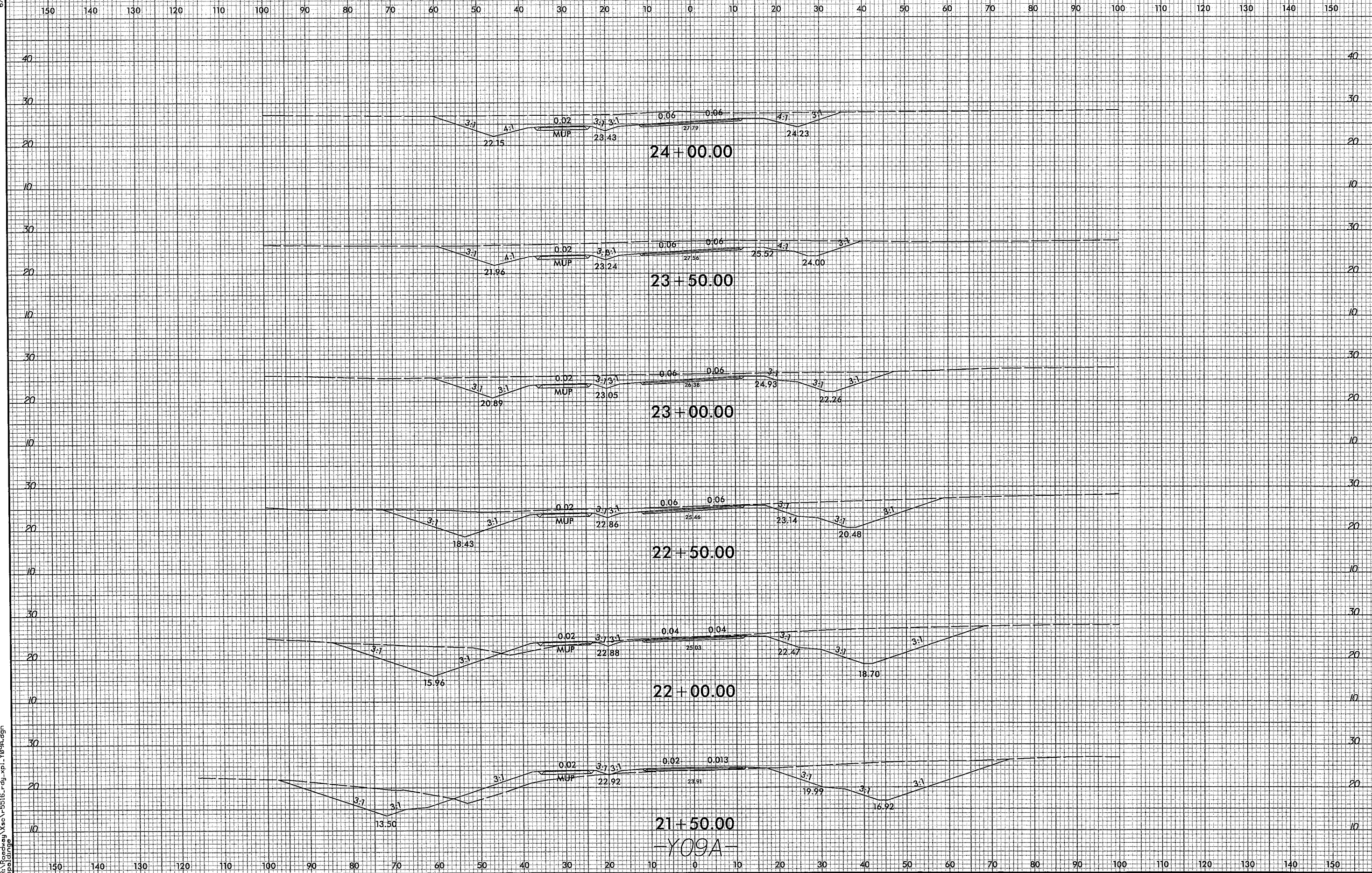

21+50.00  
-Y09A-

6/15/2017  
spal change  
6:\15\2017\spal change\ksc\5516\_rdy\_xpl\_Y09A.dgn

6/23/16

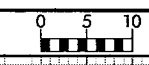

PROJ. REFERENCE NO.	SHEET NO.
R-5516	X-49

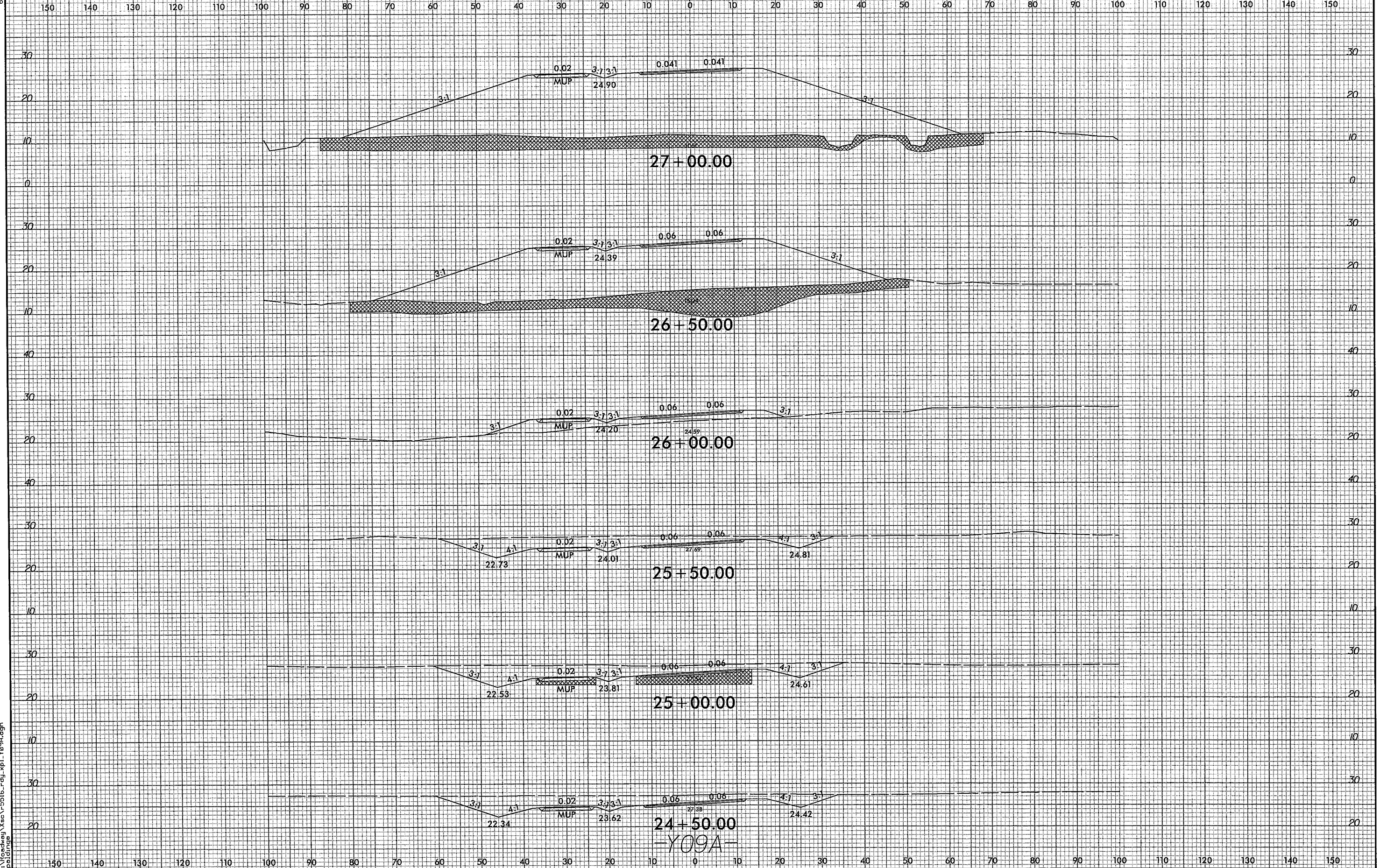

6/17/2017  
R:\Projects\5516\_rdy\_xpl\_Y09A.dgn  
spal

6/23/16

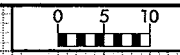

PROJ. REFERENCE NO.	SHEET NO.
R-5516	X-50

150 140 130 120 110 100 90 80 70 60 50 40 30 20 10 0 10 20 30 40 50 60 70 80 90 100 110 120 130 140 150

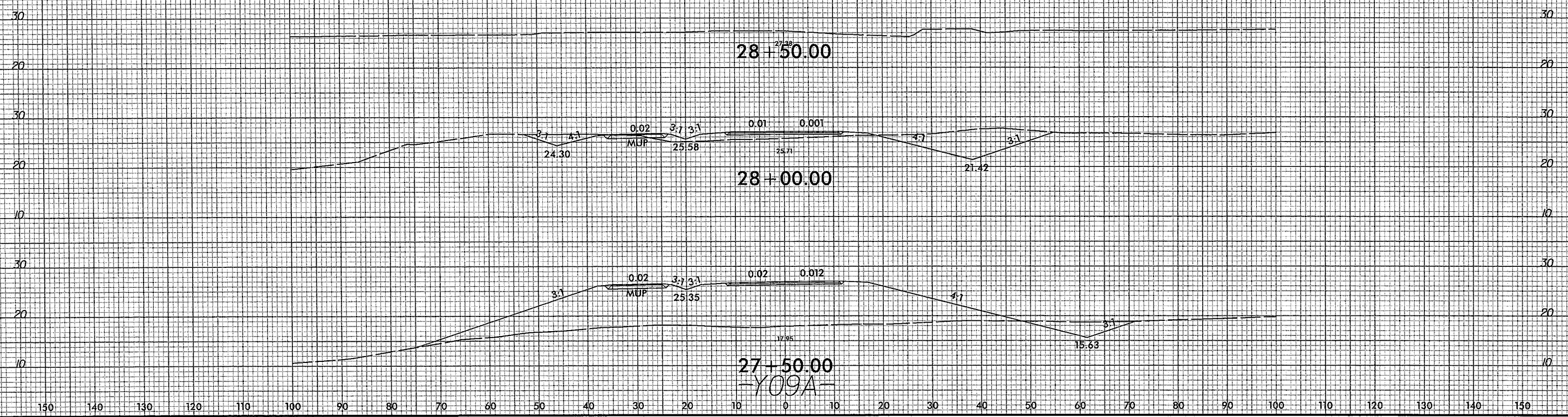

6/13/2017  
 R:\V\09\09\Xsec\5516\_r.dwg\_xpl\_Y09A.dgn  
 spolding