

2 Phase Fully Actuated US 74 - Indian Trail CLS #2

PHASING DIAGRAM

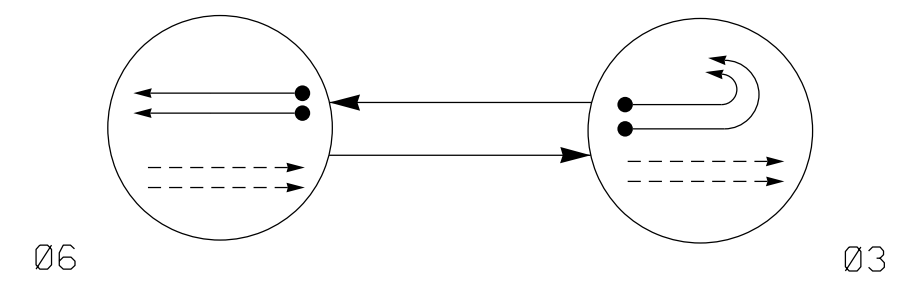

**PHASING DIAGRAM DETECTION LEGEND**  
 ←●→ DETECTED MOVEMENT  
 ←○→ UNDETECTED MOVEMENT (OVERLAP)  
 ←○→ UNSIGNALIZED MOVEMENT  
 ←○→ PEDESTRIAN MOVEMENT

TABLE OF OPERATION

SIGNAL FACE	PHASE		
	06	03	FLASH
31, 32	←●→	←○→	←○→
61, 62	G	R	Y

OASIS 2070 LOOP & DETECTOR INSTALLATION CHART

LOOP	SIZE (FT)	DISTANCE FROM STOPBAR (FT)	TURNS	NEW LOOP	DETECTOR PROGRAMMING							
					PHASE	CALLING	EXTENSION	FULL TIME DELAY	STRETCH TIME	DELAY TIME	SYSTEM LOOP	NEW CARD
3A	6X40	0	2-4-2	Y	3	Y	Y	-	-	-	-	Y
3B	6X40	0	2-4-2	Y	3	Y	Y	-	-	-	-	Y
6A/S28	6X6	420	5	Y	6	Y	Y	-	-	-	-	Y
6B/S29	6X6	420	5	Y	6	Y	Y	-	-	-	-	Y

SIGNAL FACE I.D.

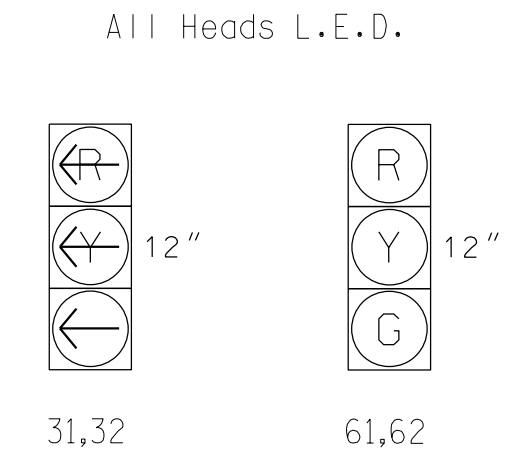

NOTES

1. Refer to "Roadway Standard Drawings NCDOT" dated January 2012 and "Standard Specifications for Roads and Structures" dated January 2012.
2. Do not program signal for late night flashing operation unless otherwise directed by the Engineer.
3. Set all detector units to presence mode.
4. Locate new cabinet so as not to obstruct sight distance of vehicles turning right on red.
5. Install combination panel with pedestal extension (see Std drawing 1700.01).
6. The cabinet should be designed to include an Auxiliary Output file for future use.
7. Maximum times shown in timing chart are for free-run operation only. Coordinated signal system timing values supersede these values.
8. Closed loop system data: Controller Asset #2197.

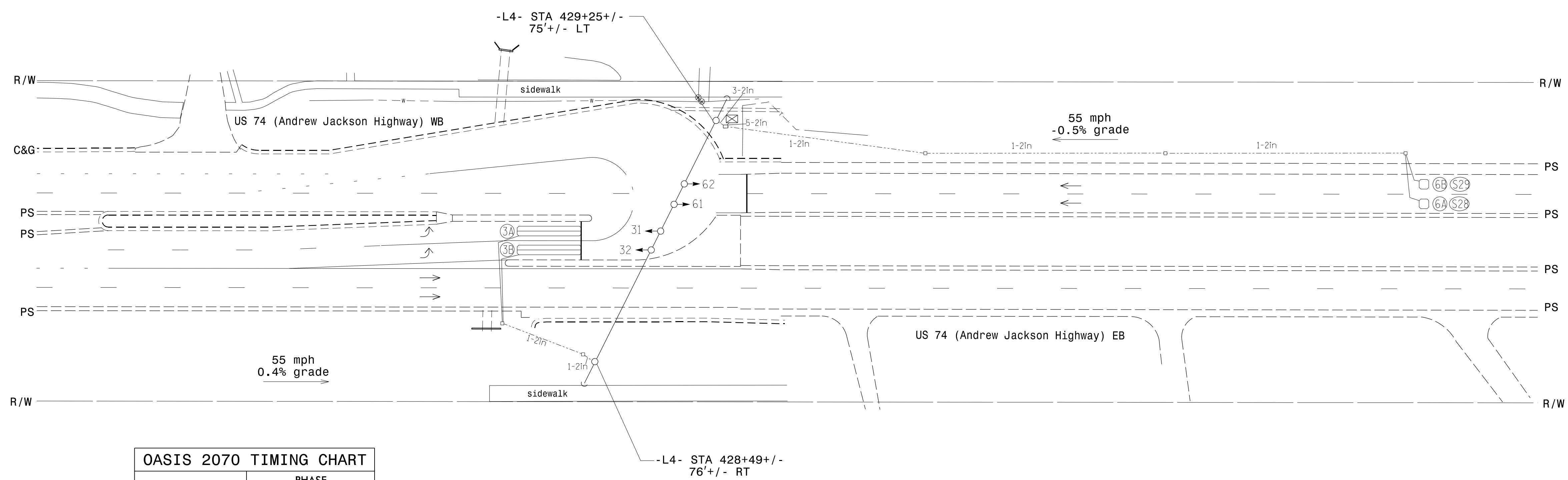

OASIS 2070 TIMING CHART

FEATURE	PHASE	
	3	6
Min Green 1 *	7	14
Extension 1 *	2.0	6.0
Max Green 1 *	30	90
Yellow Clearance	3.0	5.3
Red Clearance	3.7	1.3
Red Revert	2.0	2.0
Walk 1 *	-	-
Don't Walk 1	-	-
Seconds Per Actuation *	-	1.5
Max Variable Initial *	-	46
Time Before Reduction *	-	15
Time To Reduce *	-	30
Minimum Gap	-	3.4
Recall Mode	-	MIN RECALL
Vehicle Call Memory	-	YELLOW
Dual Entry	-	-
Simultaneous Gap	ON	ON

\* These values may be field adjusted. Do not adjust Min Green and Extension times for phase 6 lower than what is shown. Min Green for all other phases should not be lower than 4 seconds.

**LEGEND**

PROPOSED	EXISTING
	N/A
N/A	

New Installation

DOCUMENT NOT CONSIDERED FINAL UNLESS ALL SIGNATURES COMPLETED



DRMP, INC.  
 5950 FAIRVIEW ROAD, SUITE 320  
 CHARLOTTE, NC 28210  
 NC LICENSE NO. C-2213 • (704) 332-2289

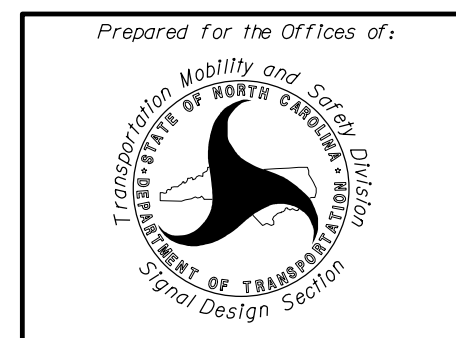

US 74 (Andrew Jackson Hwy) WB at SR 1377 (Wesley Chapel Stout Road) Eastbound U-turn  
 Division 10 Union County Indian Trail  
 PLAN DATE: June 2015 REVIEWED BY: L. Moon  
 PREPARED BY: K. Smith REVIEWED BY: J. Highland

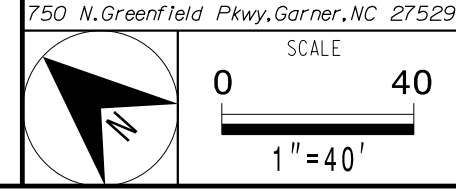

REVISIONS	INIT.	DATE

SEAL  
 LISA M. MOON  
 8/30/2016  
 DATE  
 SIG. INVENTORY NO. 10-2197

29-AUG-2016 12:36  
 N:\Projects\0615\06150001\06150001.dgn  
 L:\moon\at\car\lmoon\w7