

PROJECT REFERENCE NO. W-5520	SHEET NO. 05
RW SHEET NO.	
ROADWAY DESIGN ENGINEER SEAL JAMES E. BECK 2/2/2017	HYDRAULICS ENGINEER SEAL KANA STANSELL 2/3/2017

DOCUMENT NOT CONSIDERED FINAL UNLESS ALL SIGNATURES COMPLETED

PLANS PREPARED BY:

DRMP ENGINEERS - PLANNERS - SCIENTISTS
WSP ENGINEERS - PLANNERS - SCIENTISTS

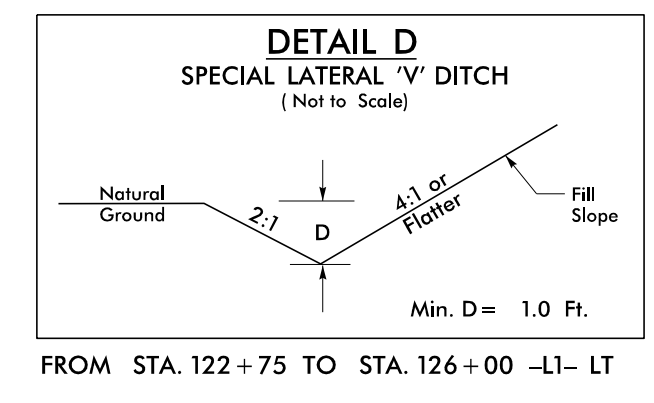
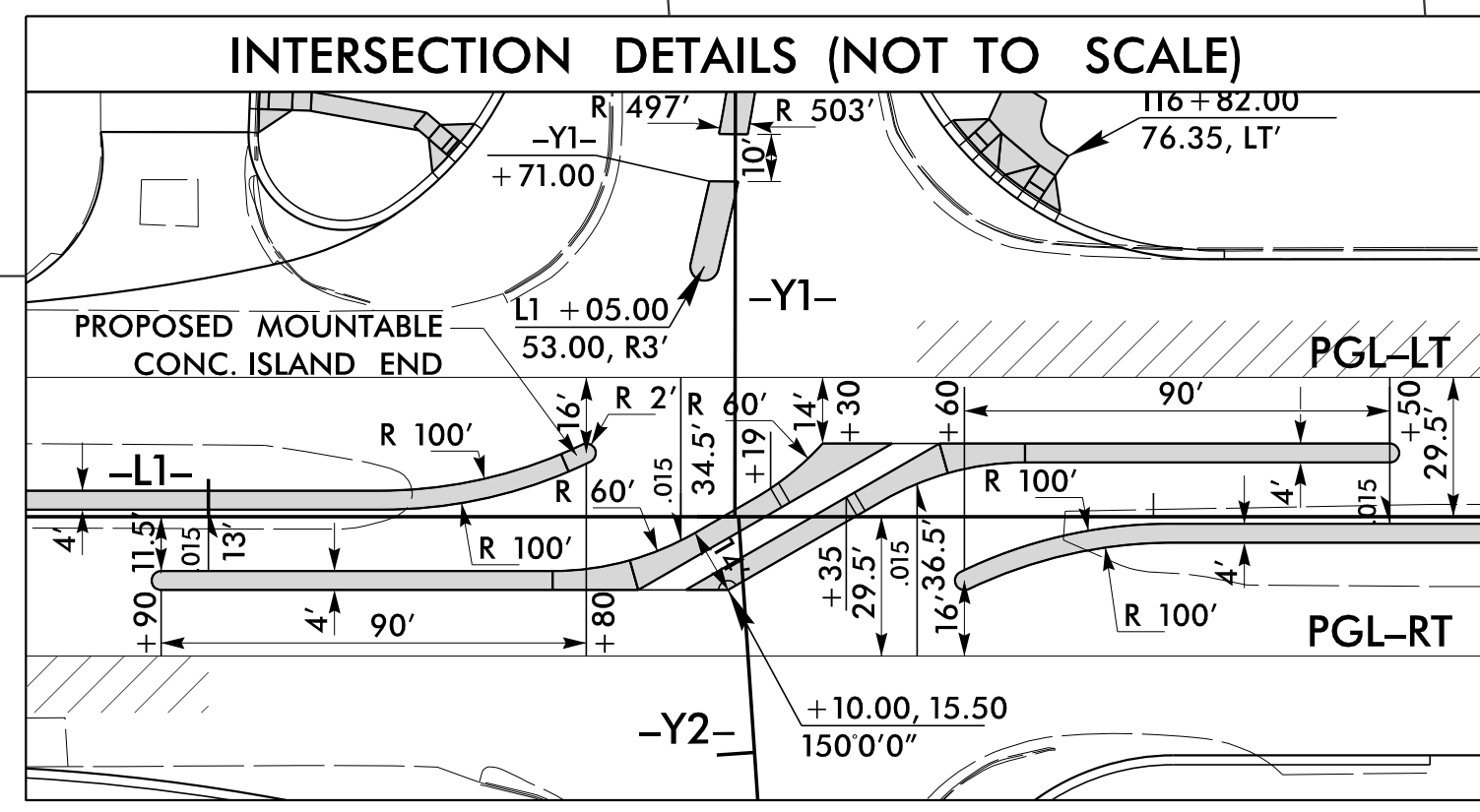
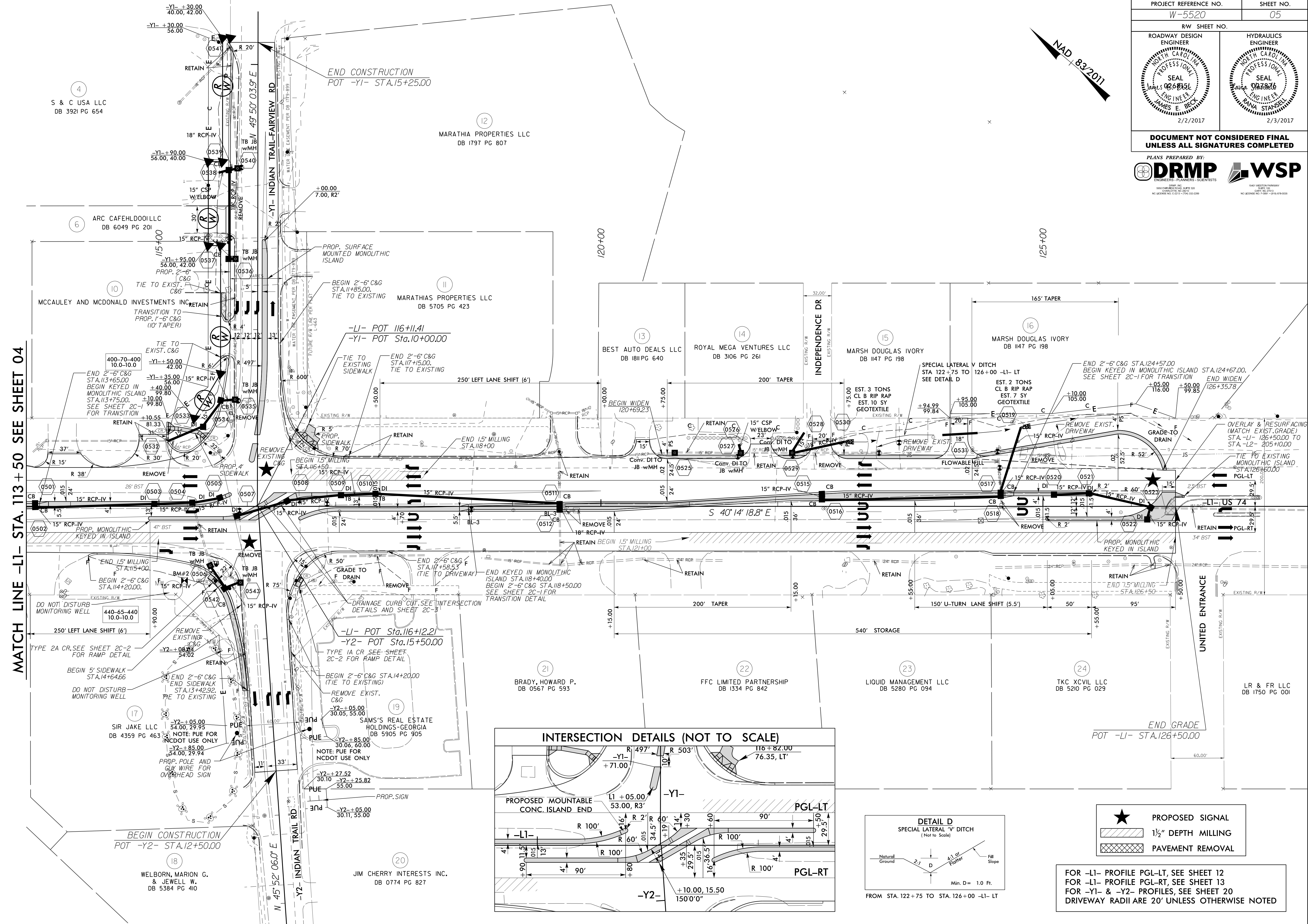

- ★ PROPOSED SIGNAL
- ▨ 1 1/2" DEPTH MILLING
- ▩ PAVEMENT REMOVAL

FOR -L1- PROFILE PGL-LT, SEE SHEET 12
 FOR -L1- PROFILE PGL-RT, SEE SHEET 13
 FOR -Y1- & -Y2- PROFILES, SEE SHEET 20
 DRIVEWAY RADII ARE 20' UNLESS OTHERWISE NOTED

REVISIONS

MATCH LINE -L1- STA. 113 + 50 SEE SHEET 04

S & C USA LLC
DB 3921 PG 654

ARC CAFEHLD00 LLC
DB 6049 PG 201

MCCAULEY AND MCDONALD INVESTMENTS INC.
TRANSITION TO PROP. 1'-6" C&G (10' TAPER)

400-70-400
10.0-10.0
END 2'-6" C&G STA. 113+65.00
BEGIN KEYED IN MONOLITHIC ISLAND STA. 113+75.00
TIE TO EXIST. C&G

15" RCP-IV
26' BST
DO NOT DISTURB MONITORING WELL

440-65-440
10.0-10.0
END 15" MILLING STA. 115+00.00
BEGIN 2'-6" C&G STA. 114+20.00

BEGIN 5' SIDEWALK STA. 114+64.66
DO NOT DISTURB MONITORING WELL

SIR JAKE LLC
DB 4359 PG 463

BEGIN CONSTRUCTION POT -Y2- STA. 12+50.00

WELBORN, MARION G. & JEWELL W.
DB 5384 PG 410

END CONSTRUCTION POT -Y1- STA. 15+25.00

MARATHIA PROPERTIES LLC
DB 1797 PG 807

MARATHIAS PROPERTIES LLC
DB 5705 PG 423

-L1- POT 116+11.41
-Y1- POT Sta. 10+00.00

END 15" MILLING STA. 116+50.00
BEGIN 15" MILLING STA. 116+50.00

-L1- POT Sta. 116+12.21
-Y2- POT Sta. 15+50.00

BEGIN 2'-6" C&G STA. 114+20.00 (TIE TO EXISTING)

SAMS'S REAL ESTATE HOLDINGS-GEORGIA
DB 5905 PG 905

NOTE: PUE FOR NCDOT USE ONLY

JIM CHERRY INTERESTS INC.
DB 0774 PG 827

MARATHIAS PROPERTIES LLC
DB 5705 PG 423

BEST AUTO DEALS LLC
DB 1811 PG 640

ROYAL MEGA VENTURES LLC
DB 3106 PG 261

MARSH DOUGLAS IVORY
DB 1147 PG 198

MARSH DOUGLAS IVORY
DB 1147 PG 198

MARSH DOUGLAS IVORY
DB 1147 PG 198

BRADY, HOWARD P.
DB 0567 PG 593

FFC LIMITED PARTNERSHIP
DB 1334 PG 842

LIQUID MANAGEMENT LLC
DB 5280 PG 094

TKC XCIV LLC
DB 5210 PG 029

LR & FR LLC
DB 1750 PG 001

END GRADE POT -L1- STA. 126+50.00

1/3/2017 15:09:36 PW W5520_05_Rdw_psh_05.dgn