

DETOUR ROUTE: ●—●—●

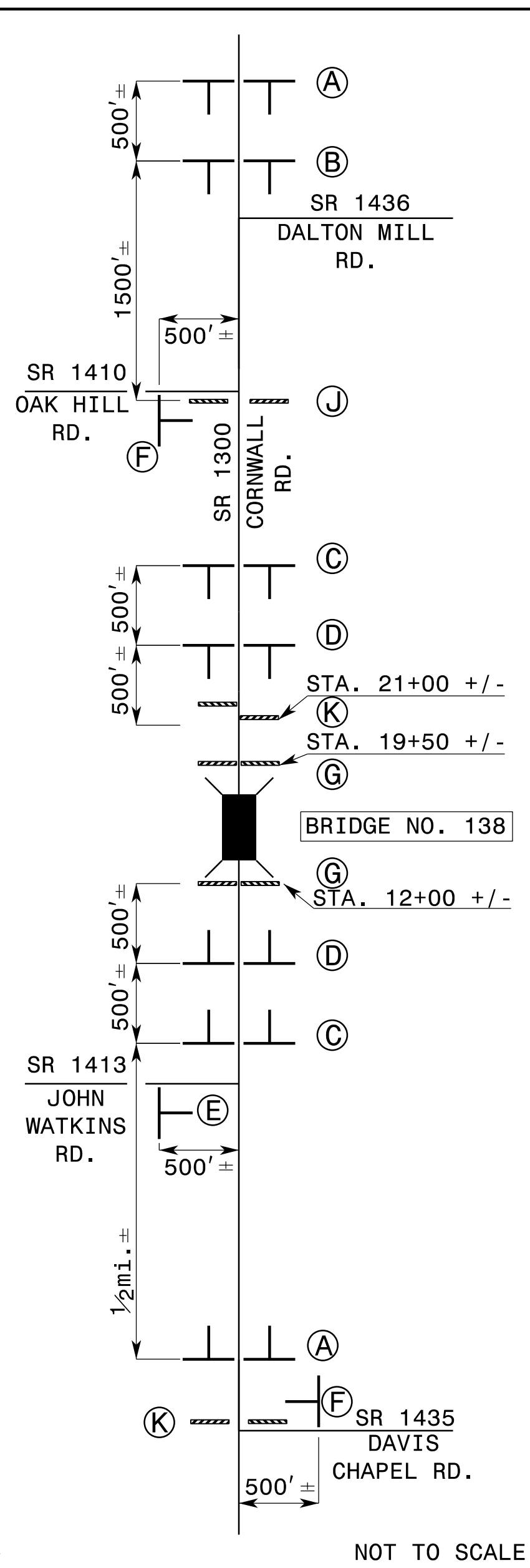

INSET "A"
REFER TO ROADWAY STANDARD DRAWING 1101.03, SHEET 1 OF 9 FOR APPLICABLE NOTES.

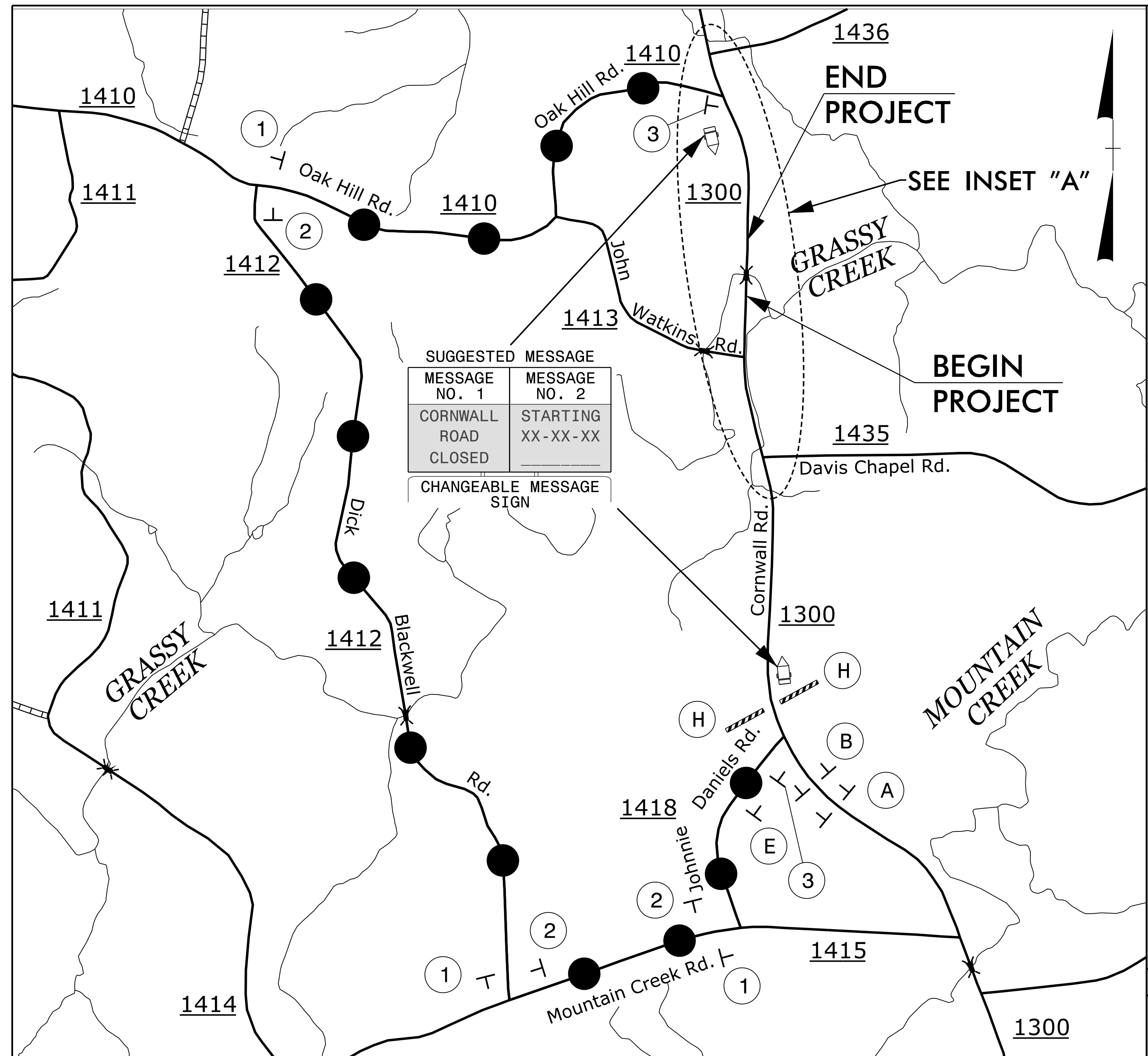
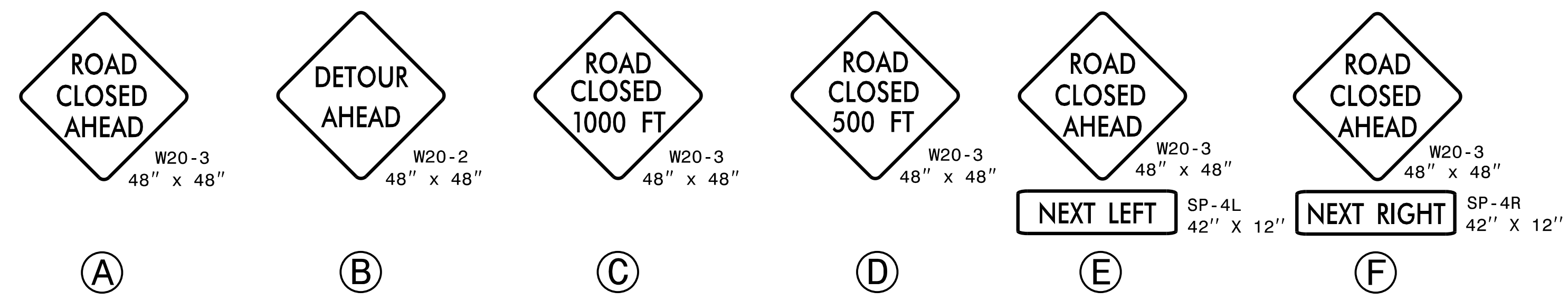
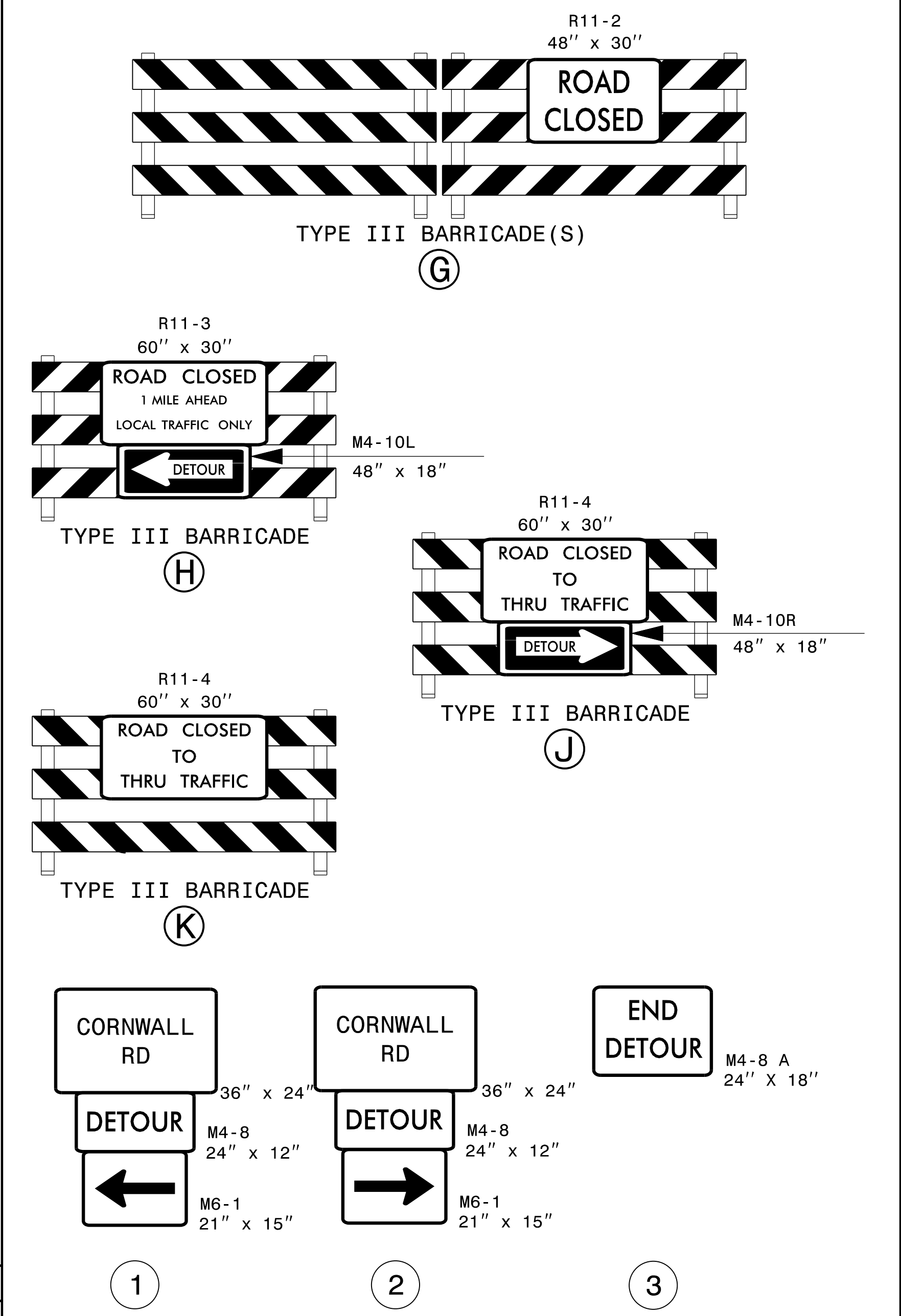

1/17/2017 11:51:16 AM TC_TMP03.dgn USER:keys

STEWART
Firm License No. C-1051
421 Fayetteville St., Suite 400
Raleigh, NC 27601
T 919.380.8750
www.stewartinc.com

DOCUMENT NOT CONSIDERED FINAL
UNLESS ALL SIGNATURES COMPLETED
APPROVED: Andrew P. Young DATE: 1/17/2017
SEAL
PROFESSIONAL ENGINEER
ANDREW P. YOUNG
034407

DIVISION OF HIGHWAYS
STATE OF NORTH CAROLINA
DEPARTMENT OF TRANSPORTATION
WORK ZONE TRAFFIC CONTROL

**OFF-SITE
DETOUR ROUTE &
ROAD CLOSURE**