

09_08/199

T.I.P PROJECT: B-5166

CONTRACT: C203902

STATE OF NORTH CAROLINA
DIVISION OF HIGHWAYS

GRANVILLE COUNTY

**LOCATION: BRIDGE NO. 138 OVER GRASSY CREEK
ON SR 1300 (CORNWALL RD.)**
TYPE OF WORK: GRADING, DRAINAGE, PAVING, AND STRUCTURE

STATE	STATE PROJECT REFERENCE NO.	SHEET NO.	TOTAL SHEETS
N.C.	B-5166	1	
STATE PROJ. NO.	F.A. PROJ. NO.	DESCRIPTION	
42342.1.1	BRSTP-1300(9)	PE	
42342.2.1		ROW & UTILITY	
42342.3.1		CONSTRUCTION	

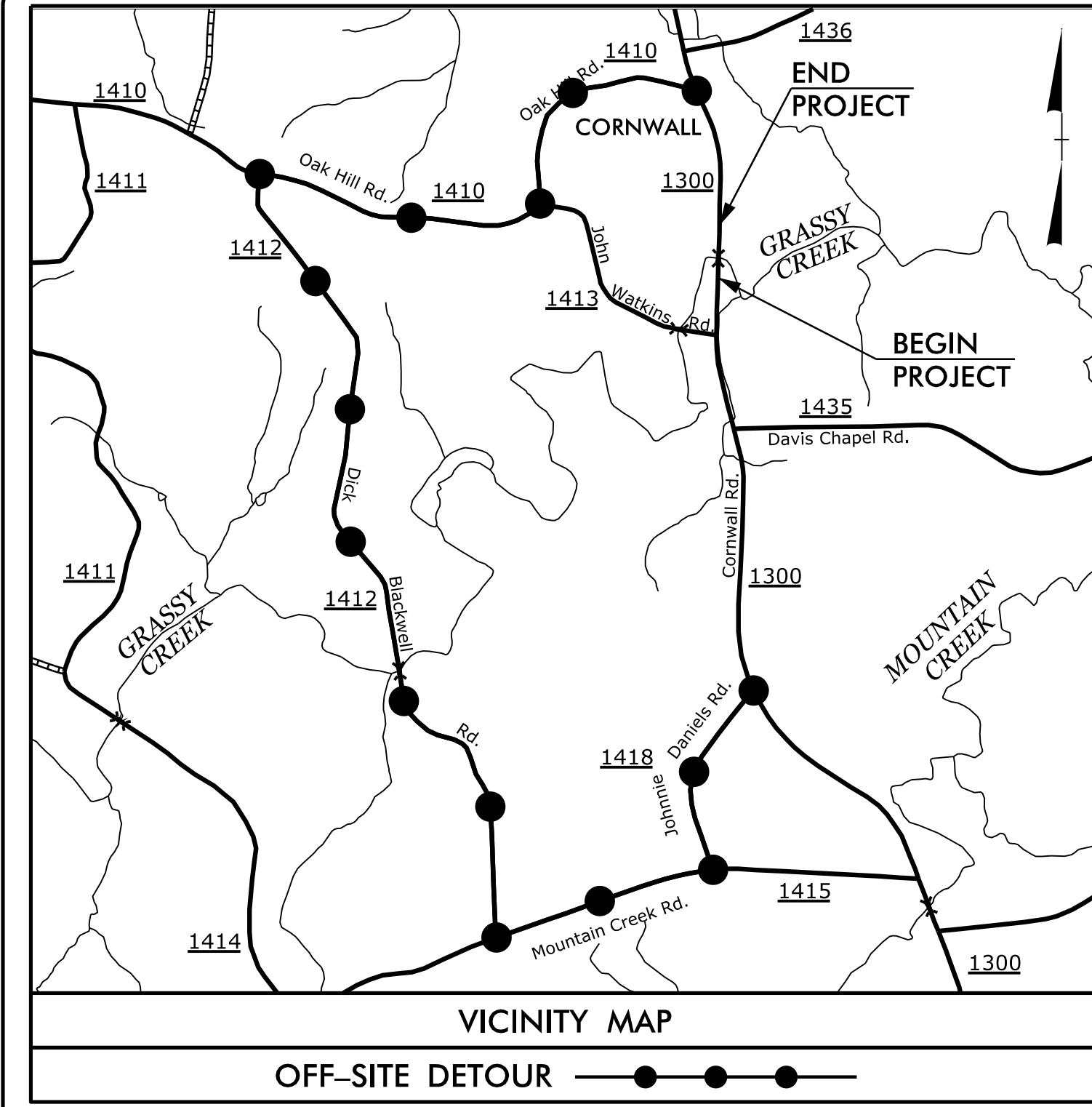
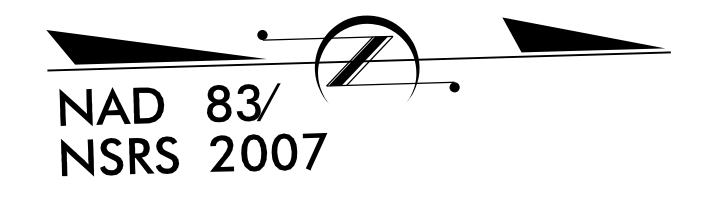

See Sheet 1A For Index of Sheets
See Sheet 1B For Conventional Symbols

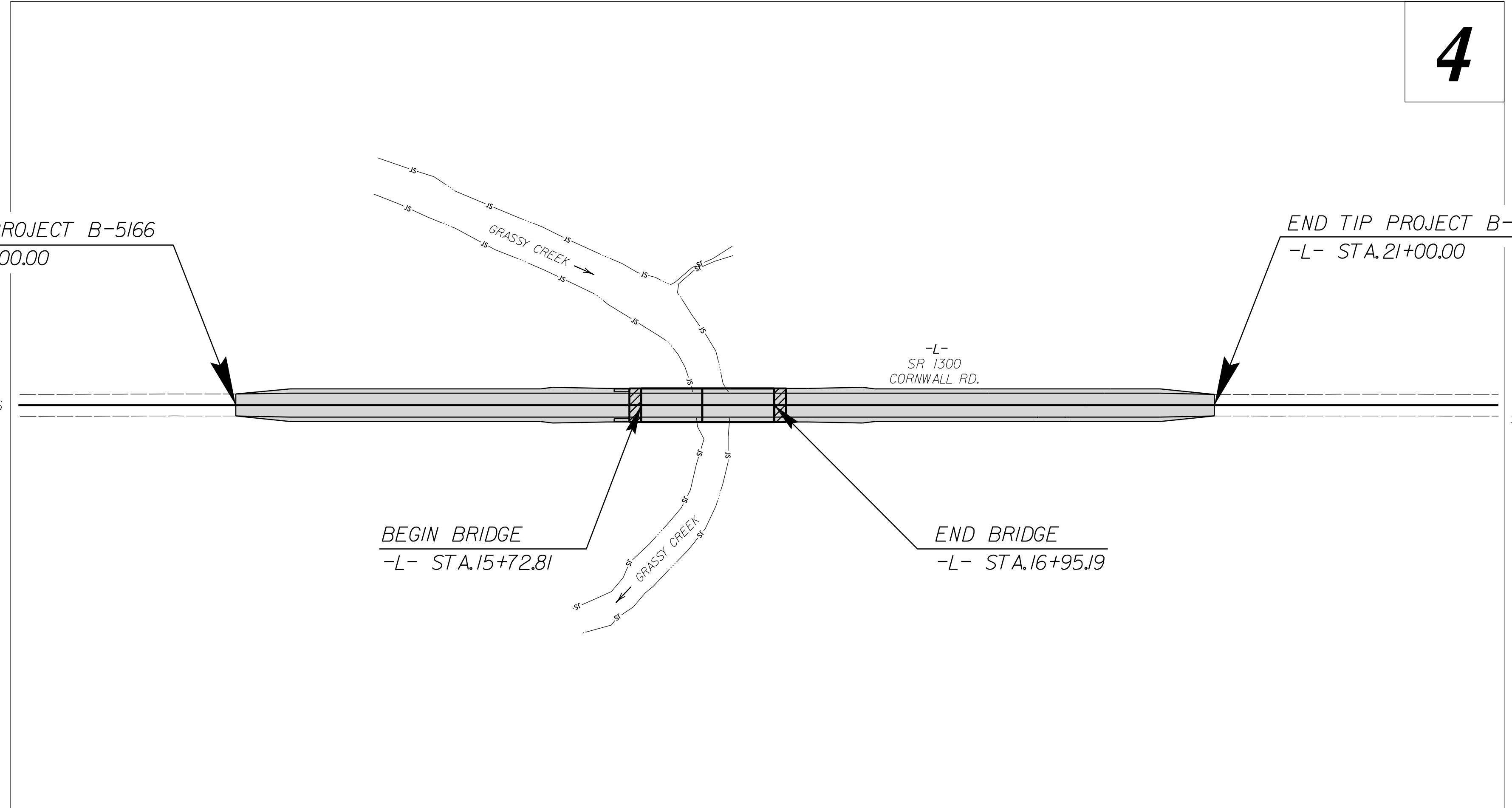

4

**DOCUMENT NOT CONSIDERED FINAL
UNLESS ALL SIGNATURES COMPLETED**

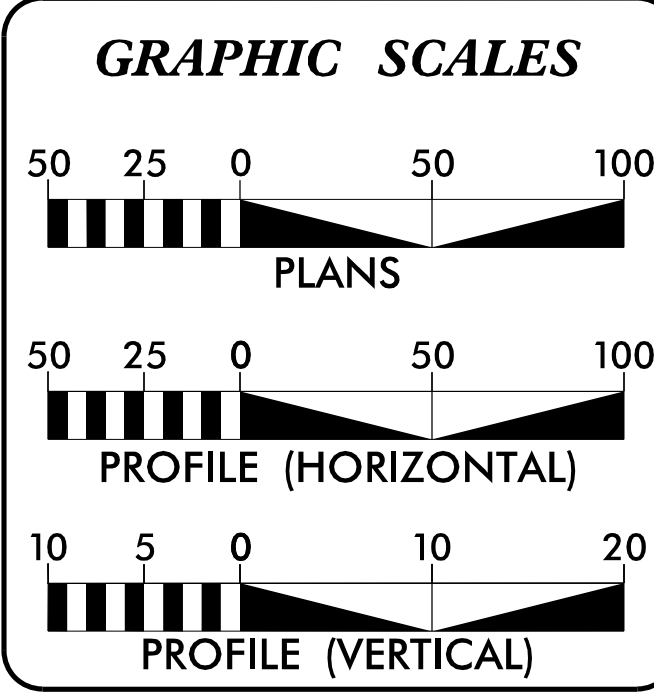

DESIGN DATA
 2017 ADT = 1,146 VPD
 2037 ADT = 1,762 VPD
 DHV = 12%
 D = 65%
 T = 8% *
 V = 60 MPH
 * (TTST 4% + DUAL 4%)
 FUNC. CLASS. = RURAL MINOR COLLECTOR
 SUBREGIONAL TIER

PROJECT LENGTH

LENGTH ROADWAY TIP PROJECT B-5166	=	0.147 mi.
LENGTH STRUCTURES TIP PROJECT B-5166	=	0.023 mi.
TOTAL LENGTH TIP PROJECT B-5166	=	0.170 mi.

Prepared in the Offices of:

STEWART
421 FAYETTEVILLE ST., STE 400
RALEIGH, NC 27601
T 919.380.8750

ECOLOGICAL ENGINEERING
NC FIRM LICENSE No. F-1148
1151 SE Cary Parkway, Suite 101
Cary, NC 27518
(919) 557-4029

2012 STANDARD SPECIFICATIONS

RIGHT OF WAY DATE:
APRIL 15, 2016

LETTING DATE:
APRIL 18, 2017

ANDY YOUNG, PE
PROJECT ENGINEER

MICHAEL BURNS, EI
PROJECT DESIGN ENGINEER

GARY R. LOVERING, P.E.
NCDOT CONTACT

HYDRAULICS ENGINEER

DocuSigned by:
Frank F. Fleming
1/17/2017
P.E.

ROADWAY DESIGN ENGINEER

DocuSigned by:
Andrew P. Young
1/17/2017
P.E.

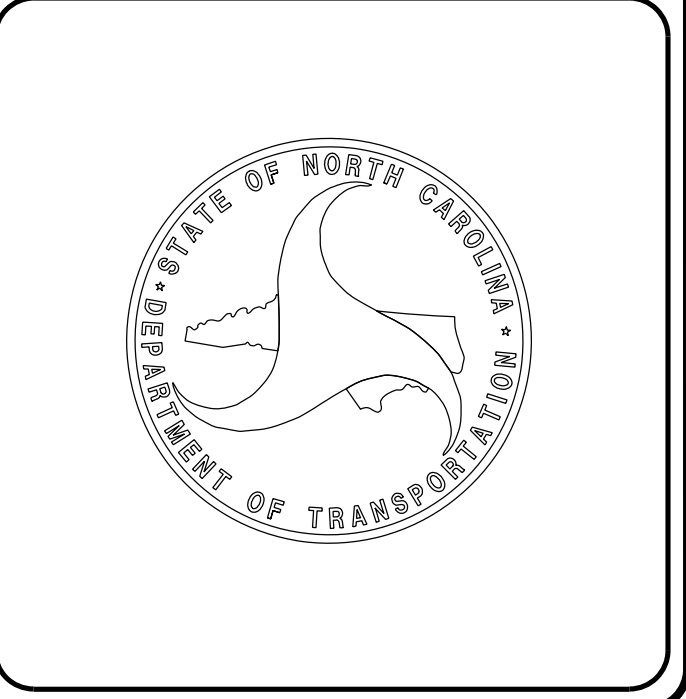

I:\7\2017
Rogdway\Proj\B5166_rdy_tsh.dgn
USER:Rkeys