

PHASING DIAGRAM

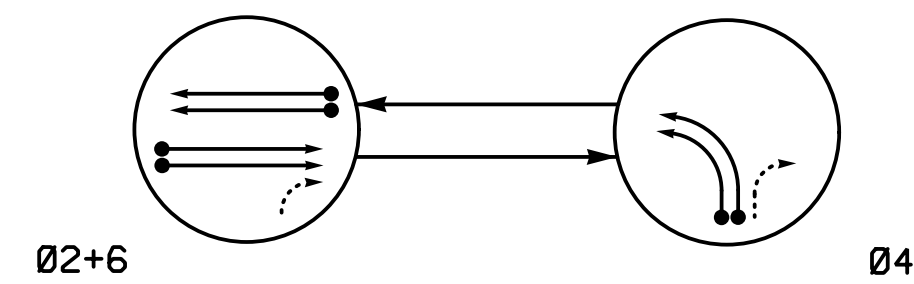

PHASING DIAGRAM DETECTION LEGEND

- ←● DETECTED MOVEMENT
- ← UNDETECTED MOVEMENT (OVERLAP)
- ←..... UNSIGNALIZED MOVEMENT
- ←--- PEDESTRIAN MOVEMENT

SIGNAL FACE	PHASE		
	02+6	04	F
21,22	G	R	Y
41,42	R	Y	R
61,62	G	R	Y

SIGNAL FACE I.D.

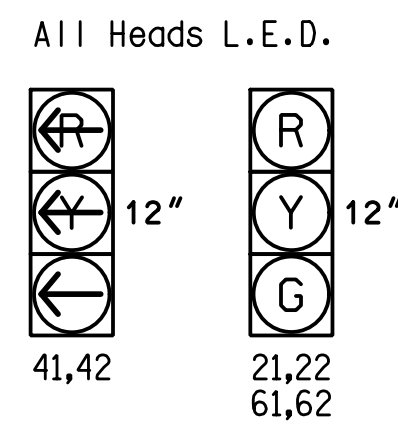

OASIS 2070 LOOP & DETECTOR INSTALLATION CHART											
INDUCTIVE LOOPS						DETECTOR PROGRAMMING					
LOOP	SIZE (FT)	DISTANCE FROM STOPBAR (FT)	TURNS	NEW LOOP	PHASE	CALLING	EXTENSION	FULL TIME DELAY	STRETCH TIME	DELAY TIME	SYSTEM LOOP
2A/S1	6X6	300	6	-	2	Y	Y	-	-	-	Y
2B/S2	6X6	300	6	-	2	Y	Y	-	-	-	Y
4A	6X40	0	2-4-2	Y	4	Y	Y	-	-	-	-
4B	6X40	0	2-4-2	Y	4	Y	Y	-	-	-	-
6A/S3	6X6	300	4	-	6	Y	Y	-	-	-	Y
6B/S4	6X6	300	4	-	6	Y	Y	-	-	-	Y

2 Phase Fully Actuated (Gastonia City Signal System)

NOTES

- Refer to "Roadway Standard Drawings NCDOT" dated January 2012 and "Standard Specifications for Roads and Structures" dated January 2012.
- Do not program signal for late night flashing operation unless otherwise directed by the Engineer.
- Set all detector units to presence mode.
- Maximum times shown in timing chart are for free-run operation only. Coordinated signal system timing values supersede these values.
- Signal System data: Controller Asset #0162.

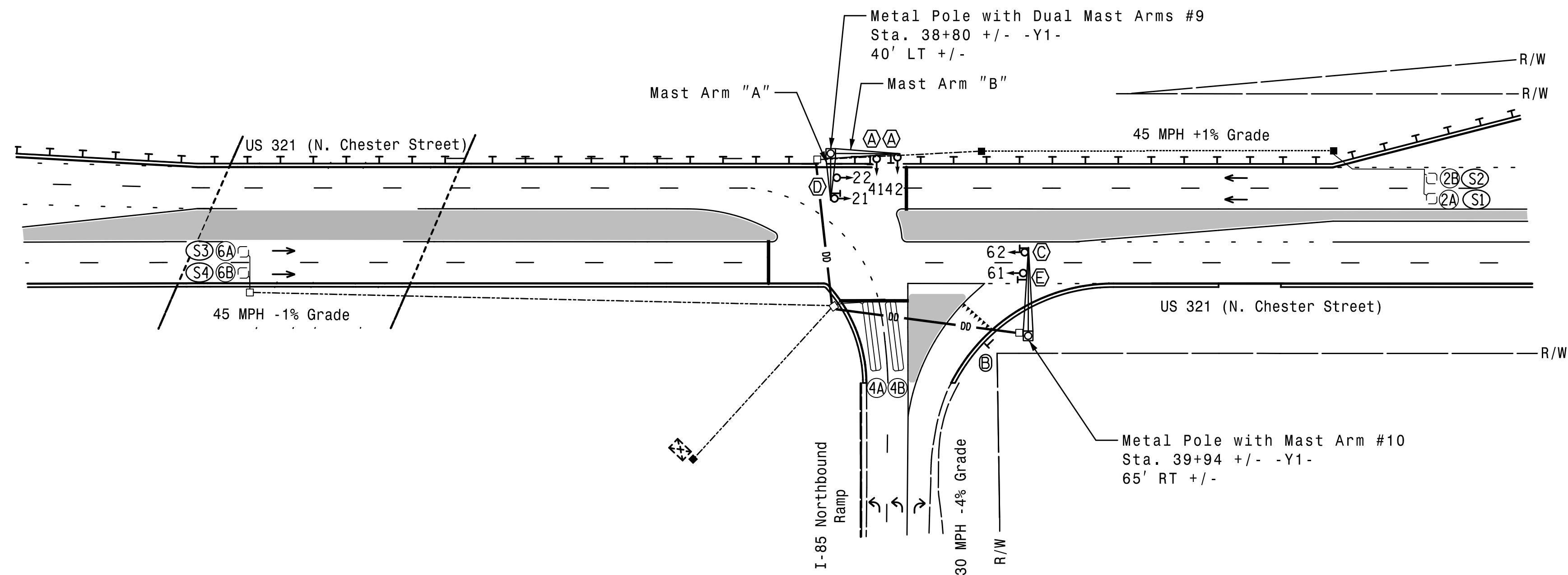

OASIS 2070 TIMING CHART

FEATURE	PHASE		
	2	4	6
Min Green 1 *	12	7	12
Extension 1 *	6.0	2.0	6.0
Max Green 1 *	90	25	90
Yellow Clearance	4.4	3.0	4.6
Red Clearance	1.2	3.3	1.3
Red Revert	2.0	2.0	2.0
Walk 1 *	-	-	-
Don't Walk 1	-	-	-
Seconds Per Actuation *	1.5	-	1.5
Max Variable Initial *	34	-	34
Time Before Reduction *	15	-	15
Time To Reduce *	30	-	30
Minimum Gap	3.0	-	3.0
Recall Mode	MIN RECALL	-	MIN RECALL
Vehicle Call Memory	YELLOW	-	YELLOW
Dual Entry	-	-	-
Simultaneous Gap	ON	ON	ON

* These values may be field adjusted. Do not adjust Min Green and Extension times for phases 2 and 6 lower than what is shown. Min Green for all other phases should not be lower than 4 seconds.

LEGEND

- | PROPOSED | EXISTING |
|--|--|
| ○ → Traffic Signal Head | ● → Traffic Signal Head |
| ○ → Modified Signal Head | N/A |
| ⊥ Sign | ⊥ Sign |
| ⊥ Pedestrian Signal Head With Push Button & Sign | ⊥ Pedestrian Signal Head With Push Button & Sign |
| ⊥ Signal Pole with Guy | ⊥ Signal Pole with Guy |
| ⊥ Signal Pole with Sidewalk Guy | ⊥ Signal Pole with Sidewalk Guy |
| ⊥ Inductive Loop Detector | ⊥ Inductive Loop Detector |
| ⊥ Controller & Cabinet | ⊥ Controller & Cabinet |
| ⊥ Junction Box | ⊥ Junction Box |
| ⊥ 2-in Underground Conduit | ⊥ 2-in Underground Conduit |
| N/A Right of Way | ⊥ Right of Way |
| → Directional Arrow | → Directional Arrow |
| ⊥ Metal Pole with Mastarm | ⊥ Metal Pole with Mastarm |
| N/A Guardrail | ⊥ Guardrail |
| ⊥ Directional Drill | N/A |
| ⊥ Left Arrow "ONLY" Sign (R3-5L) | ⊥ Left Arrow "ONLY" Sign (R3-5L) |
| ⊥ "YIELD" Sign (R1-2) | ⊥ "YIELD" Sign (R1-2) |
| ⊥ No U-Turn Sign (R3-4) | ⊥ No U-Turn Sign (R3-4) |
| ⊥ No U-Turn/No Left Turn Sign (R3-18) | ⊥ No U-Turn/No Left Turn Sign (R3-18) |
| ⊥ No Right Turn Sign (R3-1) | ⊥ No Right Turn Sign (R3-1) |

Signal Upgrade - Final Design

DOCUMENT NOT CONSIDERED FINAL UNLESS ALL SIGNATURES COMPLETED

	US 321 (N. Chester Street) at I-85 Northbound Ramp		
	Division 12 Gaston Co. Gastonia PLAN DATE: September 2016 REVIEWED BY: T.R. Terrell PREPARED BY: J.A. Wagner REVIEWED BY: N.R. Simmons	SCALE: 1"=50' REVISIONS: _____ INITIALS: _____ DATE: _____	

HNTB HNTB NORTH CAROLINA, P.C.
343 E. Six Forks Road, Suite 200
Raleigh, North Carolina 27609
NC License No: C-1554
(919) 546-8997

DocuSigned by: *W. Tasha R. Simmons* 12/16/2016
SIGNATURE DATE
SIG. INVENTORY NO. 12-0162