

Project: R-3100A

STATE OF NORTH CAROLINA
DIVISION OF HIGHWAYS

Project No.	Sheet No.
R-3100A	Sig. 1.0

CATAWBA COUNTY

LOCATION: NC 16 FROM NORTH OF SR 1814 (CALDWELL ROAD) TO SR 1895 (TOWER ROAD)

TYPE OF WORK: TRAFFIC SIGNAL

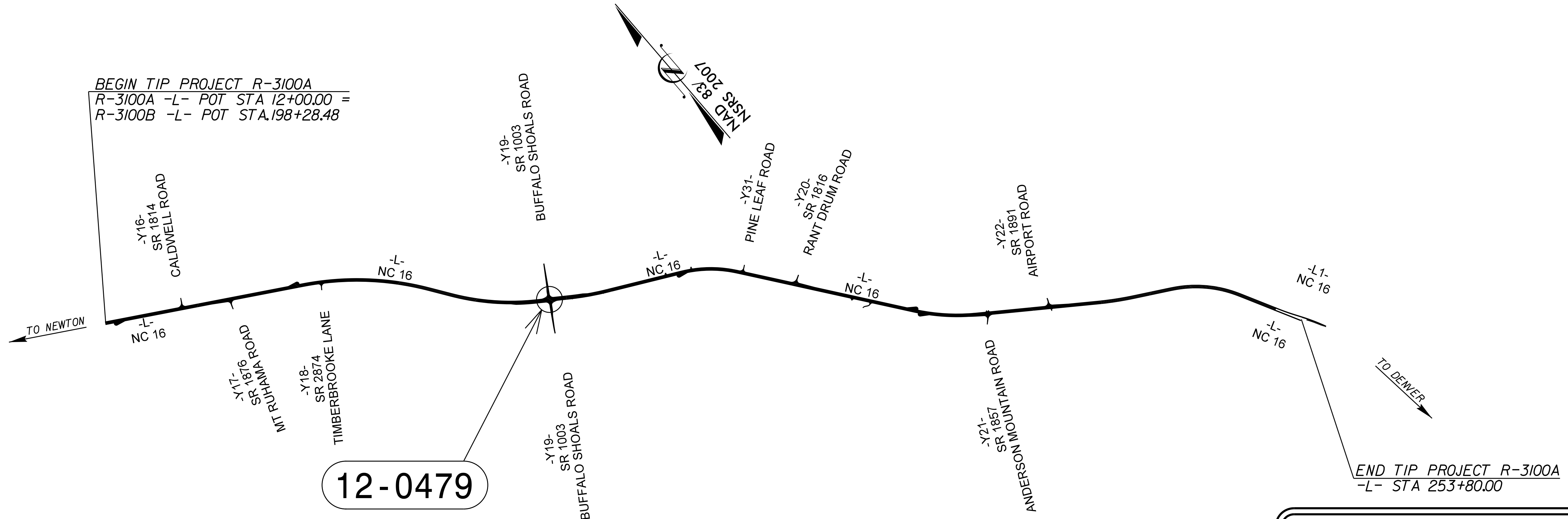

Refer to "Roadway Standard Drawings NCDOT" dated January 2012 and "Standard Specifications for Roads and Structures" dated January 2012.

Sheet #	Reference #	Index of Plans	Location/Description
Sig. 1.0	R-3100A	Title Sheet	
Sig. 2.0	12-0479 T1	NC 16 at SR 1003 (Buffalo Shoals Road) Temporary-1	
Sig. 3.0	12-0479 T2	NC 16 at SR 1003 (Buffalo Shoals Road) Temporary-2	
Sig. 4.0	12-0479 T3	NC 16 at SR 1003 (Buffalo Shoals Road) Temporary-3	
Sig. 5.0	12-0479	NC 16 at SR 1003 (Buffalo Shoals Road) Final design	
Sig. M1-M8	POLES	Standard Drawings for All Metal Poles	

INTELLIGENT TRANSPORTATION AND SIGNALS UNIT

Contacts:

Timothy J. Williams, PE, Western Region Signals Engineer
Zachary M. Little, PE, Signal Equipment Design Engineer

Prepared In the Office of:
DIVISION OF HIGHWAYS
TRANSPORTATION MOBILITY AND SAFETY
DIVISION

750 N. Greenfield Parkway, Garner, NC 27529

04-06-2016 16:28 P:\Projects\R-3100A\Traffic\Signals\Design\Titlesheet\R3100A_rdy_tsh.dgn