

CULVERT CONSTRUCTION SEQUENCE STA. 230+73 -L- (SHEET 1 OF 2)

PROJECT REFERENCE NO. <i>R-3100A</i>	SHEET NO. <i>EC-24/CONST.20</i>
RW SHEET NO.	
ROADWAY DESIGN ENGINEER	HYDRAULICS ENGINEER

PHASE I

1. CONSTRUCT STILLING BASIN 1 (30 CY).
2. CONSTRUCT IMPERVIOUS DIKES A AND B AND INSTALL 36 INCH TEMPORARY PIPE A, DIVERTING FLOW.
3. INSTALL TEMPORARY HEADWALL ON EXISTING CULVERT AND TEMPORARY SHORING 1.
4. REMOVE 47 FT. OF EXISTING CULVERT.
5. CONSTRUCT 165 FT. OF PROPOSED CULVERT AND OUTLET CHANNEL IMPROVEMENTS.
6. INSTALL TEMPORARY HEADWALL ON PROPOSED CULVERT AND TEMPORARY SHORING 2.

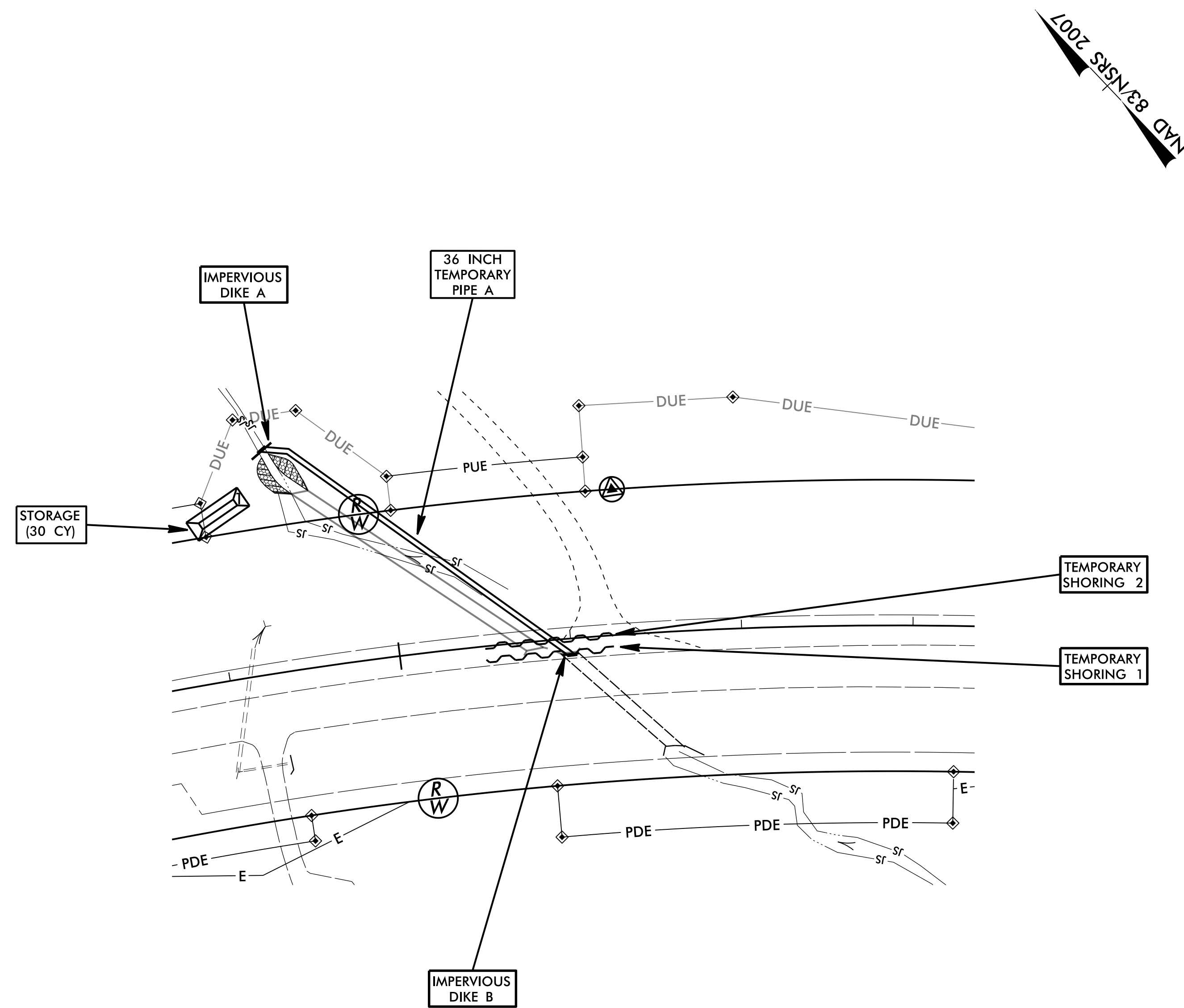

PHASE II

7. REMOVE 36 INCH TEMPORARY PIPE A AND INSTALL 36 INCH TEMPORARY PIPE B, ADJUSTING IMPERVIOUS DIKES A AND B AS NEEDED.
8. EXTEND TEMPORARY HEADWALL ON PROPOSED CULVERT IN FRONT OF EXISTING CULVERT.
9. CONSTRUCT PORTION OF WESTBOUND LANES OF PROPOSED ROADWAY AND SHIFT TRAFFIC.

