

8/17/99

PROJECT REFERENCE NO. R-3100A	SHEET NO. 12
ROADWAY DESIGN ENGINEER MOTT MACDONALD 1 & E, LLC LICENSE NO. F-0669	HYDRAULICS ENGINEER MOTT MACDONALD 1 & E, LLC LICENSE NO. F-0669

**DOCUMENT NOT CONSIDERED FINAL
UNLESS ALL SIGNATURES COMPLETED**

Prepared in the Office of:
M MOTT MACDONALD
 PO Box 700
 Fuquay-Varina, NC 27526
 www.mottmac.com/americas

MCKIM & CREED
 343 NORTH FRONT STREET
 WILMINGTON, NORTH CAROLINA 28401
 TEL: (910) 343-1048 FAX: (910) 796-8282

SEE SHEET 2B-6 FOR ISLAND DETAIL
SEE PROFILE SHEET 28

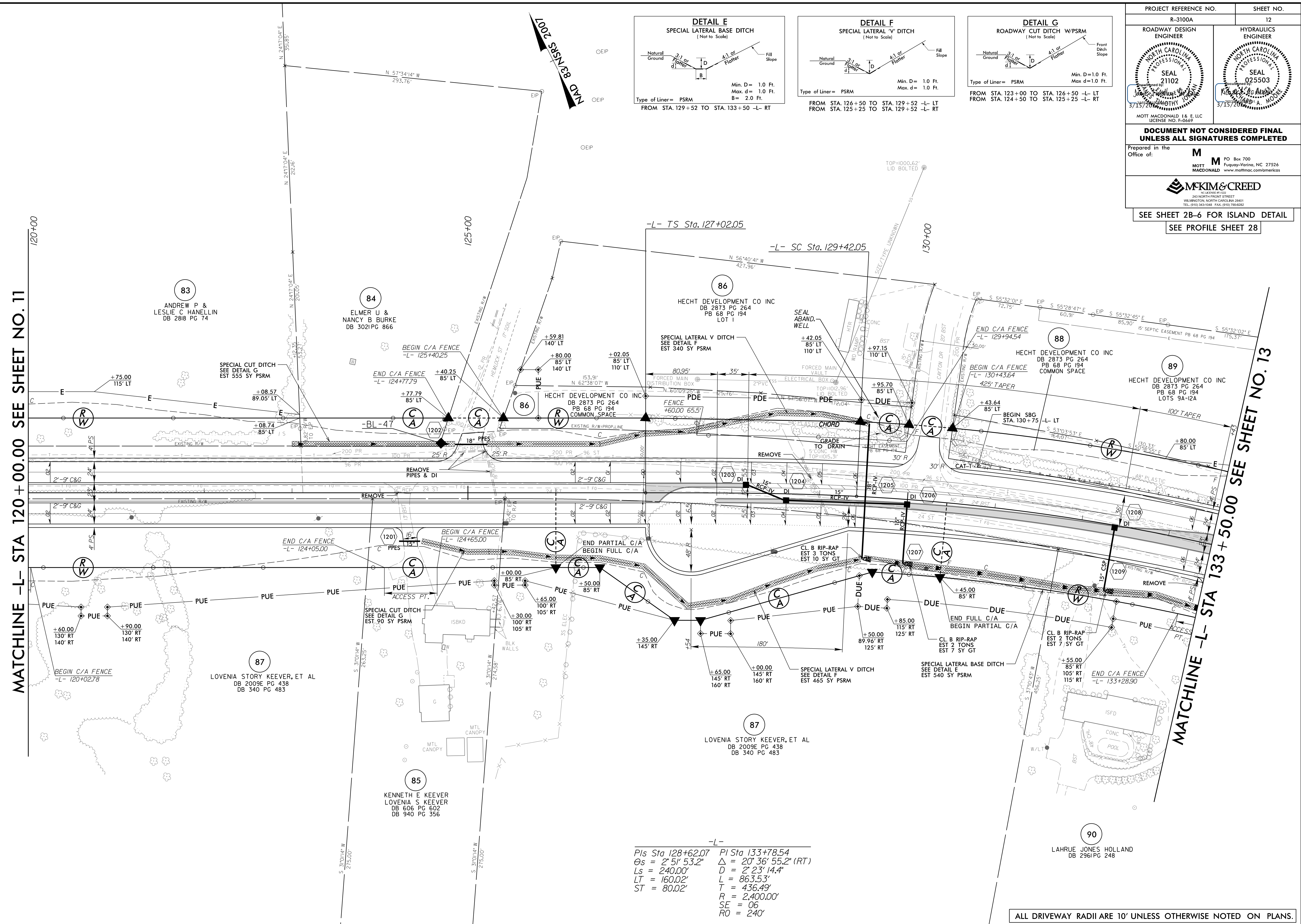
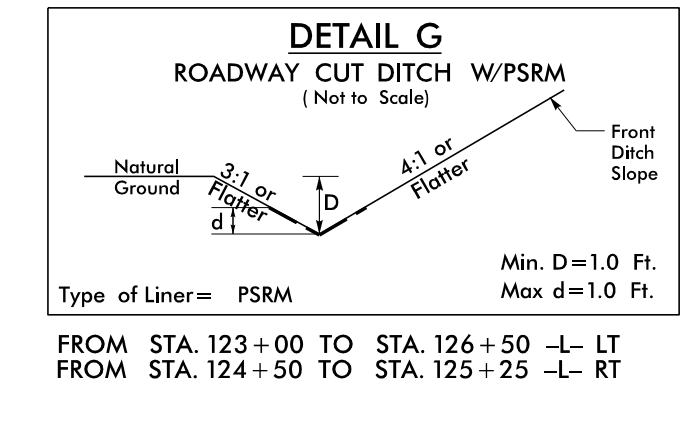
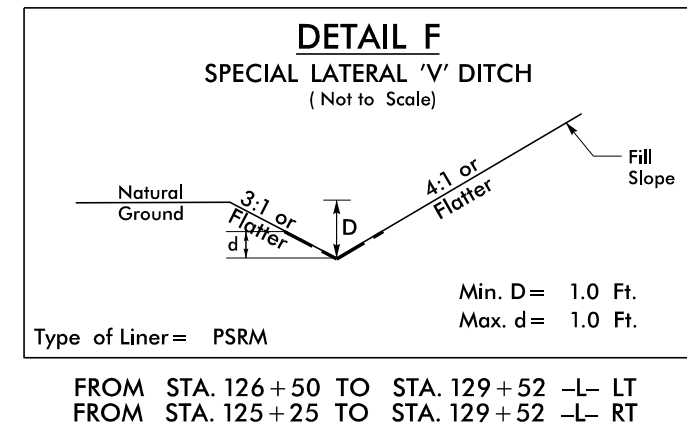
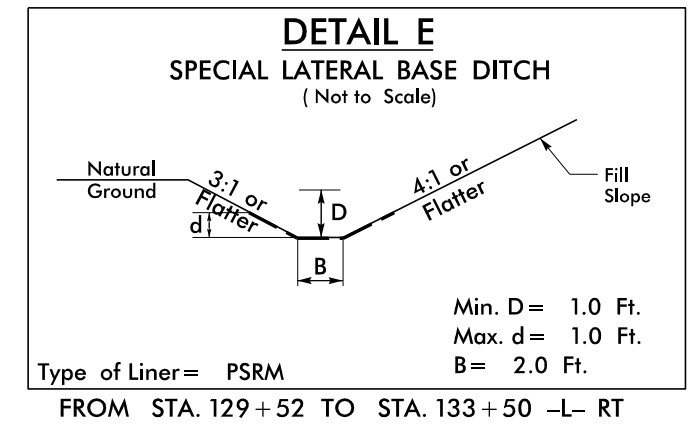

MATCHLINE -L- STA 120+00.00 SEE SHEET NO. 11

MATCHLINE -L- STA 133+50.00 SEE SHEET NO. 13

-L-
 Pls Sta 128+62.07 PI Sta 133+78.54
 Os = 2' 51" 53.2" Δ = 20' 36" 55.2" (RT)
 Ls = 240.00' D = 2' 23" 14.4"
 LT = 160.02' L = 863.53'
 ST = 80.02' T = 436.49'
 R = 2,400.00'
 SE = 06
 RO = 240'

ALL DRIVEWAY RADII ARE 10' UNLESS OTHERWISE NOTED ON PLANS.

R:\Projects\12000A\12000A.dgn