

TIP PROJECT: R-3100A

CONTRACT: C203800

See Sheet 1A For Index of Sheets
See Sheet 1B For Conventional Plan Sheet Symbols

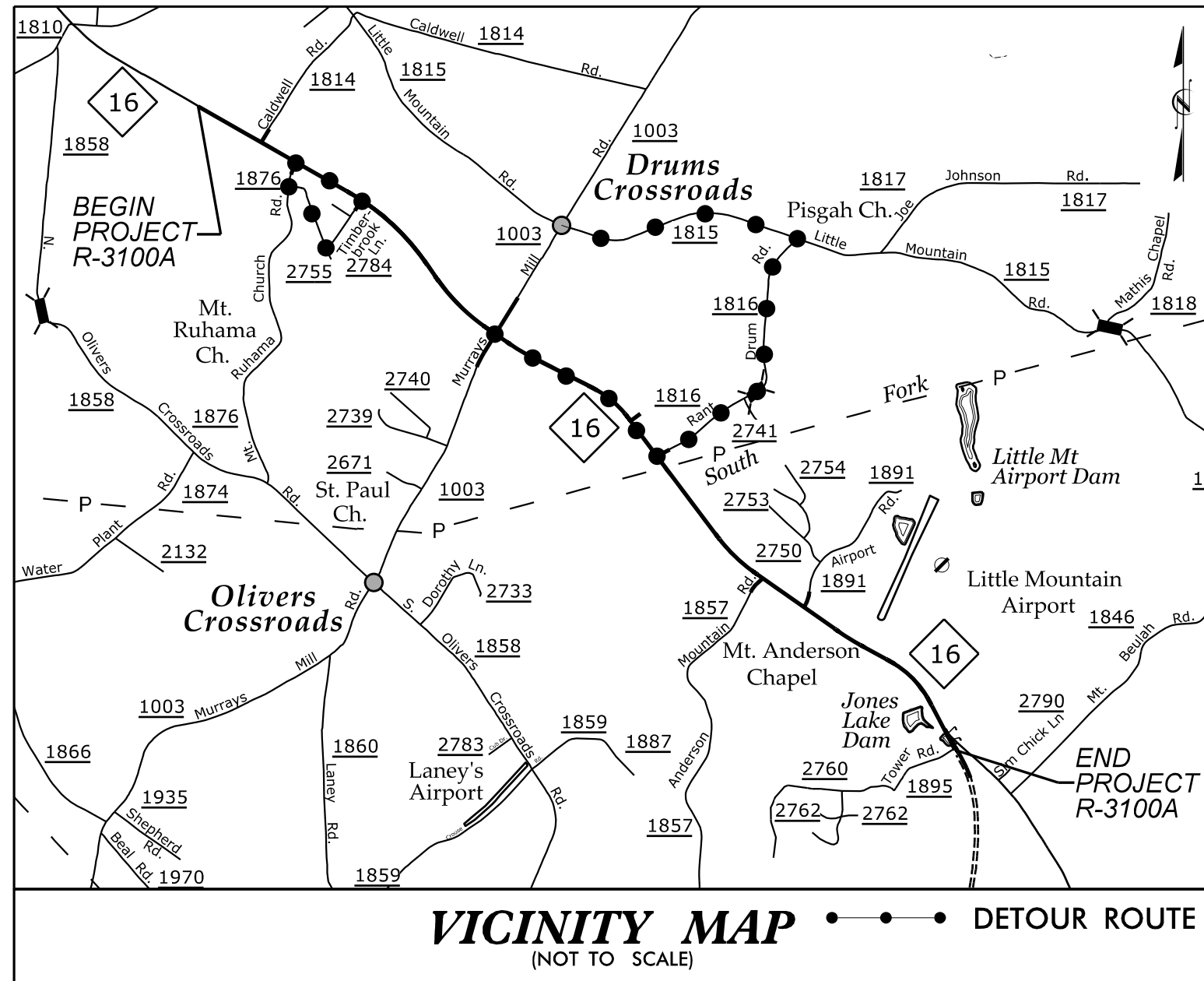

STATE OF NORTH CAROLINA
DIVISION OF HIGHWAYS
CATAWBA COUNTY

STATE	STATE PROJECT REFERENCE NO.	SHEET NO.	TOTAL SHEETS
N.C.	R-3100A	1	
STATE PROJ. NO.	F.A. PROJ. NO.	DESCRIPTION	
34522.1.3	STP-0016(52)	P.E.	
34522.2.FR6	STP-0016(52)	R/W	
34522.2.FRU6	STP-0016(52)	UTIL.	
34522.3.5	STP-0016(52)	CONST.	

PART 1 OF 2

LOCATION: NC 16 FROM NORTH OF SR 1814 (CALDWELL ROAD) TO SR 1895 (TOWER ROAD)

TYPE OF WORK: GRADING, PAVING, DRAINAGE, SIGNALS AND CULVERTS

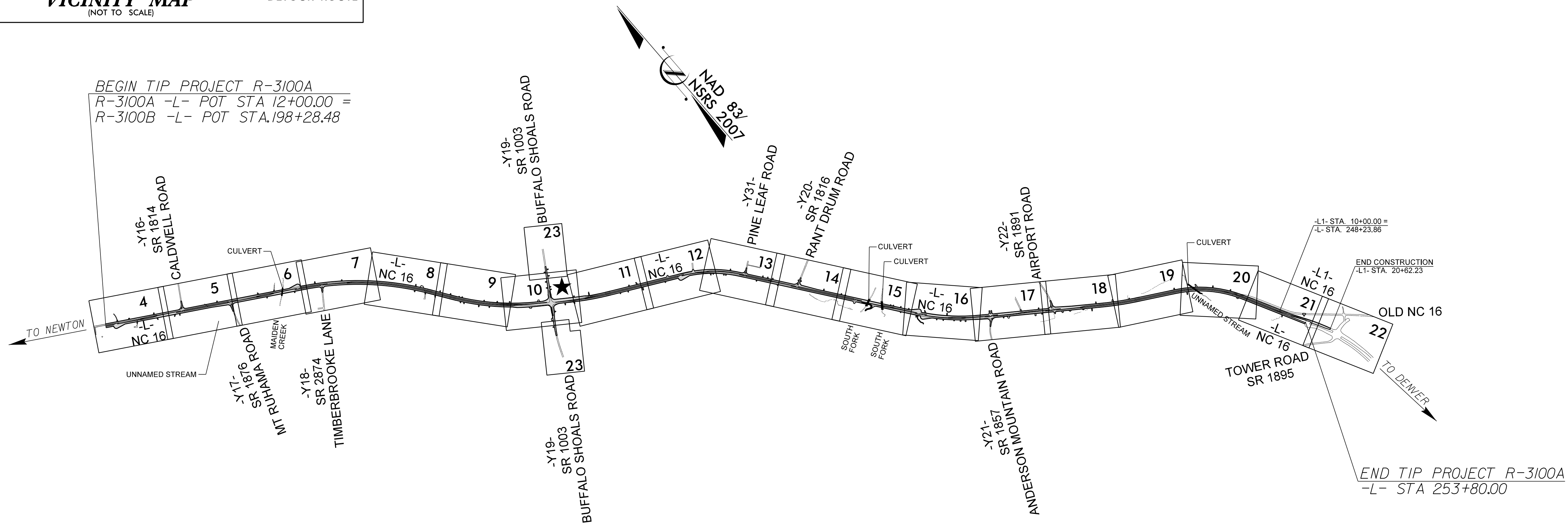

THIS IS A PARTIAL CONTROLLED-ACCESS PROJECT WITH ACCESS BEING LIMITED TO POINTS AS SHOWN ON THE PLANS.

DOCUMENT NOT CONSIDERED FINAL
UNLESS ALL SIGNATURES COMPLETED

★ PROPOSED SIGNAL

GRAPHIC SCALES

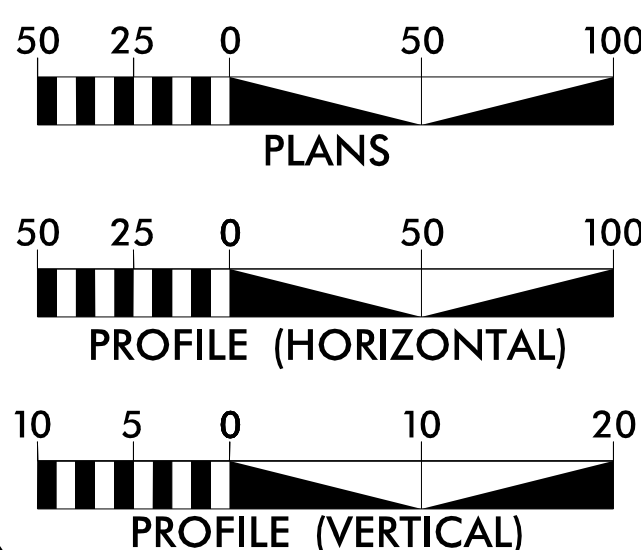

DESIGN DATA

ADT 2017 = 10,800
ADT 2037 = 17,690
K = 11 %
D = 60 %
T = 9 % *
V = 60 MPH
* TTST 4% DUAL 5%
FUNC CLASS =
RURAL ARTERIAL
REGIONAL TIER

PROJECT LENGTH

LENGTH ROADWAY TIP PROJECT R-3100A = 4.580 MILES
TOTAL LENGTH OF TIP PROJECT R-3100A = 4.580 MILES

Prepared in the Office of:

M MOTT MACDONALD
PO Box 700
Fuquay-Varina, NC 27526
www.mottmac.com/americas
LICENSE NO. F-0669
2012 STANDARD SPECIFICATIONS

MCKIM & CREED
NC LICENSE #1222
243 NORTH FRONT STREET
WILMINGTON, NORTH CAROLINA 28401
TEL. (910) 943-1948 FAX. (910) 790-8282

TIM JORDAN, PE
PROJECT ENGINEER

RICK MOORE, P.E.
HYDRAULICS PROJECT ENGINEER

GARY LOVING, P.E.
NCDOT CONTACT

RIGHT OF WAY DATE:
NOVEMBER 26, 2014

LETTING DATE:
APRIL 18, 2017

ROADWAY DESIGN ENGINEER

JAMES T. JORDAN
PROFESSIONAL SEAL 21102
3/15/2017
P.E.

HYDRAULICS ENGINEER

RICK MOORE
PROFESSIONAL SEAL 025503
3/15/2017
P.E.

