

SURVEY CONTROL SHEET B-5333

PRELIMINARY ROW MARKER IRON PIN AND CAP-E

ALIGN	STATION	OFFSET	NORTH	EAST
L	19+64.34	-60.00	317584.3028	1958814.3882
L	24+60.00	-28.82	317830.6637	1959248.2993
L	24+00.00	30.96	317748.7099	1959226.9950
L	22+84.21	65.41	317658.5906	1959149.8432
L	18+50.00	30.00	317443.5793	1958774.1445
L	35+20.00	31.80	318094.8400	1960271.2882
L	36+30.03	70.00	318076.7764	1960386.3521
L	35+00.03	-28.34	318150.4742	1960240.9608
L	39+50.00	-53.00	318301.0915	1960646.3523
L	40+14.89	50.00	318248.1774	1960755.8576
L	41+50.00	30.07	318351.8747	1960853.9223
L	41+40.00	-29.95	318389.1028	1960805.7902
L	36+30.03	-53.00	318197.8237	1960364.5221
L	38+50.00	61.03	318154.1136	1960608.4185
L	22+84.21	-60.00	317762.6911	1959079.9023
L	40+50.00	-48.00	318348.4906	1960728.0616
L	19+64.34	60.00	317484.6962	1958881.3099
L	18+50.00	-30.00	317490.6241	1958736.9050
L	24+00.00	64.68	317719.8693	1959244.4718
L	41+20.00	-55.00	318395.1062	1960774.9327

TYPE	STATION	NORTH	EAST
POT	5+32.86	316357.3729	1958076.8282
PC	6+30.63	316448.4107	1958112.4980
PT	7+52.88	316560.7234	1958160.7037
PC	11+70.10	316938.6595	1958337.4452
PT	19+64.34	317534.4995	1958847.8490
PC	22+84.21	317712.8878	1959131.3631
PCC	28+34.52	317966.8864	1959608.3890
PT	32+42.70	318076.9083	1959992.7448
PC	36+30.03	318145.6654	1960373.9303
PCC	40+14.89	318289.6109	1960727.8707
PCC	42+69.23	318461.1945	1960914.3252
PT	44+18.42	318578.4712	1961006.5403
POT	46+73.75	318780.8696	1961162.1931

PRELIMINARY ROW MARKER PERMANENT EASEMENT-E

ALIGN	STATION	OFFSET	NORTH	EAST
L	42+30.00	60.00	318391.4857	1960934.0264
L	42+30.00	30.07	318411.2927	1960911.5932
L	39+70.00	80.00	318197.0101	1960731.5915
L	18+25.00	45.00	317416.6166	1958764.5832
L	18+25.00	30.00	317428.2174	1958755.0741
L	26+30.00	30.99	317857.2032	1959426.4348
L	26+30.00	50.00	317840.1013	1959434.7356
L	33+45.00	30.63	318064.9209	1960098.8608
L	33+45.00	45.00	318050.7830	1960101.4110

BL	POINT	DESC.	NORTH	EAST	ELEVATION	L STATION	OFFSET
1	B-5333	BL-1	316952.5150	1958326.0980	135.39	11+77.76	16.17 LT
2	B-5333	BL-2	317419.3140	1958659.4630	135.71	17+46.75	25.85 LT
3	B-5333	BL-3	317734.0950	1959108.7190	137.36	22+92.12	20.21 LT
4	B-5333	BL-4	317996.2260	1959608.7810	134.57	28+52.81	24.59 LT
5	B-5333	BL-5	318124.0560	1960135.8050	134.14	33+91.85	21.00 LT
6	B-5333	BL-6	318173.4390	1960544.2110	135.43	38+00.07	18.78 RT
7	B-5333	BL-7	318443.3710	1960920.1400	141.42	42+59.17	15.76 RT

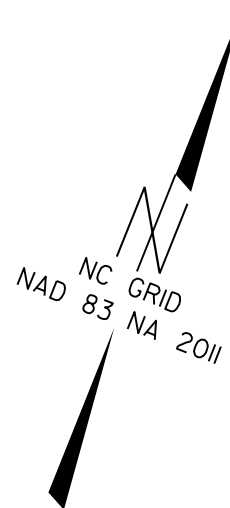

.....
 BM80 ELEVATION = 132.74
 N 317247 E 1958451
 BL STATION 8+12.00 69 LEFT
 4021

.....
 BM81 ELEVATION = 149.16
 N 318374 E 1960921
 BL STATION 35+63.00 57 RIGHT
 4021

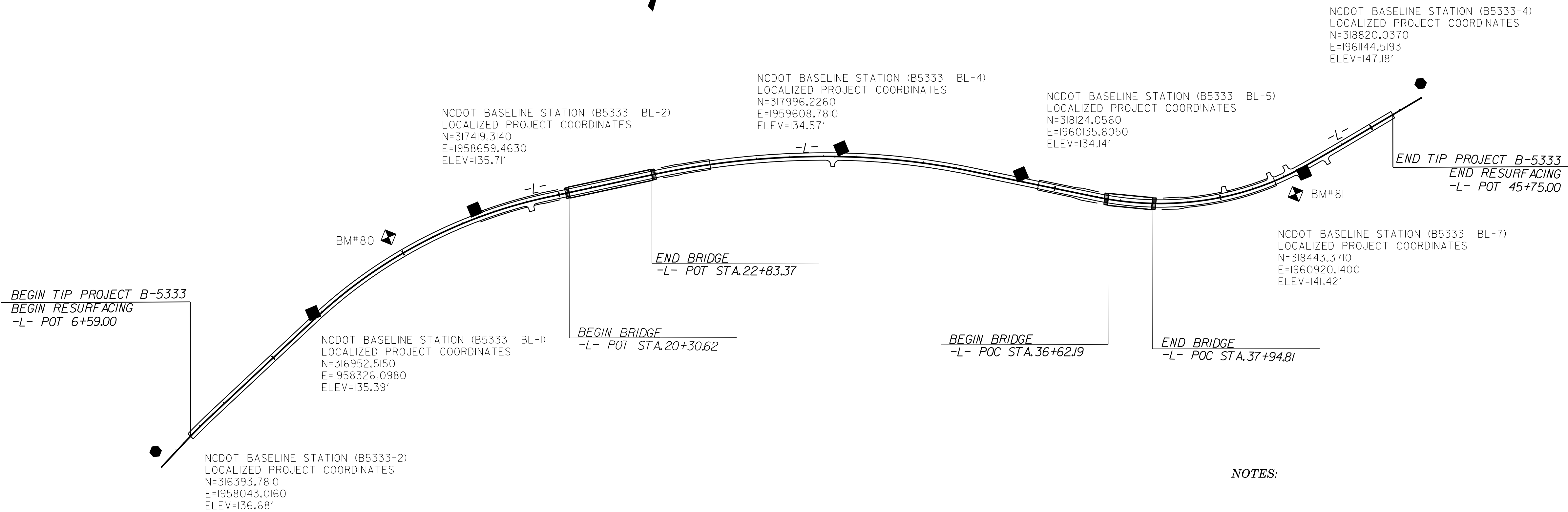

NOTES:

- THE CONTROL DATA FOR THIS PROJECT CAN BE FOUND ELECTRONICALLY BY SELECTING PROJECT CONTROL DATA AT:
[HTTPS://CONNECT.NCDOT.GOV/RESOURCES/LOCATION/](https://connect.ncdot.gov/resources/location/)
 THE FILES TO BE FOUND ARE AS FOLLOWS:
 B-5333_LS_CONTROL.TXT
 SITE CALIBRATION INFORMATION HAS NOT BEEN PROVIDED FOR THIS PROJECT. IF FURTHER INFORMATION IS NEEDED, PLEASE CONTACT THE LOCATION AND SURVEYS UNIT.

© INDICATES GEODETIC CONTROL MONUMENTS USED OR SET FOR HORIZONTAL PROJECT CONTROL BY THE NCDOT LOCATION AND SURVEYS UNIT.
 PROJECT CONTROL ESTABLISHED USING GLOBAL POSITIONING SYSTEM.
 NETWORK ESTABLISHED FROM EXISTING HARN MONUMENTATION
 SEE GPS CALIBRATION SHEET FOR HORIZONTAL AND VERTICAL COORDINATE VALUES.

DATUM DESCRIPTION

THE LOCALIZED COORDINATE SYSTEM DEVELOPED FOR THIS PROJECT IS BASED ON THE STATE PLANE COORDINATES ESTABLISHED BY NCDOT FOR MONUMENT "B5333-2" WITH NAD 83/NA 2011 STATE PLANE GRID COORDINATES OF NORTHING: 316393.7810(ft) EASTING: 1958043.0160(ft) ELEVATION: 136.6800(ft)

THE AVERAGE COMBINED GRID FACTOR USED ON THIS PROJECT (GROUND TO GRID) IS: 0.99993085

THE N.C. LAMBERT GRID BEARING AND LOCALIZED HORIZONTAL GROUND DISTANCE FROM "B5333-2" TO -L- STATION BL-1 IS
 N26°52'08.42"E 626.35

ALL LINEAR DIMENSIONS ARE LOCALIZED HORIZONTAL DISTANCES
 VERTICAL DATUM USED IS NAVD 88

NOTE: DRAWING NOT TO SCALE