

See Sheet 1A For Index of Sheets

STATE OF NORTH CAROLINA  
DIVISION OF HIGHWAYS

**ROBESON COUNTY**

**LOCATION: BRIDGE NO. 173 OVER LUMBER RIVER AND  
BRIDGE NO. 174 OVER OVERFLOW ON SR 1550 (LOWE ROAD)**

**TYPE OF WORK: GRADING, PAVING, DRAINAGE,  
AND STRUCTURES**

STATE	STATE PROJECT REFERENCE NO.	SHEET NO.	TOTAL SHEETS
N.C.	<b>B-5333</b>	1	
STATE PROJ. NO.	F.A. PROJ. NO.	DESCRIPTION	
46047.1.1	BRZ-1550(2)	P.E.	
46047.2.1	BRZ-1550(2)	RW & UTIL	
46047.3.1	BRZ-1550(2)	CONST.	

**TIP PROJECT: B-5333**

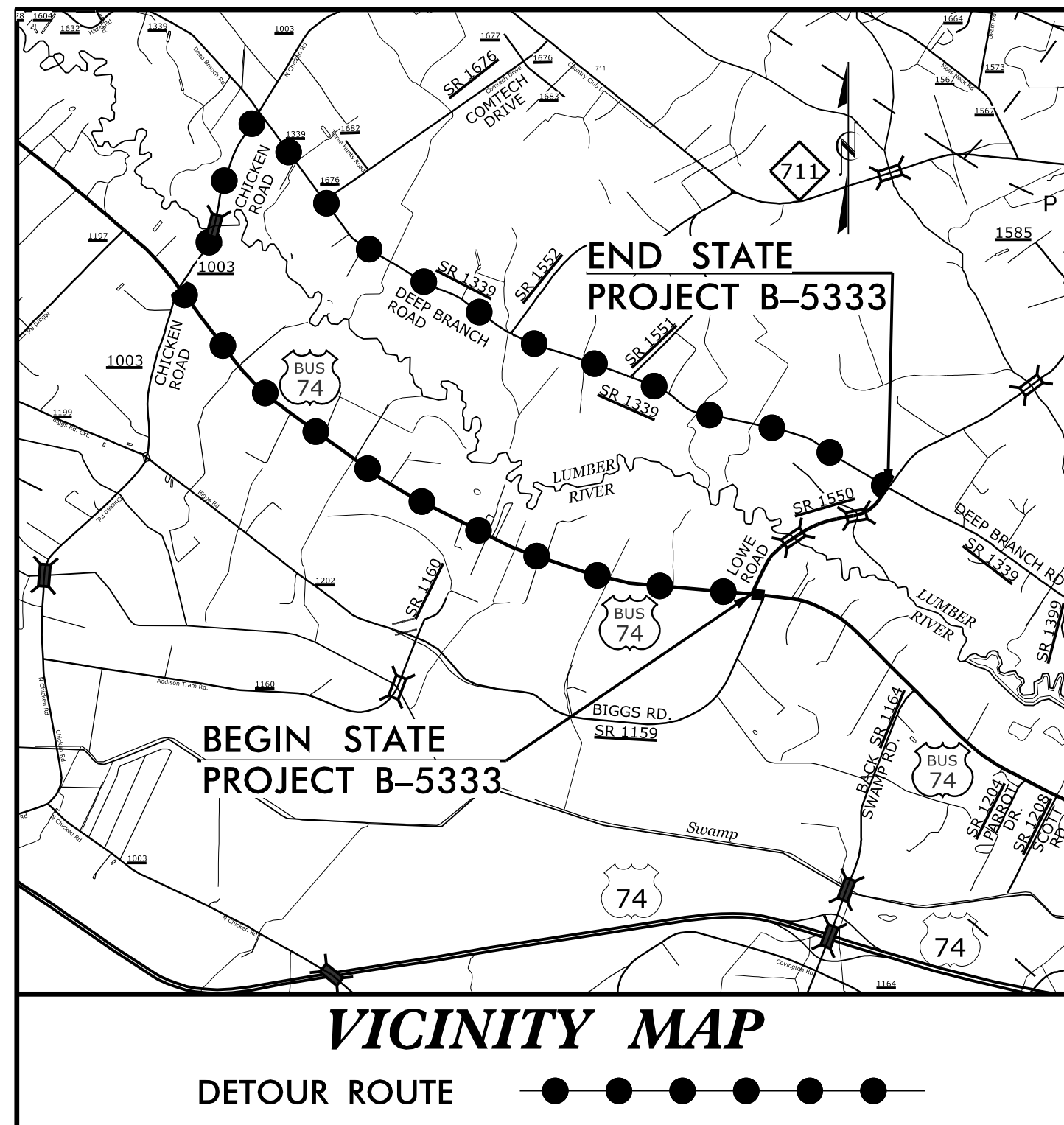

**CONTRACT: C203877**

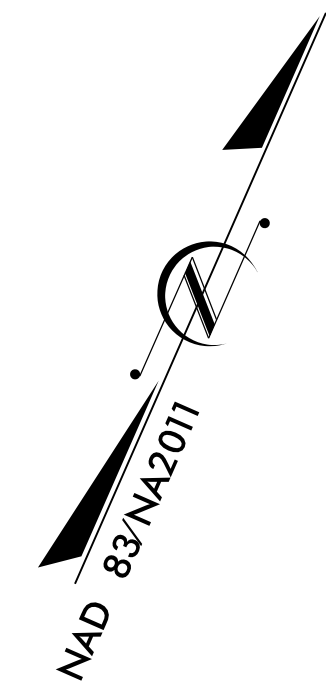
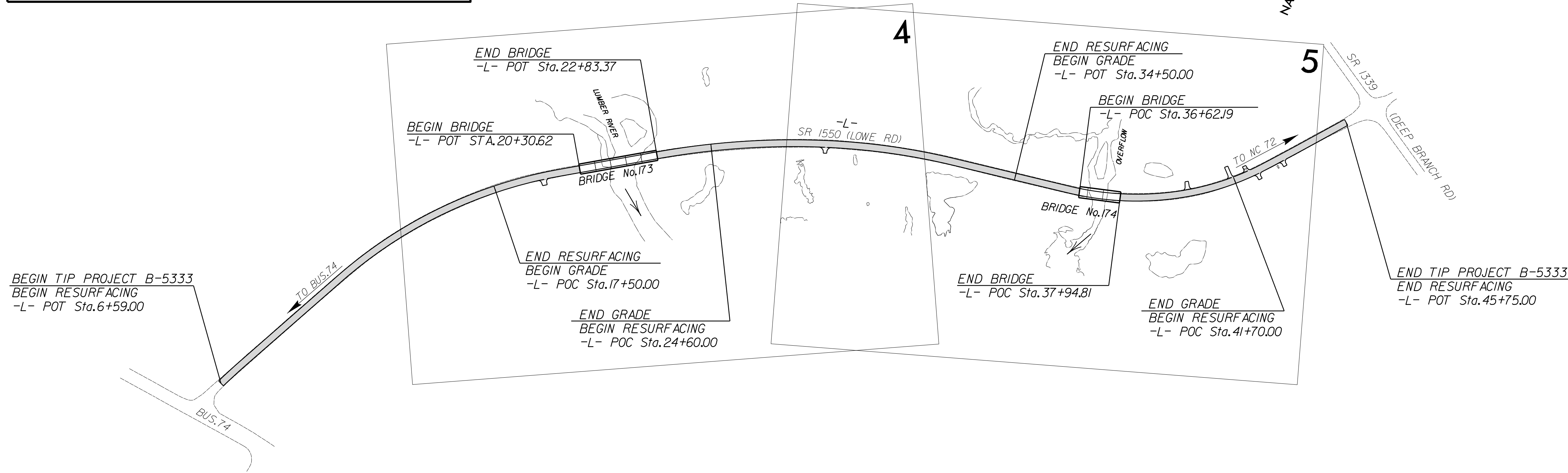

DOCUMENT NOT CONSIDERED FINAL  
UNLESS ALL SIGNATURES COMPLETED

NCDOT CONTACT: GARY LOVERING, PE

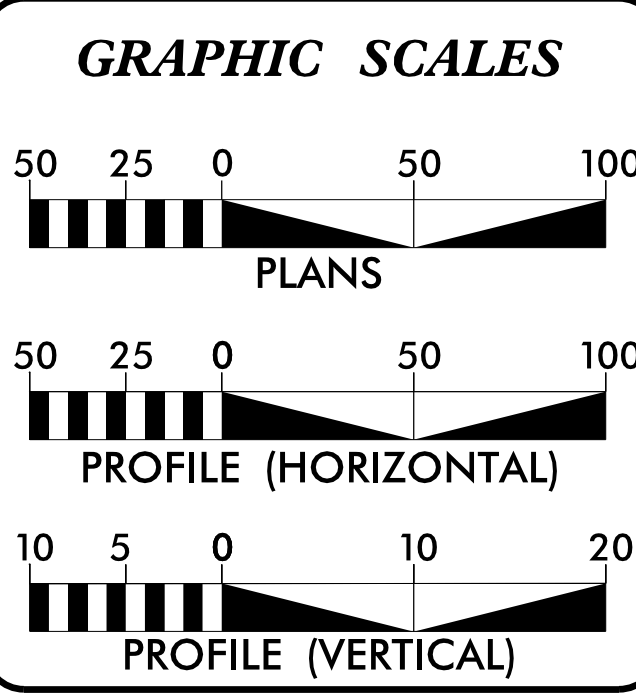

**DESIGN DATA**

ADT 2017 =	1,700
ADT 2037 =	2,300
K =	9 %
D =	60 %
T =	6 % *
V =	60 MPH
* TTST = 1% DUAL 5%	
FUNC CLASS =	
MINOR COLLECTOR	
SUB REGIONAL TIER	

**PROJECT LENGTH**

LENGTH ROADWAY TIP PROJECT B-5333 =	0.669 MILES
LENGTH STRUCTURE TIP PROJECT B-5333 =	0.073 MILES
TOTAL LENGTH TIP PROJECT B-5333 =	0.742 MILES

**PLANS PREPARED FOR NCDOT BY:**

2610 WYCLIFF ROAD  
SUITE 410  
RALEIGH, NC 27607  
PHONE: 919.881.9939  
NC COA No. F-0929

2012 STANDARD SPECIFICATIONS

<b>RIGHT OF WAY DATE:</b>	MARCH 21, 2016
<b>LETTING DATE:</b>	MARCH 21, 2017

<b>DENNIS J. MORY, PE</b>	PROJECT ENGINEER
<b>CHAD D. BOBROWSKI, PE</b>	PROJECT DESIGN ENGINEER

**HYDRAULICS ENGINEER**

DocuSigned by:  
*Cameron Long*  
2/9/2017  
SIGNATURE:

**ROADWAY DESIGN ENGINEER**

DocuSigned by:  
*Dennis J. Mory*  
2/9/2017  
SIGNATURE:

