

SIDE VIEW  
NORTH FACE

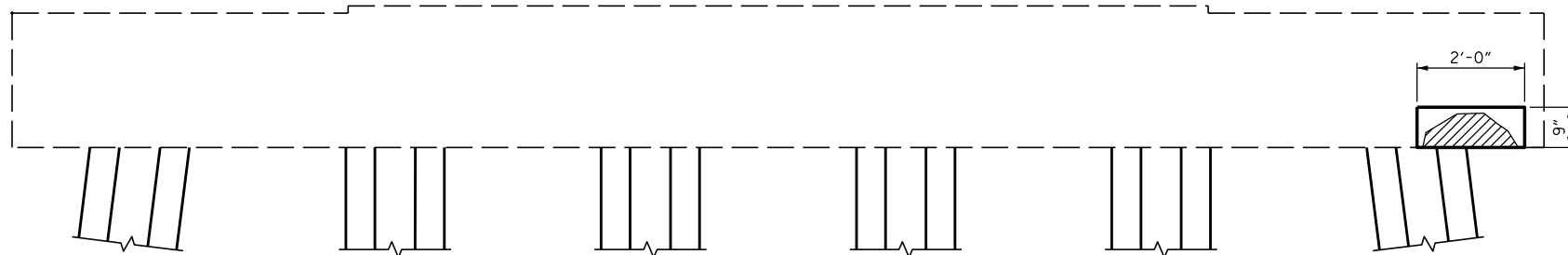

ELEVATION  
WEST FACE

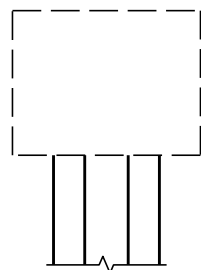

SIDE VIEW  
SOUTH FACE

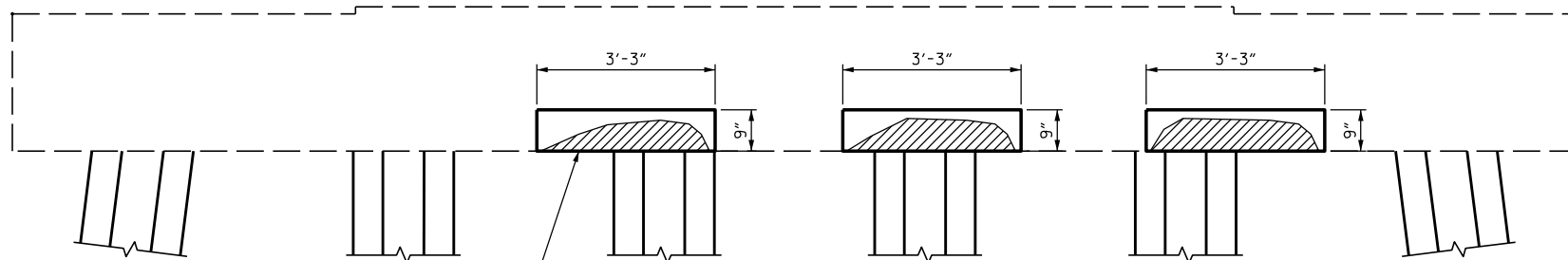

ELEVATION  
EAST FACE

ANTICIPATE CAP  
UNDERSIDE REPAIRS



PROPOSED REPAIR AREAS



SUBSTRUCTURE SPALL/DELAMINATION

DocuSigned by:  
*Samuel Cullum*



PROJECT NO. B-5937  
CURRITUCK/DARE COUNTY  
STATION: BRIDGE NO. 16

STATE OF NORTH CAROLINA  
DEPARTMENT OF TRANSPORTATION  
RALEIGH

SUBSTRUCTURE CONC.  
REPAIR - BENT 123

DRAWN BY : J. B. HANNA DATE : 07-16  
CHECKED BY : S. L. CULLUM DATE : 07-16  
DESIGN ENGINEER OF RECORD: S. L. CULLUM DATE : 07-16

DOCUMENT NOT CONSIDERED  
FINAL UNLESS ALL  
SIGNATURES COMPLETED

REVISIONS						SHEET NO.
NO.	BY:	DATE:	NO.	BY:	DATE:	TOTAL SHEETS
1			3			S-142
2			4			

\*\*\*\*\*SYSTEM\*\*\*\*\*  
\*\*\*\*\*SDGN\*\*\*\*\*  
\*\*\*\*\*USERNAME\*\*\*\*\*