

MATCH LINE, SEE SHEET ITS-73

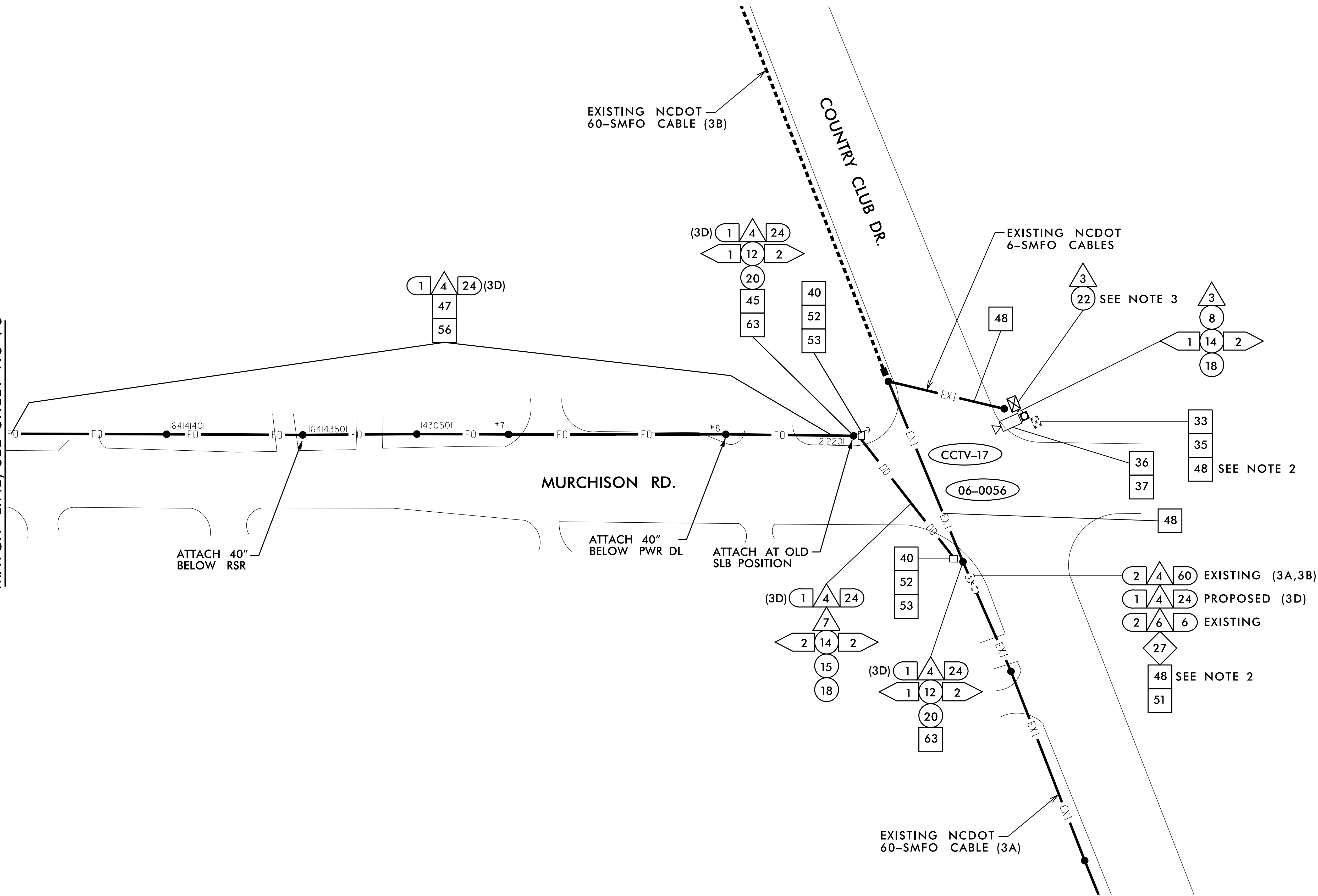

- NOTES:**
1. NCDOT CONTRACTOR ATTACH TO FRONT SIDE OF POLE AT 40" BELOW POWER PRESENCE UNLESS OTHERWISE NOTED.
  2. REMOVE EXISTING DROP CABLE BETWEEN CCTV CABINET AND AERIAL SPLICE ENCLOSURE.
  3. SEE SUMMARY OF WORK TABLES FOR ADDITIONAL CABINET AND COMMUNICATIONS WORK TO BE PERFORMED.

11/5/2016 K:\ARL\_TPTD\_ITS\01036305 - Fayetteville Sig Sys\Plans\01036305\_ITS\_psh\_74.dgn

**Kimley»Horn**  
 NC License #F-0102  
 421 Fayetteville St., Suite 600  
 Raleigh, NC 27636  
 Tel: (919) 677-2000  
 Fax: (919) 677-2050

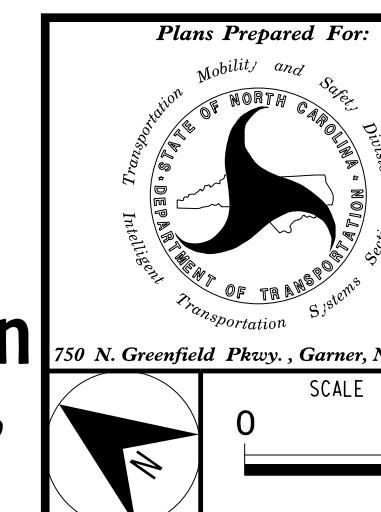

<b>FAYETTEVILLE COMPUTERIZED SIGNAL SYSTEM</b> <b>COMMUNICATIONS CABLE AND CONDUIT ROUTING PLAN</b>	
DIVISION 06	CUMBERLAND COUNTY
PLAN DATE: NOVEMBER 2016	REVIEWED BY: K. NICHOLAS
PREPARED BY: J. CROSS	REVIEWED BY: K. SMITH
REVISIONS	INIT. DATE

SEAL	DATE
	11/15/2016
SIGNATURE	DATE

