

6 PHASE FULLY ACTUATED FAYETTEVILLE SIGNAL SYSTEM

NOTES

- REFER TO "ROADWAY STANDARD DRAWINGS NCDOT" DATED JANUARY 2012 AND "STANDARD SPECIFICATIONS FOR ROADS AND STRUCTURES" DATED JANUARY 2012.
- PAVEMENT MARKINGS ARE EXISTING.
- MAXIMUM TIMES SHOWN IN TIMING CHART ARE FOR FREE-RUN OPERATION ONLY. COORDINATED SIGNAL SYSTEM TIMING VALUES SHALL SUPERSEDE THESE VALUES.
- SET ALL DETECTOR UNITS TO PRESENCE MODE.
- PROGRAM PEDESTRIAN HEADS TO COUNTDOWN THE FLASHING "DON'T WALK" TIME ONLY. USE LIGHTED PEDESTRIAN PUSH BUTTON CALL INDICATORS.
- LOCATE NEW CABINET ON EXISTING FOUNDATION.
- PHASE 1 AND/OR PHASE 5 MAY BE LAGGED.
- THE ORDER OF PHASE 3 AND PHASE 4 MAY BE REVERSED.
- OMIT "WALK" AND FLASHING "DON'T WALK" WITH NO PEDESTRIAN CALLS.
- IN THE EVENT OF LOOP REPLACEMENT, REFER TO THE CURRENT ITS AND SIGNALS DESIGN MANUAL AND SUBMIT A PLAN OF RECORD TO THE SIGNAL DESIGN SECTION.

PHASING DIAGRAM

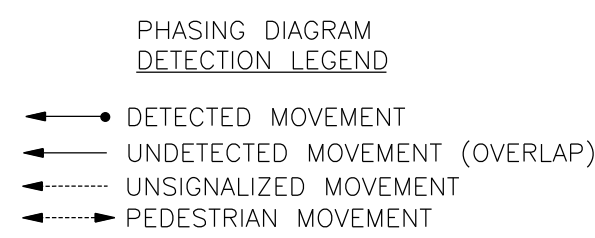
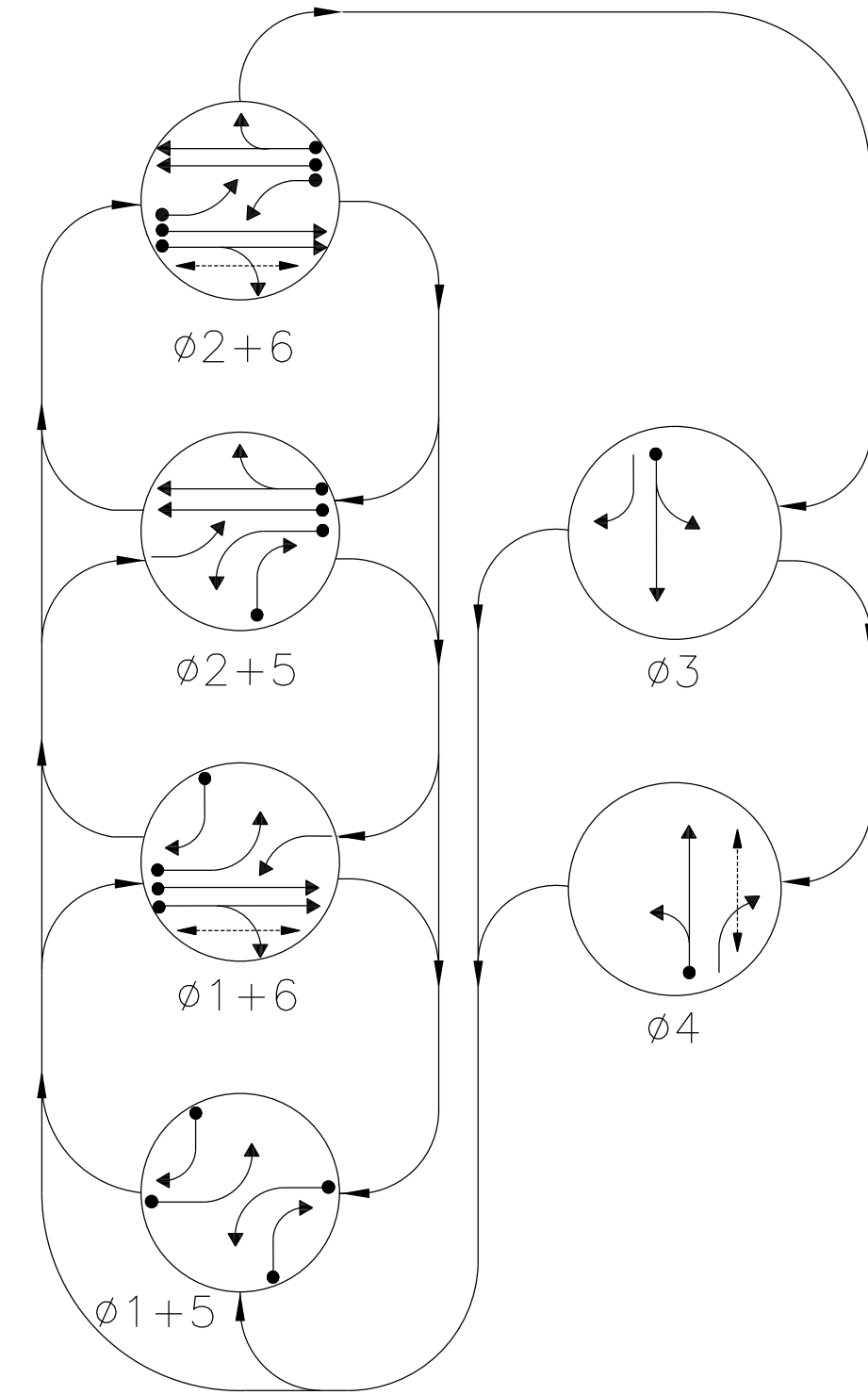

SIGNAL FACE	PHASE						FLASH
	Ø 1+5	Ø 1+6	Ø 2+5	Ø 2+6	Ø 3	Ø 4	
11	—	—	⤴	⤵	⤴	⤵	—
21,22	R	R	G	G	R	R	Y
31	R	R	R	R	G	R	R
32	R	R	R	R	G	R	R
41	R	R	R	R	R	G	R
42	R	R	R	R	R	G	R
51	—	—	⤴	⤵	⤴	⤵	—
61,62	R	G	R	G	R	R	Y
P41,P42	DW	DW	DW	DW	DW	W	DRK
P61,P62	DW	W	DW	W	DW	DW	DRK

SIGNAL FACE I.D.
All Heads L.E.D.

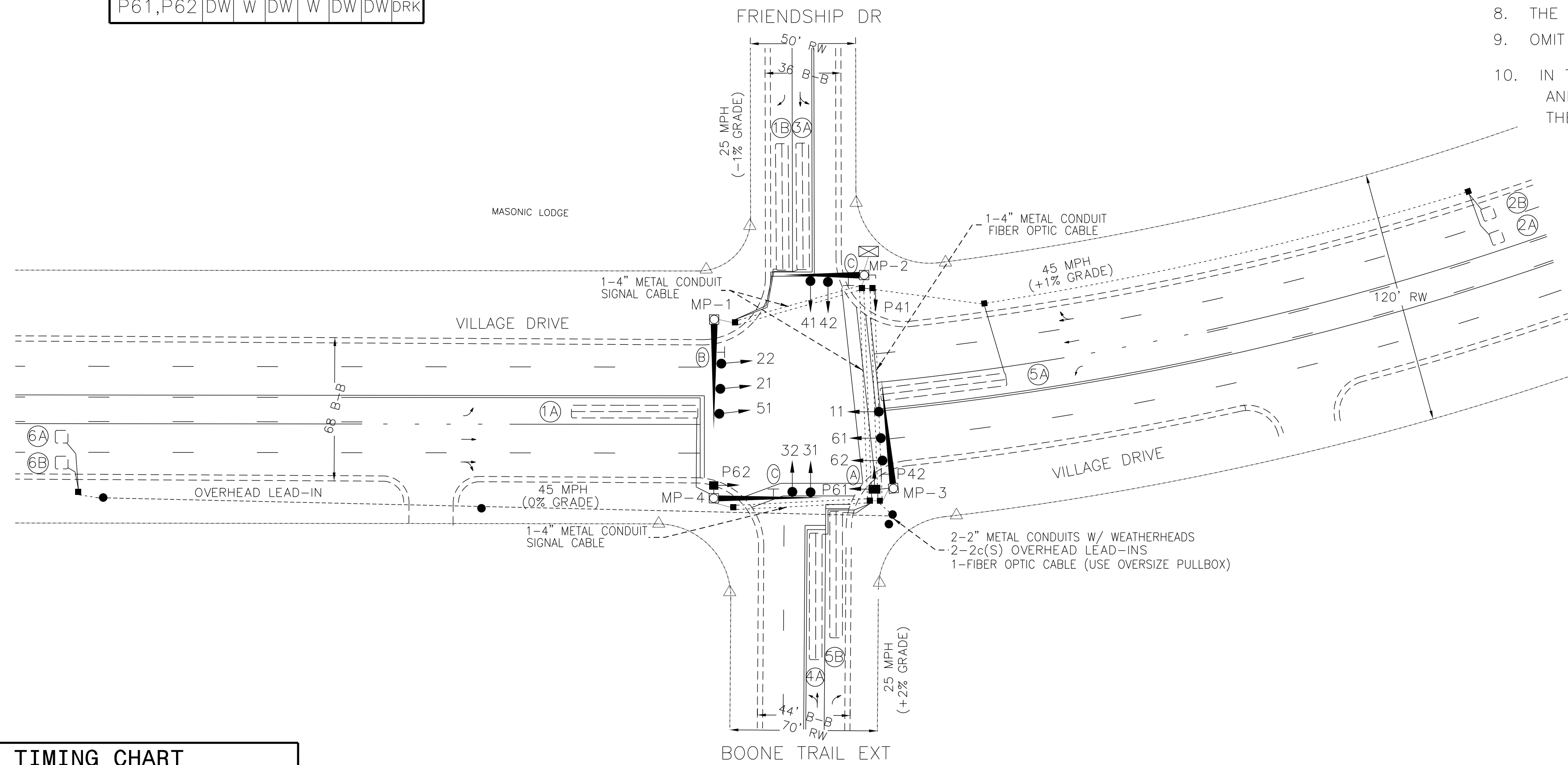
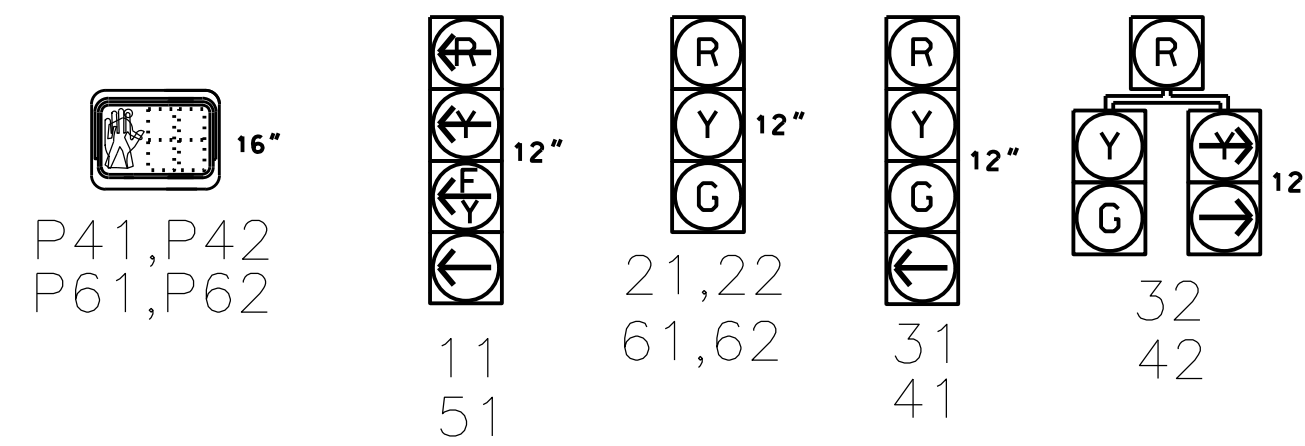

LEGEND

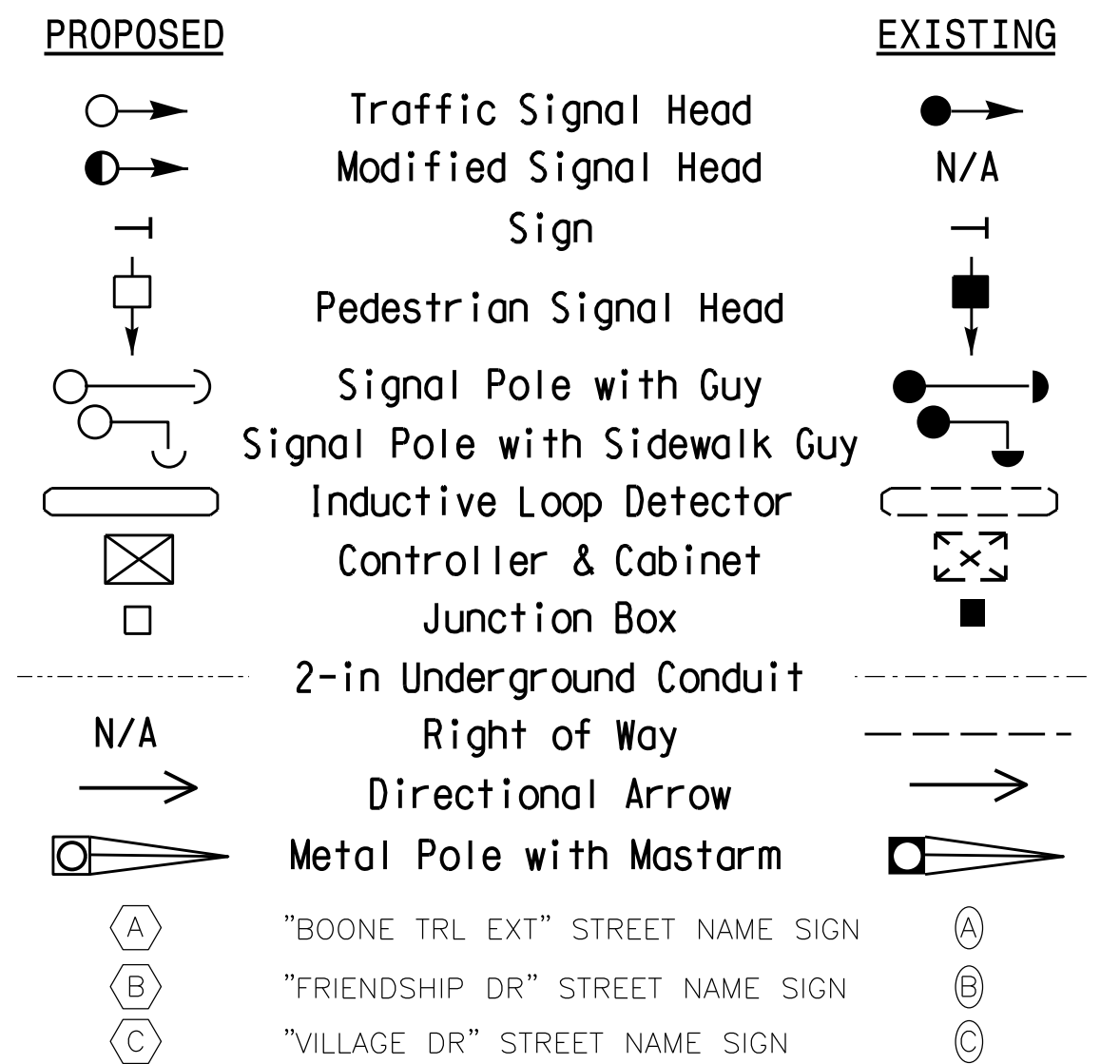

FEATURE	ASC/3 TIMING CHART					
	1	2	3	4	5	6
Min Green *	7	12	7	7	7	12
Walk *	0	0	0	7	0	7
Ped Clear	0	0	0	22	0	11
Veh. Extension *	1.0	6.0	1.0	1.0	1.0	6.0
Max I *	15	75	20	20	15	75
Yellow	3.2	4.4	3.2	3.1	3.1	4.5
Red Clear	1.8	1.0	2.9	2.6	1.8	1.2
Actuations B4 Add *	-	0	-	-	-	0
Seconds / Actuation *	-	1.5	-	-	-	1.5
Max Initial *	-	34	-	-	-	34
Time Before Reduction *	-	15	-	-	-	15
Time To Reduce *	-	30	-	-	-	30
Minimum Gap	-	3.0	-	-	-	3.0
Locking Detector	-	X	-	-	-	X
Recall Position	-	VEH. RECALL	-	-	-	VEH. RECALL
Dual Entry	-	-	-	-	-	-
Simultaneous Gap	X	X	X	X	X	X

* These values may be field adjusted. Do not adjust Min Green and Extension times for phases 2 and 6 lower than what is shown. Min Green for all other phases should not be lower than 4 seconds.

ASC/3 DETECTOR INSTALLATION CHART									
DETECTOR				PROGRAMMING					
LOOP	SIZE (FT)	DISTANCE FROM STOPBAR (FT)	TURNS	NEW LOOP	PHASE	EXTEND TIME	DELAY TIME	TYPE	SYSTEM LOOP NEW CARD
1A	6x60	0	2-4-2	-	6	-	3	G	- Y
1B	6x60	0	2-4-2	-	1	-	15	S	- Y
2A	6x6	300	4	-	2	-	-	S	- Y
2B	6x6	300	4	-	2	-	-	S	- Y
3A	6x60	0	2-4-2	-	3	-	3	S	- Y
4A	6x60	0	2-4-2	-	4	-	3	S	- Y
5A	6x60	0	2-4-2	-	2	-	3	G	- Y
5B	6x60	0	2-4-2	-	5	-	15	S	- Y
6A	6x6	300	4	-	6	-	-	S	- Y
6B	6x6	300	4	-	6	-	-	S	- Y

Signal Upgrade

Prepared In the Offices of
Hatch Mott MacDonald
PO Box 700
Fayetteville, NC 27526
www.hatchmott.com
HATCH MOTT MACDONALD & E. LLC
LICENSE NO. F-0669

<p>VILLAGE DRIVE AT BOONE TRAIL EXTENSION/ FRIENDSHIP DRIVE</p> <p>DIV 06 CUMBERLAND COUNTY FAYETTEVILLE</p> <p>PLAN DATE: NOVEMBER 2016 REVIEWED BY: RWT</p> <p>PREPARED BY: BLR REVIEWED BY:</p>		<p>SEAL</p> <p>Russell W. Thompson 11/21/2016</p>							
<p>REVISIONS</p> <table border="1"> <tr> <th>NO.</th> <th>DATE</th> <th>INIT.</th> <th>DATE</th> </tr> <tr> <td> </td> <td> </td> <td> </td> <td> </td> </tr> </table>	NO.		DATE	INIT.	DATE				
NO.	DATE	INIT.	DATE						

default \\NCF-DATA\Project\360655_U-5742_Fay-Sig\Project\Sigs\Design\100%FINAL SEALED PLANS\Revised 1172016\1172016_Village-et.Boone.dgn 11/21/2016 10:03:45 AM