

PHASING DIAGRAM

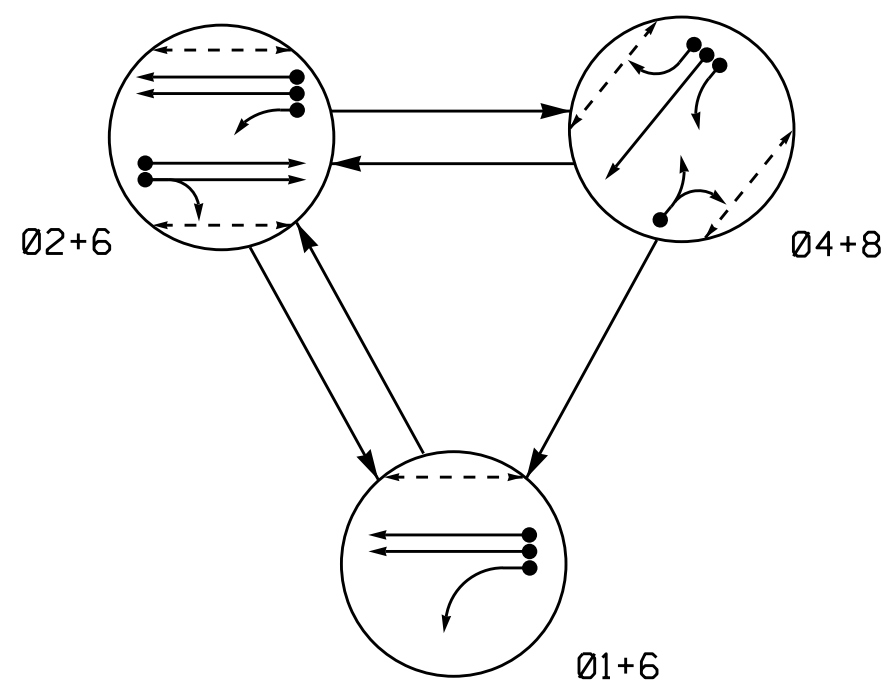

SIGNAL FACE	PHASE			
	01+6	02+6	04+8	FLUSH
11	←	←	←	←
21, 22	R	G	R	Y
41, 42	R	R	G	R
61, 62	G	G	R	Y
81, 82	R	R	G	R
P21, P22	DW	W	DW	DRK
P41, P42	DW	DW	W	DRK
P61, P62	W	W	DW	DRK
P81, P82	DW	DW	W	DRK

SIGNAL FACE I.D.

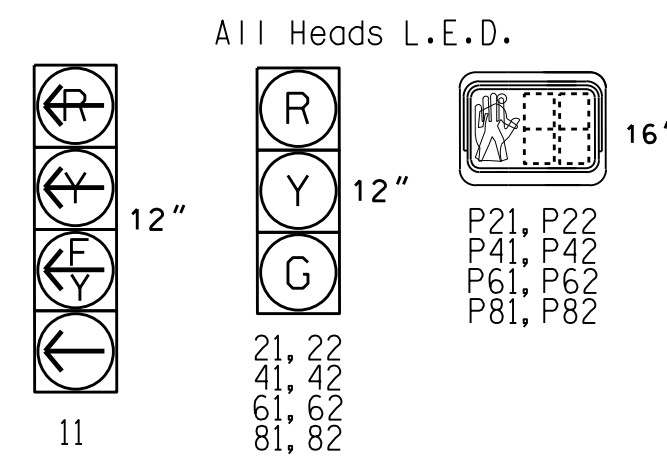

ASC/3 DETECTOR INSTALLATION CHART										
DETECTOR					PROGRAMMING					
LOOP	SIZE (FT)	DISTANCE FROM STOPBAR (FT)	TURNS	NEW LOOP	PHASE	CALLING	EXTEND TIME	DELAY TIME	TYPE	LOOP NEW CARD
1A	6X60	0	2-4-2	-	1	Yes	-	15	S	- X
2A,2B	6X6	70	4	-	6	Yes	-	-	S	- X
4A	6X60	0	2-4-2	-	4	Yes	-	-	S	- X
4B	6X60	0	2-4-2	-	4	Yes	-	-	S	- X
4C	6X60	0	2-4-2	-	4	Yes	-	10	S	- X
6A,6B	6X6	70	4	-	6	Yes	-	-	S	- X
8A	6X60	0	2-4-2	-	8	Yes	-	10	S	- X

3 Phase Fully Actuated Fayetteville Signal System

NOTES

1. Refer to "Roadway Standard Drawings NCDOT" dated January 2012 and "Standard Specifications for Roads and Structures" dated January 2012.
2. Do not program signal for late night flashing operation unless otherwise directed by the Engineer.
3. Phase 1 may be lagged.
4. Set all detector units to presence mode.
5. In the event of loop replacement, refer to the current ITS and Signals Design Manual and submit a Plan of Record to the Signal Design Section.
6. Locate new cabinet so as not to obstruct sight distance of vehicles turning right on red.
7. Omit "WALK" and flashing "DON'T WALK" with no pedestrian calls.
8. Program pedestrian heads to countdown the flashing "Don't Walk" time only.
9. Pavement markings are existing.
10. Maximum times shown in timing chart are for free-run operation only. Coordinated signal system timing values supersede these values.

PHASING DIAGRAM DETECTION LEGEND

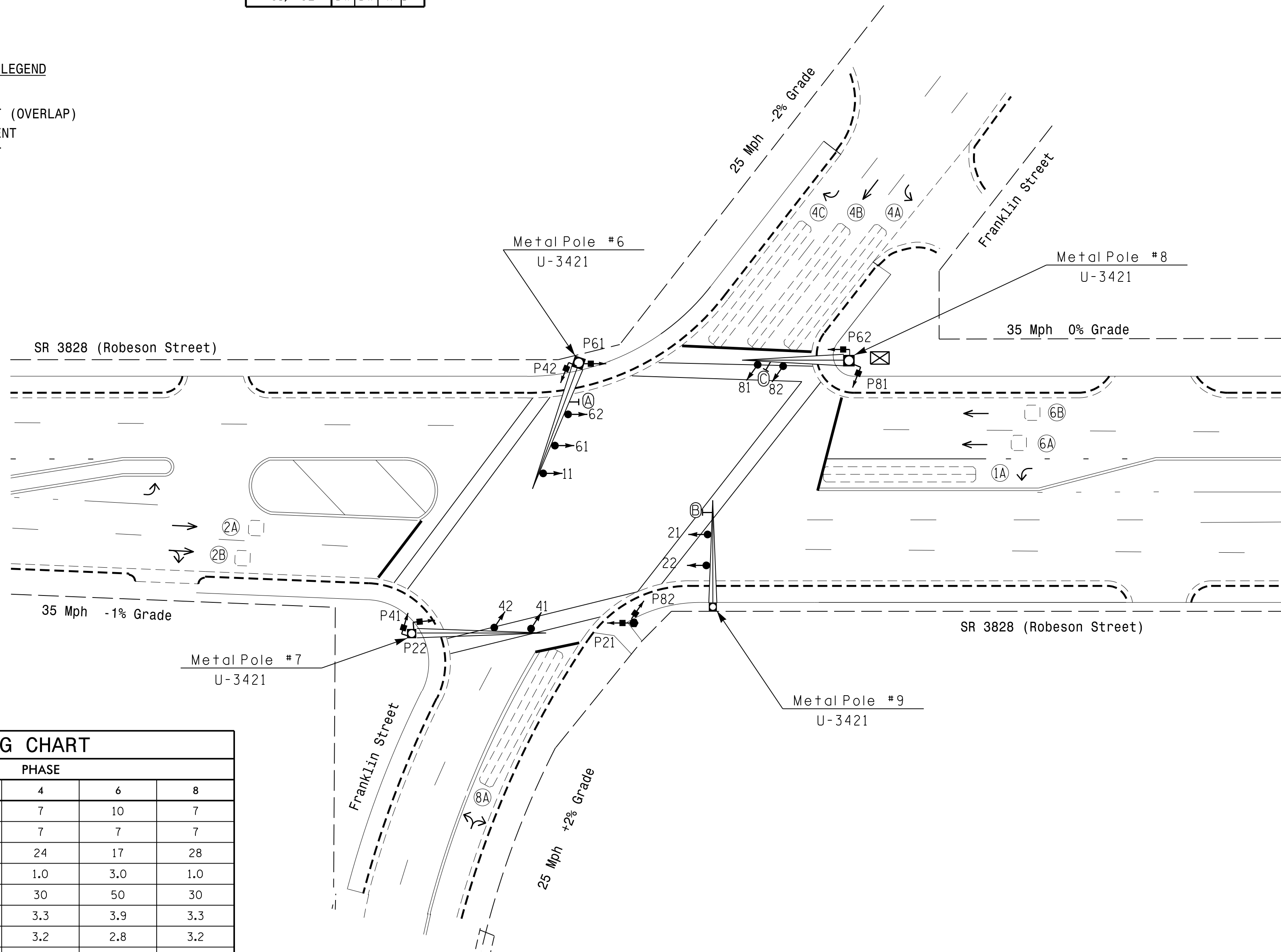
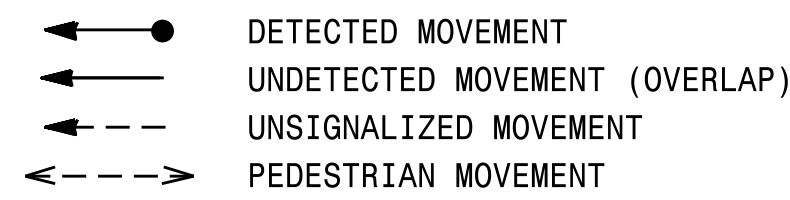

ASC/3 TIMING CHART					
FEATURE	PHASE				
	1	2	4	6	8
Min Green *	7	10	7	10	7
Walk *	0	7	7	7	7
Ped Clear	0	17	24	17	28
Veh. Extension *	1.0	3.0	1.0	3.0	1.0
Max 1 *	15	50	30	50	30
Yellow	3.0	3.9	3.3	3.9	3.3
Red Clear	3.6	2.8	3.2	2.8	3.2
Actuations B4 Add *	-	-	-	-	-
Seconds / Actuation *	-	-	-	-	-
Max Initial *	-	-	-	-	-
Time Before Reduction *	-	-	-	-	-
Time To Reduce *	-	-	-	-	-
Minimum Gap	-	-	-	-	-
Locking Detector	-	X	-	X	-
Recall Position	-	VEH. RECALL	-	VEH. RECALL	-
Dual Entry	-	-	X	-	X
Simultaneous Gap	X	X	X	X	X

* These values may be field adjusted. Do not adjust Min Green and Extension times for phases 2 and 6 lower than what is shown. Min Green for all other phases should not be lower than 4 seconds.

LEGEND

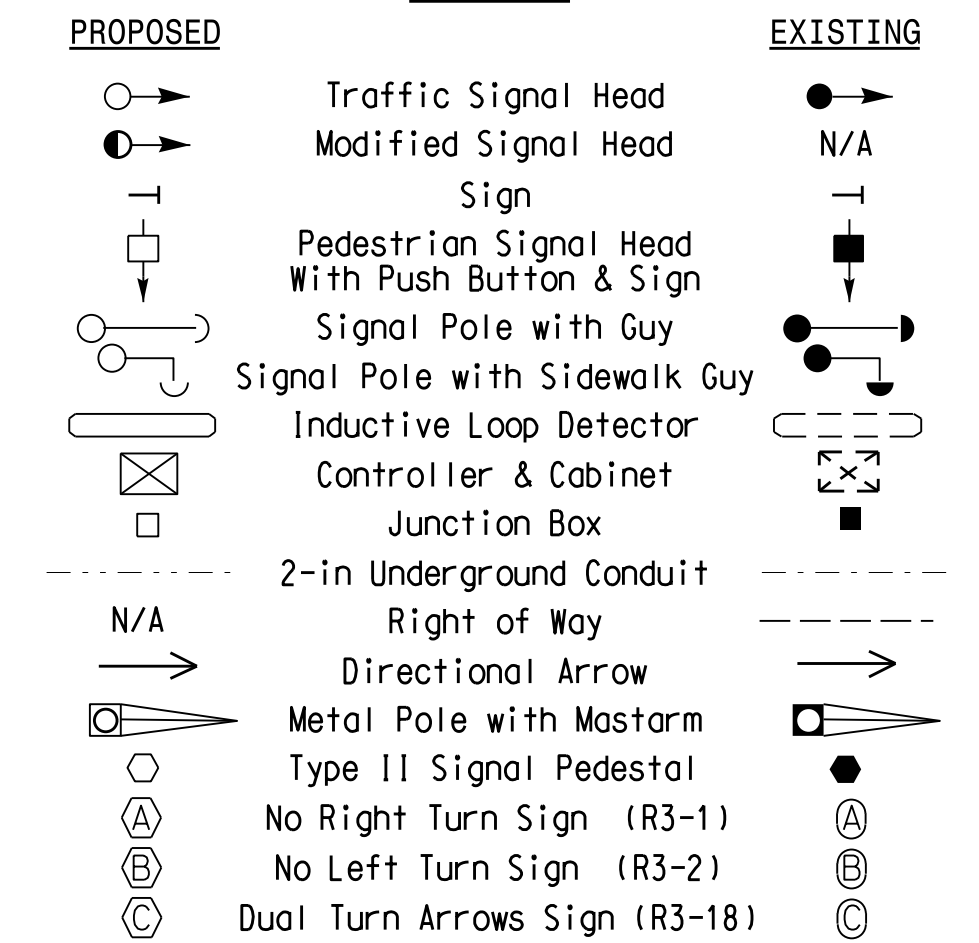

Signal Upgrade

750 N. Greenfield Pkwy, Garner, NC 27529

SR 3828 (Robeson Street) at Franklin Street

Division 6 Cumberland County Fayetteville

PLAN DATE: July 2016 REVIEWED BY: JPG

PREPARED BY: Jeff Spence REVIEWED BY:

SEAL

9/21/2016

SIG. INVENTORY NO. 06-0264

DOCUMENT NOT CONSIDERED FINAL UNLESS ALL SIGNATURES COMPLETED

24-SEP-2016 08:54
 S:\ITS\ASU\ITS_Signal\Signal Design\Section\Eastern Region\04\U-5742 Fayetteville\11e ASC\3\06-0264\060264_sigs.dsn_2016mmds.dgn
 J. Spence