

8 Phase Fully Actuated Fayetteville Signal System

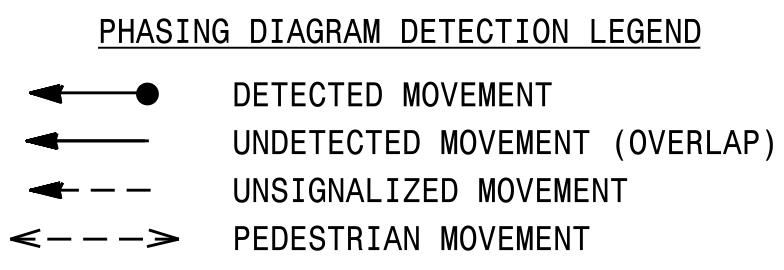

SIGNAL FACE I.D.

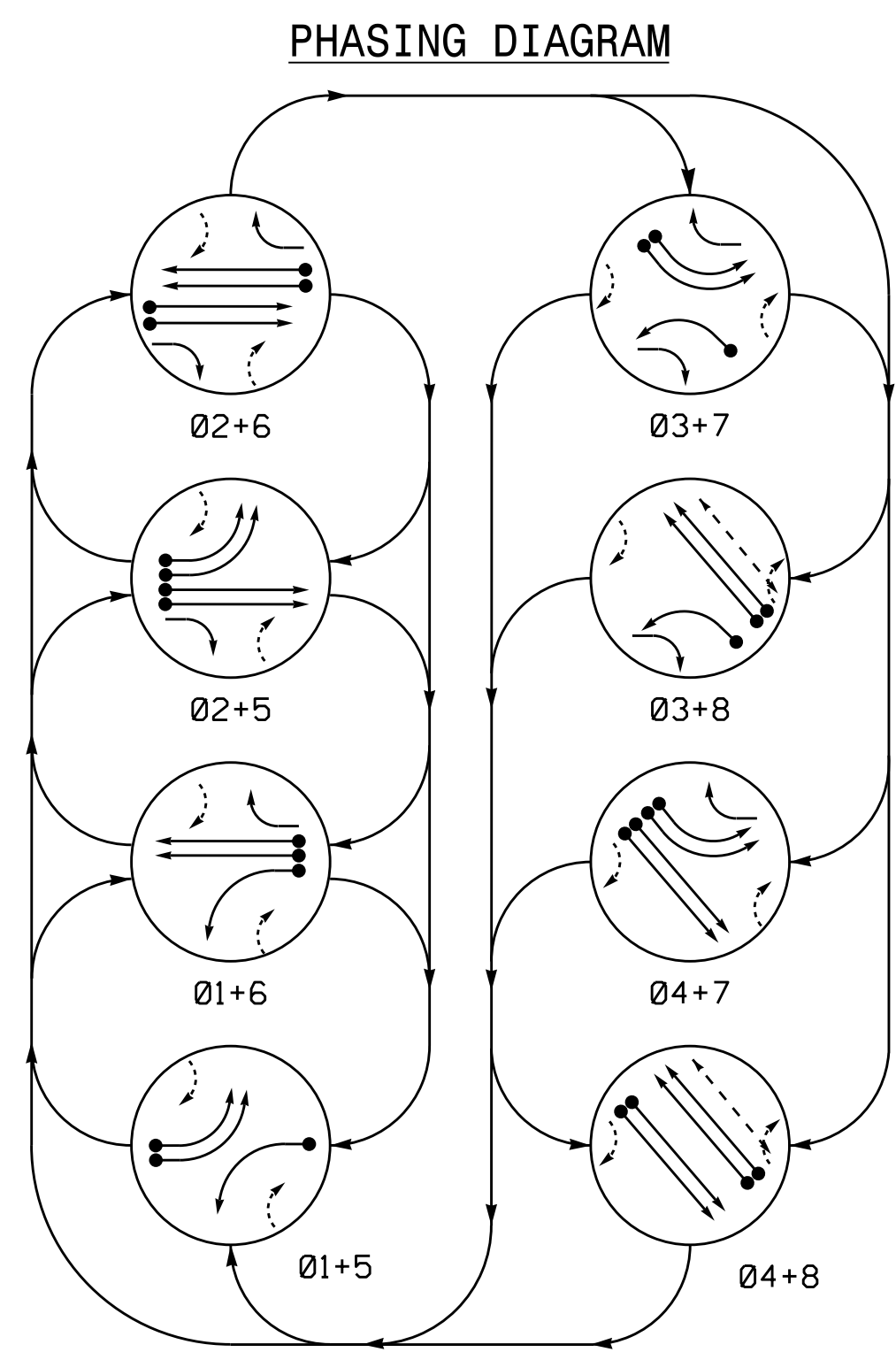
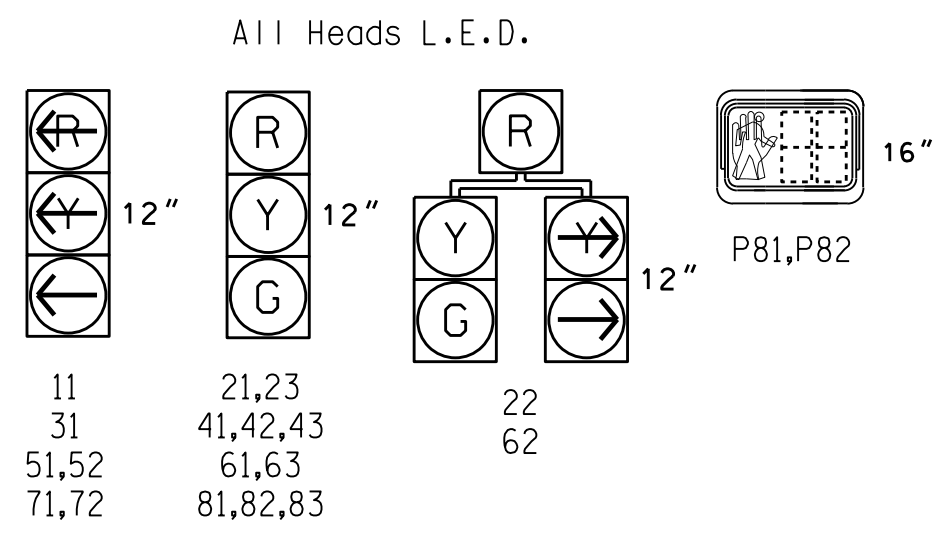

TABLE OF OPERATION

SIGNAL FACE	PHASE								FLASH
	01+5	01+6	02+5	02+6	03+7	03+8	04+7	04+8	
11	-	-	R	R	R	R	R	R	R
21,23	R	R	G	G	R	R	R	R	Y
22	R	R	G	G	R	R	R	R	Y
31	R	R	R	R	-	-	R	R	R
41,42,43	R	R	R	R	R	R	G	G	R
51,52	-	-	-	-	R	R	R	R	R
61,63	R	G	R	G	R	R	R	R	Y
62	R	G	R	G	R	R	R	R	Y
71,72	R	R	R	R	-	-	R	R	R
81,82,83	R	R	R	R	R	G	R	G	R
P81,P82	DW	DW	DW	DW	DW	W	DW	W	DRK

ASC/3 DETECTOR INSTALLATION CHART

LOOP	SIZE (FT)	DISTANCE FROM STOPBAR (FT)	TURNS	NEW LOOP	PROGRAMMING						
					PHASE	CALLING	EXTEND TIME	DELAY TIME	TYPE	SYSTEM LOOP	NEW CARD
1A	6X40	0	2-4-2	-	1	Yes	-	-	S	-	X
2A	6X6	300	6	-	2	Yes	-	-	N	-	X
2B	6X6	300	6	-	2	Yes	-	-	N	-	X
3A	6X40	0	2-4-2	-	3	Yes	-	-	S	-	X
4A	6X6	300	4	-	4	No	-	-	N	-	X
4B	6X6	300	4	-	4	No	-	-	N	-	X
4C	6X40	0	2-4-2	-	4	Yes	2.0	5	S	-	X
4D	6X40	0	2-4-2	-	4	Yes	2.0	5	S	-	X
5A	6X40	0	2-4-2	-	5	Yes	-	-	S	-	X
5B	6X40	0	2-4-2	-	5	Yes	-	-	S	-	X
6A	6X6	300	6	-	6	Yes	-	-	N	-	X
6B	6X6	300	6	-	6	Yes	-	-	N	-	X
7A	6X40	0	2-4-2	-	7	Yes	-	-	S	-	X
7B	6X40	0	2-4-2	-	7	Yes	-	-	S	-	X
8A	6X6	300	6	-	8	No	-	-	N	-	X
8B	6X6	300	6	-	8	No	-	-	N	-	X
8C	6X40	0	2-4-2	-	8	Yes	2.0	5	S	-	X
8D	6X40	0	2-4-2	-	8	Yes	2.0	5	S	-	X

NOTES

- Refer to "Roadway Standard Drawings NCDOT" dated January 2012 and "Standard Specifications for Roads and Structures" dated January 2012.
- Do not program signal for late night flashing operation unless otherwise directed by the Engineer.
- Phase 1 and/or phase 5 may be lagged.
- Phase 3 and/or phase 7 may be lagged.
- Set all detector units to presence mode.
- Locate new cabinet so as not to obstruct sight distance of vehicles turning right on red. The cabinet should be designed to include an Auxiliary Output file for future use.
- Omit "WALK" and flashing "DON'T WALK" with no pedestrian calls.
- Program pedestrian heads to countdown the flashing "Don't Walk" time only.
- Pavement markings are existing.
- Maximum times shown in timing chart are for free-run operation only. Coordinated signal system timing values supersede these values.

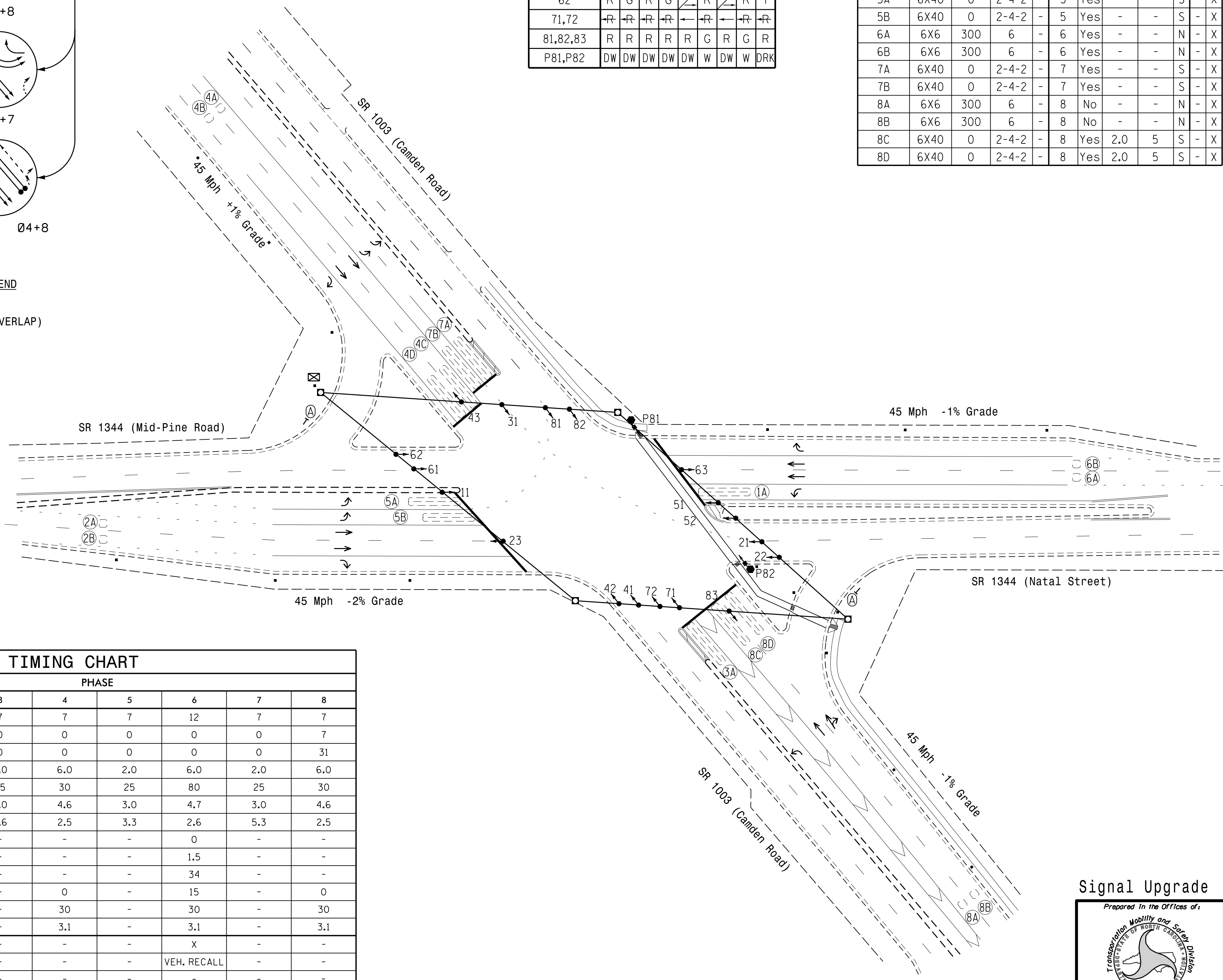

ASC/3 TIMING CHART

FEATURE	PHASE							
	1	2	3	4	5	6	7	8
Min Green *	7	12	7	7	7	12	7	7
Walk *	0	0	0	0	0	0	0	7
Ped Clear	0	0	0	0	0	0	0	31
Veh. Extension *	2.0	6.0	2.0	6.0	2.0	6.0	2.0	6.0
Max I *	25	80	25	30	25	80	25	30
Yellow	3.0	4.7	3.0	4.6	3.0	4.7	3.0	4.6
Red Clear	2.9	2.6	4.6	2.5	3.3	2.6	5.3	2.5
Actuations B4 Add *	-	0	-	-	-	0	-	-
Seconds / Actuation *	-	1.5	-	-	-	1.5	-	-
Max Initial *	-	34	-	-	-	34	-	-
Time Before Reduction *	-	15	-	0	-	15	-	0
Time To Reduce *	-	30	-	30	-	30	-	30
Minimum Gap	-	3.1	-	3.1	-	3.1	-	3.1
Locking Detector	-	X	-	-	-	X	-	-
Recall Position	-	VEH. RECALL	-	-	-	VEH. RECALL	-	-
Dual Entry	-	-	-	-	-	-	-	-
Simultaneous Gap	X	X	X	X	X	X	X	X

* These values may be field adjusted. Do not adjust Min Green and Extension times for phases 2 and 6 lower than what is shown. Min Green for all other phases should not be lower than 4 seconds.

LEGEND

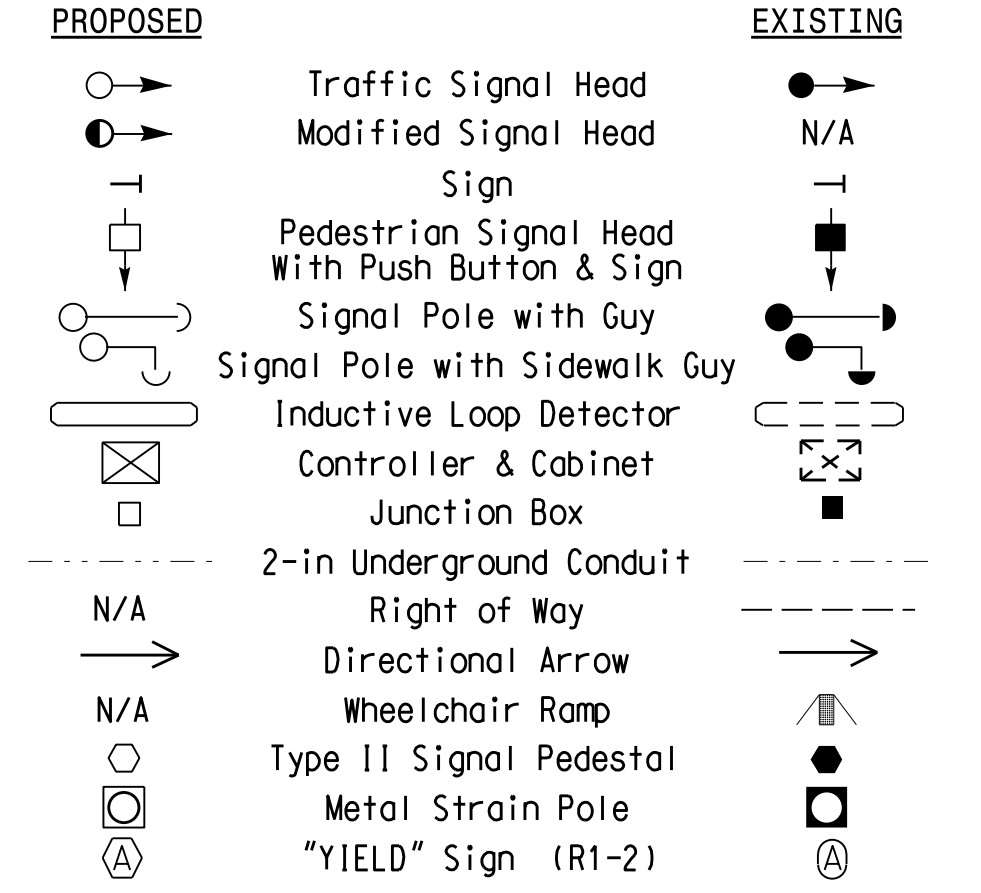

Signal Upgrade

Prepared in the Offices of:

750 N. Greenfield Pkwy, Garner, NC 27529

SCALE: 1"=50'

DOCUMENT NOT CONSIDERED FINAL UNLESS ALL SIGNATURES COMPLETED

SR 1344 (Natal St/Mid-Pine Rd) at SR 1003 (Camden Road)

Division 6 Cumberland County Fayetteville

PLAN DATE: December 2015 REVIEWED BY: JPG

PREPARED BY: Jeff Spence REVIEWED BY:

REVISIONS: INIT. DATE

SEAL: NORTH CAROLINA PROFESSIONAL ENGINEER, JASON P. GALLAGHER, No. 029904

DATE: 6/8/2016

SIG. INVENTORY NO. 06-0335

02-jul-2016 09:17
 S:\Projects\Signal Design\Section\Eastern Region\01-5742 Fayetteville\11e ASC\3\06-0335\060335_s1a.dsn_2015.mxd.dgn
 J:\011000