

**This electronic collection of documents is provided
for the convenience of the user
and is Not a Certified Document –**

**The documents contained herein were originally issued
and sealed by the individuals whose names and license
numbers appear on each page, on the dates appearing
with their signature on that page.**

**This file or an individual page
shall not be considered a certified document.**

STATE OF NORTH CAROLINA DIVISION OF HIGHWAYS

CROSS-SECTION SUMMARY

NOTE: EMBANKMENT COLUMN DOES NOT INCLUDE BACKFILL FOR UNDERCUT

Station	Uncl. Exc.	Embt	Station	Uncl. Exc.	Embt										
Det	(cu. yd.)	(cu. yd.)	DET REMV	(cu. yd.)	(cu. yd.)										
10+40.00	0	9	11+34.00	5	0										
11+00.00	0	0	11+50.00	5	0										
11+25.00	1	5	11+75.00	1	0										
11+50.00	1	3	12+00.00	5	0										
11+75.00	2	13	12+55.00	5	0										
12+00.00	32	7													
12+25.00	67	7	Station	Uncl. Exc.	Embt										
12+50.00	34	44	DET REMV	(cu. yd.)	(cu. yd.)										
12+56.41	0	20	13+10.00	25	0										
Station	Uncl. Exc.	Embt	13+25.00	25	0										
Det	(cu. yd.)	(cu. yd.)	13+50.00	25	0										
13+11.54	1	6	13+75.00	23	0										
13+25.00	0	0	14+00.00	13	0										
13+50.00	6	13													
13+75.00	12	17													
14+00.00	8	22													
14+25.00	2	17													
14+50.00	0	6													
15+00.00	0	3													
Station	Uncl. Exc.	Embt													
L	(cu. yd.)	(cu. yd.)													
10+12.26	4	1													
10+25.00	0	0													
10+50.00	7	8													
10+75.00	0	14													
11+00.00	1	19													
11+25.00	1	19													
11+50.00	0	22													
11+75.00	0	22													
12+00.00	0	15													
12+24.81	0	12													
Station	Uncl. Exc.	Embt													
L	(cu. yd.)	(cu. yd.)													
13+17.19	0	4													
13+25.00	0	0													
13+50.00	0	15													
13+75.00	0	27													
14+00.00	0	37													
14+25.00	0	35													
14+50.00	0	25													
14+75.00	3	11													
15+00.00	12	4													
15+25.00	17	3													
15+50.00	7	2													

Approximate quantities only. Unclassified excavation, borrow excavation, fine grading, clearing and grubbing, and removal of existing pavement will be paid for at the lump sum price for "Grading".

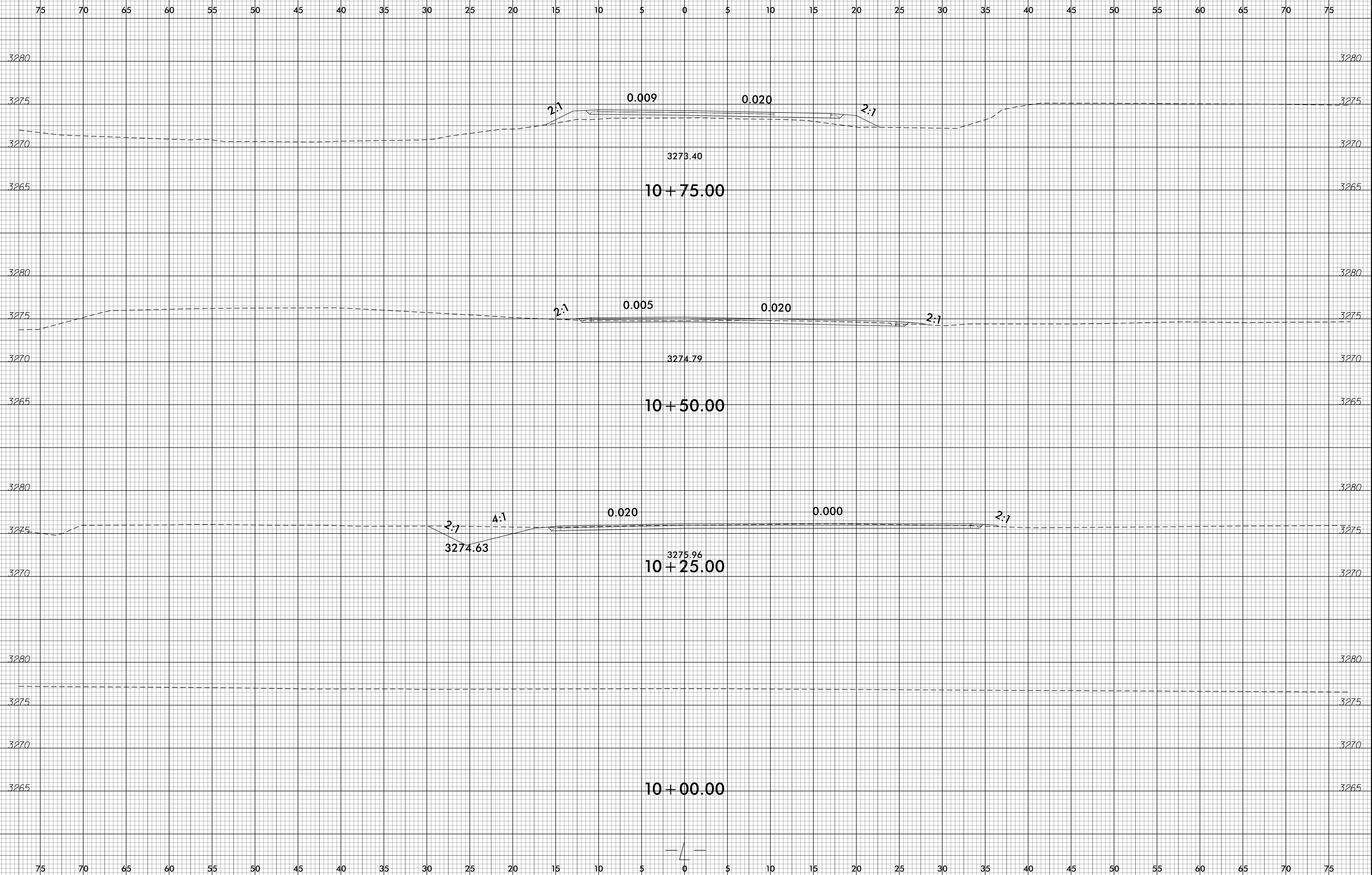

8/23/99

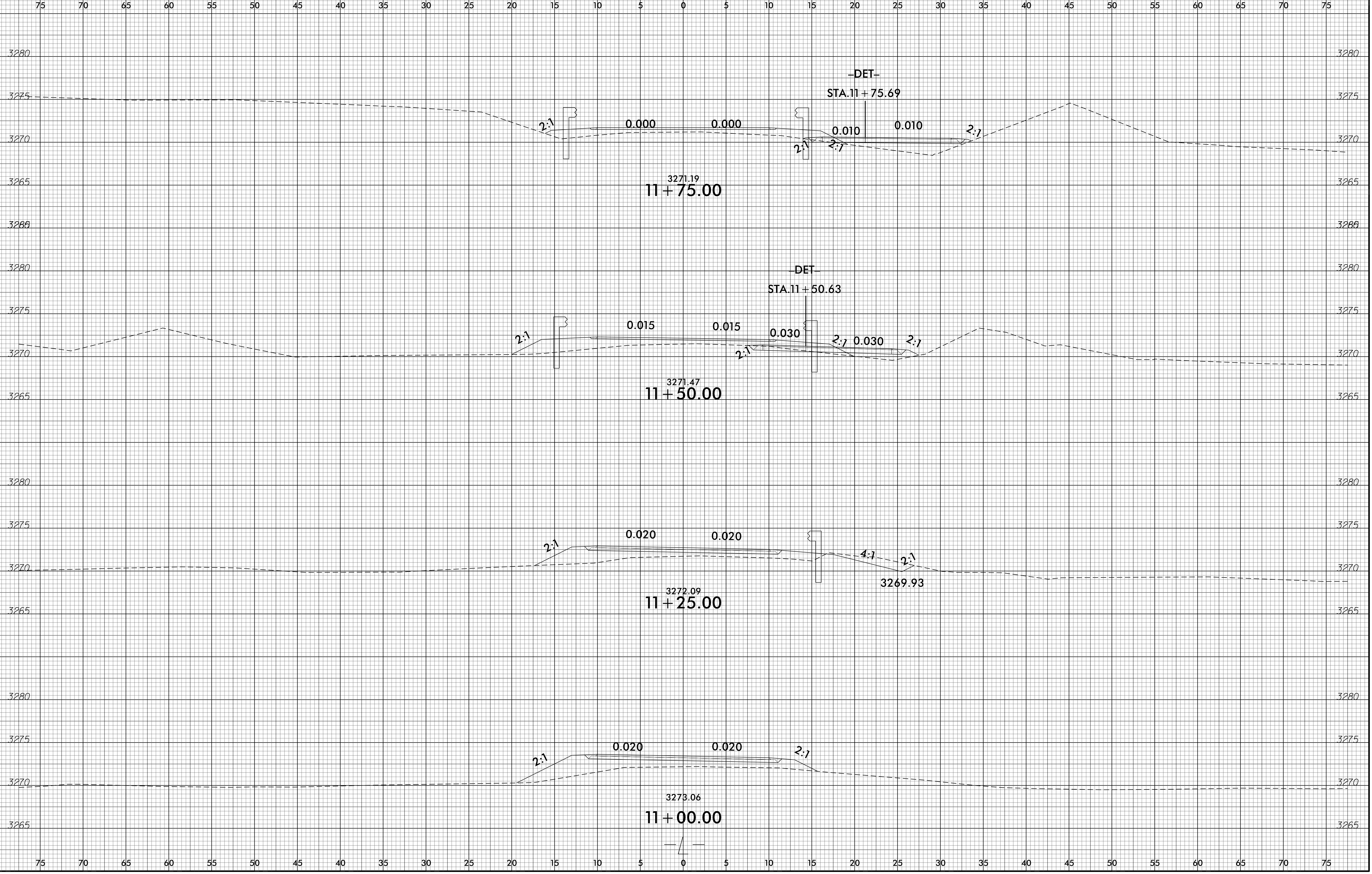

9 DEC 2016 10:54
RAVE...
\$\$\$\$\$
\$\$\$\$\$

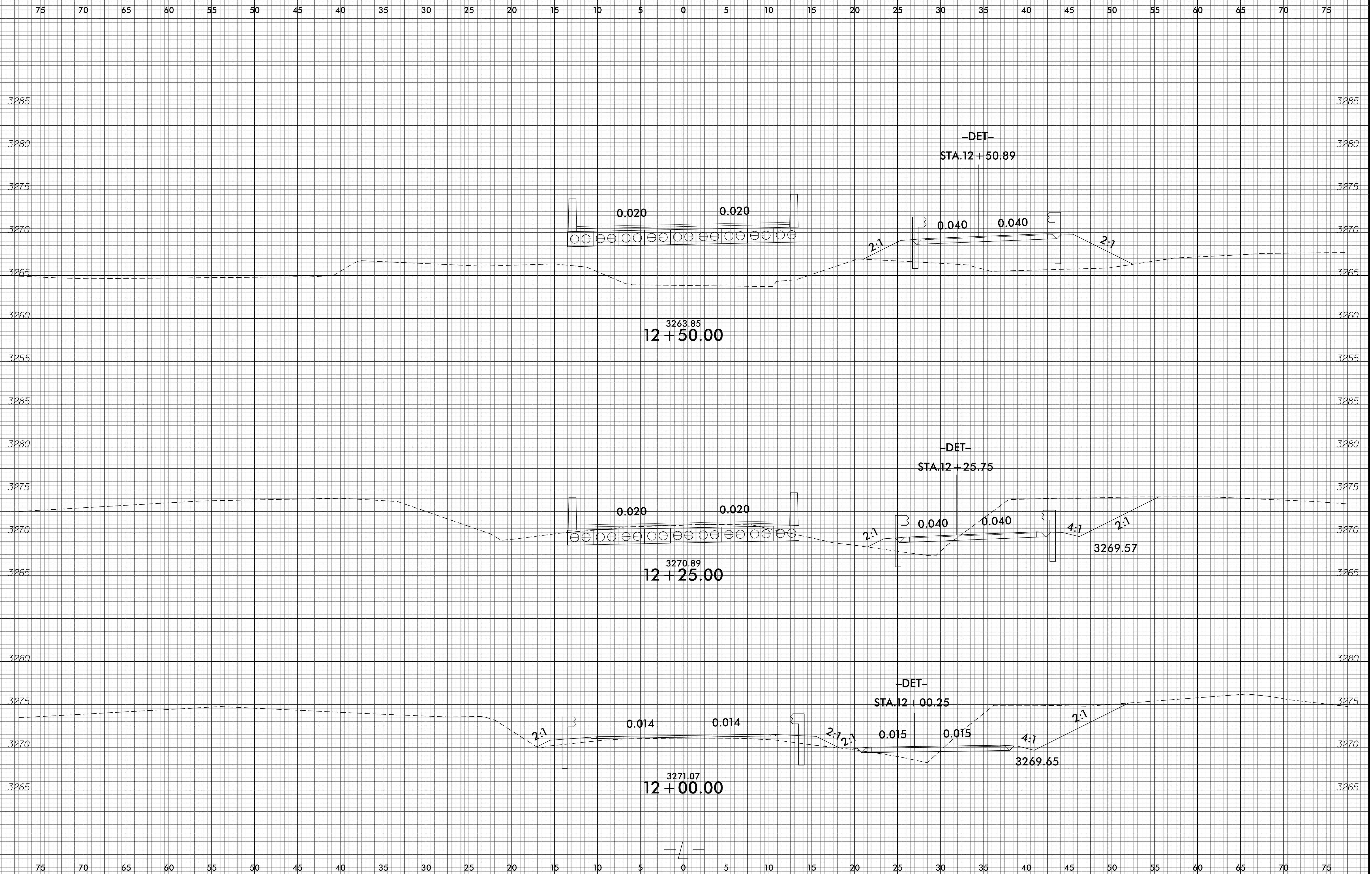
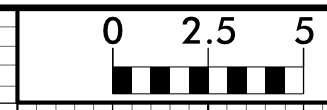

8/23/99

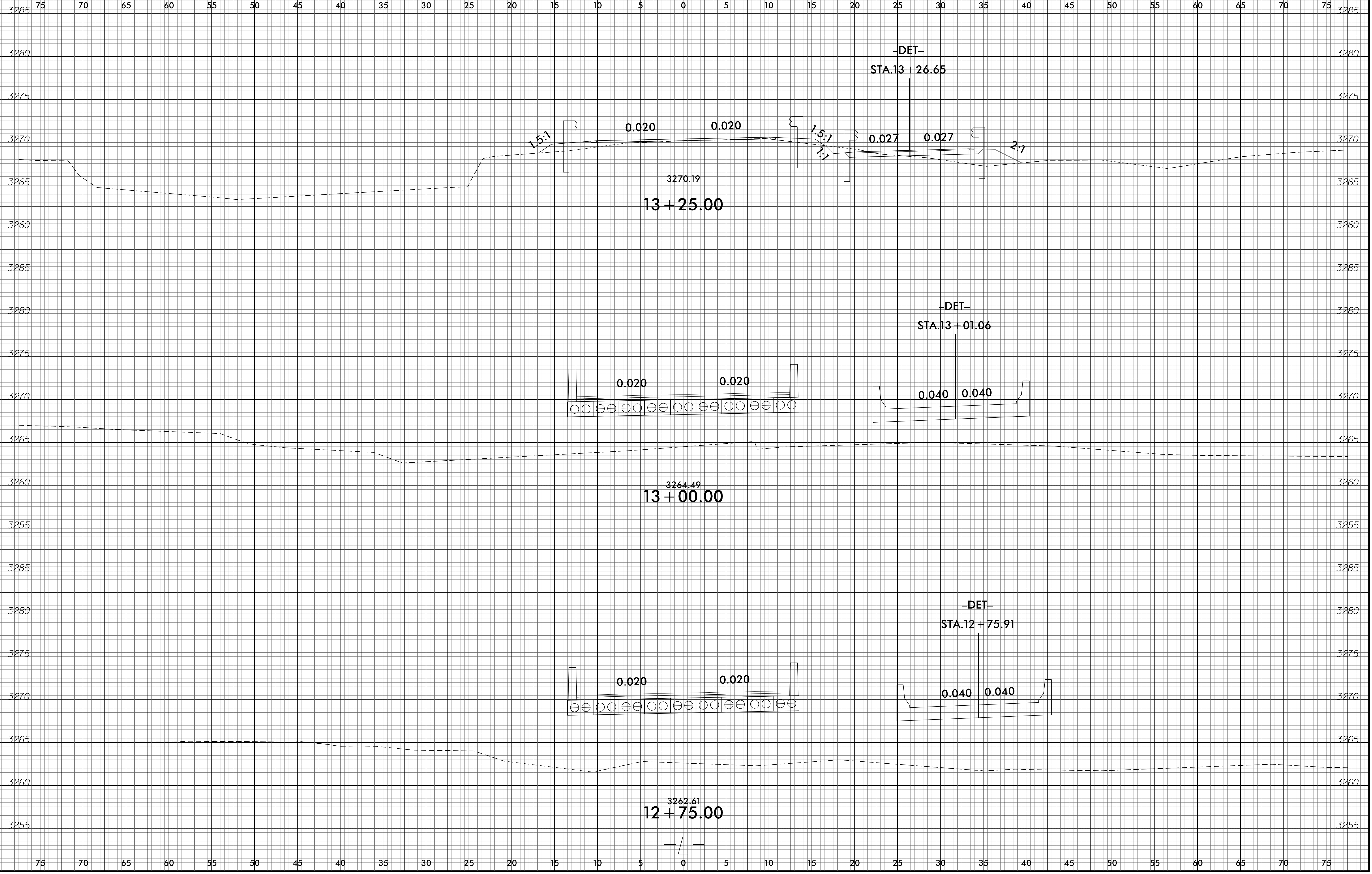

19 DEC 2016 10:54
RAVE...forModeling\B5383.Rdy...L and DET_new.dgn
\$\$\$\$\$USERNAME\$\$\$\$\$

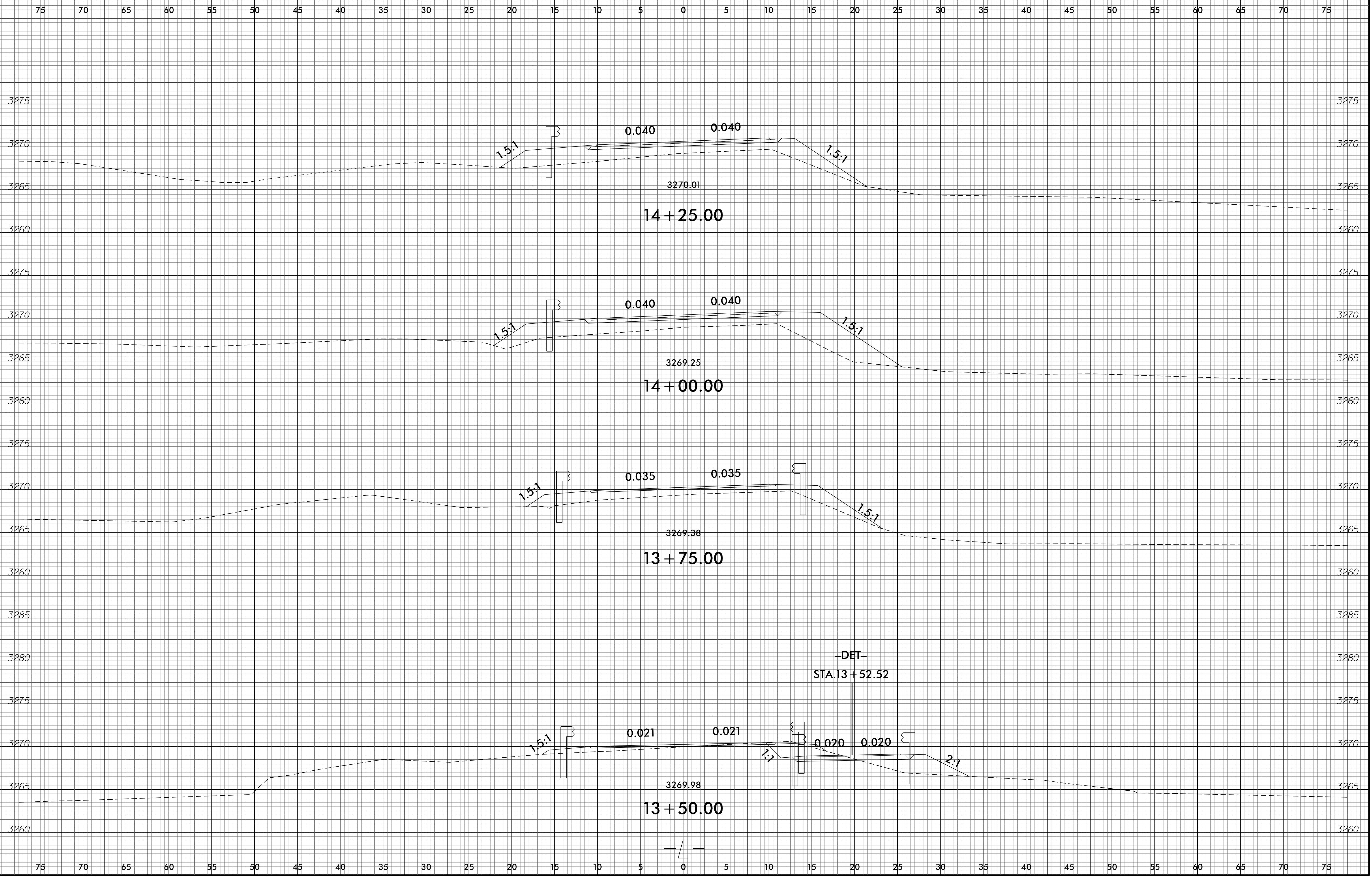
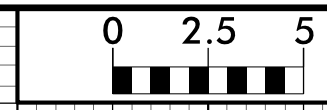

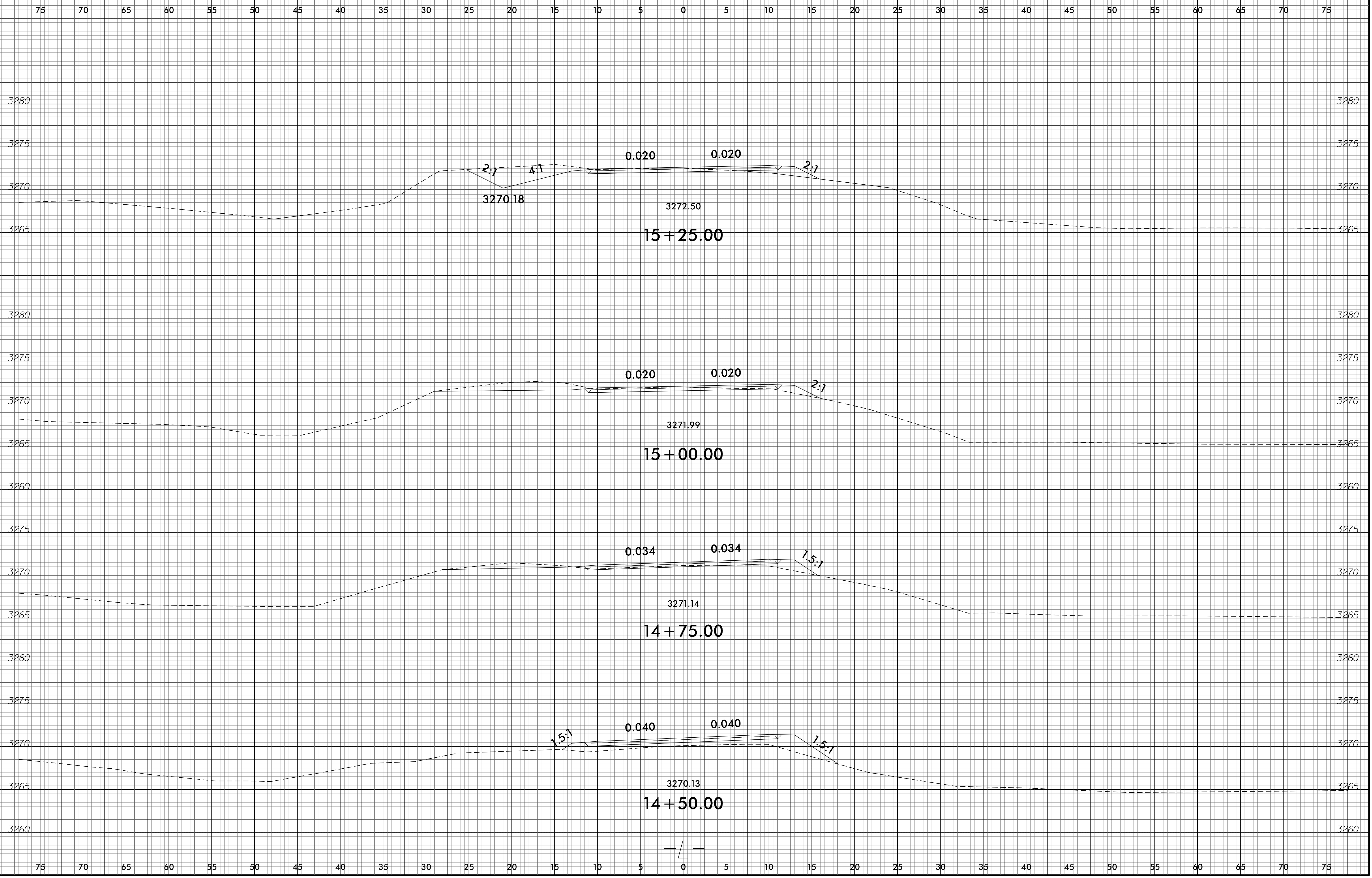
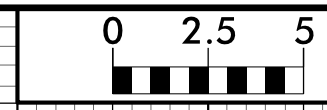

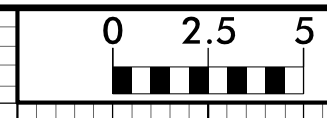

PROJ. REFERENCE NO.
B-5383

SHEET NO.
X-7

75 70 65 60 55 50 45 40 35 30 25 20 15 10 5 0 5 10 15 20 25 30 35 40 45 50 55 60 65 70 75

