

PROJECT REFERENCE NO.	SHEET NO.
R-3826	EC-24/CONST.12
RW SHEET NO.	
ROADSIDE ENVIRONMENTAL PROJECT ENGINEER	
LEVEL III CERTIFIED BY: STACEY H. BAILEY, PE CERTIFICATION NUMBER: 3074 ISSUED: SEPTEMBER 27, 2016	

FINAL EROSION CONTROL FOR
CONSTRUCTION SHEET 12

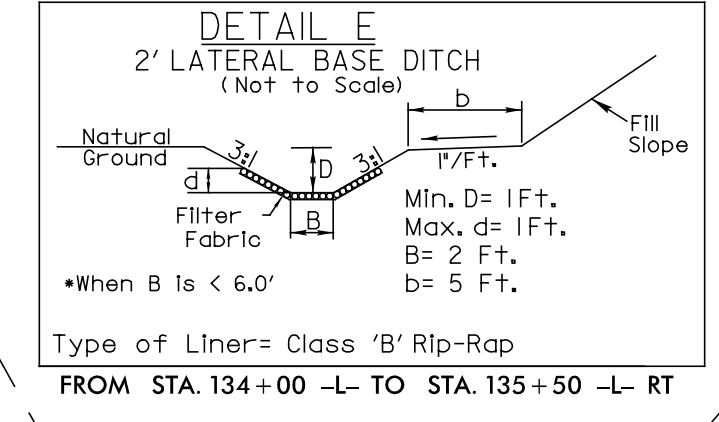
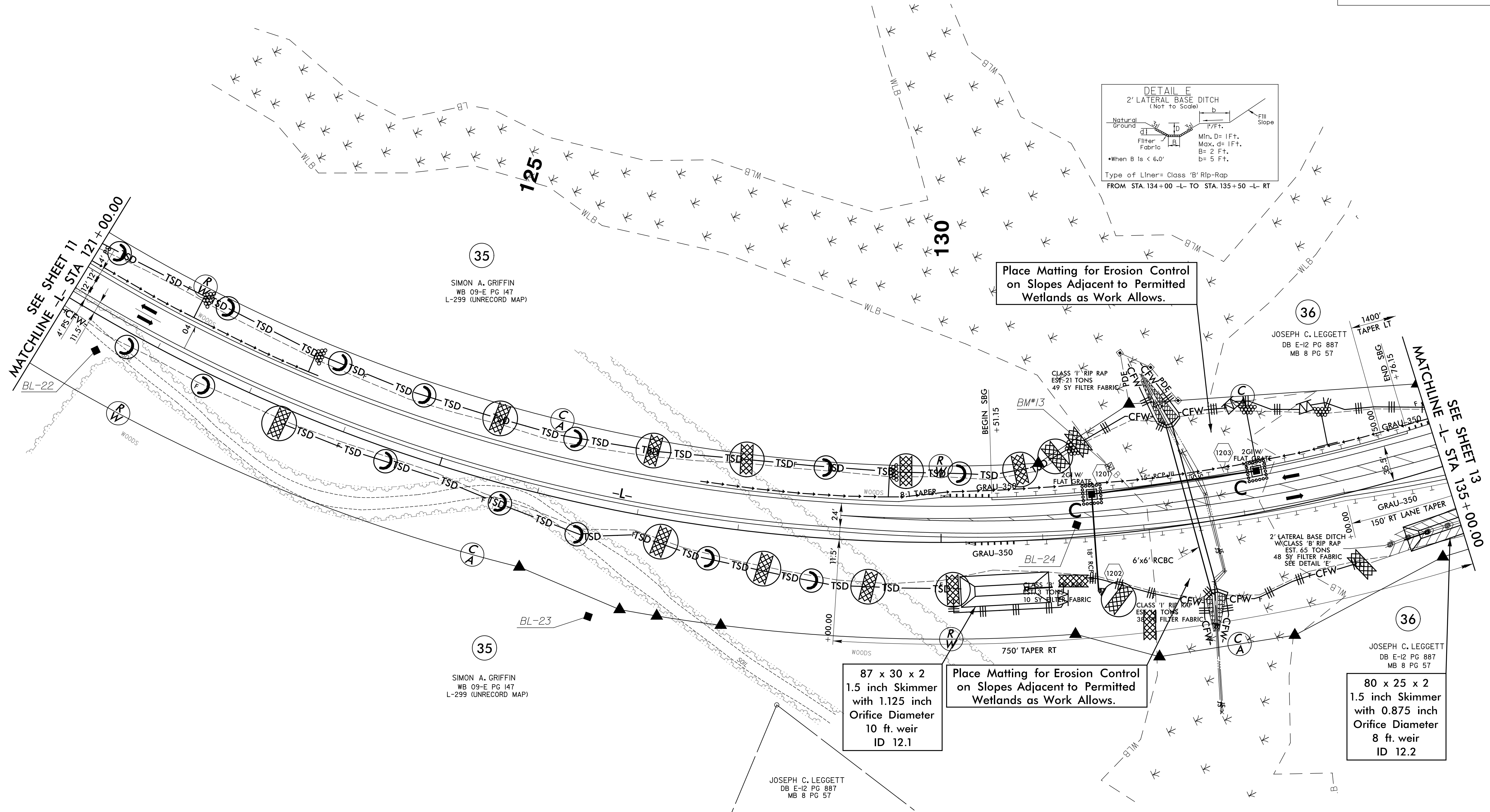
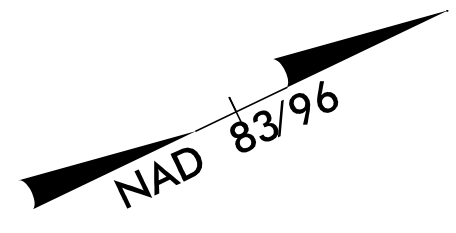

Place Matting for Erosion Control
on Slopes Adjacent to Permitted
Wetlands as Work Allows.

87 x 30 x 2
1.5 inch Skimmer
with 1.125 inch
Orifice Diameter
10 ft. weir
ID 12.1

Place Matting for Erosion Control
on Slopes Adjacent to Permitted
Wetlands as Work Allows.

80 x 25 x 2
1.5 inch Skimmer
with 0.875 inch
Orifice Diameter
8 ft. weir
ID 12.2

NOTE:
ALL EROSION CONTROL DEVICES SHOWN ARE LOCATED
WITHIN EXISTING RW OR EASEMENT.

FOR -L- PROFILE, SEE SHEET 20

FOR CULVERT, SEE SHEET C-1 THROUGH C-5

5/14/99
11/15/2016
R3826.dwg
control.final.psh.12.dgn
S.A. GRIFFIN, INC.