

LEGEND

TRAFFIC CONTROL DEVICES

BARRICADE (TYPE III)

TEMPORARY SIGNING

STATIONARY SIGN

NOTES:
 TRAFFIC CONTROL DEVICES (A) THROUGH (I) SHALL BE INSTALLED ACCORDING TO RSD 1101.03, SHEET 1 OF 9.
 TRAFFIC CONTROL DEVICES (1) THROUGH (3) SHALL BE INSTALLED AS SHOWN ON PLAN OR AS DIRECTED BY THE ENGINEER.

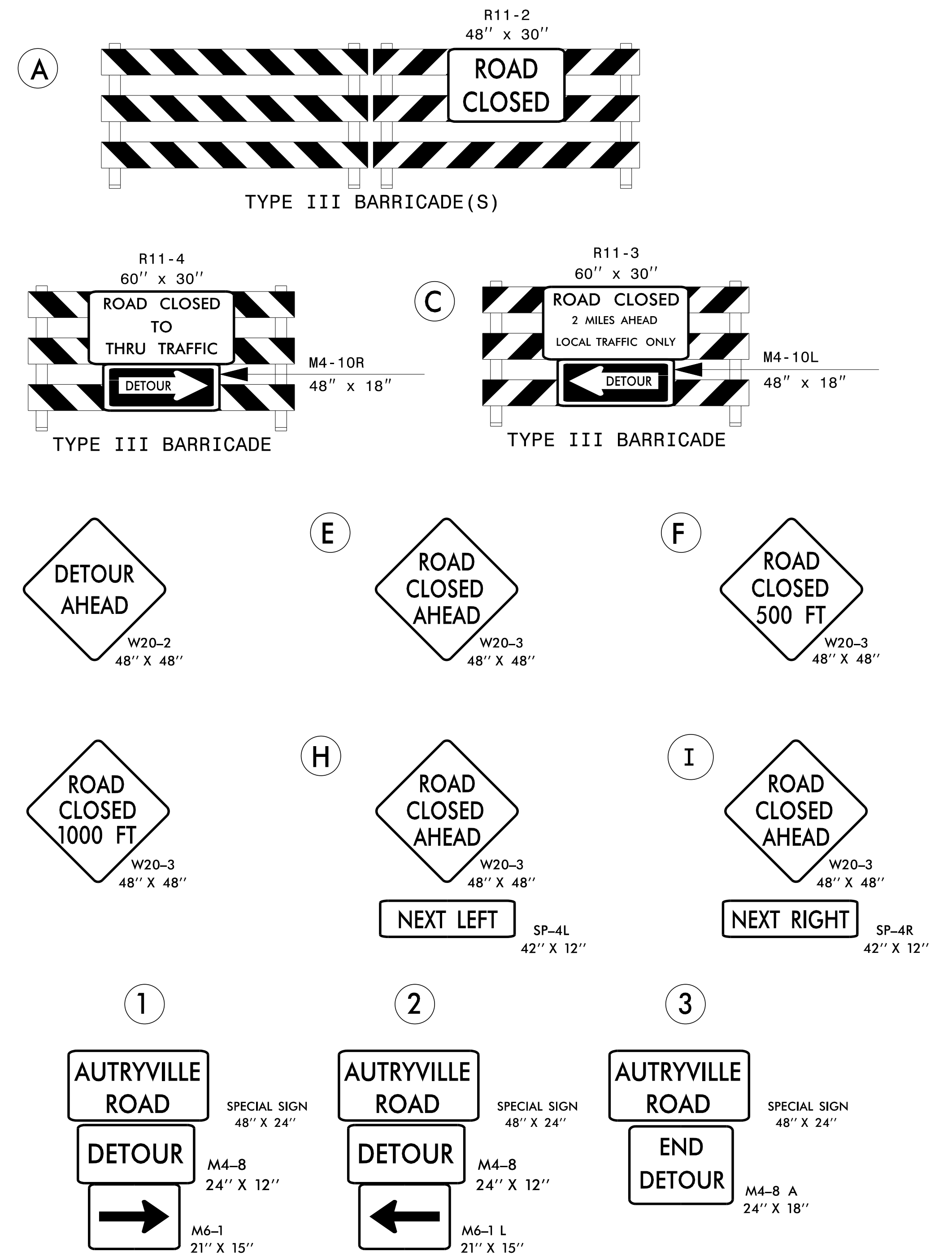

APPROVED: *Don A. Parker*
 DATE: 9/26/2016

OFF-SITE DETOUR ROUTE AND BARRICADE PLACEMENT

9/26/2016
 R:\TrafficControl\CP\B-4814_TC_TMP_3.dgn
 User: sbjennings