

NOTES

MATERIAL EXCAVATED FROM THE EXISTING BED SHALL BE STOCKPILED FOR USE IN THE PROPOSED CULVERT AND SHALL PROVIDE A CONTINUOUS LOW FLOW CHANNEL AS SHOWN. THE MATERIAL SHALL BE NATURAL STONE WITH A GRADATION SIZE SIMILAR TO THAT OF CLASS B RIP RAP. STONES LARGER THAN 6 INCHES SHALL NOT BE PLACED WITHIN THE LOW FLOW CHANNEL. BED MATERIAL SHALL BE SUBJECT TO APPROVAL BY THE ENGINEER, AND MAY BE SUBJECT TO PERMIT CONDITIONS.

THE STOCKPILED MATERIAL SHALL BE PLACED TO PROVIDE A DEPTH OF 1 FOOT IN LOW FLOW CHANNEL, AND 1'-6" FEET IN THE HIGH FLOW CHANNEL.

THE TOP OF BED MATERIAL IN THE LOW FLOW CHANNEL SHOULD MATCH THE STREAM BED ELEVATION.

BED MATERIAL SHALL BE SUPPLEMENTED BY CLASS B RIP RAP AS NECESSARY IN THE HIGH FLOW CHANNEL ONLY.

THE ENTIRE COST OF WORK REQUIRED TO PLACE THE EXCAVATED MATERIAL AS SHOWN ON THE PLANS SHALL BE INCLUDED IN THE CONTRACT LUMP SUM PRICE BID FOR CULVERT EXCAVATION.

THE ENTIRE COST OF WORK REQUIRED TO CONSTRUCT THE SILLS/BAFFLES SHALL BE INCLUDED IN THE VARIOUS PAY ITEMS.

BAR TYPE

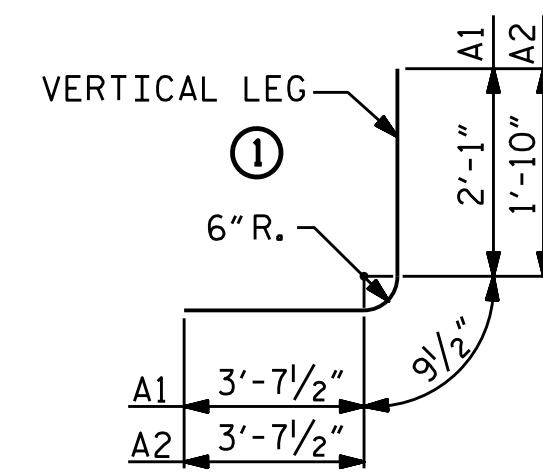

BAR DIMENSIONS ARE OUT TO OUT

SPLICE CHART

BAR	SIZE	SPLICE LENGTH
B1	#4	1'-5"
C1	#4	1'-11"

BAR SCHEDULE

STAGE I						STAGE II					
BAR	NO.	SIZE	TYPE	LENGTH	WEIGHT	BAR	NO.	SIZE	TYPE	LENGTH	WEIGHT
A1	153	#4	1	6'-6"	664	A1	67	#4	1	6'-6"	291
A2	153	#5	1	6'-3"	997	A2	67	#5	1	6'-3"	437
A100	75	#6	STR	10'-11"	1230	A150	32	#6	STR	10'-11"	525
A101	1	#6	STR	8'-6"	13	A151	1	#6	STR	9'-0"	14
A102	1	#6	STR	5'-2"	8	A152	1	#6	STR	5'-8"	9
A103	1	#6	STR	1'-11"	3	A153	1	#6	STR	2'-4"	4
A200	75	#7	STR	10'-11"	1674	A250	32	#7	STR	10'-11"	714
A201	1	#7	STR	8'-6"	17	A251	1	#7	STR	9'-0"	18
A202	1	#7	STR	5'-2"	11	A252	1	#7	STR	5'-8"	12
A203	1	#7	STR	1'-11"	4	A253	1	#7	STR	2'-4"	5
B1	90	#4	STR	6'-11"	416	B1	40	#4	STR	6'-11"	185
B2	153	#4	STR	5'-4"	545	B2	67	#4	STR	5'-4"	239
C1	76	#4	STR	24'-10"	1261	C2	76	#4	STR	11'-2"	567
D1	12	#6	STR	1'-10"	33	D1	6	#6	STR	1'-10"	17
D2	8	#6	STR	1'-4"	16	D2	4	#6	STR	1'-4"	8
G1	2	#4	STR	11'-2"	15	G1	2	#4	STR	11'-2"	15
S2	6	#8	STR	11'-2"	179	S2	6	#8	STR	11'-2"	179
REINFORCING STEEL = 7,086 LBS						REINFORCING STEEL = 3,239 LBS					

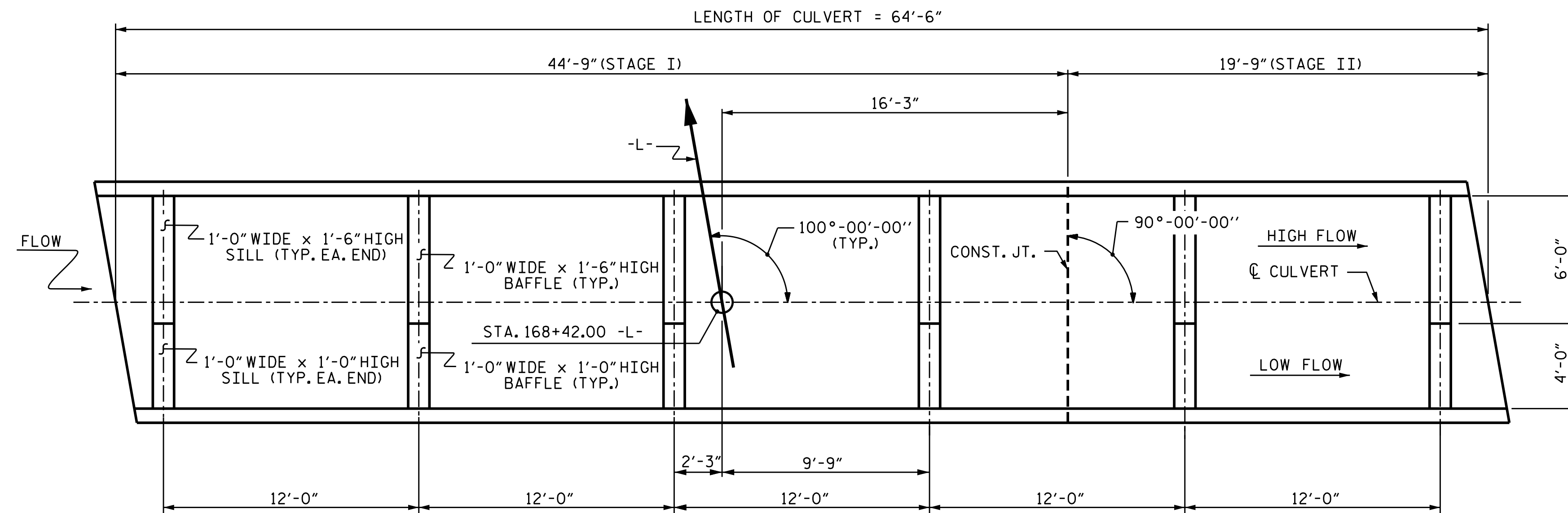

PLAN VIEW SHOWING SILL/BAFFLE LOCATIONS

STAGE I STRUCTURE QUANTITIES		STAGE II STRUCTURE QUANTITIES	
CLASS A CONCRETE		CLASS A CONCRETE	
BARREL @ 0.913 CY/FT	40.9 C.Y.	BARREL @ 0.913 CY/FT	18.0 C.Y.
WINGS ETC.	8.2 C.Y.	WINGS ETC.	8.2 C.Y.
SILLS/BAFFLES	1.9 C.Y.	SILLS/BAFFLES	1.0 C.Y.
TOTAL	51.0 C.Y.	TOTAL	27.2 C.Y.
REINFORCING STEEL		REINFORCING STEEL	
BARREL	7,086 LBS.	BARREL	3,239 LBS.
WING ETC.	466 LBS.	WING ETC.	466 LBS.
TOTAL	7,552 LBS.	TOTAL	3,705 LBS.
CULVERT EXCAVATION	LUMP SUM	CULVERT EXCAVATION	LUMP SUM
FOUNDATION CONDITIONING MATERIAL	48 TONS	FOUNDATION CONDITIONING MATERIAL	21 TONS

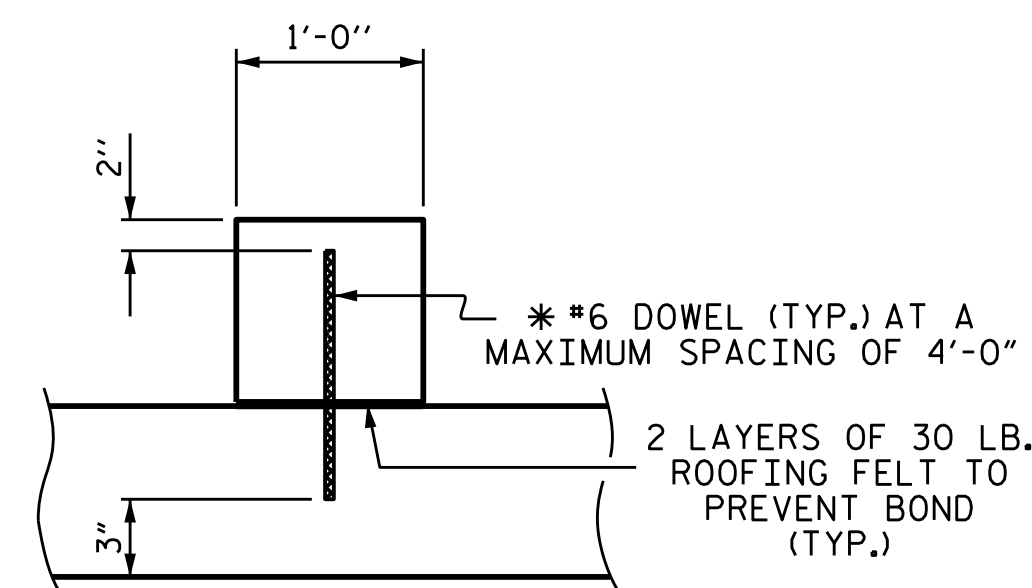

* DOWELS MAY BE PUSHED INTO GREEN CONCRETE AFTER SLAB HAS BEEN FLOAT FINISHED.

SECTION THROUGH SILL/BAFFLE

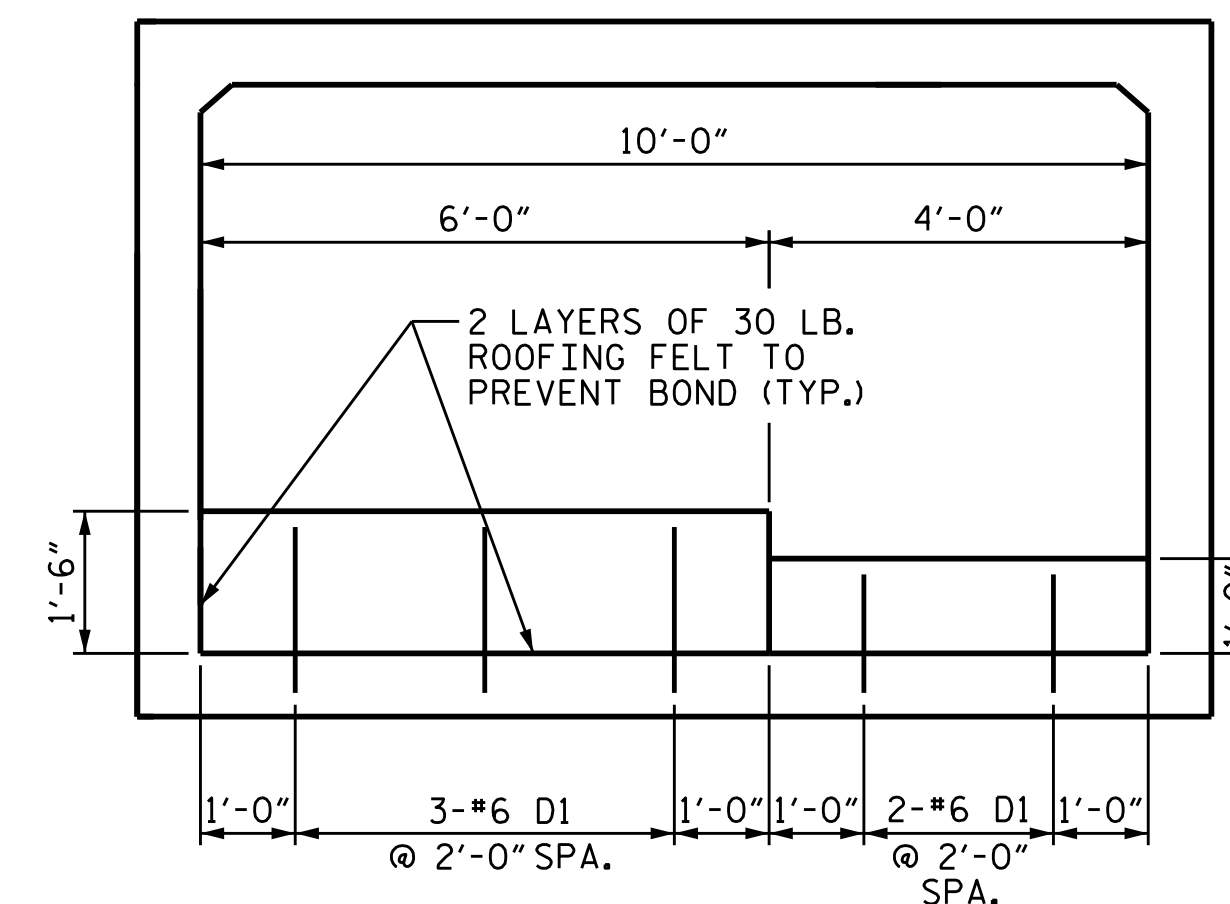

**ELEVATION
(LOOKING DOWNSTREAM)**

CULVERT SILL/BAFFLE DETAILS

DRAWN BY :	E.C.PHELPS/VXN	DATE :	8-5-16
CHECKED BY :	H.T. BARBOUR	DATE :	8-8-16
DESIGN ENGINEER OF RECORD :	A. M. LEE	DATE :	9-16

18-OCT-2016 10:34
O:\Structures\Plans\FINAL PLANS\R4753.SD.CU.02.dgn
warofat



DocuSigned by:
Wael Arafat
4139C12A32A8408...
10/18/2016

DOCUMENT NOT CONSIDERED FINAL UNLESS ALL SIGNATURES COMPLETED

PROJECT NO. R-4753
JACKSON COUNTY
STATION: 168+42.00 -L-
SHEET 5 OF 7

STATE OF NORTH CAROLINA
DEPARTMENT OF TRANSPORTATION
RALEIGH
SINGLE 10 FT. X 6 FT.
CONCRETE BOX CULVERT
100°-00'-00" SKEW

REVISIONS				SHEET NO.	
NO.	BY:	DATE:	NO.	BY:	DATE:
1			3		
2			4		

TOTAL SHEETS 14

CULVERT #2