

PROJECT REFERENCE NO.	SHEET NO.
R-4753	EC-13/CONST.13
RW SHEET NO.	
ROADWAY DESIGN ENGINEER	HYDRAULICS ENGINEER

NAD 83/NSRS 2007

-L-	
PI Sta 147+37.01 Δ = 27° 12' 31.7" (RT) D = 4' 05" 33.2" L = 664.84' T = 338.81' R = 1,400.00' SE = .05 RO = 105'	PI Sta 156+13.24 Δ = 25° 21' 12.8" (RT) D = 10' 03" 06.8" L = 252.23' T = 128.21' *R = 570.00' (40mph) SE = .08 RO = 168'

INSTALL PIPE(S) IN JURISDICTIONAL AREAS WITHOUT IMPACTING STREAM UNTIL AREA STABILIZED AND ACCORDING TO NCDOT BEST MANAGEMENT PRACTICES FOR CONSTRUCTION AND MAINTENANCE ACTIVITIES MANUAL.

\*Design Exception Required For Horizontal Curve Radius

THOMAS C. BEUTELL  
AND WIFE,  
JOAN A. BEUTELL  
DB 398 PG 123

30 x 14 x 3  
1.5 inch Skimmer  
with 0.5 inch  
Orifice Diameter  
6 ft. weir  
ID 13.1 CG

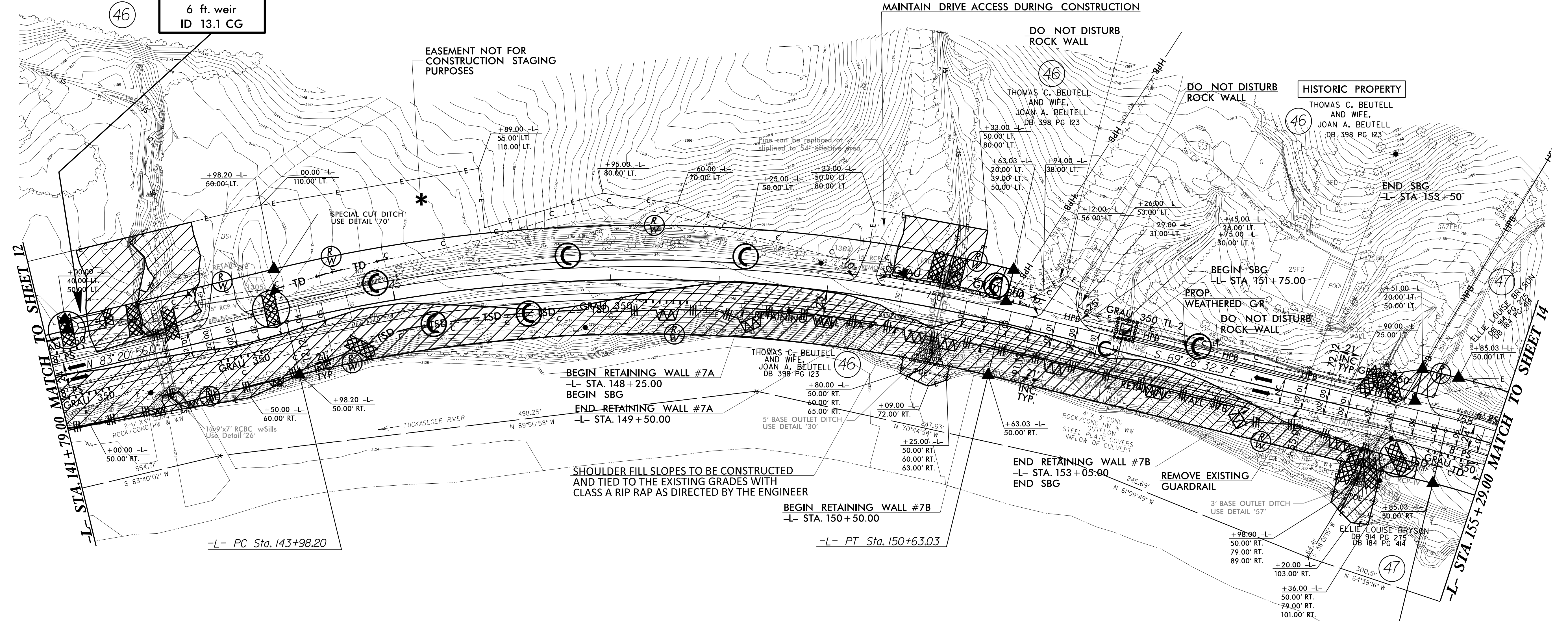

-L- STA 141+79.00 MATCH TO SHEET 12

-L- STA 155+29.00 MATCH TO SHEET 14

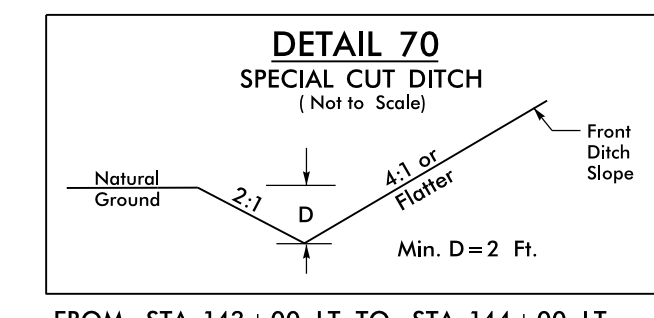
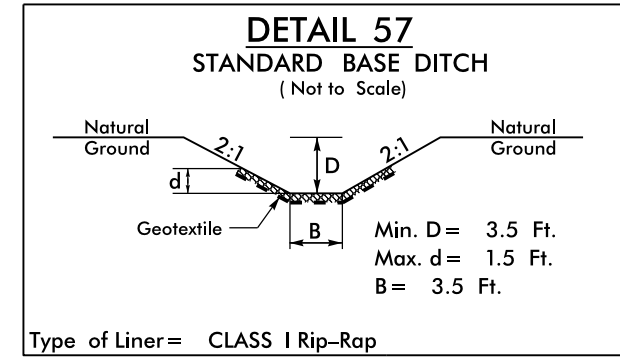
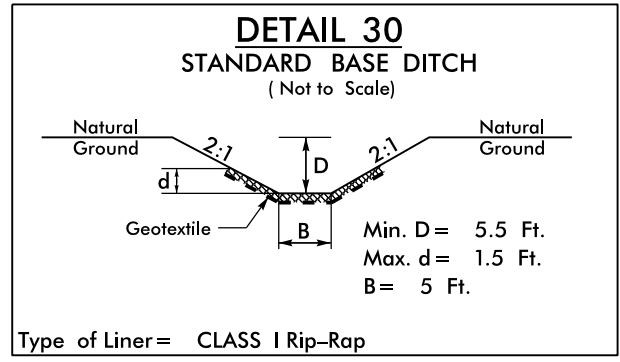
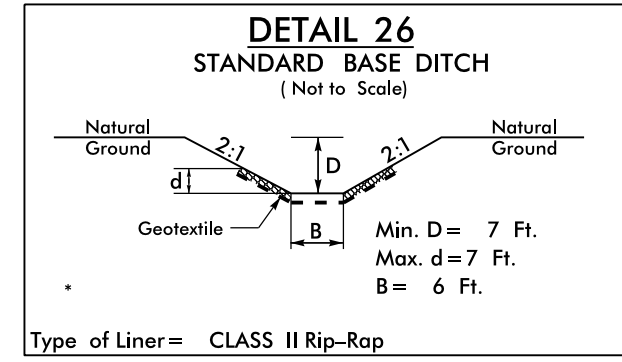

CLEARING AND GRUBBING  
EROSION CONTROL FOR  
CONSTRUCTION SHEET 13

NOTE:  
PLACE TEMPORARY ROCK SEDIMENT DAMS TYPE - B  
AND TEMPORARY ROCK SILT CHECKS TYPE - A AT  
DRAINAGE OUTLETS.



Type of Liner = CLASS II Rip-Rap  
STA. 142+79 ENTRANCE AND EXIT  
ON PROPOSED 9'x7' RCBC  
NOTE: NO RIP-RAP IS TO BE PLACED IN STREAM

Type of Liner = CLASS I Rip-Rap  
STA. 150+03 RT. (Pipe Outlet)  
48 Ton Class I Rip-Rap  
89 SY Geotextile  
36 cu. yd. DDE

Type of Liner = CLASS I Rip-Rap  
STA. 154+17 RT. (Pipe Outlet)  
20 Ton Class I Rip-Rap  
39 SY Geotextile  
15 cu. yd. DDE

FROM STA. 143+00 LT. TO STA. 144+00 LT.

Note: All Driveway Radii are 20' Unless Otherwise Noted  
Note: All Proposed Guardrail to Use Weathered Steel Unless Otherwise Noted

SBG = SHOULDER BERM GUTTER  
SEE SHEETS 23 & 24 FOR -L- PROFILE  
SEE SHEETS W-1 THRU W-8 FOR RETAINING WALL PLANS

5/14/99  
R:\E-28-SEP-2016 10:09  
r:\p\shimma\ec\B-4753-EC.psh13.dgn  
r:\p\shimma\ec\B-4753-EC.psh13.dgn